

2 - 50GHz High Gain Power Amplifier

Features

- 30dBm output power @ 10GHz
- 26dBm output power @ 40GHz
- 28dB gain to 26GHz
- 25dB gain to 40GHz
- Useful gain and power to 50GHz
- Small Size
- ECCN 3A001.b.4.c

Description

The UA2V50HM Amplifier is a broadband, high power, high gain instrumentation grade amplifier. The amplifier was designed to provide exceptional gain flatness per octave over greater than 5 octaves of frequency coverage. The 2 GHz to 50 GHz amplifier provides up to 30dB of gain and 30dBm output power with low harmonics and low residual phase noise.

Application

The UA2V50HM Amplifier is an ideal selection for laboratory and instrumentation systems where a high performance broadband RF power amplifier is required. Examples include use as a post amplifier for synthesizers, mixers, modulators, etc. where output powers are low and need to be increased to the 20dBm to 30dBm range. The amplifier was designed for use in communications systems, test equipment, military systems, etc.

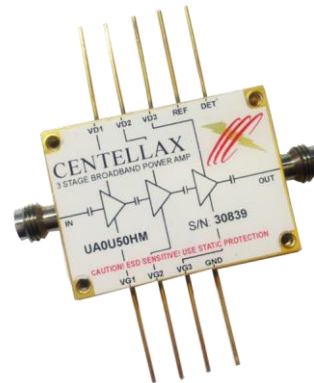

Key Characteristics @ 25°C: VD1 = VD2 = 6V; VD3 = 7V; Vg1 = Vg2 = Vg3 = -0.1V; Zo = 50Ω

Parameter	Description	2-10GHz Typ	10-26GHz Typ	26-40GHz Typ	40-50GHz Typ
Psat (dBm)	Saturated Output Power	30	28	26	22
P1dB (dBm)	1db Compressed Power	28	27	25	20
S21 (dB)	Small Signal Gain	29	28	25	24
S11 (dB)	Input Match	-15	-15	-10	-8
S22 (dB)	Output Match	-12	-10	-6	-6
S12 (dB)	Reverse Isolation	-60	-60	-50	-50
NF (dB)	Noise Figure	9	9	10.5	12

Absolute Maximum Ratings*

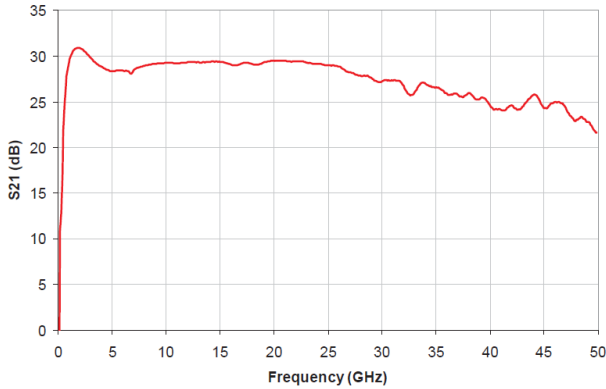
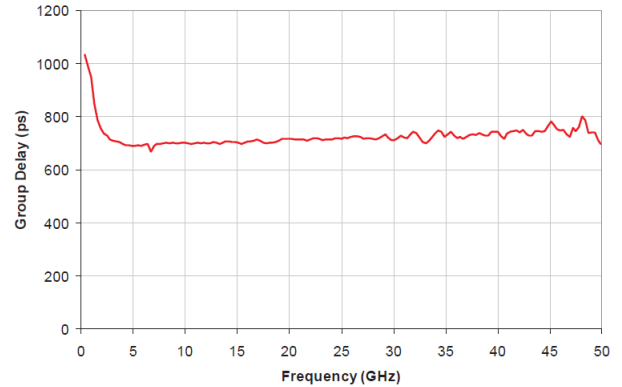
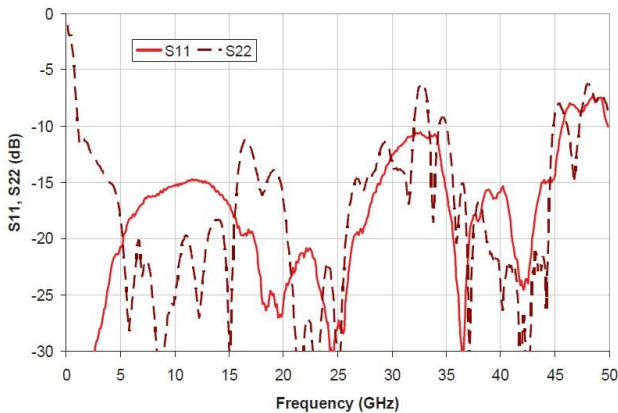
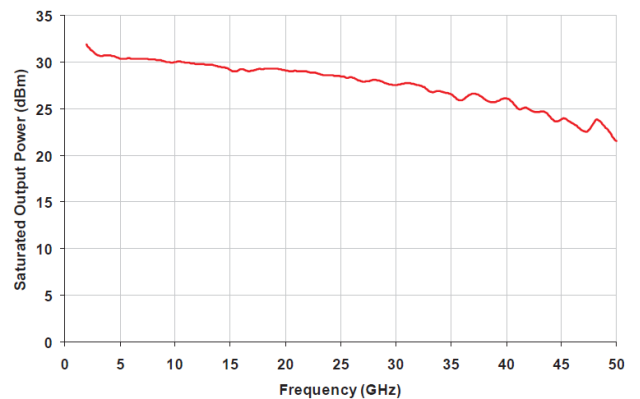
UA2V50HM S21

UA2V50HM Group Delay

UA2V50HM S11, S22

UA2V50HM Saturated Output Power

Parameter	Description	Minimum	Typ	Maximum
Vd1 (V)	Drain Bias Voltage FET1	-	6	8
Vg1 (V)	Gate Bias Voltage FET1	-4	-0.2 to 0	0.5
Idd1 (mA)	Drain Bias Current FET1	-	200	500
Vd2 (V)	Dain Bias Voltage FET2	-	6	8
Vg2 (V)	Gate Bias Voltage FET2	-4	-0.2 to 0	0.5
Idd2	Drain Bias Current FET2	-	600	1000
Vd3 (V)	Drain Bias Voltage FET3	-	7	8
Vg3 (V)	Gate Bias Voltage FET3	-4	-0.2 to 0	0.5
Idd3 (V)	Drain Bias Current FET3	-	1000	1200
Pin	Input Power (CW)	-	-	20 dBm
Pdc	Power Dissipation	-	12	-
Tbs	Backside Case Temperature	-	-	75°C

Note:

It is recommended to apply gate bias voltages before drain bias voltages, however, it is not necessary to absolutely guarantee this sequence. This device is robust and will survive drain voltages being applied before gate voltages.

1 Operation under the Supplemental Specifications may cause permanent damage to the device. These are stress ratings only, and functional operation of the device at these or any other conditions beyond those indicated in the Operating Specifications is not implied. Prolonged use at the absolute maximum rating conditions may affect device reliability.

Physical Dimensions and Pin Assignment

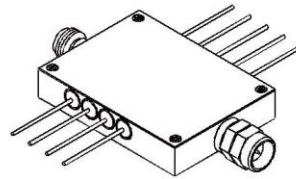
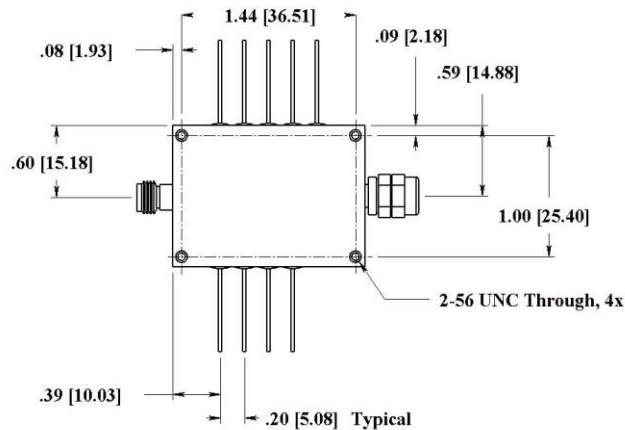

Physical Characteristics

(all measurements in inches[mm])

Tolerance typically
+/- 0.0025in
(+/- 0.0635mm)

DC pin diameter is
0.03in [0.76mm]

Note: physical dimensions drawing is shown with option 263 (male output V-connector). Standard product is female input V-connector and female output V-connector.

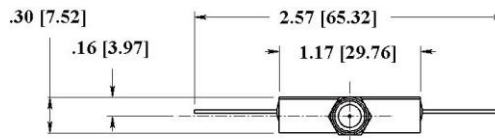
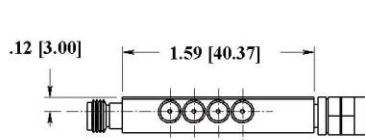

Pin	Function	Operational Notes
RFin	RF input	V-connector (female)
RFout	RF output	V-connector (female)
Vg1	1st stage gate bias	Set at typical operating specification
Vg2	2nd stage gate bias	Set at typical operating specification
Vg3	3rd stage gate bias	Set at typical operating specification
Vd1	1st stage drain bias	Set at typical operating specification
Vd2	2nd stage drain bias	Set at typical operating specification
Vd3	3rd stage drain bias	Set at typical operating specification
Ref	DC reference offset (optional)	Remove this offset from the detector voltage (see appnote MM-AAP-004)
Det	RF power detector (optional)	Remove the DC offset from this signal and linearize (see appnote MM-AAP-004)
Gnd	Connected	Connected to Ground

Information contained in this document is proprietary to Microsemi. This document may not be modified in any way without the express written consent of Microsemi. Product processing does not necessarily include testing of all parameters. Microsemi reserves the right to change the configuration and performance of the product and to discontinue product at any time.

Microsemi Corporate Headquarters

One Enterprise, Aliso Viejo CA 92656 USA
Within the USA: +1 (949) 380-6100
Sales: +1 (949) 380-6136
Fax: +1 (949) 215-4996

Microsemi Corporation (Nasdaq: MSCC) offers a comprehensive portfolio of semiconductor and system solutions for communications, defense and security, aerospace, and industrial markets. Products include high-performance and radiation-hardened analog mixed-signal integrated circuits, FPGAs, SoCs, and ASICs; power management products; timing and synchronization devices and precise time solutions, setting the world's standard for time; voice processing devices; RF solutions; discrete components; security technologies and scalable anti-tamper products; Power-over-Ethernet ICs and midspans; as well as custom design capabilities and services. Microsemi is headquartered in Aliso Viejo, Calif. and has approximately 3,400 employees globally. Learn more at www.microsemi.com.

© 2014 Microsemi Corporation. All rights reserved. Microsemi and the Microsemi logo are trademarks of Microsemi Corporation. All other trademarks and service marks are the property of their respective owners.