

PRODUCT NUMBER	PITCH
YK222xx0x0J0G	6.35 mm

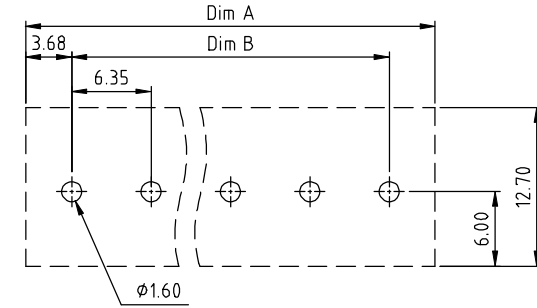

RECOMMENDED P.C.B LAYOUT
TOP VIEW

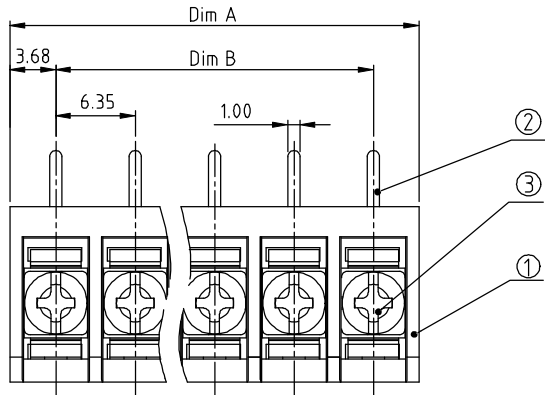
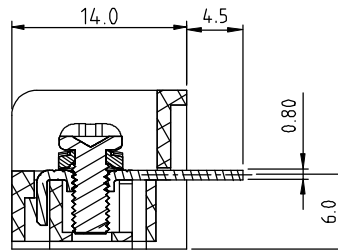
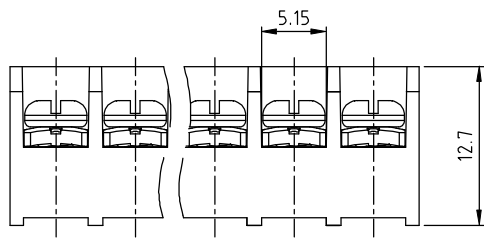

MATERIALS & ELECTRICAL

	cULus	CQC
RATED VOLTAGE & CURRENT:	250 V, 10 A	/ 250 V, 9 A
WITHSTAND VOLTAGE:	AC 2000 V/Min	
INSULATION RESISTANCE:	1000 M Ω OR MORE AT DC 500 V	
OPERATING TEMPERATURE RANG:	-40 °C ~ +115 °C	
SCREW TORQUE VALUE:	5.3 Lb-In.	
WIRE RANGE:	22 - 18 AWG	
1) HOUSING:	Thermoplastic, UL 94 V-0 BLACK	
2) TERMINAL:	BRASS, 0.8t	
3) TERMINAL SCREWS:	STEEL, M3	

APPROVAL:

DIMENSION

Dim A	Nx6.35+1.0
Dim B	(N-1)x6.35

N=Number of poles

Poles	Tolerance
2p-5p	± 0.20
6p-10p	± 0.25
11p-16p	± 0.35
17p-24p	± 0.40
25p-31p	± 0.50

PART NO.: YK 222xx 0 x 0 JOG

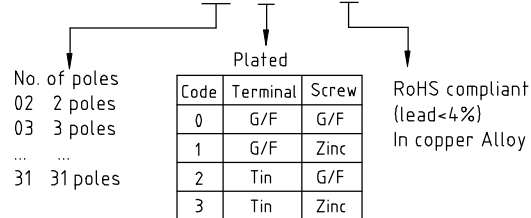

mat'l. code		surface ASME Y14.5	tolerance ASME Y14.5	projection 	product family TERMINAL BLOCK
ltr	ecn no	dr	date	tolerances unless otherwise specified	title TERMINAL BLOCK
				angles X ± 0.5	BARRIER TYPE
				flatness X.X ± 0.3	scale MM
				total run out X.XX ± 0.1	FCI logo
		dr	EVAN LU	061614	dwg no
		enr	EVAN LU	061614	sheet 1 of 1
		chr	HANKE FENG	061614	size A4
		appd	SHI JUN	061614	YK222xx0x0J0G
					type CUSTOMER Drawing
sheet index	revision sheet	A	1		