

THIS DRAWING IS UNPUBLISHED. RELEASED FOR PUBLICATION
 © COPYRIGHT 19 BY AMP INCORPORATED. ALL INTERNATIONAL RIGHTS RESERVED.

| LOC | DIST | P | F | ZONE | LTR | DESCRIPTION | DATE | APPD |
|-----|------|---|---|------|-----|---------------------------|------------|------|
| BD | 48 | | | | C | REDRAWN | 7/11/90 | - |
| | | | | | C1 | ADDED -5 PER NPR 4841 | 07/09/93 | MW |
| | | | | | D | REV PER EC 0020-881-95 | 25 AUG 95 | JS |
| | | | | | E | OBS -5 PER EC 0420-141-96 | 23 SEPT 97 | SB |

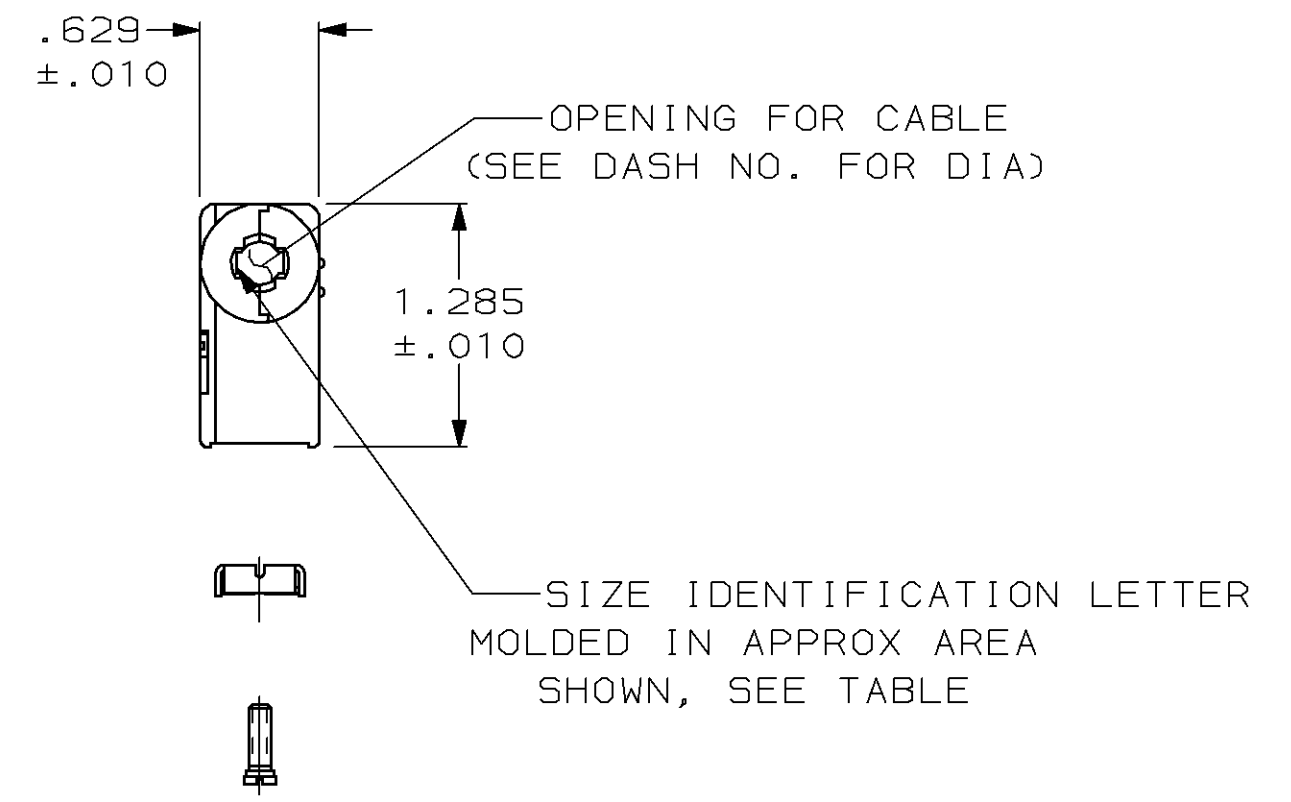
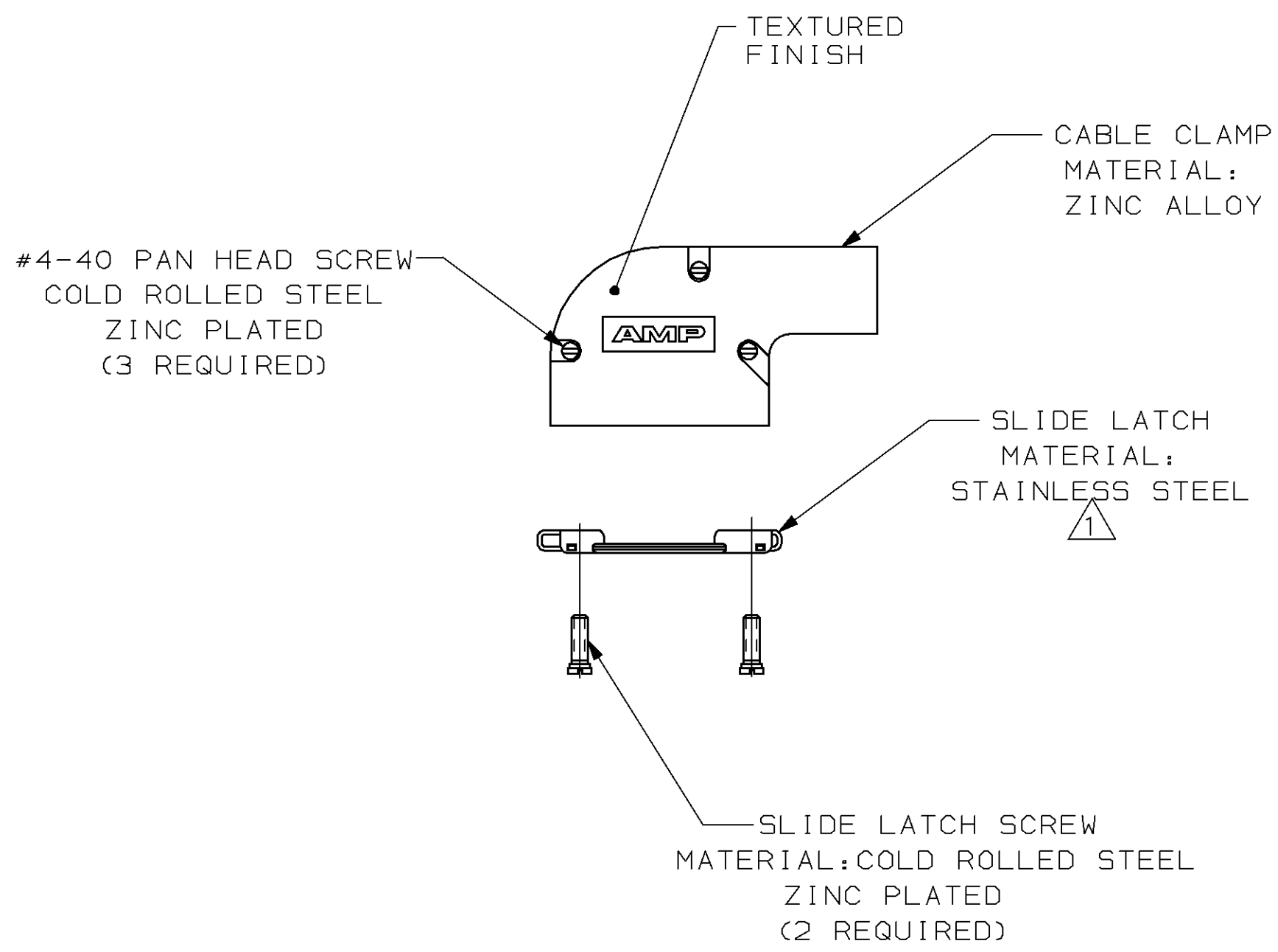
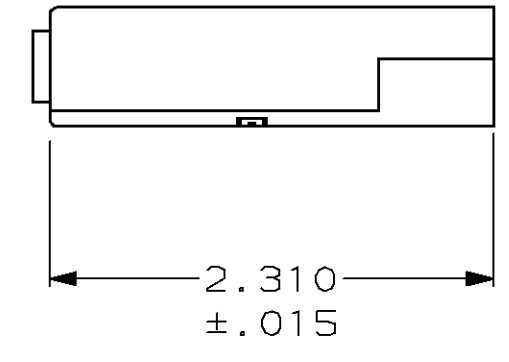

| OBSOLETE | SMALL PACK | K | PLATED NICKEL OVER COPPER | .430 | 745652-5 |
|----------|------------|------------|---------------------------|-----------|----------|
| | STANDARD | B | | .225 | 745652-4 |
| | STANDARD | E | | .300 | 745652-3 |
| | STANDARD | H | | .375 | 745652-2 |
| | STANDARD | K | | .430 | 745652-1 |
| | PACKAGING | NECK IDENT | REMARKS | CABLE DIA | PART NO. |

- 1 KIT INCLUDES SLIDE LATCH & SCREWS.
- 2. ALL PARTS PACKAGED UNASSEMBLED.

| | | | | | |
|--|--|---|------------------|----------------------|--|
| DO NOT SCALE PRINT. UNLESS SPECIFIED DIMENSIONS IN INCHES TOLERANCES ON : 2 PLC DEC ± - 3 PLC DEC ± .005 ANGLES ± - | DR 7-10-90 A.STAUB BG CHK 9-10-90 J.McCLINTON APPD 9-11-90 B.TAYLOR | AMP AMP INCORPORATED Harrisburg, Pa. 17105 | | | |
| MATERIAL SEE CALLOUTS | APPD 9-11-90 J.ASSINI PRODUCT SPEC - | NAME CABLE CLAMP KIT, SIZE 2, 15 POSITION, 90°, AMPLIMITE™ SERIES | | | |
| FINISH SEE CALLOUTS | APPLICATION SPEC - | SIZE C | FSCM NO 00779 | DRAWING NO 745652 | |
| | WEIGHT - | SCALE 1:1 | | SHEET 1 OF 1 | |