

THIS DRAWING IS UNPUBLISHED. RELEASED FOR PUBLICATION
 © COPYRIGHT - By - ALL RIGHTS RESERVED.

LOC		DIST		REVISIONS			
P	LTR	DESCRIPTION		DATE	DWN	APVD	
	K	REV PER ECO 14-017813		11-25-14	CT	RG	

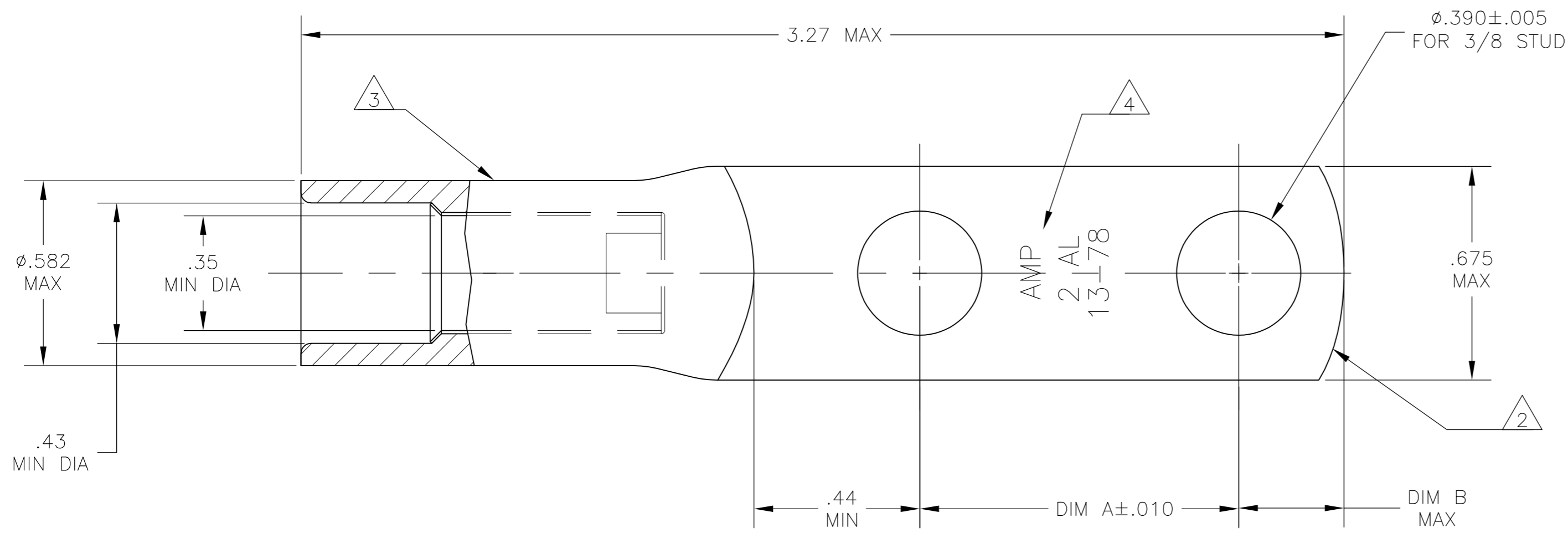

- 1 WIRE INSULATION: .381-417 DIA
- 2 THE TONGUE RADIUS FEATURE IS NOT A TOOLING CONTROLLED DIMENSION AND MAY NOT BE A TRUE RADIUS.
- 3 IMPACT FLASH PERMITTED .020 MAX
- 4 STAMP "AMP 2 AL 13-78" SIZE AND LOCATION APPROX AS SHOWN
- 5 BODY: COPPER ASTM-B187 ANNEALED TIN PL PER ASTM B-545 .000150 MIN THK
 INSERT & FUNNEL: BRASS PER ASTM B36 NICKEL PLATE SAE AMS QQ-N-290A, DATED JULY 2000, .000100 MIN THK

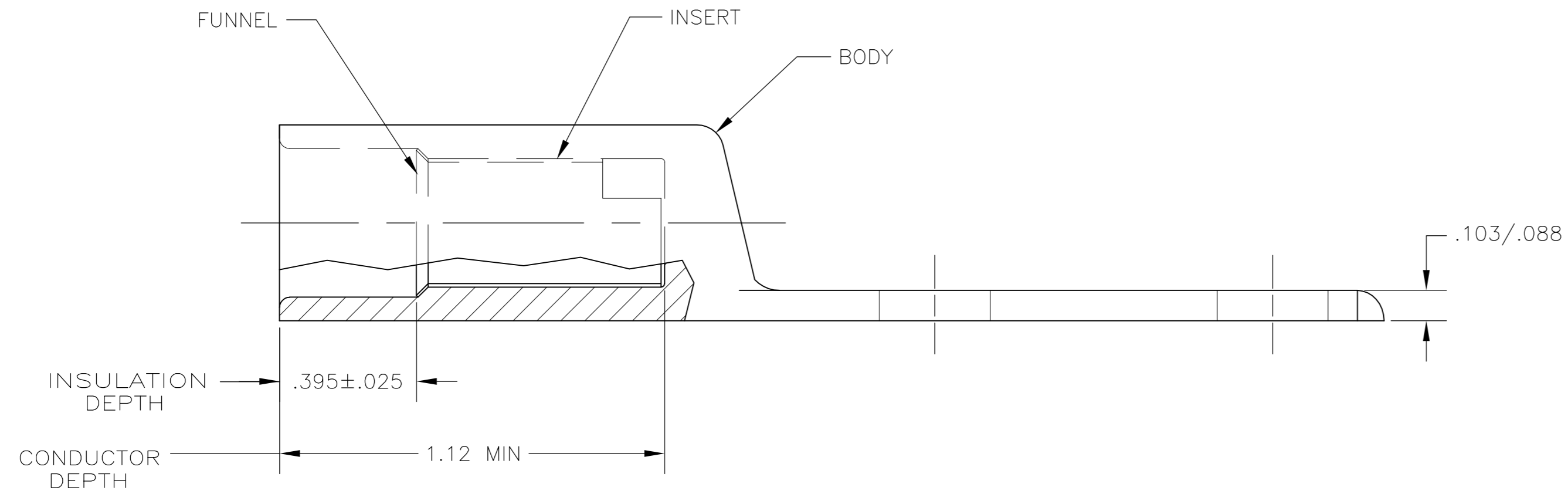

.590	.790	5	696890-3
.485	.895	5	696890-2
.380	1.000	5	696890-1
DIM B	DIM A	MATERIAL & FINISH	PART NO.

THIS DRAWING IS A CONTROLLED DOCUMENT.		DWN	JR RUTH	13OCT05	TE TE Connectivity																				
DIMENSIONS: INCHES		CHK	MJ SPICER	13OCT05																					
TOLERANCES UNLESS OTHERWISE SPECIFIED:		APVD	MJ SPICER	13OCT05																					
<table border="1"> <tr><td>0 PLC</td><td>±</td><td>-</td></tr> <tr><td>1 PLC</td><td>±</td><td>-</td></tr> <tr><td>2 PLC</td><td>±</td><td>-</td></tr> <tr><td>3 PLC</td><td>±</td><td>.008</td></tr> <tr><td>4 PLC</td><td>±</td><td>-</td></tr> <tr><td>ANGLES</td><td>±</td><td>-</td></tr> <tr><td>FINISH</td><td>±</td><td>-</td></tr> </table>		0 PLC	±	-		1 PLC	±	-	2 PLC	±	-	3 PLC	±	.008	4 PLC	±	-	ANGLES	±	-	FINISH	±	-	PRODUCT SPEC	NAME
0 PLC	±	-																							
1 PLC	±	-																							
2 PLC	±	-																							
3 PLC	±	.008																							
4 PLC	±	-																							
ANGLES	±	-																							
FINISH	±	-																							
MATERIAL	SEE TABLE	APPLICATION SPEC	-		SIZE	CAGE CODE	DRAWING NO	RESTRICTED TO																	
SEE TABLE		WEIGHT	43 GRAMS	A2	00779	C=696890	-																		
SEE TABLE		CUSTOMER DRAWING	SCALE	3:1	SHEET	1 of 1	REV	K																	