

RECOMMENDED PCB LAYOUT

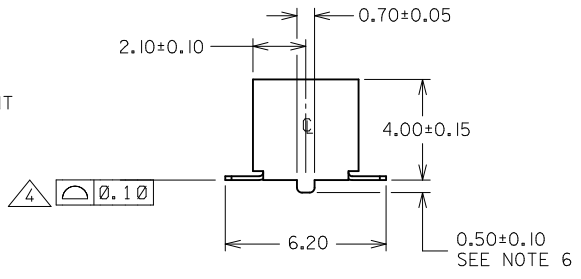

PART NUMBER	CKT. SIZE	DIM A	DIM B
8738 I-06**	6	4.00	6.00
8738 I-08**	8	6.00	8.00
8738 I-10**	10	8.00	10.00
8738 I-12**	12	10.00	12.00
8738 I-14**	14	12.00	14.00
8738 I-16**	16	14.00	16.00
8738 I-18**	18	16.00	18.00
8738 I-20**	20	18.00	20.00
8738 I-22**	22	20.00	22.00
8738 I-24**	24	22.00	24.00
8738 I-26**	26	24.00	26.00
8738 I-28**	28	26.00	28.00
8738 I-30**	30	28.00	30.00
8738 I-32**	32	30.00	32.00
8738 I-34**	34	32.00	34.00
8738 I-36**	36	34.00	36.00
8738 I-38**	38	36.00	38.00
8738 I-40**	40	38.00	40.00
8738 I-42**	42	40.00	42.00
8738 I-44**	44	42.00	44.00
8738 I-46**	46	44.00	46.00
8738 I-48**	48	46.00	48.00
8738 I-50**	50	48.00	50.00

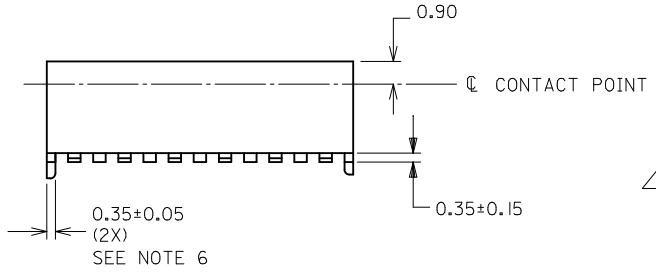
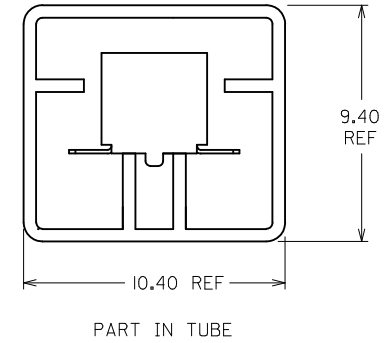

NOTES:

- PLATING FINISH :  
GOLD PLATING OPTION IN CONTACT AREA (SEE SHT 2)  
TIN IN SOLDER TAIL AREA  
BOTH OVER 1.27um MIN NICKEL OVERALL
- 12 CKT SIZE SHOWN FOR ILLUSTRATION ONLY. SEE CHART FOR ALL AVAILABLE PART SIZES
- PRODUCT SPECIFICATION PS-87380 APPLIES  
COPLANARITY OF SOLDER TAILS ARE TO BE MEASURED BY RESTING THE PART ON A FLAT GAUGE SURFACE  
↑+0.05 UPWARDS AND ↓-0.05 DOWNWARDS
- OTHER PLATING OPTIONS AVAILABLE. PLEASE CONTACT FACTORY
- PEG AND PCB HOLE OPTIONAL. SEE PART LEGEND FOR PART CONFIGURATON
- PARTS SHALL BE PACKED IN MOISTURE BARRIER BAG.

REVISE NOTE 4.  
EC NO: S2012-0026  
DRWN:SKANG  
CHKD:ATSEE  
APPR:MLONG

REV	DESCRIPTION
1	QUALITY SYMBOLS
2	QUALITY SYMBOLS
3	QUALITY SYMBOLS

GENERAL TOLERANCES (UNLESS SPECIFIED)	
	ANGULAR ± 3 °
4 PLACES	± ---
3 PLACES	± ---
2 PLACES	± 0.10
1 PLACE	± ---

DIMENSION STYLE	
MM ONLY	
DRAWN BY	TAY
DATE	1993/01/21
CHECKED BY	SKTOH
DATE	1993/01/26
APPROVED BY	RWONG
DATE	1993/01/27
MATERIAL NO.	SEE TABLE

SCALE	DESIGN UNITS	THIRD ANGLE PROJECTION
NTS	METRIC	THIRD ANGLE PROJECTION
TITLE		
MGRID 4MM HT., WITH LOC. PEG		
MOLEX INCORPORATED		
DOCUMENT NO.	SD-87381-****	SHEET NO. 1 OF 2
DRAFT WHERE APPLICABLE MUST REMAIN WITHIN DIMENSIONS		
SIZE	THIS DRAWING CONTAINS INFORMATION THAT IS PROPRIETARY TO MOLEX INCORPORATED AND SHOULD NOT BE USED WITHOUT WRITTEN PERMISSION	

PLATING OPTION			
PEG OPTION	0.05um MIN GOLD 1.90um MIN TIN	0.76um MIN GOLD 1.27um MIN TIN	0.38um MIN GOLD 1.27um MIN TIN
NO	**37	**07	**08
YES	**38	**17	**18

PART NUMBER LEGEND

87381 - \*\*\*\*

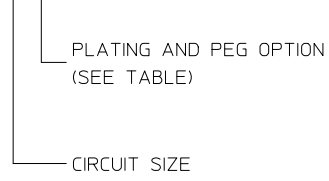

<b>REVISE NOTE 4.</b> EC NO: S2012-0026 DRWN:SKANG 2011/07/29 CHKD:ATSEE 2011/08/03 APPR:MLONG 2011/08/03	QUALITY SYMBOLS	GENERAL TOLERANCES (UNLESS SPECIFIED)		DIMENSION STYLE	SCALE	DESIGN UNITS	THIRD ANGLE PROJECTION		
	$F_A=0$	mm	INCH	MM ONLY	NTS	METRIC			
	$F_C=0$	4 PLACES ± ---	± ---	DRAWN BY	DATE	TITLE			
	$F_P=0$	3 PLACES ± ---	± ---	TAY	1993/01/21	MGRID 4MM HT., WITH LOC. PEG			
	2 PLACES ± 0.10	± ---	CHECKED BY	DATE					
	1 PLACE ± ---	± ---	SKTOH	1993/01/26	MOLEX INCORPORATED				
	ANGULAR ± 3 °		APPROVED BY	DATE					
	DRAFT WHERE APPLICABLE MUST REMAIN WITHIN DIMENSIONS		RWONG	1993/01/27	MATERIAL NO.	DOCUMENT NO.	SHEET NO.		
F2			SEE TABLE		SD-87381-****		2 OF 2		
			SIZE A3		THIS DRAWING CONTAINS INFORMATION THAT IS PROPRIETARY TO MOLEX INCORPORATED AND SHOULD NOT BE USED WITHOUT WRITTEN PERMISSION				