

UNLESS OTHERWISE NOTED
 DIMENSIONS ARE IN INCHES TOLERANCES ARE:
 ONE PLACE DECIMALS: ± .1 [3] THREE PLACE DECIMALS: ± .005 [.13]
 TWO PLACE DECIMALS: ± .01 [.3] FOUR PLACE DECIMALS: ± .0020 [.051] ANGLES ± 2°

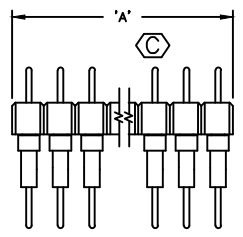
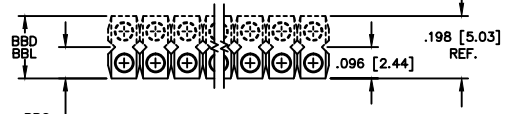
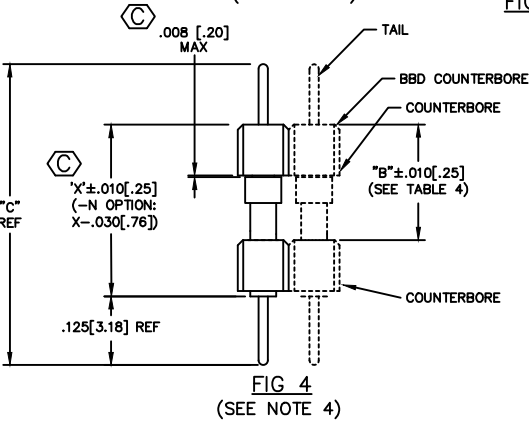
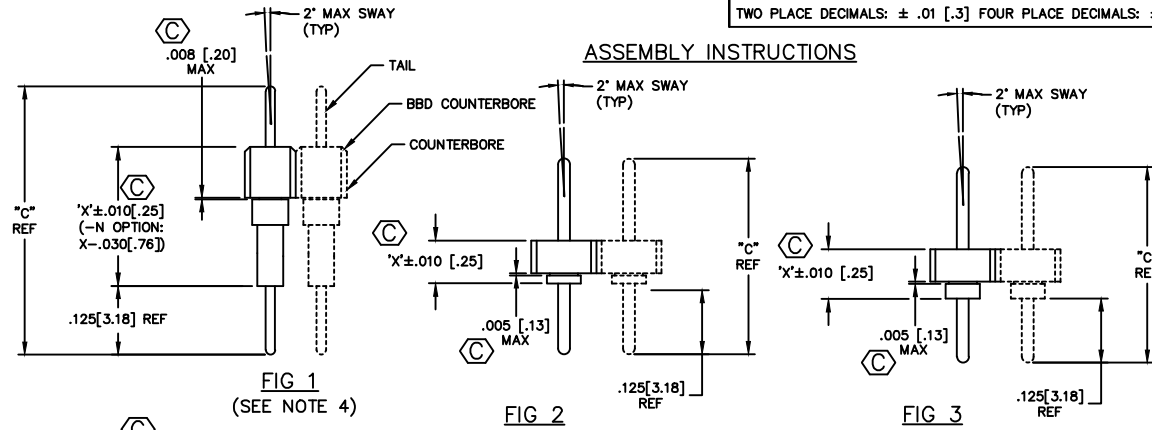

TABLE 5

BODY SPEC.	"A"
BBS, BBL	
BBD, BHS, BDL	

BXX-1XX-X-X-X

OPTION
 -N NON-FLUSH-LEAVE BLANK FOR STANDARD (USE BODY SPECIFIED IN TABLE 1) (SEE TABLE 4)
 TERMINAL SPECIFICATION (SEE TABLE 2)
 PLATING SPECIFICATION (SEE TABLE 2)
 -G: SPECIFY -G IN TERMINAL SUFFIX -X
 *T: SPECIFY -T IN TERMINAL SUFFIX -X
 **=INVALID WITH D & G TERMINAL SPEC

BODY SPECIFICATION (SEE TABLE 1)
 BODY STYLE
 BBS: SINGLE
 BBD: DOUBLE
 BBL: SINGLE, LOW PROFILE
 BDL: DOUBLE, LOW PROFILE
 BHS: SINGLE, HI-TEMP
 FOR ALL PLATING STYLES OTHER THAN -G PLATING

BODY LENGTH SPECIFICATION
 'A'=BBS: XX-MAX 32 POSITION
 'A'=BBL: XX-MAX 32 POSITION
 'A'=BHS: XX-MAX 36 POSITION (MUST BE CUT ON MULTI-CUTTER)
 'A'=BDL: XX-MAX 36 POSITION
 'A'=BBL: XX-MAX 36 POSITION

- NOTES:
- 1.) MIN PUSHOUT FORCE: 5 lbs FOR ALL EXCEPT BBL, FOR BBL: 2 lbs. MIN.
 - 2.) MAX ALLOWABLE BOW: .009 IN/IN TOP TO BOTTOM
 BBL: .020 IN/IN TOP TO BOTTOM
 - 3.) Ⓞ REPRESENTS A CRITICAL DIMENSION.
 - 4.) ON BBD STYLE FILL WITH COUNTERBORE TOWARD TAILS, ALL OTHER STYLES FILL COUNTERBORE AWAY FROM TAILS.
 - 5.) .005 MAX CUT FLASH, .012 MAX FLASH AT BREAK-OFF BAR LOCATION.

PACKAGING

TABLE 3
 (4 POSITION MIN)

BODY	LEAD STYLE	PACKAGING TUBE	PLUG
BHS	A	PT-1-24-01-24	TP-24
	B	PT-1-24-02-03	TP-24
	D	PT-1-24-02-04	TP-33
	C,G	PT-1-24-10-03	TP-33
BBS	A	PT-1-24-01-24	TP-24
	B	PT-1-24-02-03	TP-24
	D	PT-1-24-02-04	TP-33
	C,G	PT-1-24-10-03	TP-33
BBD	A	PT-1-24-01-22	TP-03
	B	PT-1-24-06-03	TP-07
	D	PT-1-24-08-03	TP-09
	C,G	PT-1-24-01-74	TP-07
BBL	A,B,C,D,G	PT-1-24-01-23	TP-12
	E, F	PT-SFM002-X2-S	TP-12
BDL	ALL	PT-1-24-01-14	TP-03

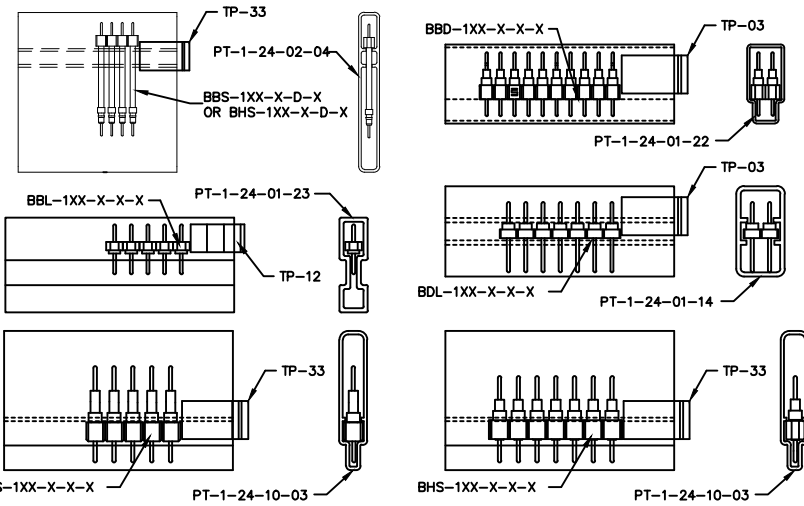

TABLE 4

TERMINAL SPEC.	"B"
-G	.320 [8.13]
-G-N	.290 [7.37]
-N	.410 [10.41]

TABLE 1

BODY STYLE	BODY SPECIFICATION	
	STANDARD	-N OPTION
BBS-	TBS-32	SSB-XX
BBD-	DSB-36	DSB-XX
BBL-	SSL-XX	N/A
BDL-	HSDL-XX	N/A
BHS-G (PLATING)	HTS-36-G	SSB-XX-U
BHS-T (PLATING)	HTS-36-L	SSB-XX-U

TABLE 2

TERMINAL SPECIFICATIONS

LEAD STYLE	BODY SPEC.		FIG	"C"	BODY SPEC.		FIG	"C"
	BBS,BBD,BHS	'X'			BBL,BDL	'X'		
A	T-1R14-1-X	.210 [5.35]	1	.460 [11.68]	N/A			
B	T-1R14-2-X	.335 [8.51]		.585 [14.86]	N/A			
C	T-1R14-3-X	.585 [14.86]		.835 [21.21]	N/A			
D	T-1R14-4-X	.835 [21.21]		1.085 [27.56]	N/A			
E	N/A				T-1R6-X	.070	2	.300 [7.62]
F	N/A				T-2R6-X	.085	3	.332 [8.43]
* G	T-1R14-5-X	.585 [14.86]	4	.835 [21.21]	N/A			

* = SEE NOTE 4

PROPRIETARY NOTE
 THE INFORMATION CONTAINED HEREIN IS THE PROPERTY OF SAMTEC CORPORATION AND IS UNCLASSIFIED EXCEPT WHERE SHOWN OTHERWISE. IT IS TO BE KEPT CONFIDENTIAL AND NOT TO BE DISCLOSED TO ANY OTHER PARTY WITHOUT THE WRITTEN PERMISSION OF SAMTEC, INC.

MATERIAL:
 INSULATOR:
 GLASS FILLED POLYESTER
 COLOR: BLACK
 TERMINAL:
 PHOSPHOR BRONZE OR BRASS

520 PARK EAST BLVD. NEW ALBANY, INDIANA 47150
 PHONE (812) 944-6733, P.O. BOX 1147
 CODE 55322

samtec