

Type DSF Polyester Capacitors

Stacked Metallized Radial Leads

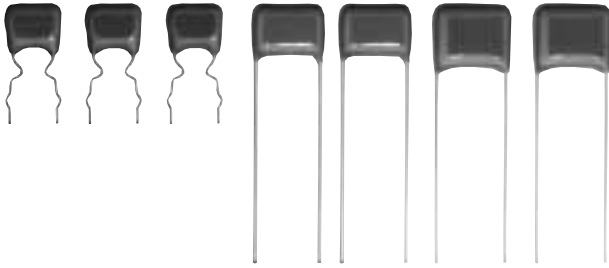

Subminiature Size

Type DSF film capacitors are made with stacked metallized polyester, resulting in high volumetric efficiency and a very economical solution for general purpose DC applications. Ideally suited for blocking, by-pass, coupling, decoupling, and filtering circuits. Specifically designed for applications where high density insertion of components is required. Ammo box style or reel taping available.

Specifications

Voltage Range: 50-100 Vdc (63 Vdc Optional)

Capacitance Range: .010-2.2 μ F

Capacitance Tolerance: \pm 5% (J) standard

Operating Temperature Range: -40 to + 85°C

Full rated voltage at 85°C-Derate linearly to 50% - rated voltage at 125°C

Dielectric Strength: Rated Vdc x 150 %, 60 sec.

Dissipation Factor: 1% max (25°C, 1 kHz)

Insulation Resistance: C \leq 0.33 μ F : 3000M Ω min.

C > 0.33 μ F : 1000M Ω · μ F min.

Life Test: 1000 h @ 85 °C, 125% rated voltage

| Pulse Capability | | |
|-----------------------------------|------------------|------|
| Rated Volts | Body Length (mm) | |
| | 7.3, 7.5 | 10.2 |
| dV/dt volts per microsecond, max. | | |
| 50 | 32 - 37 | 12 |
| 100 | 55 | 43 |

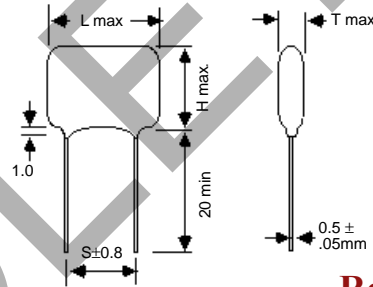

| Lead Spacing | |
|--------------|-----|
| L | S |
| <10 | 5.0 |
| \geq 10 | 7.5 |

Ratings and Dimensions

RoHS Compliant

| Cap. (μ F) | Catalog Part Number | T Inches(mm) | H Inches(mm) | L Inches(mm) | S Inches(mm) |
|--------------------|------------------------|-----------------|-----------------|-----------------|-----------------|
| 50 Vdc | | | | | |
| 0.010 | DSF050J103 | 0.126 (3.2) | 0.197 (5.0) | 0.287 (7.3) | 0.197 (5.0) |
| 0.012 | DSF050J123 | 0.126 (3.2) | 0.197 (5.0) | 0.287 (7.3) | 0.197 (5.0) |
| 0.015 | DSF050J153 | 0.126 (3.2) | 0.197 (5.0) | 0.287 (7.3) | 0.197 (5.0) |
| 0.018 | DSF050J183 | 0.126 (3.2) | 0.197 (5.0) | 0.287 (7.3) | 0.197 (5.0) |
| 0.022 | DSF050J223 | 0.126 (3.2) | 0.197 (5.0) | 0.287 (7.3) | 0.197 (5.0) |
| 0.027 | DSF050J273 | 0.126 (3.2) | 0.197 (5.0) | 0.287 (7.3) | 0.197 (5.0) |
| 0.033 | DSF050J333 | 0.126 (3.2) | 0.197 (5.0) | 0.287 (7.3) | 0.197 (5.0) |
| 0.039 | DSF050J393 | 0.126 (3.2) | 0.197 (5.0) | 0.287 (7.3) | 0.197 (5.0) |
| 0.047 | DSF050J473 | 0.126 (3.2) | 0.197 (5.0) | 0.287 (7.3) | 0.197 (5.0) |
| 0.056 | DSF050J563 | 0.126 (3.2) | 0.197 (5.0) | 0.287 (7.3) | 0.197 (5.0) |
| 0.068 | DSF050J683 | 0.126 (3.2) | 0.197 (5.0) | 0.287 (7.3) | 0.197 (5.0) |
| 0.082 | DSF050J823 | 0.142 (3.6) | 0.197 (5.0) | 0.287 (7.3) | 0.197 (5.0) |
| 0.100 | DSF050J104 | 0.157 (4.0) | 0.197 (5.0) | 0.287 (7.3) | 0.197 (5.0) |
| 0.120 | DSF050J124 | 0.157 (4.0) | 0.197 (5.0) | 0.287 (7.3) | 0.197 (5.0) |
| 0.150 | DSF050J154 | 0.173 (4.4) | 0.217 (5.5) | 0.287 (7.3) | 0.197 (5.0) |
| 0.180 | DSF050J184 | 0.177 (4.5) | 0.217 (5.5) | 0.287 (7.3) | 0.197 (5.0) |
| 0.220 | DSF050J224 | 0.189 (4.8) | 0.217 (5.5) | 0.287 (7.3) | 0.197 (5.0) |
| 0.270 | DSF050J274 | 0.181 (4.6) | 0.276 (7.0) | 0.287 (7.3) | 0.197 (5.0) |
| 0.330 | DSF050J334 | 0.205 (5.2) | 0.276 (7.0) | 0.287 (7.3) | 0.197 (5.0) |
| 0.390 | DSF050J394 | 0.224 (5.7) | 0.287 (7.3) | 0.287 (7.3) | 0.197 (5.0) |
| 0.470 | DSF050J474 | 0.236 (6.0) | 0.287 (7.3) | 0.287 (7.3) | 0.197 (5.0) |
| 0.560 | DSF050J564 | 0.228 (5.8) | 0.394 (10.0) | 0.287 (7.3) | 0.197 (5.0) |
| 0.680 | DSF050J684 | 0.256 (6.5) | 0.394 (10.0) | 0.287 (7.3) | 0.197 (5.0) |
| 0.820 | DSF050J824 | 0.268 (6.8) | 0.394 (10.0) | 0.287 (7.3) | 0.197 (5.0) |
| 1.000 | DSF050J105 | 0.315 (8.0) | 0.433 (11.0) | 0.287 (7.3) | 0.197 (5.0) |

| Cap. (μ F) | Catalog Part Number | T Inches(mm) | H In. (mm) | L Inches(mm) | S Inches(mm) |
|--------------------|------------------------|-----------------|---------------|-----------------|-----------------|
| 1.200 | DSF050J125 | 0.256 (6.5) | 0.394 (10.0) | 0.402 (10.2) | 0.295 (7.5) |
| 1.500 | DSF050J155 | 0.283 (7.2) | 0.394 (10.0) | 0.402 (10.2) | 0.295 (7.5) |
| 1.800 | DSF050J185 | 0.283 (7.2) | 0.472 (12.0) | 0.402 (10.2) | 0.295 (7.5) |
| 2.200 | DSF050J225 | 0.311 (7.9) | 0.472 (12.0) | 0.402 (10.2) | 0.295 (7.5) |
| 100 Vdc | | | | | |
| 0.010 | DSF100J103 | 0.126 (3.2) | 0.276 (7.0) | 0.295 (7.5) | 0.197 (5.0) |
| 0.012 | DSF100J123 | 0.126 (3.2) | 0.276 (7.0) | 0.295 (7.5) | 0.197 (5.0) |
| 0.015 | DSF100J153 | 0.126 (3.2) | 0.276 (7.0) | 0.295 (7.5) | 0.197 (5.0) |
| 0.018 | DSF100J183 | 0.126 (3.2) | 0.276 (7.0) | 0.295 (7.5) | 0.197 (5.0) |
| 0.022 | DSF100J223 | 0.126 (3.2) | 0.276 (7.0) | 0.295 (7.5) | 0.197 (5.0) |
| 0.027 | DSF100J273 | 0.126 (3.2) | 0.276 (7.0) | 0.295 (7.5) | 0.197 (5.0) |
| 0.033 | DSF100J333 | 0.126 (3.2) | 0.276 (7.0) | 0.295 (7.5) | 0.197 (5.0) |
| 0.039 | DSF100J393 | 0.126 (3.2) | 0.276 (7.0) | 0.295 (7.5) | 0.197 (5.0) |
| 0.047 | DSF100J473 | 0.126 (3.2) | 0.276 (7.0) | 0.295 (7.5) | 0.197 (5.0) |
| 0.056 | DSF100J563 | 0.126 (3.2) | 0.276 (7.0) | 0.295 (7.5) | 0.197 (5.0) |
| 0.068 | DSF100J683 | 0.157 (4.0) | 0.276 (7.0) | 0.295 (7.5) | 0.197 (5.0) |
| 0.082 | DSF100J823 | 0.161 (4.1) | 0.276 (7.0) | 0.295 (7.5) | 0.197 (5.0) |
| 0.100 | DSF100J104 | 0.177 (4.5) | 0.276 (7.0) | 0.295 (7.5) | 0.197 (5.0) |
| 0.120 | DSF100J124 | 0.130 (3.3) | 0.354 (9.0) | 0.402 (10.2) | 0.295 (7.5) |
| 0.150 | DSF100J154 | 0.130 (3.3) | 0.354 (9.0) | 0.402 (10.2) | 0.295 (7.5) |
| 0.180 | DSF100J184 | 0.142 (3.6) | 0.354 (9.0) | 0.402 (10.2) | 0.295 (7.5) |
| 0.220 | DSF100J224 | 0.157 (4.0) | 0.354 (9.0) | 0.402 (10.2) | 0.295 (7.5) |
| 0.270 | DSF100J274 | 0.165 (4.2) | 0.354 (9.0) | 0.402 (10.2) | 0.295 (7.5) |
| 0.330 | DSF100J334 | 0.189 (4.8) | 0.394 (10.0) | 0.402 (10.2) | 0.295 (7.5) |
| 0.390 | DSF100J394 | 0.217 (5.5) | 0.394 (10.0) | 0.402 (10.2) | 0.295 (7.5) |
| 0.470 | DSF100J474 | 0.268 (6.8) | 0.413 (10.5) | 0.402 (10.2) | 0.295 (7.5) |

Type DSF Polyester Capacitors

DSF
Dipped
Stacked
Film
Type

050
Voltage
Code
050 = 50 Vdc
100 = 100 Vdc

J
Capacitance
Tolerance
J = ±5%

223
Nominal
Capacitance
(First two digits are significant
figures. Last digit is multiplier
to give cap in pF)
e.g. 223 = 22 X 10³ pF = .022 μF
104 = 10 X 10⁴ pF = .100 μF
155 = 15 X 10⁵ pF = 1.50 μF

C
Bulk and Ammo
Packaging Options
Blank = Straight lead, Bulk
C = Crimped, Bulk
CA = Crimped Lead, Ammo Pack
TA = Straight Lead, Ammo Pack

*Tape & Reel packaging available.
Contact us for detailed specs.*

Ammo Pack Options

Crimped Lead Ammo Pack Option (CA)

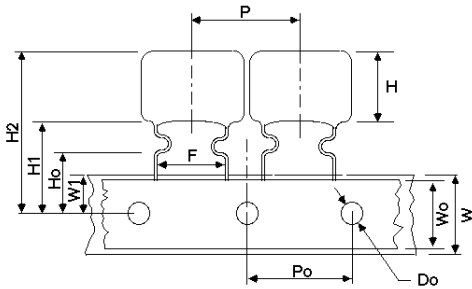

Straight Lead Ammo Pack Option (TA)

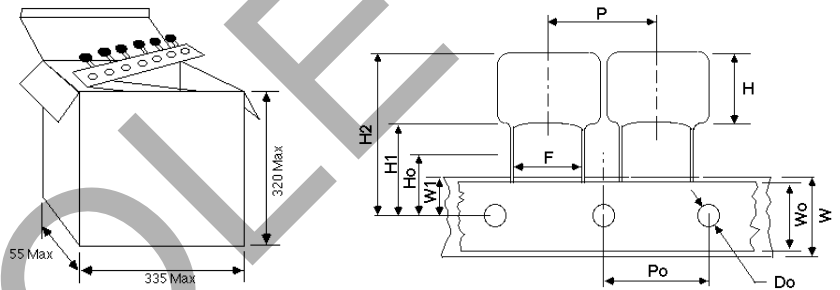

| PACKAGE QUANTITY FOR AMMO PACK CRIMPED LEAD OPTION (CA) & (CR) | | |
|---|-------------------|----------|
| WVDC | Capacitance Range | Quantity |
| 50 | 0.01 - 0.12 | 2000 |
| | 0.15 - 2.2 | 1000 |
| 100 | 0.01 - 0.068 | 2000 |
| | 0.082 - 0.1 | 1000 |
| | 0.12 - 0.22 | 2000 |
| | 0.27 - 0.47 | 1000 |

| PACKAGE QUANTITY FOR AMMO PACK STRAIGHT LEAD OPTION (TA) & (TR) | | |
|--|-------------------|----------|
| WVDC | Capacitance Range | Quantity |
| 50 | 0.01 - 0.12 | 2000 |
| | 0.15 to 1.0 | 1000 |
| 100 | 0.01 - 0.068 | 2000 |
| | 0.082 - 0.1 | 1000 |

Bulk Cut & Crimp Styles

Crimp style depends on capacitor length.

$L \leq 10.0$ mm

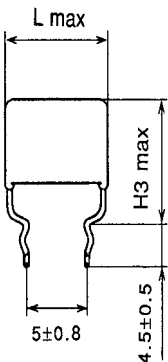

| WVDC | H3 max. (mm) |
|------|--------------|
| 50 | H+4.5 |
| 100 | H+5.0 |

$L > 10.0$ mm

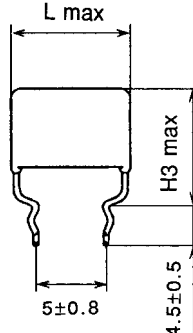

| AMMO PACK TAPING SPECIFICATIONS | | | |
|------------------------------------|--|--|--------------|
| | Dimensions for Crimped Option (CA) | Dimensions for Straight Lead Option (TA) | Tol. (mm) |
| Lead Spacing (F) | 5.0 | 5.0 | +8/-2 |
| Capacitor Pitch (P) | 12.7 | 12.7 | ±1 |
| Feed Hole Pitch (Po) | 12.7 | 12.7 | ±2 |
| Carrier Width (W) | 18.0 | 18.0 | ±5 |
| Feed Hole Position (W1) | 9.0 | 9.0 | ±5 |
| Height of Seating Plane (H1) | 20.0 | 20.0 | ±5 |
| Lead Wire Clinch Height (Ho) | 16.0 | --- | ±5 |
| Feed Hole Diameter (Do) | 4.0 | 4.0 | ±2 |
| Case Top to Feed Hole (H2) Max. | 20.5 + Hmax | 20.5 + Hmax | Max. |

Notice and Disclaimer: All product drawings, descriptions, specifications, statements, information and data (collectively, the "Information") in this datasheet or other publication are subject to change. The customer is responsible for checking, confirming and verifying the extent to which the Information contained in this datasheet or other publication is applicable to an order at the time the order is placed. All Information given herein is believed to be accurate and reliable, but it is presented without any guarantee, warranty, representation or responsibility of any kind, expressed or implied. Statements of suitability for certain applications are based on the knowledge that the Cornell Dubilier company providing such statements ("Cornell Dubilier") has of operating conditions that such Cornell Dubilier company regards as typical for such applications, but are not intended to constitute any guarantee, warranty or representation regarding any such matter – and Cornell Dubilier specifically and expressly disclaims any guarantee, warranty or representation concerning the suitability for a specific customer application, use, storage, transportation, or operating environment. The Information is intended for use only by customers who have the requisite experience and capability to determine the correct products for their application. Any technical advice inferred from this Information or otherwise provided by Cornell Dubilier with reference to the use of any Cornell Dubilier products is given gratis (unless otherwise specified by Cornell Dubilier), and Cornell Dubilier assumes no obligation or liability for the advice given or results obtained. Although Cornell Dubilier strives to apply the most stringent quality and safety standards regarding the design and manufacturing of its products, in light of the current state of the art, isolated component failures may still occur. Accordingly, customer applications which require a high degree of reliability or safety should employ suitable designs or other safeguards (such as installation of protective circuitry or redundancies or other appropriate protective measures) in order to ensure that the failure of an electrical component does not result in a risk of personal injury or property damage. Although all product-related warnings, cautions and notes must be observed, the customer should not assume that all safety measures are indicated in such warnings, cautions and notes, or that other safety measures may not be required.

OBSOLETE