

NOTES:

- ALL DIMENSIONS ARE IN  $\frac{\text{INCHES}}{\text{[MILLIMETERS]}}$
- DIMENSIONS APPEARING IN TABLE ARE AS FOLLOWS:
  - a - AS SUPPLIED
  - b - AFTER UNRESTRICTED RECOVERY

\*TOLERANCES FOR MARKED PARTS TO BE  $+0.002/-0.004$   
 $[+0,05/-0,10]$
- SERRATIONS TO MATE WITH SERRATIONS IN BOOTS AND TRANSITIONS.

REVISIONS		
LTR	DESCRIPTION	DATE
N	REVISED PER ECO-13-015722	10/07/13

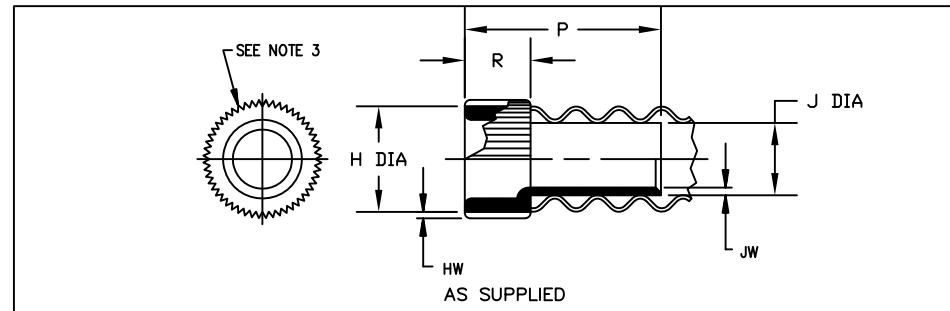

TABLE OF DIMENSIONS													
PART NUMBER	H +0.015 -0.005 [+0,38] [-0,13] a	J +0.005 -0.015 [+0,13] [-0,38] a	P ±0.02 [±0,51] a	R ±0.01 [±0,25] a	HW ±0.01 [±0,25] a	JW	PART NUMBER	H +0.015 -0.005 [+0,38] [-0,00] a	J +0.000 -0.015 [+0,00] [-0,38] a	P ±0.02 [±0,51] a	R ±0.01 [±0,25] a	HW ±0.01 [±0,25] a	JW
202B211	.329 [8,36]	.188 [4,78]	1.00 [25,4]	.50 [12,7]	.04 [1,0]	.016 $\pm 0.005$ [0,40 $\pm 0,13$ ]	202B261	.811 [20,6]	.610 [15,50]	1.00 [25,4]	.50 [12,7]	.04 [1,0]	.030 $\pm 0.010$ [0,76 $\pm 0,25$ ]
202B221	.421 [10,7]	.264* [6,70]	1.00 [25,4]	.50 [12,7]	.04 [1,0]	.016 $\pm 0.005$ [0,40 $\pm 0,13$ ]	202B272	.941 [23,9]	.721 [18,30]	1.00 [25,4]	.50 [12,7]	.04 [1,0]	.030 $\pm 0.010$ [0,76 $\pm 0,25$ ]
202B231	.524 [13,3]	.354* [9,00]	1.00 [25,4]	.50 [12,7]	.04 [1,0]	.016 $\pm 0.005$ [0,40 $\pm 0,13$ ]	202B282	1.087 [27,6]	.850* [21,60]	1.00 [25,4]	.50 [12,7]	.04 [1,0]	.030 $\pm 0.010$ [0,76 $\pm 0,25$ ]
202B241	.591 [15,0]	.431 [10,95]	1.00 [25,4]	.50 [12,7]	.04 [1,0]	.030 $\pm 0.010$ [0,76 $\pm 0,25$ ]	202B292	1.213 [30,8]	.978 [24,85]	1.00 [25,4]	.50 [12,7]	.04 [1,0]	.030 $\pm 0.010$ [0,76 $\pm 0,25$ ]
202B251	.658 [16,7]	.492* [12,50]	1.00 [25,4]	.50 [12,7]	.04 [1,0]	.032 $\pm 0.010$ [0,80 $\pm 0,25$ ]	202B302	1.532 [38,9]	1.177 [29,90]	1.00 [25,4]	.50 [12,7]	.04 [1,0]	.030 $\pm 0.010$ [0,76 $\pm 0,25$ ]

ORDERING INFORMATION

202B2XX -XXX -XX /XXX

BASE PART NUMBER \_\_\_\_\_

MATERIAL DASH NUMBER \_\_\_\_\_  
(SEE COMPATABILITY CHART)

MODIFICATION NUMBER \_\_\_\_\_  
(IF NECESSARY, SEE FRONT OF SCD BINDER FOR A COMPLETE LIST)

ADHESIVE SLASH NUMBER \_\_\_\_\_  
(IF NECESSARY, SEE COMPATABILITY CHART)

COMPATIBILITY CHART			
MATERIAL DASH NO.	MATERIAL DESCRIPTION	COATING SLASH NUMBER	COATING S NUMBER
-13	Nylon, Glass Filled		

IF THIS DOCUMENT IS PRINTED IT BECOMES UNCONTROLLED.  
CHECK FOR THE LATEST REVISION.

Raychem Molded Parts  
CUSTOMER DRAWING

UNLESS OTHERWISE SPECIFIED DIMENSIONS ARE INCHES. METRIC DIMENSIONS ARE IN BRACKETS. DECIMAL TOLERANCES .XXX ± 0.005 [0.13 mm] .XX ± 0.01 [0.25 mm] .X ± 0.1 [0.50 mm] ANGLE TOLERANCE .X ± 1 DEG.	DRAWN MMazariegos	TE Connectivity
	APPROVED SGravano	
TE CONNECTIVITY RESERVES THE RIGHT TO AMEND THIS DRAWING AT ANY TIME. USERS SHOULD EVALUATE THE SUITABILITY OF THE PRODUCT FOR THEIR APPLICATION.	THIRD ANGLE PROJECTION	TITLE SLEEVE, CONDUIT
© 2013 Tyco Electronics Corporation, a TE connectivity Ltd. company. All rights reserved.	SIZE B	CODE IDENT. NO. 06090
	DWG. NO. 202B211thru302	

DO NOT SCALE THIS DRAWING

SHEET 1 OF 1