

THIS COPY IS PROVIDED ON A RESTRICTED BASIS AND IS NOT TO BE USED IN ANY WAY DETRIMENTAL TO THE INTERESTS OF PANDUIT CORP.

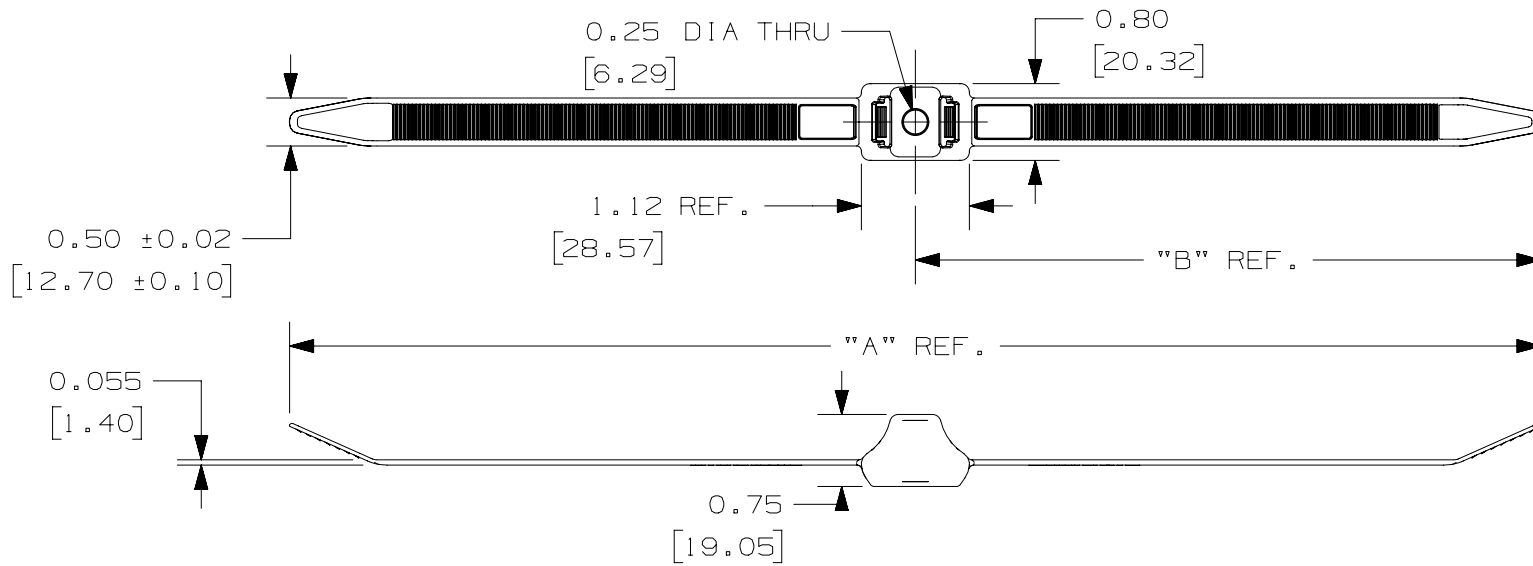

PANDUIT PART NO.	BUNDLE DIA.		"A"	"B"	MIN. LOOP TENSILE lbs. (N)	CROSS SECTION	TIP STYLE	WEIGHT lbs. (g) /100 pcs.
	MIN. in. (mm)	MAX. in. (mm)						
PLDC1.5EH	0.20 (5.1)	1.30 (33.0)	13.1 (333)	6.55 (166.4)	150 (667)	EXTRA HEAVY	CURVED	0.0226 (10.2)
PLDC2.5EH	0.20 (5.1)	2.30 (58)	19.2 (489)	9.63 (244.6)	150 (667)	EXTRA HEAVY	CURVED	0.0294 (13.3)

NOTES:
 * SEE www.panduit.com FOR PART NUMBER SUFFIX DESIGNATION FOR PACKAGE SIZE, PART MATERIAL, PART COLOR AND ANY THIRD PARTY RECOGNITION OR COMPLIANCE.

DIMENSIONS IN PARENTHESES ARE IN METRIC UNITS.

REV	DATE	BY	CHK	APR	DESCRIPTION	ECN	TITLE	ITEM REVISION NAME	DATASET FILE NAME	MATERIAL:	DRAWING NUMBER:
							DOUBLE CLAMP TIE			NYLON 6.6	
							CUSTOMER DRAWING	00071SBA/08	00071SBA_DC/08 00071SBA_REV00		
							UNLESS OTHERWISE SPECIFIED, DIMENSIONAL TOLERANCES ARE: IN (mm)	.xxx ± .020 (.51)	.xx ± .02 (.5)	ANGLES ±	
00	10/05/16	BWG	DJSL	JADE	DRAWING RELEASED.	010056/00	THIRD ANGLE PROJECTION				00071SBA_DC
							DRAWN BY: BWG	DATE: 5/05/16	CHK: DJSL	SCALE: NONE	SHT 1 OF 1