

Radial Lead Fuses

TE5® > Fast-Acting Fuse > 395 Series

395 Series, TE5® Fast-Acting Fuse

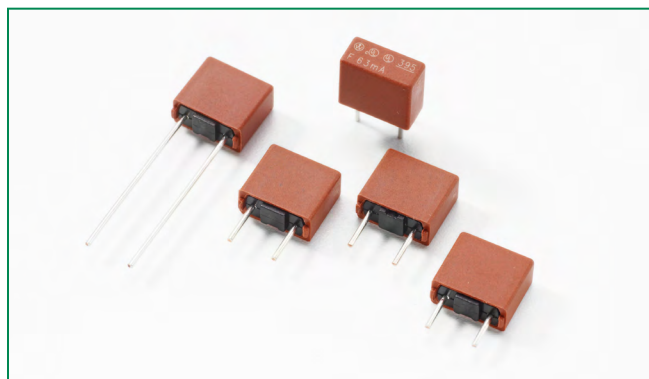

Agency Approvals

| Agency | Agency File Number | Ampere Range |
|--------|--------------------|--------------|
| | E67006 | 0.05A-6.3A |
| | E67006 | 0.05A-6.3A |
| | JET1896-31007-1005 | 1A - 5A |

Additional Information



Datasheet



Resources



Samples

Description

The 395 Series TE5® Fuses are fast-acting type, 125V and are designed in accordance to UL 248-14.

Features

- RoHS compliant and Lead-free
- Reduced PCB space requirements
- Direct solderable or plug-in versions
- Internationally approved
- Low internal resistance
- Shock safe casing
- Vibration resistant
- Halogen Free
- Available from 0.05A to 6.3A

Applications

- Battery chargers
- Consumer Electronics
- Power supplies
- Industrial controllers

Electrical Characteristics

| % of Ampere Rating | Opening Time |
|--------------------|-------------------------|
| 200% | 60 Seconds, Max. |

Electrical Characteristics

| Amp Code | Rated Current | Voltage Rating | Breaking Capacity | Nominal Cold Resistance (Ohms) | Voltage Drop 1.0xI _N max. (mV) | Power Dissipation 1.0xI _N max. (mW) | Melting Integral 10xI _N max. (A ² s) | Agency Approvals | | |
|----------|---------------|----------------|-------------------|--------------------------------|---|--|--|------------------|---|---|
| | | | | | | | | | | |
| 0050 | 50mA | 125V | 100A @125 VAC | 8.1290 | 1600 | 85 | 0.0001 | x | x | |
| 0063 | 63mA | 125V | | 4.6900 | 1300 | 85 | 0.0001 | x | x | |
| 0080 | 80mA | 125V | | 3.6500 | 1200 | 100 | 0.0002 | x | x | |
| 0100 | 100mA | 125V | | 7.4910 | 1100 | 110 | 0.0013 | x | x | |
| 0125 | 125mA | 125V | | 6.1970 | 1350 | 160 | 0.0019 | x | x | |
| 0160 | 160mA | 125V | | 4.2850 | 1000 | 150 | 0.0037 | x | x | |
| 0200 | 200mA | 125V | | 2.9780 | 950 | 210 | 0.0075 | x | x | |
| 0250 | 250mA | 125V | | 2.3100 | 900 | 225 | 0.0130 | x | x | |
| 0315 | 315mA | 125V | | 1.7220 | 800 | 255 | 0.0260 | x | x | |
| 0400 | 400mA | 125V | | 0.2200 | 230 | 95 | 0.0150 | x | x | |
| 0500 | 500mA | 125V | | 0.1570 | 220 | 110 | 0.0250 | x | x | |
| 0630 | 630mA | 125V | | 0.1180 | 210 | 135 | 0.0450 | x | x | |
| 0800 | 800mA | 125V | | 0.0970 | 200 | 160 | 0.0680 | x | x | |
| 1100 | 1.00A | 125V | | 0.0710 | 190 | 190 | 0.1300 | x | x | x |
| 1125 | 1.25A | 125V | | 0.0635 | 180 | 225 | 0.2000 | x | x | x |
| 1160 | 1.60A | 125V | | 0.0492 | 170 | 275 | 0.3900 | x | x | x |
| 1200 | 2.00A | 125V | | 0.0412 | 160 | 450 | 0.5300 | x | x | x |
| 1250 | 2.50A | 125V | | 0.0305 | 150 | 375 | 1.1000 | x | x | x |
| 1315 | 3.15A | 125V | | 0.0247 | 140 | 445 | 1.9000 | x | x | x |
| 1400 | 4.00A | 125V | | 0.0193 | 130 | 520 | 3.2000 | x | x | x |
| 1500 | 5.00A | 125V | 0.0139 | 120 | 600 | 6.1000 | x | x | x | |
| 1630 | 6.30A | 125V | 0.0116 | 115 | 850 | 9.7000 | x | x | | |

Notes:

1. 1.00 means the number one with two decimal places. 1,000 means the number one thousand.
2. Resistance is measured at 10% of rated current, 25°C.

Temperature Re-rating Curve

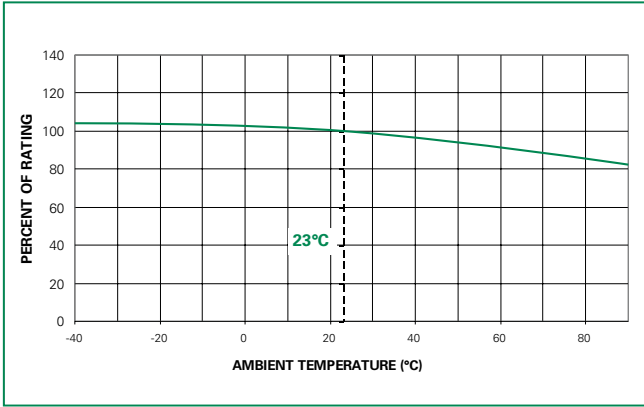

Note:
1. Derating depicted in this curve is in addition to the standard derating of 25% for continuous operation.

Average Time Current Curves

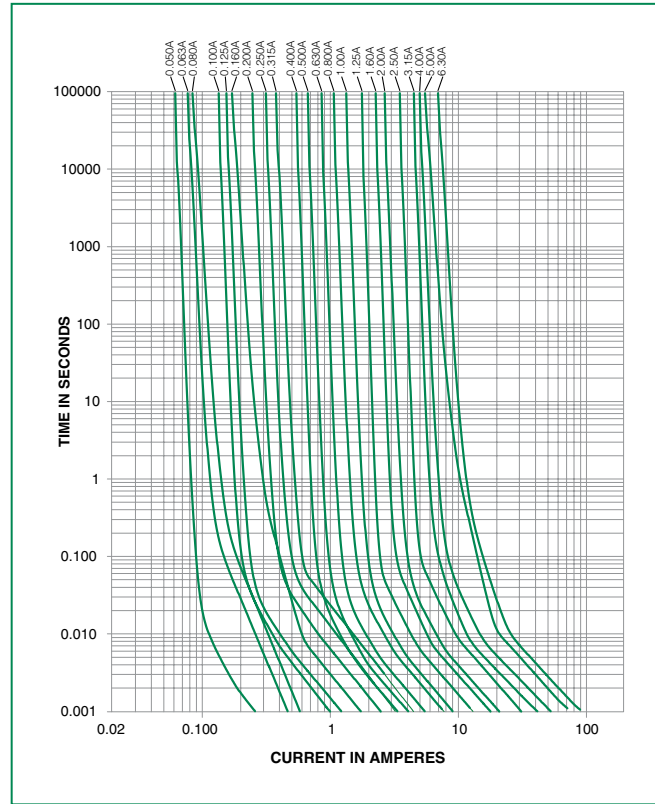

Soldering Parameters - Wave Soldering

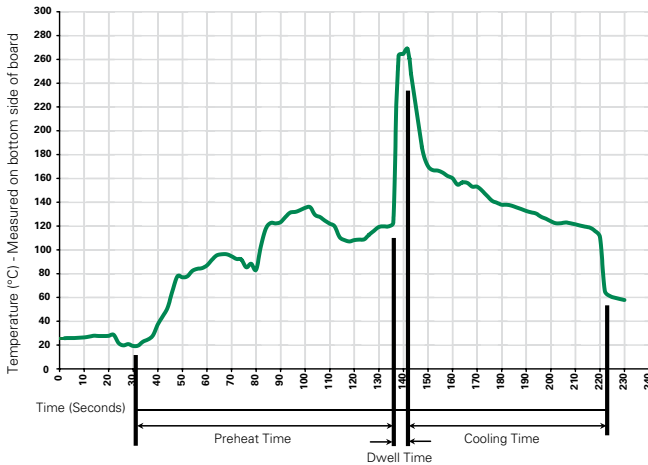

Recommended Process Parameters:

| Wave Parameter | Lead-Free Recommendation |
|---|-----------------------------------|
| Preheat: (Depends on Flux Activation Temperature) | (Typical Industry Recommendation) |
| Temperature Minimum: | 100°C |
| Temperature Maximum: | 150°C |
| Preheat Time: | 60-180 seconds |
| Solder Pot Temperature: | 260°C Maximum |
| Solder Dwell Time: | 2-5 seconds |

Recommended Hand-Solder Parameters:

Solder Iron Temperature: 350°C +/- 5°C
Heating Time: 5 seconds max.

Note: These devices are not recommended for IR or Convection Reflow process.

Radial Lead Fuses

TE5® > Fast-Acting Fuse > 395 Series

Product Characteristics

| | |
|----------------------------------|---|
| Materials | Base/Cap: Brown Thermoplastic Polyamide PA 6.6, UL 94 V-0 Round Pins: Copper, Tin-plated |
| Lead Pull Strength | 10 N (IEC 60068-2-21) |
| Solderability | 260°C, ≤ 3s. (Wave) 350°C, ≤ 1s. (Soldering Iron) |
| Soldering Heat Resistance | 260°C, 10s. (IEC 60068-2-20) 350°C, 3s. (Soldering Iron) |

| | |
|------------------------------|--|
| Operating Temperature | -40°C to +85°C (Consider re-rating) |
| Climatic Category | -40°C to +85°C/21 days (IEC 60068-1,-2-1,-2-2,-2-78) |
| Stock Conditions | +10°C to +60°C RH ≤ 75% yearly average, without dew, maximum value for 30 days-95% |
| Vibration Resistance | 24 cycles at 15 min. each (IEC 60068-2-6) 10 - 60Hz at 0.75mm amplitude 60 - 2000Hz at 10g acceleration |

Dimensions

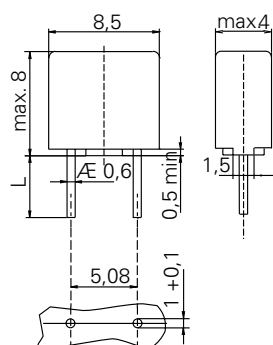

Holes in PCB
 Long Leads (L=18.8mm)
 Short Leads (L=4.3mm)

Part Numbering System

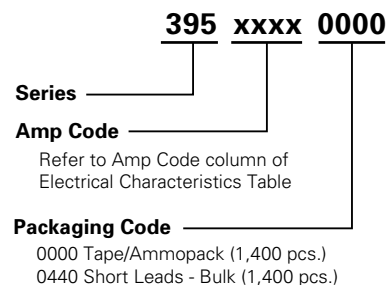

Packaging

| Packaging Option | Packaging Specification | Quantity | Quantity & Packaging Code | Taping Width |
|-------------------|-------------------------|----------|---------------------------|--------------|
| 395 Series | | | | |
| Tape and Ammopack | N/A | 1,400 | 0000 | N/A |
| Short Leads | N/A | 1,400 | 0440 | N/A |