

| LOC | QTY | REV | DATE    | BY | APPV |
|-----|-----|-----|---------|----|------|
| AJ  | 16  | A   | 04APR01 | MO | JL   |

- REVISIONS
- | REV | DESCRIPTION          | DATE    | BY | APPV |
|-----|----------------------|---------|----|------|
| A   | REV PER OU20-0200-01 | 04APR01 | MO | JL   |
- 1 CARBON STEEL PER ASTM-A-108
  - 2 BRASS PER ASTM-B-16
  - 3 PHOSPHOR BRONZE PER ASTM-B-139
  - 4 POLYMETHYLPENTENE: GENERAL PURPOSE
  - 5 SILICONE RUBBER PER ZZ-R-765
  - 6 ZINC DIE CAST PER ASTM-B-86
  - 7 GOLD PLATE PER MIL-G-45204, 0.76µm [.000030] MIN THICKNESS
  - 8 NICKEL PLATE PER QQ-N-290, 1.27µm [.000050] MIN THICKNESS
  - 9 NICKEL PLATE PER QQ-N-290, 2.54µm [.000100] MIN THICKNESS

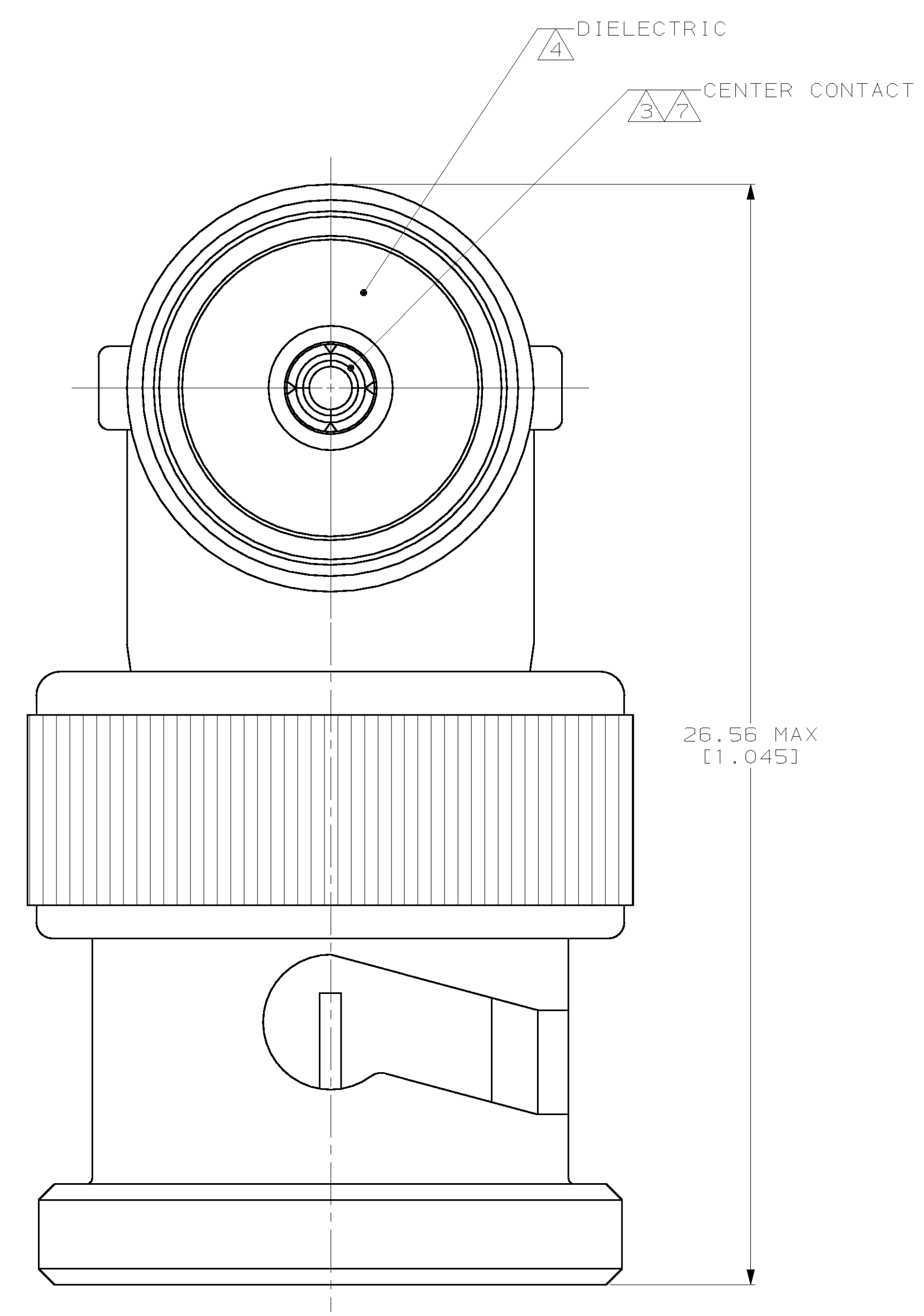
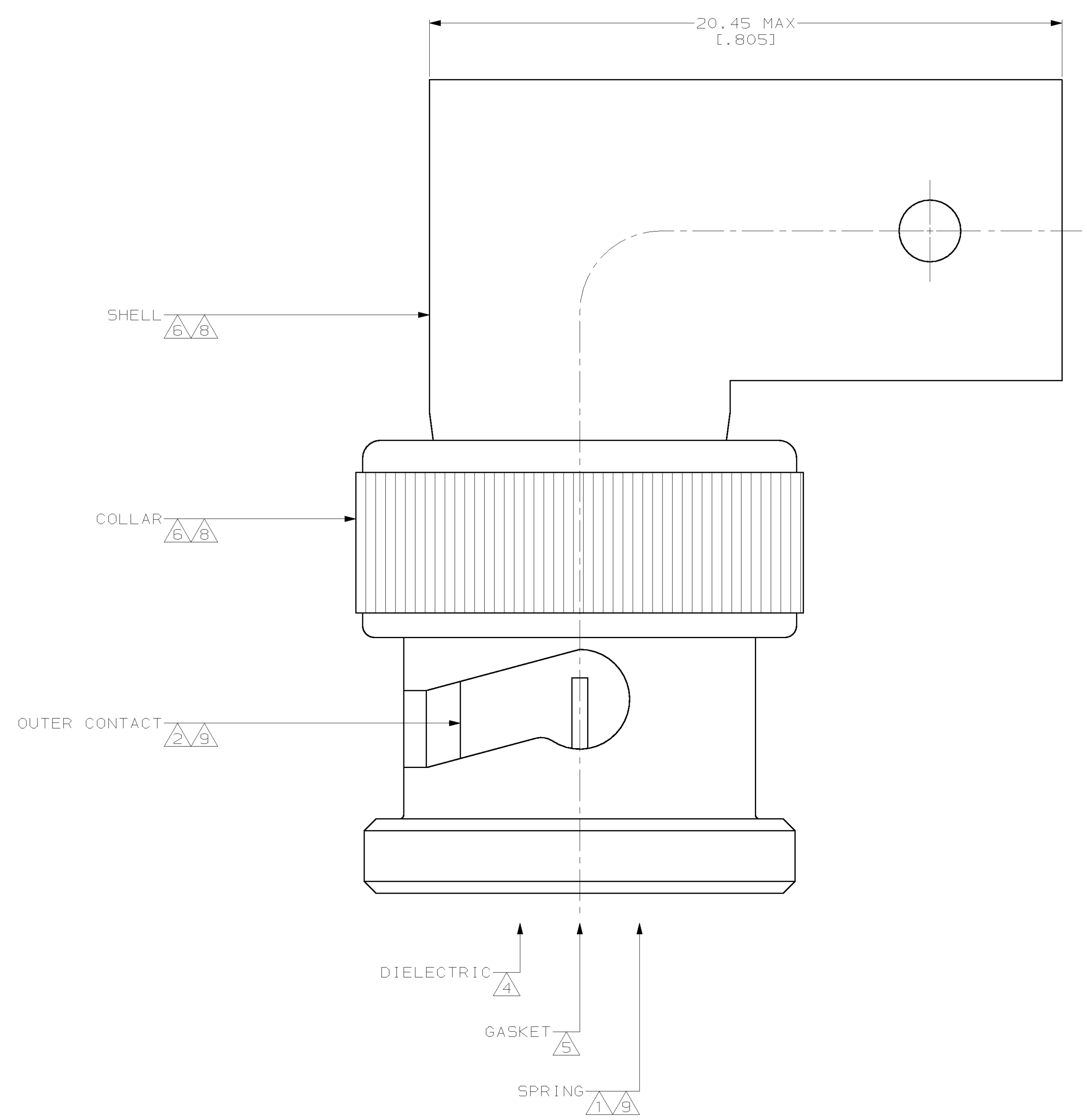

415020-1  
PART NUMBER

|  |   |  |  |  |
|--|---|--|--|--|
| <small>THIS DRAWING IS A CONTROLLED DOCUMENT AND IS UNPUBLISHED. IT IS SUBJECT TO CHANGE AND THE CONTROLLING ENGINEERING ORGANIZATION SHOULD BE CONTACTED FOR THE LATEST REVISION.</small> |   | DWG: M. E. COWHER<br>CHK: M. J. PHILLIPS<br>APPV: M. J. PHILLIPS | OBR4995<br>OBR4995<br>OBR4995                        | <b>AMP</b> AMP Incorporated<br>Harrisburg, PA 17105-3608 |
| DIMENSIONS:<br>mm (INCHES)   | TOLERANCES UNLESS OTHERWISE SPECIFIED:<br>0 PLC ±.01<br>1 PLC ±.01<br>2 PLC ±.01<br>3 PLC ±.01<br>4 PLC ±.01<br>ANGLES ±.01 | PRODUCT SPEC: 108-12096<br>APPLICATION SPEC:                     | SIZE: A1<br>CAGE CODE: 00779<br>DRAWING NO: C-415020 | SCALE: 10:1<br>SHEET: 1 OF 1<br>REV: A                   |
| MATERIAL: SEE NOTES<br>FINISH: SEE NOTES   |   | WEIGHT: -  | CUSTOMER DRAWING                                     |  |