

THIS DRAWING IS UNPUBLISHED. RELEASED FOR PUBLICATION
 © COPYRIGHT - By - ALL RIGHTS RESERVED.

| LOC | | DIST | | REVISIONS | | | |
|-----|-----|-------------|---------------------------|-----------|-----|------|--|
| P | LTR | DESCRIPTION | | DATE | DWN | APVD | |
| CM | 00 | W | REVISED PER ECO-12-007504 | 03AUG12 | KH | SM | |

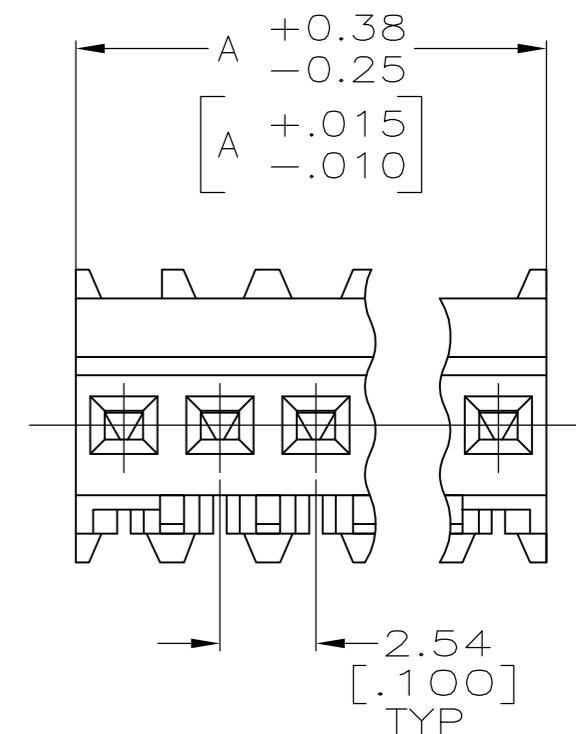
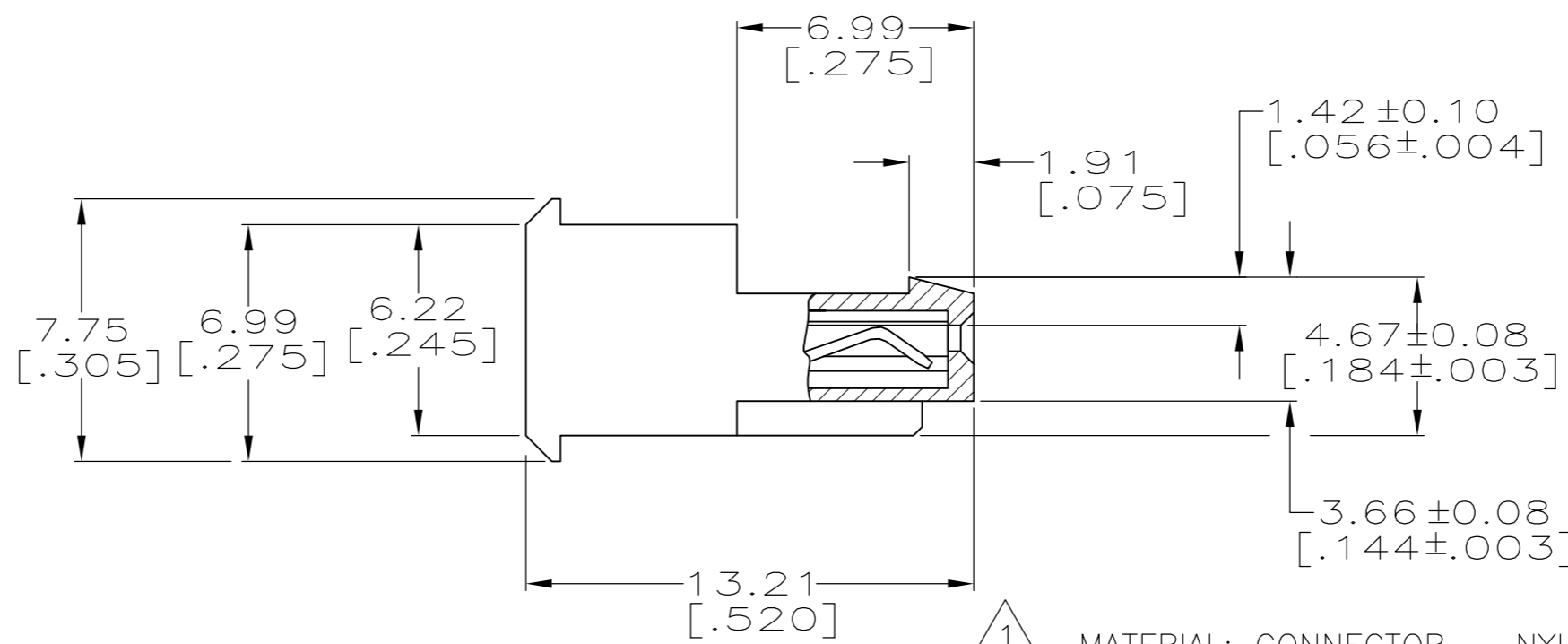
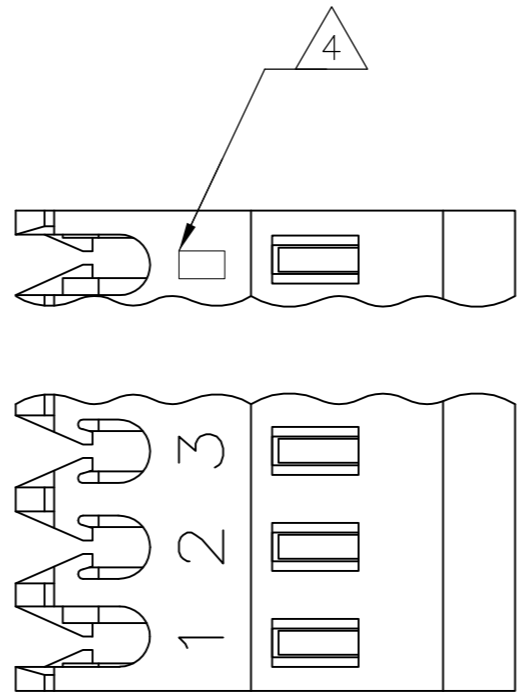

MATERIAL: CONNECTOR - NYLON UL94V-2.
 CONTACTS - 0.30[.012] THICK COPPER ALLOY
 BRIGHT TIN-LEAD .00203[.000080] MIN THICKNESS
 FOR 640622-2 THRU 2-640622-8.
 MATTE WHISKER MITIGATED TIN .00203[.000080] MIN THICKNESS
 OVER NICKEL UNDERPLATE FOR 3-640622-2 THRU 5-640622-8.

- 2 CONTACTS ACCEPT 26 AWG WIRE WITH 1.52[.060] MAX INSULATION DIAMETER.
- 3 CONTACTS MUST ACCEPT 0.64±0.03[.025±.001] SQUARE POST AND REMAIN LOCKED IN POSITION.
- 4 IDENTIFICATION NUMBER FOR LAST CIRCUIT MAY NOT APPEAR ON ALL ASSEMBLIES.
- 5 DIMENSIONS IN BRACKETS ARE IN INCHES.
- 6 HOUSING FEATURES ARE: FEED THRU WITH LOCKING RAMP.
- 7 OBSOLETE PARTS: OBSOLETE CIS STREAMLINING PER D.RENAUD/D.SINISI
- 8 BLUE COLOR STRIPE ON HOUSING (NOT SHOWN) MAY RUN DOWN BETWEEN RIBS.

| D | YES | DIM A | NO. OF CIRCUITS | PART NO. |
|---|----------|--------------|-----------------|------------|
| | YES | 71.12[2.800] | 28 | 5-640622-8 |
| | YES | 68.58[2.700] | 27 | 5-640622-7 |
| | YES | 66.04[2.600] | 26 | 5-640622-6 |
| | YES | 63.50[2.500] | 25 | 5-640622-5 |
| | YES | 60.96[2.400] | 24 | 5-640622-4 |
| | YES | 58.42[2.300] | 23 | 5-640622-3 |
| | YES | 55.88[2.200] | 22 | 5-640622-2 |
| | YES | 53.34[2.100] | 21 | 5-640622-1 |
| | YES | 50.80[2.000] | 20 | 5-640622-0 |
| | YES | 48.26[1.900] | 19 | 4-640622-9 |
| | YES | 45.72[1.800] | 18 | 4-640622-8 |
| | YES | 43.18[1.700] | 17 | 4-640622-7 |
| | YES | 40.64[1.600] | 16 | 4-640622-6 |
| | YES | 38.10[1.500] | 15 | 4-640622-5 |
| | YES | 35.56[1.400] | 14 | 4-640622-4 |
| | YES | 33.02[1.300] | 13 | 4-640622-3 |
| | YES | 30.48[1.200] | 12 | 4-640622-2 |
| | YES | 27.94[1.100] | 11 | 4-640622-1 |
| | YES | 25.40[1.000] | 10 | 4-640622-0 |
| | YES | 22.86[.900] | 9 | 3-640622-9 |
| | YES | 20.32[.800] | 8 | 3-640622-8 |
| | YES | 17.78[.700] | 7 | 3-640622-7 |
| | YES | 15.24[.600] | 6 | 3-640622-6 |
| | YES | 12.70[.500] | 5 | 3-640622-5 |
| | YES | 10.16[.400] | 4 | 3-640622-4 |
| | YES | 7.62[.300] | 3 | 3-640622-3 |
| | YES | 5.08[.200] | 2 | 3-640622-2 |
| | NO | 71.12[2.800] | 28 | 2-640622-8 |
| | NO | 68.58[2.700] | 27 | 2-640622-7 |
| | NO | 66.04[2.600] | 26 | 2-640622-6 |
| | NO | 63.50[2.500] | 25 | 2-640622-5 |
| | NO | 60.96[2.400] | 24 | 2-640622-4 |
| | NO | 58.42[2.300] | 23 | 2-640622-3 |
| | NO | 55.88[2.200] | 22 | 2-640622-2 |
| | NO | 53.34[2.100] | 21 | 2-640622-1 |
| | NO | 50.80[2.000] | 20 | 2-640622-0 |
| | NO | 48.26[1.900] | 19 | 1-640622-9 |
| | NO | 45.72[1.800] | 18 | 1-640622-8 |
| | NO | 43.18[1.700] | 17 | 1-640622-7 |
| | NO | 40.64[1.600] | 16 | 1-640622-6 |
| | NO | 38.10[1.500] | 15 | 1-640622-5 |
| | NO | 35.56[1.400] | 14 | 1-640622-4 |
| | NO | 33.02[1.300] | 13 | 1-640622-3 |
| | NO | 30.48[1.200] | 12 | 1-640622-2 |
| | NO | 27.94[1.100] | 11 | 1-640622-1 |
| | NO | 25.40[1.000] | 10 | 1-640622-0 |
| | NO | 22.86[.900] | 9 | 640622-9 |
| | NO | 20.32[.800] | 8 | 640622-8 |
| | NO | 17.78[.700] | 7 | 640622-7 |
| | NO | 15.24[.600] | 6 | 640622-6 |
| | NO | 12.70[.500] | 5 | 640622-5 |
| | NO | 10.16[.400] | 4 | 640622-4 |
| | NO | 7.62[.300] | 3 | 640622-3 |
| | NO | 5.08[.200] | 2 | 640622-2 |
| | LEADFREE | DIM A | NO. OF CIRCUITS | PART NO. |

SUPERSEDED



SUPERSEDED



SUPERSEDED



| | | | | |
|---|--|----------------------------------|---|--------------------|
| THIS DRAWING IS A CONTROLLED DOCUMENT. | | DWN S. CARPENTER 08AUG2003 | TE Connectivity | |
| DIMENSIONS: mm [INCHES] | | CHK D. BOSSI 08AUG2003 | | |
| TOLERANCES UNLESS OTHERWISE SPECIFIED: | | APVD D. BOSSI 08AUG2003 | NAME | |
| 0 PLC ± 1 PLC ± 2 PLC ± 3 PLC ± 0.13 [.005] 4 PLC ± ANGLES ± | | PRODUCT SPEC 108-1050 | MTA-100 CONNECTOR ASSEMBLY, 26 AWG, STANDARD | |
| MATERIAL | | APPLICATION SPEC 114-1019 | SIZE A2 | CAGE CODE 00779 |
| FINISH | | WEIGHT | DRAWING NO C=640622 | RESTRICTED TO - |
| CUSTOMER DRAWING | | SCALE 5:1 | | SHEET 1 of 1 |
| | | | | REV W |