

1

2

3

4

5

6

7

A

B

C

D

E

F

G

H

A

B

C

D

E

F

G

H

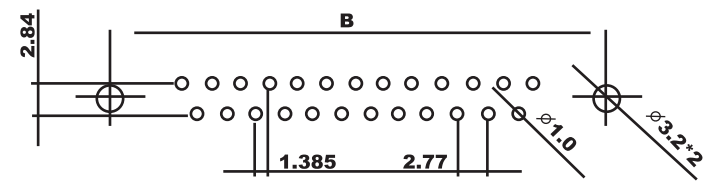
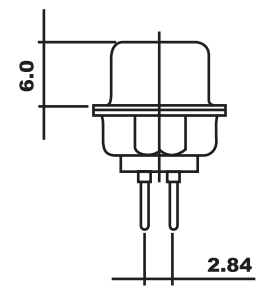
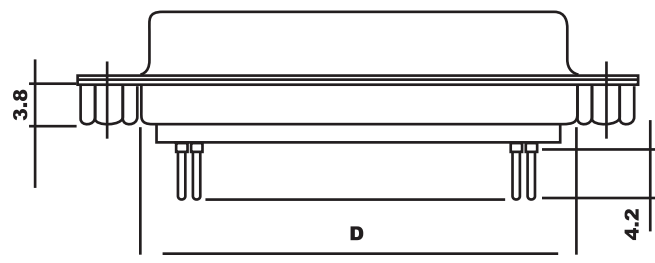
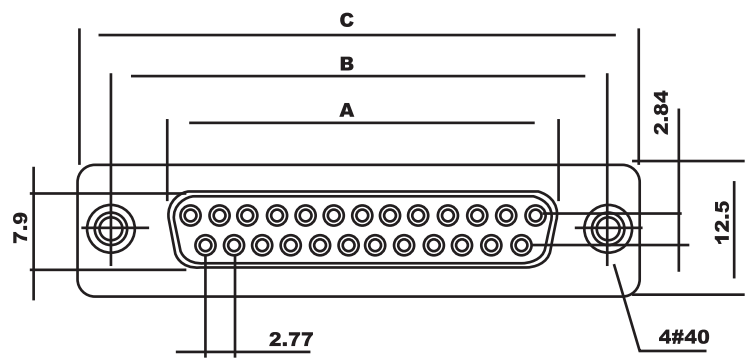

**Recommended P.C.B. Layout (Top View)**  
Tolerances:  $\pm 0.10\text{mm}$

Position	A	B	C	D
9	16.30	25.00	30.8	19.2
15	24.60	33.30	39.2	27.7
25	38.30	47.10	53.1	41.1
37	54.80	63.50	69.4	57.3
50	52.20	61.00	67.00	55.10

**Specification:**

**Material:**

Insulator: PBT, rated UL94V-0

Contacts: Brass

Shell: Steel

Rivet, Boardlock: Copper Alloy

**Contact Plating:**

Gold Flash over 50u"nickel

**Electrical**

Operation Voltage: 250 VAC max.

Current Rating: 3 Amps max.

Contact Resistance: 15 mohms max.

Insulation Resistance: 3000 Mohms min @ 500 VDC

Dielectric Withstanding Voltage: 1000 VAC/minute

Operating Temperature:  $-55^{\circ}\text{C}$  to  $+105^{\circ}\text{C}$

Scale	1:1						Name	<b>Item No.</b> <b>A-DSxxPP-TAXM-B-R</b>
TOLERANCE					Drawn	11.16.11	Chappell	
X.X	$\pm 0.40$				Approved			
X.XX	$\pm 0.25$							<b>Title</b> D-Sub Solder
X.XXX	$\pm 0.15$							Drawing No.
Angle	$\pm 3^{\circ}$							<b>rev00</b>
								Replace
					Modification	Date	Name	Sheet



1

2

3

4

5

6

7