

PRODUCT NUMBER	PITCH
YK403xx1x0JOG	8.25 mm

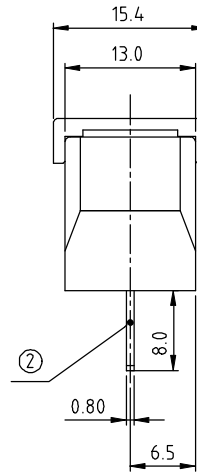
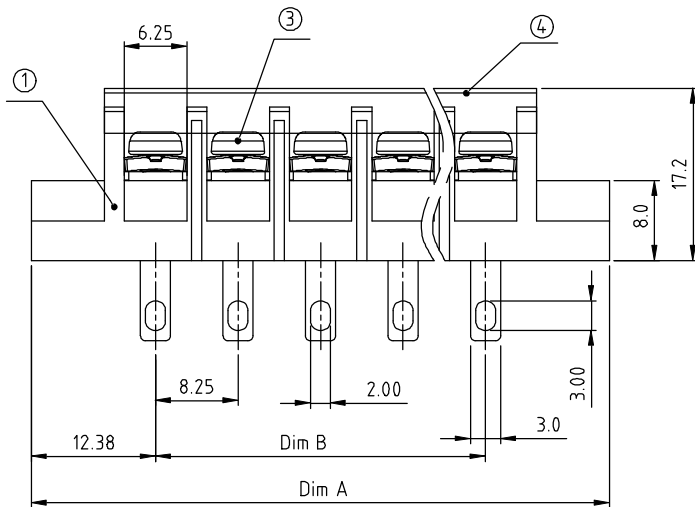
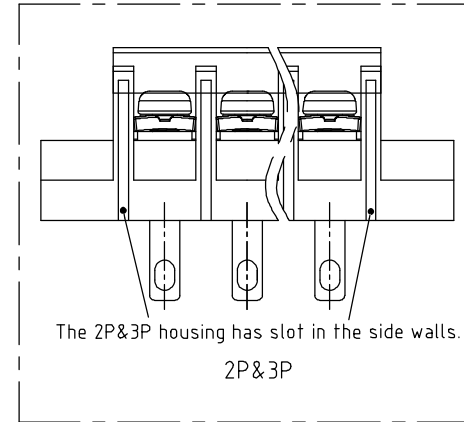
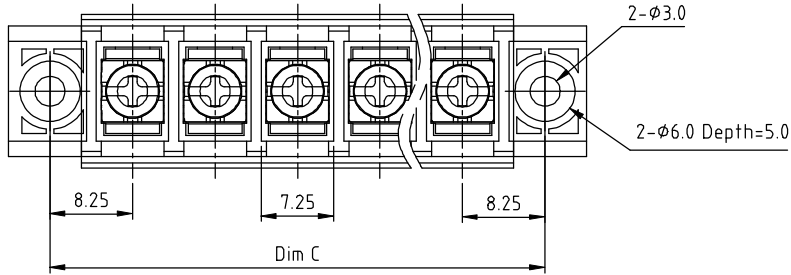

MATERIALS & ELECTRICAL

RATED VOLTAGE & CURRENT: 300 V, 20 A
 WITHSTAND VOLTAGE: AC 2000 V/Min
 INSULATION RESISTANCE: 1000 MΩ OR MORE AT DC 500 V
 OPERATING TEMPERATURE RANG: -40 °C ~ +115 °C
 SCREW TORQUE VALUE: 7 Lb-In.
 WIRE RANGE: 22 - 12 AWG

1) HOUSING: Thermoplastic , UL 94 V-0 BLACK
 2) TERMINAL: BRASS, 0.8t
 3) TERMINAL SCREWS: STEEL, M3
 4) COVER MATERIAL: PC

APPROVAL:

DIMENSION

Dim A	(N+2)×8.25
Dim B	(N-1)×8.25
Dim C	N+1×8.25

N=Number of poles

Poles	Tolerance
2p-4p	±0.30
5p-8p	±0.40
9p-16p	±0.50
17p-23p	±0.60
24p-30p	±0.80

PART NO.: YK 403xx 1 x 0 JOG

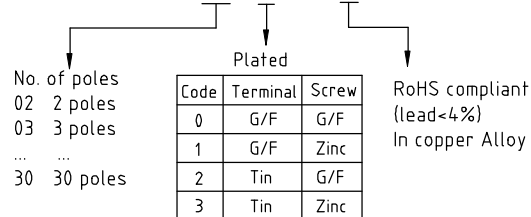

mat'l. code		surface	tolerance	projection	product family	
ltr		ASME Y14.5	ASME Y14.5		TERMINAL BLOCK	
ecn no	dr	tolerances unless otherwise specified			title	
date		angles	X.±0.5	MM	TERMINAL BLOCK	
		flat	X.X±0.3	scale	BARRIER TYPE, WITH FLANGE&COVER	
		X'±1'	X.XX±0.1		dwg no	
dr	EVAN LU	061014			sheet 1 of 1	size
enr	EVAN LU	061014			YK403xx1x0JOG	A4
chr	HANKE FENG	061014			type	
appd	SHI JUN	061014			CUSTOMER Drawing	
sheet index	revision sheet	A	1			