

SEE DETAIL Z

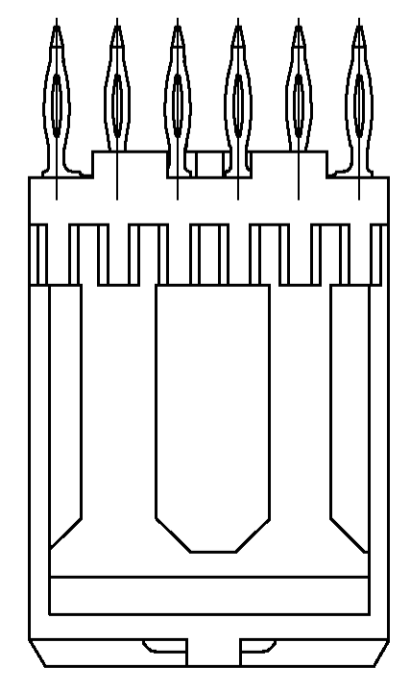

$\phi 0.725 \pm 0.075$
 $\phi 0.15 \text{ (M)}$
 PLATED THROUGH HOLE

RECOMMENDED CIRCUIT PATTERN
 PER IPC-D300 TYPE II, CLASS C
 (COMPONENT SIDE)

- 1 HOUSING MATERIAL: LIQUID CRYSTAL POLYMER PER ASTM D5138 LCP000 G30A 32250.
- 2 CONTACT MATERIAL: PHOSPHOR BRONZE PER UNS ALLOY NO. C51100, TEMPER: H04.
- 3 CONTACT FINISH:(D)
 UNDERPLATE (ENTIRE CONTACT):
 0.00127 MIN NICKEL PER SAE-AMS-QQ-N-290
 ON MATING SURFACES:
 FLASH GOLD PER ASTM B 488, OVER
 0.00076 MIN PALLADIUM-NICKEL OVER UNDERPLATE, OR
 0.00076 MIN GOLD PER ASTM B 488 OVER UNDERPLATE.
 ON LEADS:
 0.00127 MIN MATTE TIN PER ASTM B 545 OVER UNDERPLATE.
 LUBRICATION (MIN MATING SURFACES):
 SURFACE CONDITIONER AFTER PLATING.
- 4 PART MARKING, LOCATED APPROXIMATELY AS SHOWN.

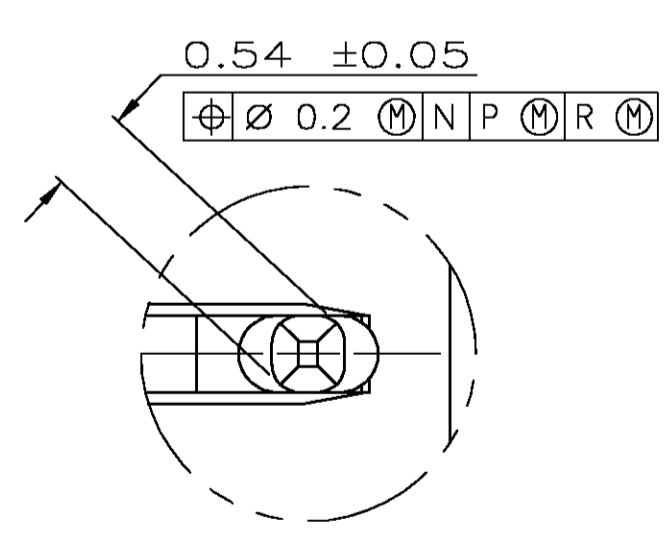

DETAIL Z
 SCALE 20:1

6	1	10	5	11.88	3	8	5536620-1
E	D	C	B	A	FINISH	NO OF POSN	PART NUMBER
THIS DRAWING IS A CONTROLLED DOCUMENT.		DIN D.R.BENDER 02/15/94		Tyco Electronics Corporation			
DIMENSIONS: mm		TOLERANCES UNLESS OTHERWISE SPECIFIED:		D.R.BAECHTLE 05/19/94		Harrisburg, Pa 17105-3608	
0 PLC	±	-	Tyco Electronics				
1 PLC	±	-	NAME				
2 PLC	±	0.13	PRODUCT SPEC				
3 PLC	±	-	APPLICATION SPEC				
4 PLC	±	-	SIZE				
ANGLES	±	-	CAGE CODE				
MATERIAL		FINISH		DRAWING NO		RESTRICTED TO	
1 2 3		A1		00779		5536620	
CUSTOMER DRAWING		SCALE		SHEET		REV	
		4:1		1 OF 1		0	