

THIS DRAWING IS UNPUBLISHED. RELEASED FOR PUBLICATION
 BY AMP INCORPORATED. ALL RIGHTS RESERVED.

LOC	DIST	REVISIONS			
P	LTR	DESCRIPTION	DATE	DWN	APVD
FT	8	H	REDRAWN W/O CHANGE PER EC 0320-108-96	05 JAN 98	-

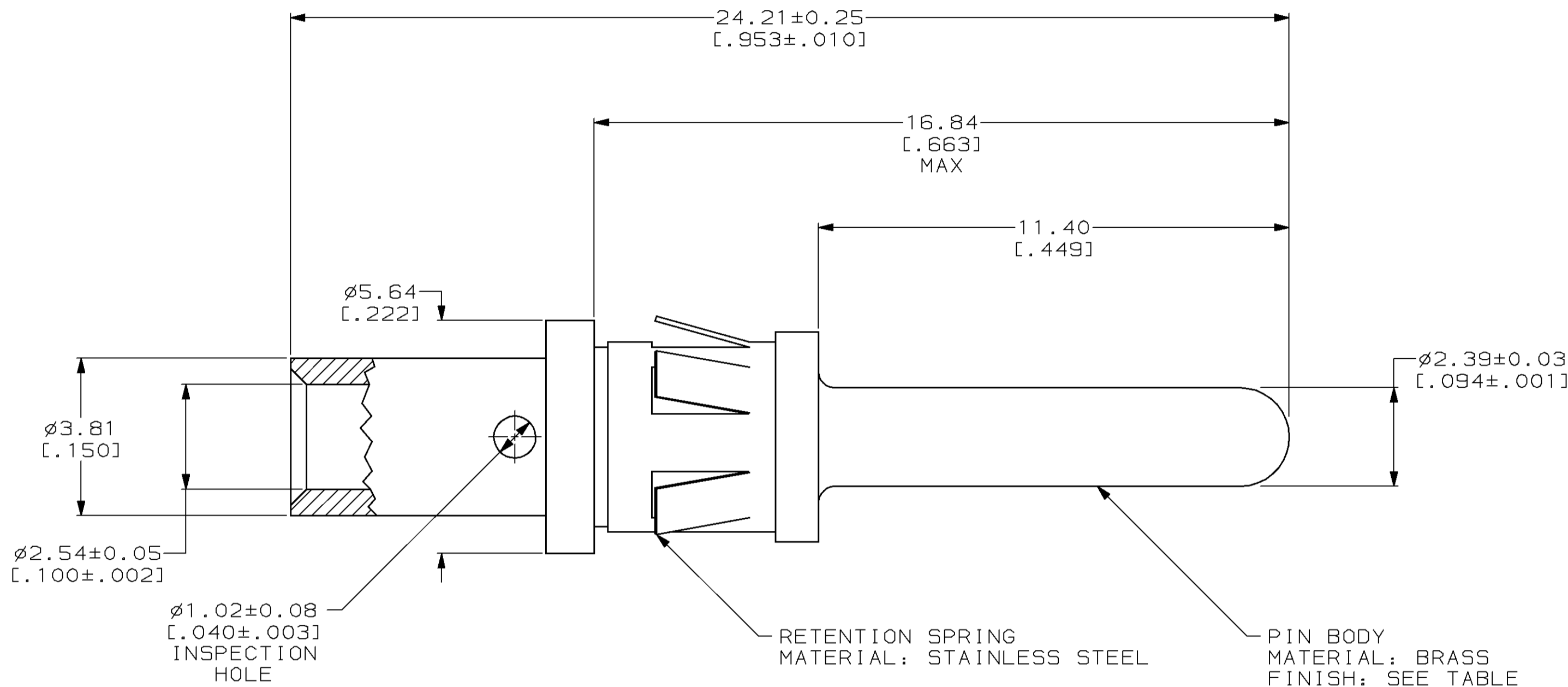

- ① $0.76 \mu\text{m}$ [$.000030$] MIN GOLD OVER $1.27 \mu\text{m}$ [$.000050$] MIN NICKEL.
- ② $3.81 \mu\text{m}$ [$.000150$] MIN TIN.
- 3. ASSEMBLY MATES WITH SOCKET ASSEMBLY 202417.

②	202422-4
①	202422-1
PIN BODY FINISH	PART NUMBER

THIS DRAWING IS A CONTROLLED DOCUMENT.		DWN	B. CARBO	05 JAN 98
DIMENSIONS:		CHK	R. STONE	09 JAN 98
mm [INCHES]		APVD	G. STEINHAUER	30 JAN 98
TOLERANCES UNLESS OTHERWISE SPECIFIED:		PRODUCT SPEC	NAME	
0 PLC	±-	APPLICATION SPEC	-	
1 PLC	±-	WEIGHT	-	
2 PLC	±0.13 [$.005$]	CUSTOMER DRAWING	SCALE	10:1
3 PLC	±-	RESTRICTED TO	SHEET	1 OF 1
4 PLC	±-	REV	REV	H
ANGLES	±-			
FINISH	SEE CALLOUTS			

AMP AMP Incorporated
Harrisburg, PA 17105-3608

CONTACT ASSEMBLY, PIN,
#14-#12 WIRE SIZE, TYPE I

SIZE CAGE CODE DRAWING NO RESTRICTED TO
A2 00779 C= 202422 -