

PRODUCT NUMBER	PITCH
YExx01x000J0G	5.00 mm

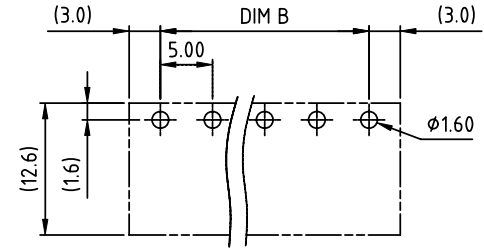

RECOMMENDED P.C.B LAYOUT  
TOP VIEW

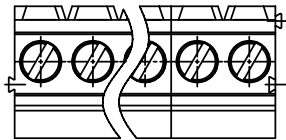
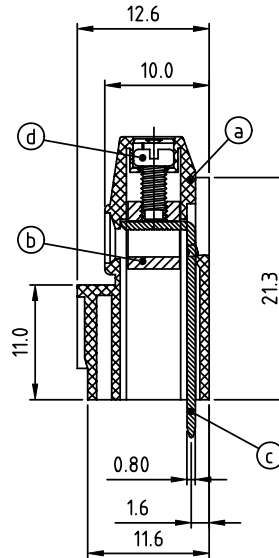
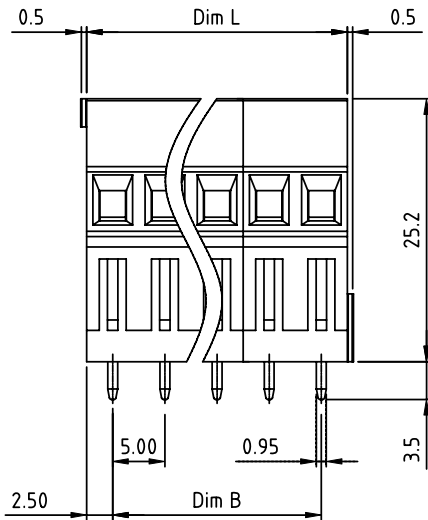

Material:

- Item (a) Terminal housing: Thermoplastic (UL 94V-0)
- Item (b) Clamp: Brass, Ni plated
- Item (c) Solder pin: Brass, Tin plated
- Item (d) Terminal screw: Steel, Zinc plating - "slot type"

Electrical cULus

- Voltage rating: 300VAC
- Current rating: 10A
- Wire range:
  - Solid wire(AWG): 12-24
  - Stranded wire(AWG): 12-24
- Torque(Lb-In): 3.5
- Screw: M2.5
- Wire strip length: 6-7mm
- Withstanding Voltage: 1.6KV
- Operating temperature: -40°C to +115°C
- Soldering temperature: 260°C±5°C/5 Sec
- Safety Approval:

DIMENSION

Dim L	Nx5.0
Dim B	(N-1)x5.0

N=Number of poles

Poles	Tolerance
2p~6p	±0.15
7p~12p	±0.25
13p~18p	±0.35
19p~24p	±0.40

PART NO.: YE xx 0 1 x 0 00J0 G

End stackable	0	Color	RoHS compliant (lead<4%) In copper Alloy
No. of poles	2	Black (RAL9005)	
02 2 poles	3	Red (RAL3001/D)	
03 3 poles	4	Orange(RAL2011/P)	
...	5	Yellow(RAL1018/A)	
24 24 poles	6	Green(RAL6018/T)	
	7	Blue (RAL5015/A)	
	8	Grey(RAL7035/D)	
	9	White(RAL1102)	
	C	Green(RAL6018/U)	

mat'l. code		surface ASME Y14.5 ✓	tolerance ASME Y14.5	projection 	product family TERMINAL BLOCK
ltr	ecn no	dr	date	title TERMINAL BLOCK RISING CLAMP, 180D WIRE INLET, END STACKABLE	
tolerances unless otherwise specified				scale	
angles		X.±0.5		MM	
hole		X.X±0.3		FCI	
X*±1*		X.XX±0.1		sheet 1 of 1 size A4	
dr		EVIN ZHONG	041014	YExx01x000J0G	
enrg		EVIN ZHONG	041014	CUSTOMER Drawing	
chr		HANKE FENG	041014		
appd		SHI JUN	041014		
sheet index	revision sheet	A	1		