

LOC		DIST		REVISIONS			
F	LTR	DESCRIPTION	DATE	OWN	APVD		
D		ECO-07-012892	22JUN07	KW	DB		
D1		REVISED PER ECO-09-022908	08OCT09	KK	AEG		

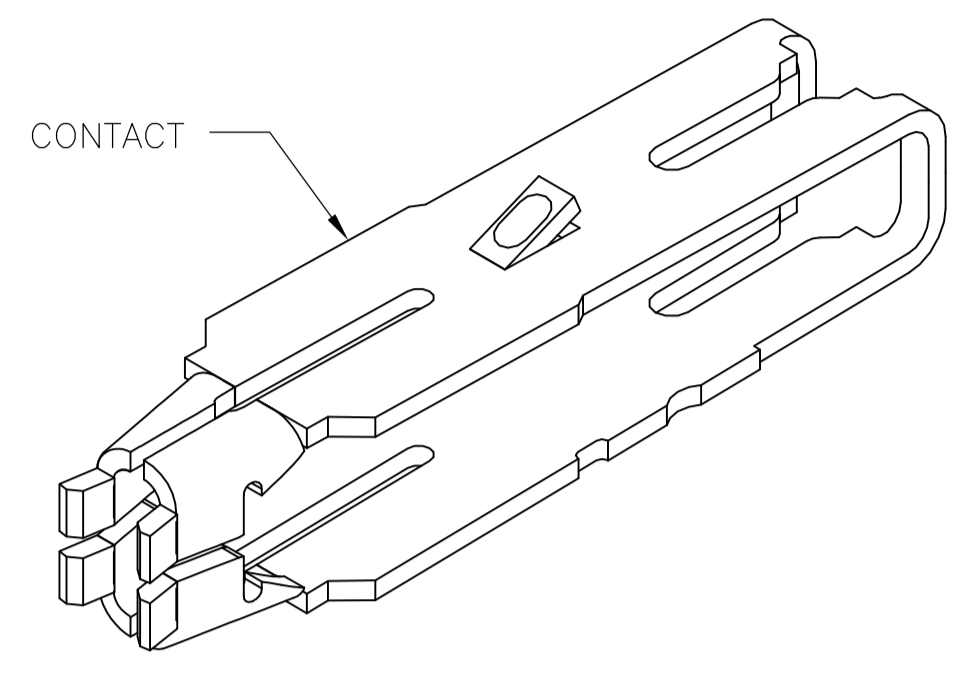

1. OPERATING TEMPERATURE: -55° C TO 105°C.
- 2 MATERIAL: HOUSING, NYLON 6/6, UL 94V-0, BLACK CONTACT, 0.30 [.012] THICK COPPER ALLOY
- 3 FINISH: BRIGHT TIN-LEAD PLATE 0.00203-0.00508 [.000080-.000200"] THICK. OR MATTE WHISKER MITIGATED TIN 0.00203 [.000080] MIN THICKNESS OVER NICKEL UNDERPLATE.
4. LUBRICATED WITH AMP ANTI-FRETTING LUBRICANT.
- 5 IDENTIFICATION NUMBER FOR FIRST CIRCUIT.
- 6 WIRE GAUGE IDENTIFICATION
7. DIMENSIONS IN BRACKETS ARE IN INCHES.
8. CONTACT MUST ACCEPT 1.14±0.03 [.045±.001] SQUARE POST AND REMAINED LOCKED IN POSITION.
- 9 OBSOLETE PARTS: OBSOLETE CIS STREAMLINING PER D.RENAUD/D.SINISI

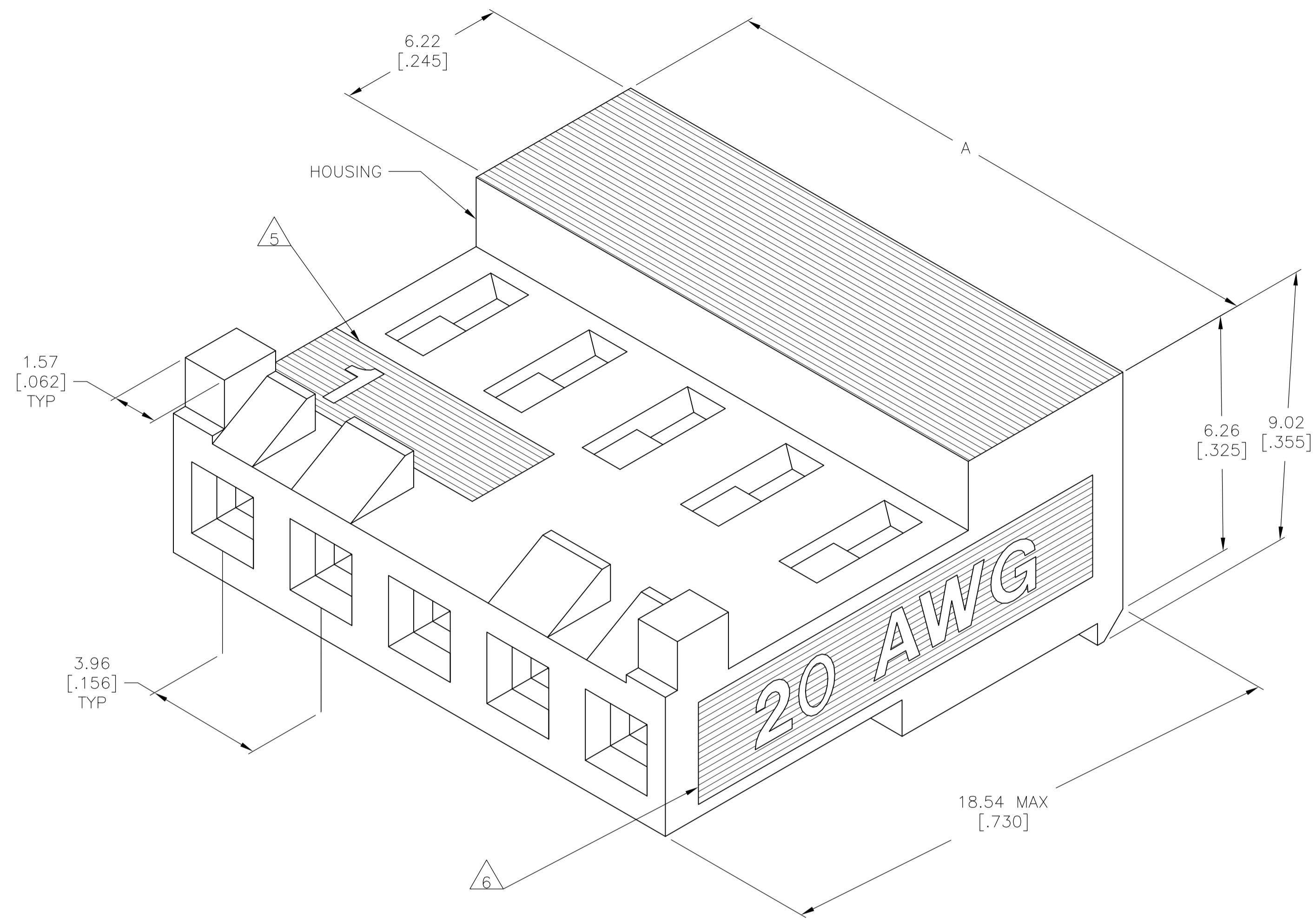
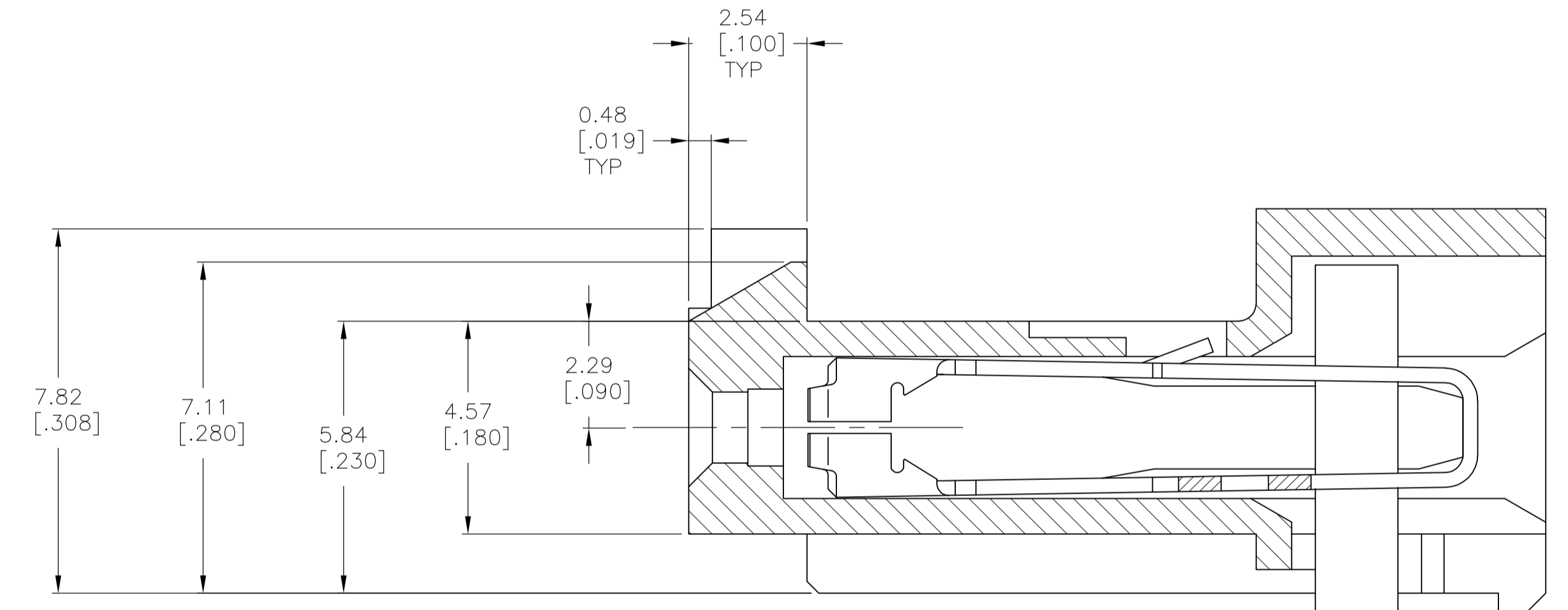

WIRE SIZE 0.5-0.6 mm² (20 AWG)
 2.41 [.095] MAX INSULATION DIA

TIN	47.55±0.30	[1.872±.012]	12	4-644382-2
TIN	43.59±0.30	[1.716±.012]	11	4-644382-1
TIN	39.62±0.30	[1.560±.012]	10	4-644382-0
TIN	35.66±0.30	[1.404±.012]	9	3-644382-9
TIN	31.70±0.30	[1.248±.012]	8	3-644382-8
TIN	27.74±0.30	[1.092±.012]	7	3-644382-7
TIN	23.77±0.30	[.936±.012]	6	3-644382-6
TIN	19.81±0.30	[.780±.012]	5	3-644382-5
TIN	15.85±0.15	[.624±.006]	4	3-644382-4
TIN	11.89±0.15	[.468±.006]	3	3-644382-3
TIN	7.92±0.15	[.312±.006]	2	3-644382-2
FINISH	A		NO OF CKTS	PART NO

9 SUPERCEDED	TIN-LEAD	47.55±0.30	[1.872±.012]	12	1-644382-2
	TIN-LEAD	43.59±0.30	[1.716±.012]	11	1-644382-1
	TIN-LEAD	39.62±0.30	[1.560±.012]	10	1-644382-0
	TIN-LEAD	35.66±0.30	[1.404±.012]	9	644382-9
	TIN-LEAD	31.70±0.30	[1.248±.012]	8	644382-8
	TIN-LEAD	27.74±0.30	[1.092±.012]	7	644382-7
	TIN-LEAD	23.77±0.30	[.936±.012]	6	644382-6
	TIN-LEAD	19.81±0.30	[.780±.012]	5	644382-5
	TIN-LEAD	15.85±0.15	[.624±.006]	4	644382-4
	TIN-LEAD	11.89±0.15	[.468±.006]	3	644382-3
	TIN-LEAD	7.92±0.15	[.312±.006]	2	644382-2
	FINISH	A		NO OF CKTS	PART NO

METRIC

THIS DRAWING IS A CONTROLLED DOCUMENT.

DIMENSIONS: mm [INCHES]	TOLERANCES UNLESS OTHERWISE SPECIFIED:	DIN C. MARTIN 23APR90	23APR90	Tyco Electronics Corporation Harrisburg, Pa 17105-3608
0. PLC ± -	1. PLC ± -	CMK R. SWING 23APR90	23APR90	
2. PLC ± -	3. PLC ± 0.13[.005]	APVD G. MILLER 24APR90	24APR90	
4. PLC ± -	ANGLES ± -	NAME	NAME	
		MTA-156 CONNECTOR ASSEMBLY, QUAD	MTA-156 CONNECTOR ASSEMBLY, QUAD	
		108-1219	108-1219	
		APPLICATION SPEC	APPLICATION SPEC	
		114-1048	114-1048	
		WEIGHT	WEIGHT	
		A1 00779	A1 00779	
		C=644382	C=644382	
		CUSTOMER DRAWING	CUSTOMER DRAWING	
		SCALE 10:1	SCALE 10:1	
		SHEET 1 of 1	SHEET 1 of 1	
		REV D1	REV D1	