

1 2 3 4 5 6 7

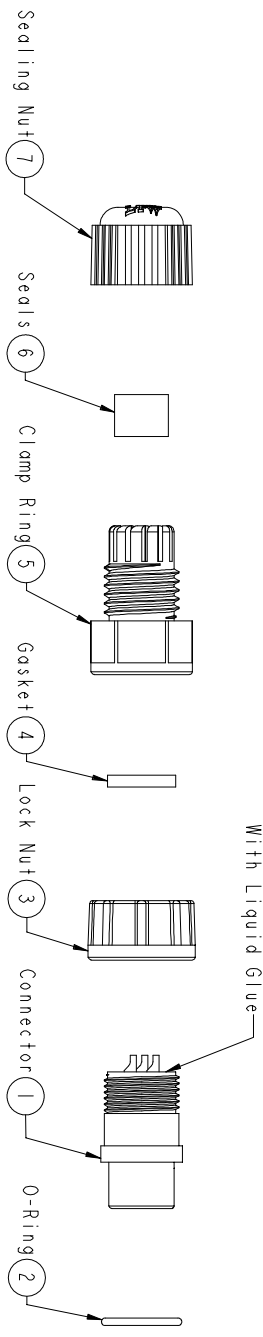

- Note:
- \*  $\varnothing$  Important Dimension To Check.
  - \* Waterproof Rate : IP67
  - \* Housing: Nylon+GF, Black
  - \* Female Pin: Copper Alloy, Gold Plated
  - \* O-Ring: EPDM, Black
  - \* Lock Nut: Nylon+GF, Black
  - \* Gasket: EPDM, Black
  - \* Seals: EPDM, Black
  - \* Clamp Ring: Nylon, Black
  - \* Sealing Nut: Nylon, Black
  - \* Seals for Cable OD:  $\varnothing$ 4.5mm- $\varnothing$ 6.5mm
  - \* One Set Unassembled in One PE Bag

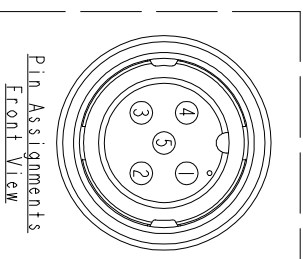
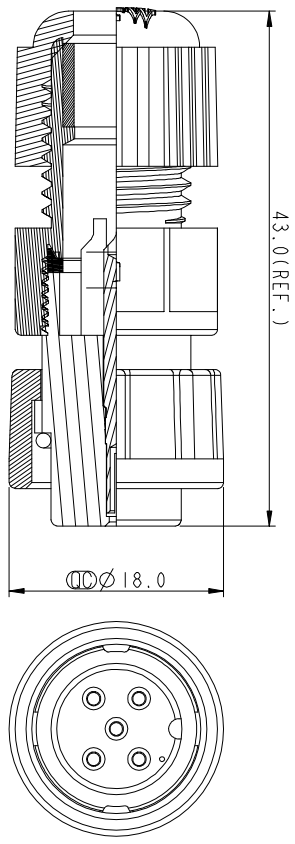

**RoHS compliant**

Scale	Free						
TOLERANCE							
.X	±0.25		Drawn	11.03.2014	Winnie	Drawn	11.03.2014
.XX	±0.10					Approved	11.03.2014
.XXX	±0.05						
Angle	±1°						

Id.	Modification	Date	Name	Date	Name
①	Drawn	11.03.2014	Winnie		



Customer-No.		Drawing-No.		Replace	
ASSMANN WSW-No.		ASSMANN WSW-No.		ASS 6240 CO	
A-CR-05BFFA-L180-WP		A-CR-05BFFA-L180-WP		rev00	
Date		Name		Sheet	
11.03.2014		Winnie		1	