

THIS COPY IS PROVIDED ON A RESTRICTED BASIS AND IS NOT TO BE USED IN ANY WAY DETRIMENTAL TO THE INTERESTS OF PANDUIT CORP.

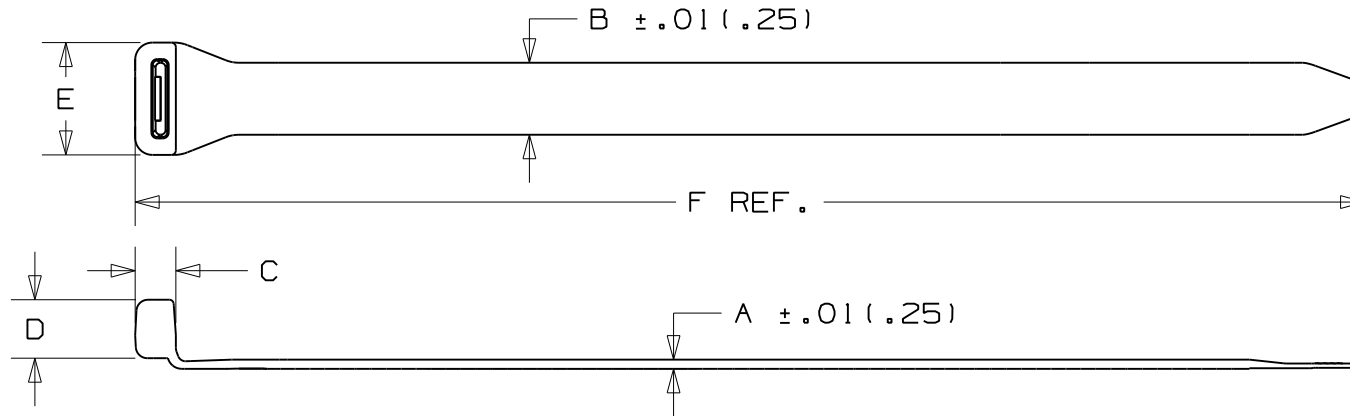

PANDUIT PART NO.	BUNDLE DIA.		A in (mm)	B in (mm)	C in (mm)	D in (mm)	E in (mm)	F in (mm)	MIN. LOOP TENSILE lbs (N)	WEIGHT lbs/100 pcs. (g)
	MIN. in (mm)	MAX. in (mm)								
ERT2M-CXX	.38 (9.7)	2.35 (59.7)	.090 (2.29)	.500 (12.70)	.323 (8.20)	.406 (10.31)	.841 (21.36)	8.5 (216)	18 (80)	1.39 (633)
ERT3M-CXX	.38 (9.7)	3.0 (76.2)	.090 (2.29)	.500 (12.70)	.323 (8.20)	.406 (10.31)	.841 (21.36)	11.0 (279)	18 (80)	1.71 (776.3)
ERT4.5M-CXX	.38 (9.7)	4.5 (114)	.090 (2.29)	.500 (12.70)	.323 (8.20)	.406 (10.31)	.841 (21.36)	16.0 (406)	18 (80)	2.41 (1093.1)

\* ERTXM-CXX

COLOR  
QUANTITY IN PACKAGE  
C = 100  
PART NUMBER

XX	COLOR
20	BLACK

NOTES:

1. SEE [www.panduit.com](http://www.panduit.com) FOR PART NUMBER SUFFIX DESIGNATION FOR PACKAGE SIZE AND PART COLOR.
2. MATERIAL FLAMMABILITY RATING: UL94V-0
3. HALOGEN FREE
4. PART IS RELEASABLE AND REUSABLE
5. PRODUCT IS RoHS COMPLIANT.
6. BLACK COLOR PROVIDES GREATER RESISTANCE TO DAMAGE CAUSED BY ULTRAVIOLET LIGHT - INDOOR OR OUTDOOR USE

CAD FILENAME/LAYERS W10001CK/07	
PANDUIT CORP. TINLEY PARK, ILLINOIS	
ELASTOMERIC CABLE TIES	
UNLESS OTHERWISE SPECIFIED, US NOMINAL DIMENSIONAL TOLERANCES ARE: (.X) ± .1(2.5) (.XXX) ± .02(0.51) (.XX) ± .02(0.5) ANGLES ± - - -	UNLESS OTHERWISE SPECIFIED, ALL DIMENSIONS ARE GIVEN IN INCHES, THIRD ANGLE PROJECTION.
DRAWN BY ERW	MAT'L: TPU
DATE 12/26/07	SCALE NONE
CHK'D TGS	DRAWING NO. SS-27570
REV	DWG A SIZE

REV	DATE	BY	CHK	DESCRIPTION	ECN	R	CUST	SUP
7	3/11/09	MJVE		ADDED NOTE 6	SS-27570		7	