

| LOC |    | DIST                      |           | REVISIONS |      |      |    |
|-----|----|---------------------------|-----------|-----------|------|------|----|
| GP  | 00 | REV                       | DATE      | BY        | APPV | DATE | BY |
| E   |    | REVISED PER ECO-12-021104 | 22JAN2013 | CJV       | CWR  |      |    |

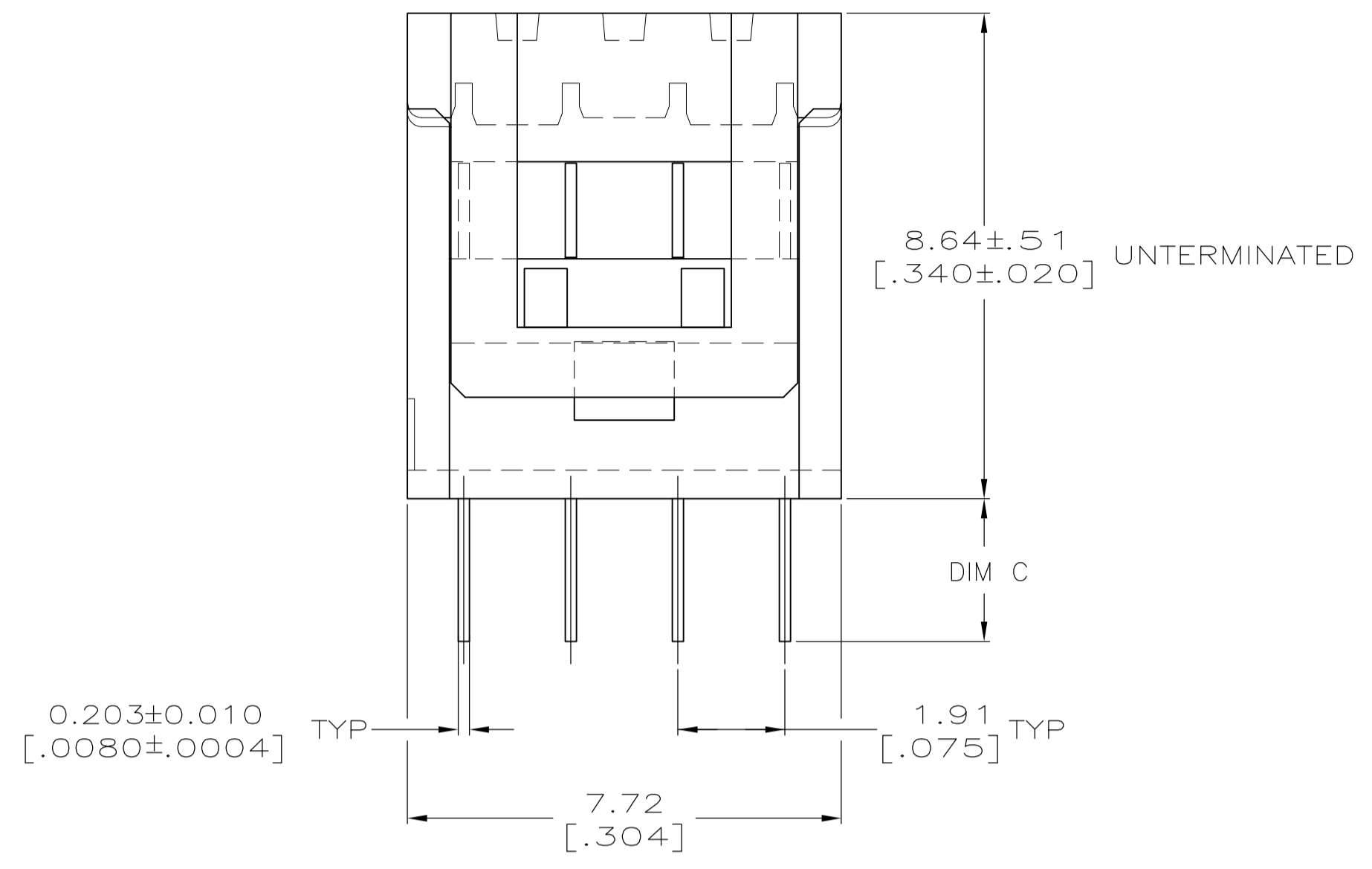

- △ HOUSING: UL RATED 94V-0 LCP THERMOPLASTIC, COLOR BLACK.  
COVER: UL RATED 94V-0 POLYESTER MOLDING COMPOUND, COLOR BLACK.
- △ CONTACTS: COPPER ALLOY.
- △ CONTACTS: 0.00254 [.000100] MIN MATTE TIN OVER 0.00127 [.000050] MIN NICKEL.
- △ POSITION 1 INDICATOR, OMITTED FOR PART NUMBER 2-5111595-1.
- △ VOID CORES MAY OR MAY NOT BE PRESENT BETWEEN ANY 2 ROWS OF CONTACTS.

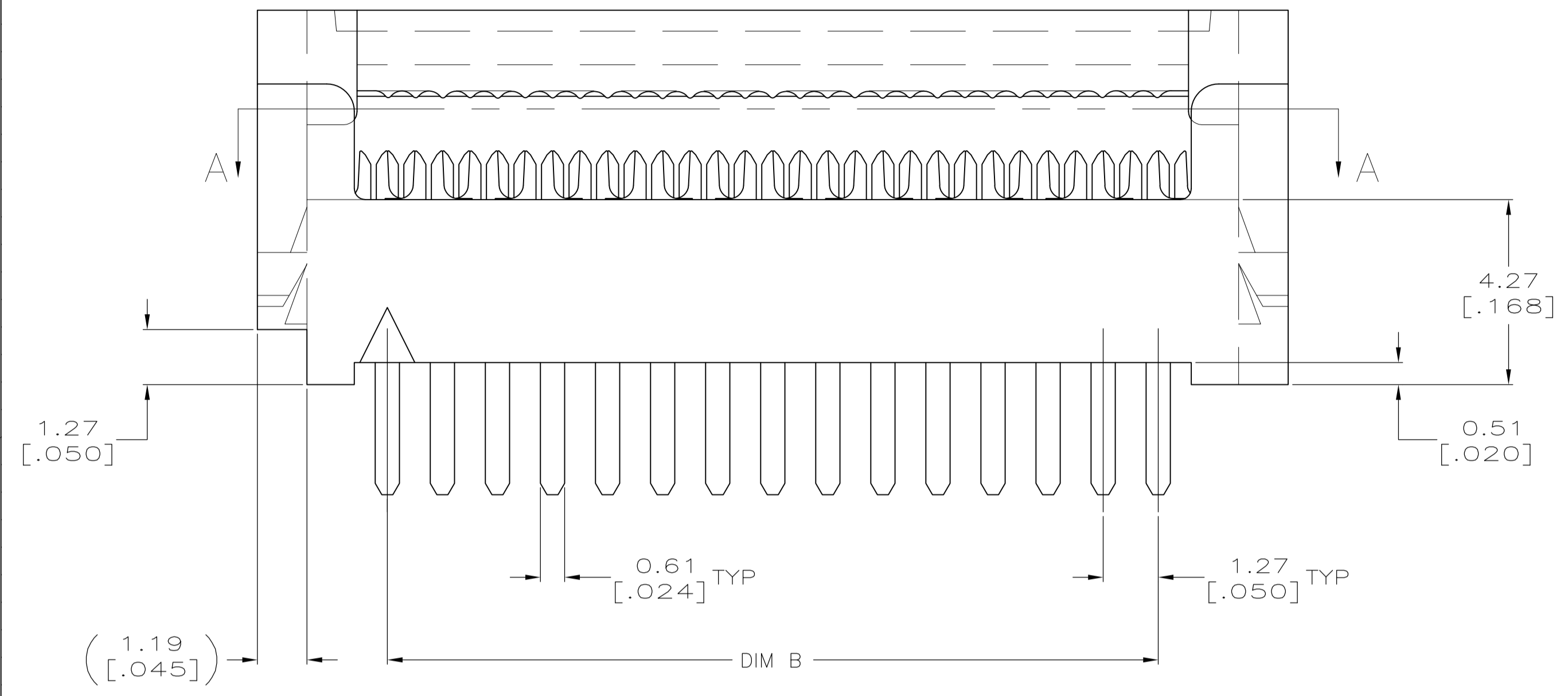
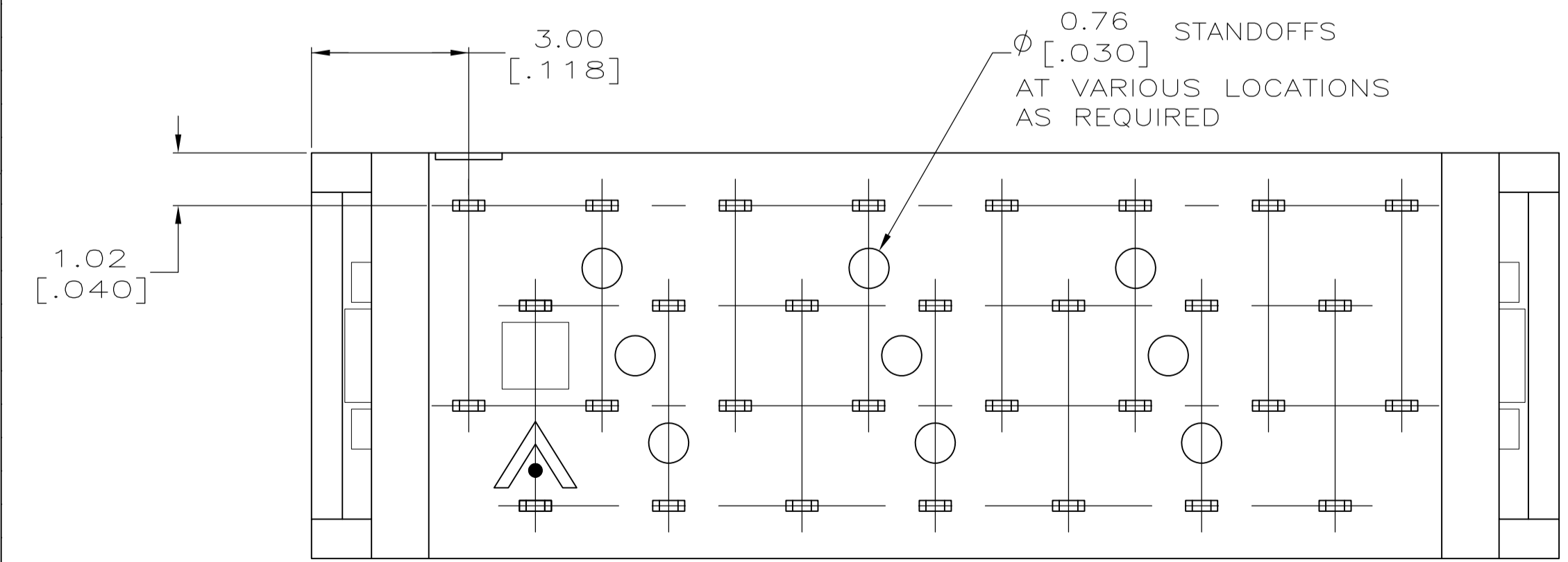
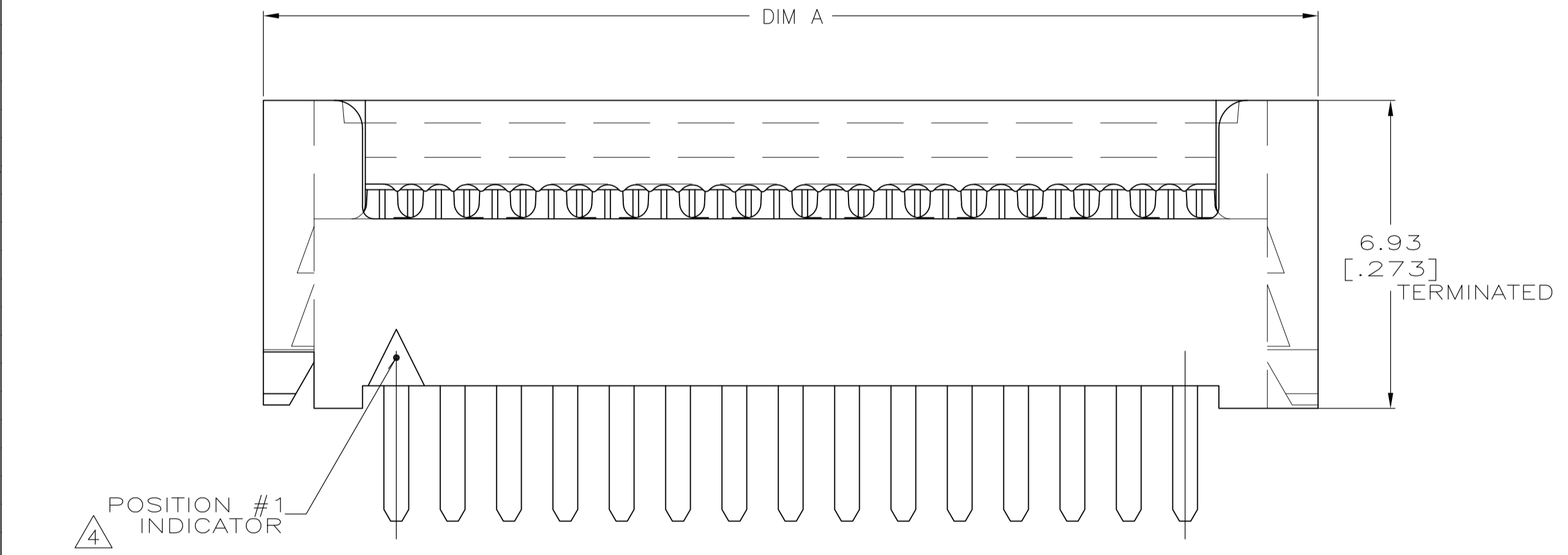

| PRELIMINARY | #1         | 3.30 [.130] | 30.48 [1.200] | 36.47 [1.436] | 50   | 2-5111595-5   |
|-------------|------------|-------------|---------------|---------------|------|---------------|
|             | #1         | 3.30 [.130] | 5.08 [.200]   | 11.07 [.436]  | 10   | 2-5111595-4   |
|             | #2         | 3.30 [.130] | 49.53 [1.950] | 55.52 [2.186] | 80   | 2-5111595-2 △ |
|             | #2         | 2.54 [.100] | 41.91 [1.650] | 47.90 [1.886] | 68   | 2-5111595-1   |
|             | #2         | 2.54 [.100] | 16.51 [.650]  | 22.50 [.886]  | 28   | 2-5111595-0   |
|             | #2         | 2.54 [.100] | 41.91 [1.650] | 47.90 [1.886] | 68   | 1-5111595-9   |
|             | #1         | 2.54 [.100] | 27.94 [1.100] | 33.93 [1.336] | 46   | 1-5111595-7   |
|             | #2         | 2.54 [.100] | 62.23 [2.450] | 68.22 [2.686] | 100  | 1-5111595-6   |
|             | #2         | 2.54 [.100] | 49.53 [1.950] | 55.52 [2.186] | 80   | 1-5111595-5   |
|             | #2         | 2.54 [.100] | 44.45 [1.750] | 50.44 [1.986] | 72   | 1-5111595-4   |
|             | #2         | 2.54 [.100] | 39.37 [1.550] | 45.36 [1.786] | 64   | 1-5111595-3   |
|             | #2         | 2.54 [.100] | 36.83 [1.450] | 42.82 [1.686] | 60   | 1-5111595-2   |
|             | #1         | 2.54 [.100] | 30.48 [1.200] | 36.47 [1.436] | 50   | 1-5111595-1   |
|             | #2         | 2.54 [.100] | 26.67 [1.050] | 32.66 [1.286] | 44   | 1-5111595-0   |
|             | #2         | 2.54 [.100] | 24.13 [.950]  | 30.12 [1.186] | 40   | 5111595-9     |
|             | #1         | 2.54 [.100] | 20.32 [.800]  | 26.31 [1.036] | 34   | 5111595-8     |
|             | #1         | 2.54 [.100] | 17.78 [.700]  | 23.77 [.936]  | 30   | 5111595-7     |
|             | #1         | 2.54 [.100] | 15.24 [.600]  | 21.23 [.836]  | 26   | 5111595-6     |
|             | #2         | 2.54 [.100] | 13.97 [.550]  | 19.96 [.786]  | 24   | 5111595-5     |
|             | #2         | 2.54 [.100] | 11.43 [.450]  | 17.42 [.686]  | 20   | 5111595-4     |
|             | #2         | 2.54 [.100] | 8.89 [.350]   | 14.88 [.586]  | 16   | 5111595-3     |
|             | #1         | 2.54 [.100] | 7.62 [.300]   | 13.61 [.536]  | 14   | 5111595-2     |
|             | #1         | 2.54 [.100] | 5.08 [.200]   | 11.07 [.436]  | 10   | 5111595-1     |
|             | PCB LAYOUT | C           | B             | A             | POSN | PART NO       |

THIS DRAWING IS A CONTROLLED DOCUMENT. DIMENSIONING AND TOLERANCING PER ASME Y14.5M-2009.

|                         |  |  |                           |
|-------------------------|--|--|---------------------------|
| DIMENSIONS: mm [INCHES] | TOLERANCES UNLESS OTHERWISE SPECIFIED: | DIN 11-26-04                               | DOCKS 11-26-04            |
| 0. PLC ± -              | 1. PLC ± -                             | ATTADIA - DOCKS                            |                           |
| 2. PLC ± -.13 [.005]    | 3. PLC ± -                             | ROHDE                                      |                           |
| 4. PLC ± -              | ANGLES ± -                             | M. WALMSLEY 11-26-04                       | NAME                      |
| MATERIAL                | FINISH                                 | AMPMODU® SYSTEM 50, CONNECTOR, PADDLEBOARD |                           |
|                         |  | 108-1109                                   | PRODUCT SPEC              |
|                         |  | 114-25040                                  | APPLICATION SPEC          |
|                         |  | A1 00779                                   | SIZE CAGE CODE DRAWING NO |
|                         |  | 5111595                                    | RESTRICTED TO             |
|                         |  | SCALE 10:1                                 | SHEET 1 OF 2              |
|                         |  | CUSTOMER DRAWING                           | REV E                     |

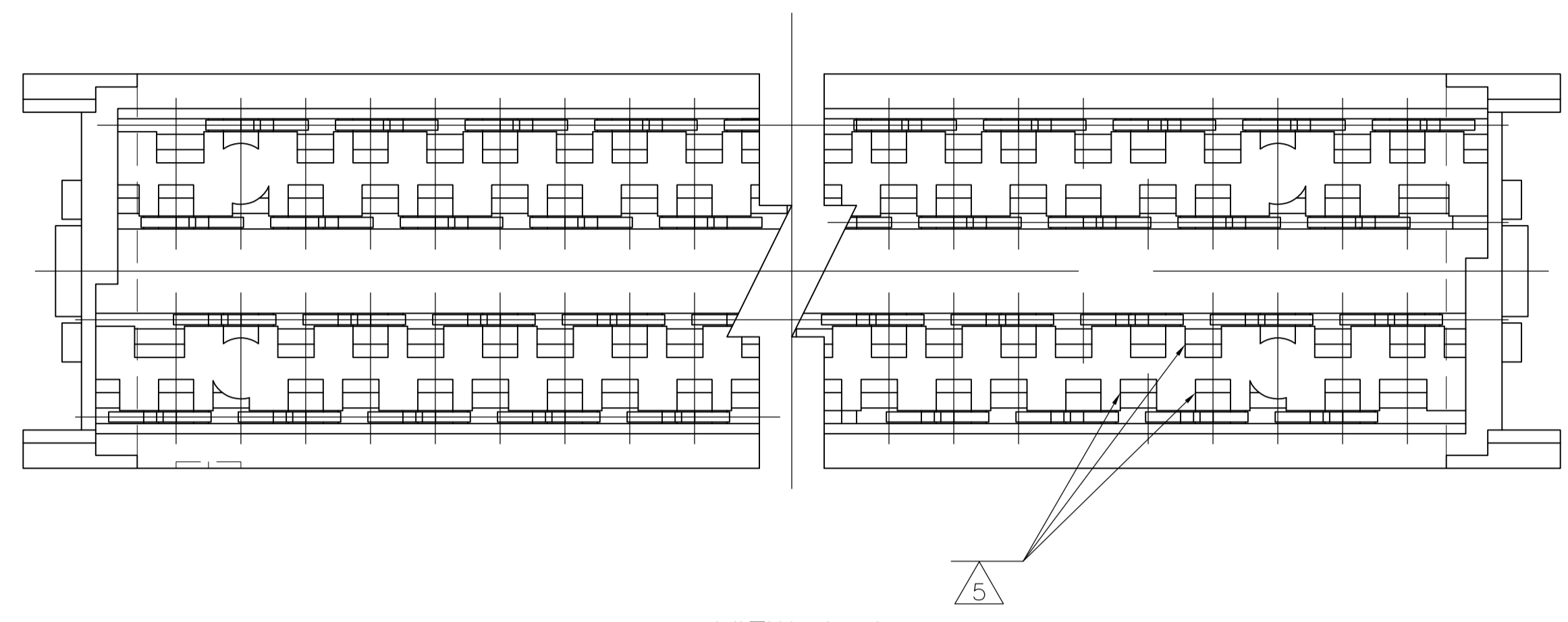

VIEW A-A  
(COVER REMOVED FOR CLARITY)

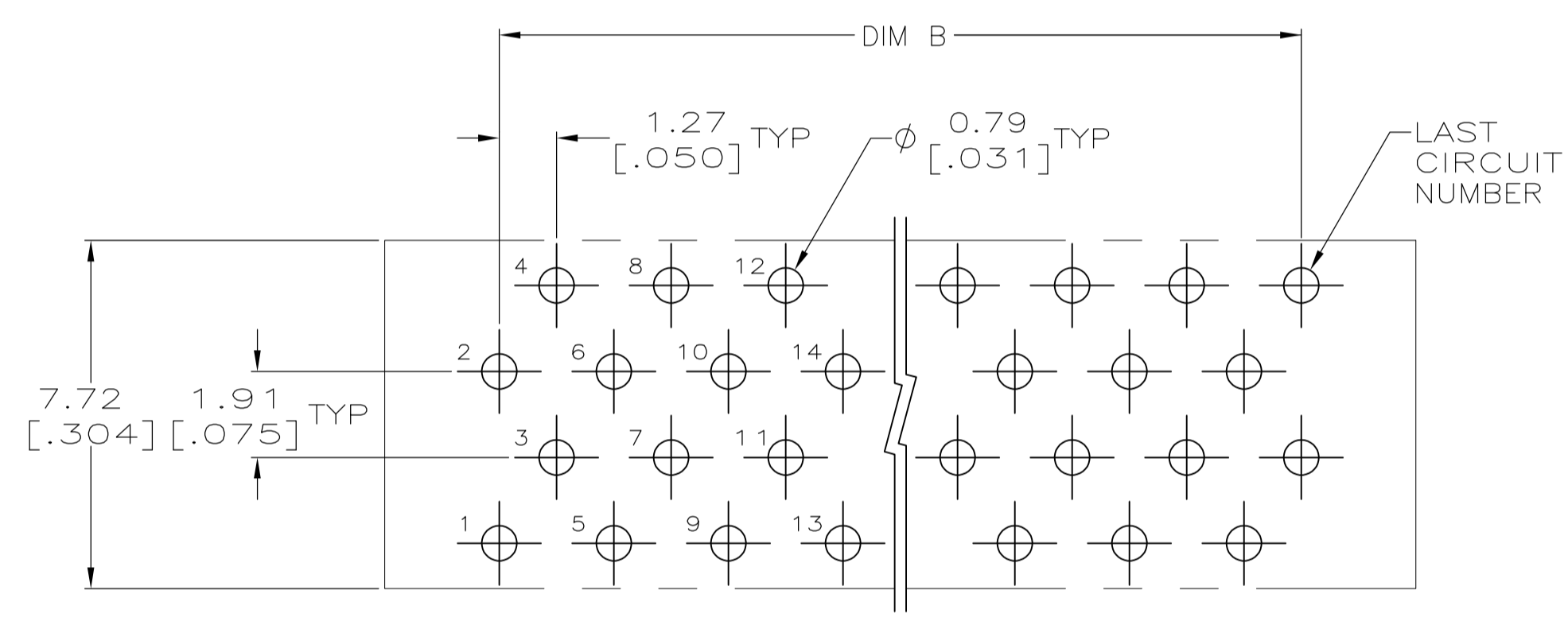

PRINTED CIRCUIT BOARD HOLE LAYOUT #2

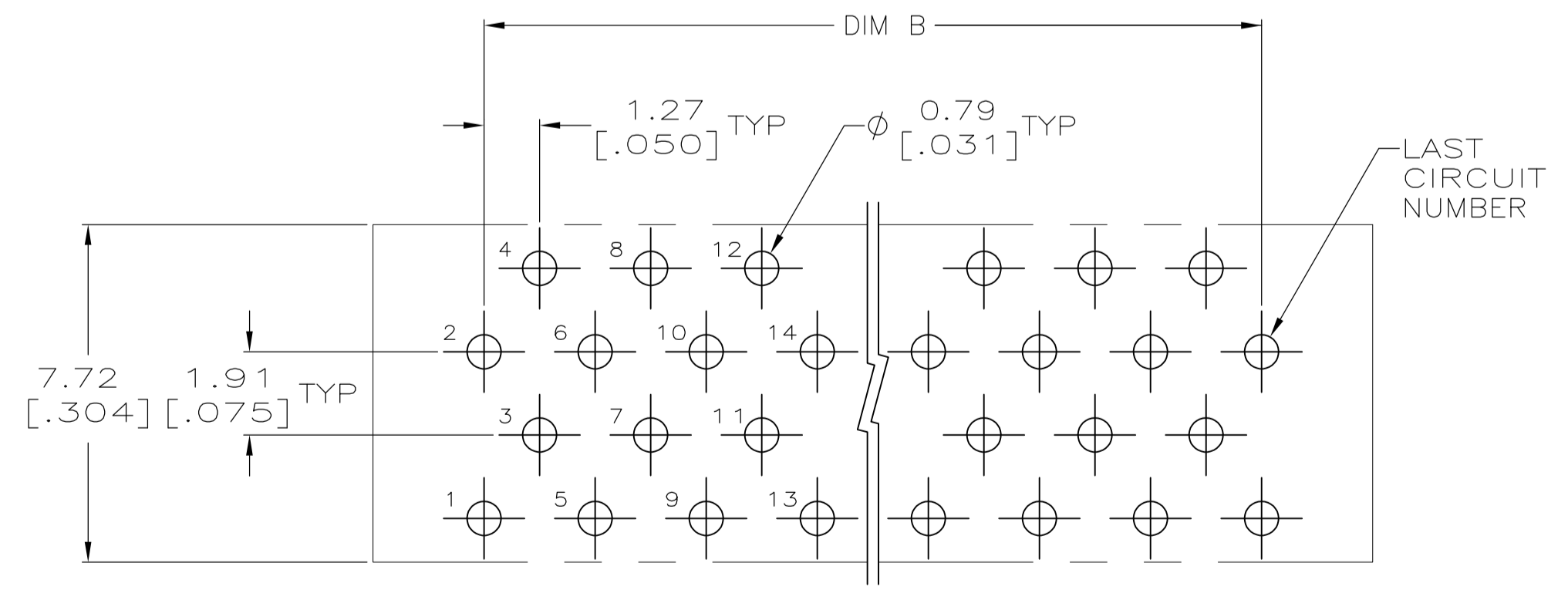

PRINTED CIRCUIT BOARD HOLE LAYOUT #1

|  |                       |                                |  |
|--|-----------------------|--------------------------------|--|
| THIS DRAWING IS A CONTROLLED DOCUMENT. DIMENSIONING AND TOLERANCING PER ASME Y14.5M-2009   |                       | DIN<br>G. ATTADIA<br>26NOV04   | TE Connectivity                                      |
| DIMENSIONS:<br>mm [INCHES]   |                       | CIR<br>C. ROHDE<br>26NOV04     |  |
| TOLERANCES UNLESS OTHERWISE SPECIFIED:   |                       | APVD<br>M. WALMSLEY<br>26NOV04 | NAME<br>AMPMODU SYSTEM 50,<br>CONNECTOR, PADDLEBOARD |
| <ul style="list-style-type: none"> <li>0. PLC ± -</li> <li>1. PLC ± -</li> <li>2. PLC ± -</li> <li>3. PLC ± -</li> <li>4. PLC ± -</li> <li>ANGLES ± -</li> </ul> |                       | APPLICATION SPEC               | RESTRICTED TO  |
| MATERIAL<br>SEE SHEET 1  | FINISH<br>SEE SHEET 1 | WEIGHT<br>-                    | SIZE<br>A1   |
| CUSTOMER DRAWING   |                       | SCALE<br>10:1                  | SHEET<br>2 OF 2                                      |
|  |                       | DRAWING NO.<br>00779           | REV<br>E   |
|  |                       | C=5111595                      |  |