

**Industrial Ethernet
IE-BS-V01M-SCRJ2SC-MM-C**

Weidmüller Interface GmbH & Co. KG
Klingenbergstraße 16
D-32758 Detmold
Germany
Fon: +49 5231 14-0
Fax: +49 5231 14-292083
www.weidmueller.com



Bayonet plug-in connector sets according to IEC
61076-3-106 ver.1 (EtherNet/IP), RJ45 metal insert incl.
SC insert

General ordering data

| | |
|------------|--|
| Type | IE-BS-V01M-SCRJ2SC-MM-C |
| Order No. | 1964450000 |
| Version | Flange FO, IP 67, Version 1, coupling from SCRJ on 2*SC, Multimode |
| GTIN (EAN) | 4032248649068 |
| Qty. | 10 pc(s). |

**Industrial Ethernet
IE-BS-V01M-SCRJ2SC-MM-C**

Weidmüller Interface GmbH & Co. KG
 Klingenbergstraße 16
 D-32758 Detmold
 Germany
 Fon: +49 5231 14-0
 Fax: +49 5231 14-292083
 www.weidmueller.com

Technical data
Dimensions and weights

Net weight 62.7 g

Temperatures

| | | | |
|-----------------------------|-------|--------------------------|----------------|
| Operating temperature, max. | 70 °C | Operating temperature | -40 °C...70 °C |
| Storage temperature | | Installation temperature | |

Downloads

GOST Approval POCC
 DE.ME25.B01411.pdf

General data

| | | | |
|-------------------|---------------|---------------------------|---------------------------------------|
| Colour | Miscellaneous | Connection 1 | SC |
| Connection 2 | SCRJ | Description of article | Version 1, coupling from SCRJ on 2*SC |
| Fibre type | Multimode | Housing main material | Zinc diecast |
| Insertion loss | ≤ 0.4 dB | Plugging cycles | 500 |
| Protection degree | IP 67 | Return loss (attenuation) | ≥ 30 dB |
| Seal material | NBR | | |

Standards

Connector standard IEC 61076-3-106 Var.
 1, IEC 61754-4, IEC
 61754-24

Classifications

| | | | |
|------------|-------------|------------|-------------|
| ETIM 3.0 | EC001121 | ETIM 4.0 | EC000437 |
| ETIM 5.0 | EC000437 | ETIM 6.0 | EC000437 |
| UNSPSC | 30-21-18-17 | eClass 5.1 | 27-26-12-03 |
| eClass 6.2 | 27-26-12-03 | eClass 7.1 | 27-25-05-04 |
| eClass 8.1 | 19-17-01-25 | eClass 9.0 | 19-17-01-25 |

Approvals

ROHS Conform

**Industrial Ethernet
IE-BS-V01M-SCRJ2SC-MM-C**

Weidmüller Interface GmbH & Co. KG
Klingenbergstraße 16
D-32758 Detmold
Germany
Fon: +49 5231 14-0
Fax: +49 5231 14-292083
www.weidmueller.com

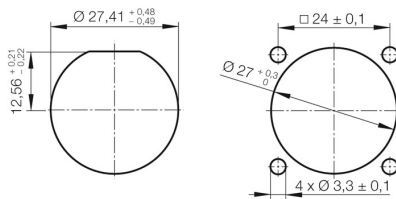
Drawings**Installation cut-out**

Mounting cut-out: 1. With central screw connection / 2. For mounting with four M3 screws