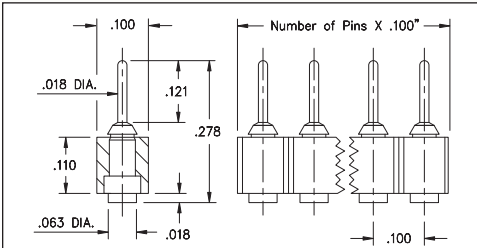
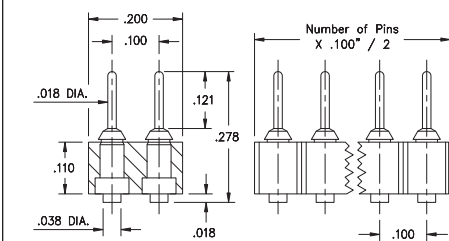


# INTERCONNECTS

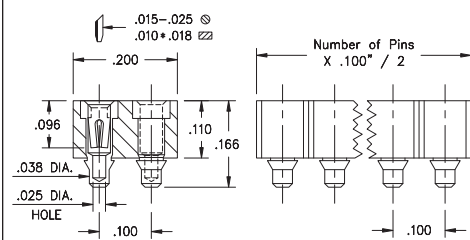
## SERIES 329, 340, 406, 414, 429 • .100" GRID SURFACE MOUNT HEADERS AND SOCKETS • SINGLE AND DOUBLE ROW STRIPS



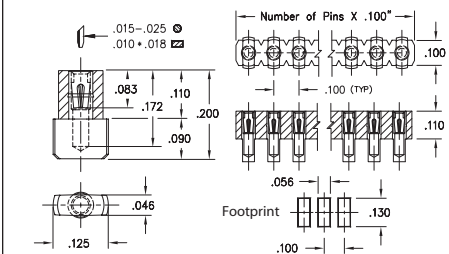
**FIG. 1**



**FIG. 2**

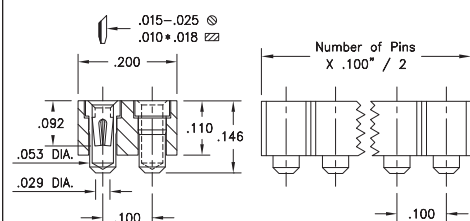


**FIG. 3**



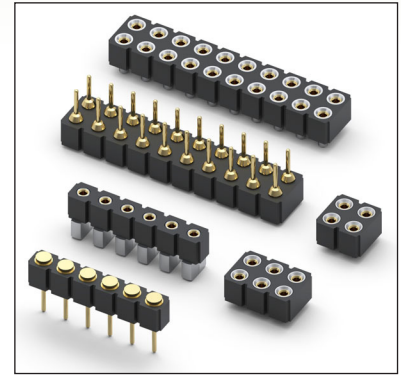
Coplanarity .005". For pin counts >24 positions, consult Technical Support.

**FIG. 4**



**FIG. 5**

- Series 329 and 429 pin interconnects feature space saving, pad style SMT termination using MM #2956-X pins. See page 218 for details
- Series 429 and 414 combine for a mated height of .323"
- Series 340, 406 and 414 surface mount sockets use MM #4078, #0668 and #1434 receptacles. See pages 162, 164 and 167 for details
- Series 340, 406 and 414 receptacles use Hi-Rel, 4-finger BeCu #30 contacts rated at 3 amps. Receptacles accept .015"-.025" diameter pins. See page 253 for details
- Insulators are high temperature thermoplastic, suitable for all soldering operations



### ORDERING INFORMATION

<b>FIG. 1</b>	<b>Series 329...560</b>	<b>Single Row Surface Mount Pin Header</b>					
	329-10-1__-00-560000		Specify number of pins	02-64			
<b>FIG. 2</b>	<b>Series 429...560</b>	<b>Double Row Surface Mount Pin Header</b>					
	429-10-2__-00-560000		Specify number of pins	04-72			
<b>SPECIFY PLATING CODE XX=</b>			10	◆			
Pin Plating			10 μ" Au				
<b>FIG. 3</b>	<b>Series 414...117</b>	<b>Double Row Surface Mount Socket</b>					
	414-XX-2__-41-117000		Specify number of pins	04-72			
<b>FIG. 4</b>	<b>Series 340...780</b>	<b>Single Row Surface Mount Socket</b>					
	340-XX-1__-30-780100		Specify number of pins	02-64			
<b>FIG. 5</b>	<b>Series 406...068</b>	<b>Double Row Surface Mount Socket</b>					
	406-43-2__-30-068000		Specify number of pins	04-20			
	<b>Tape and Reel Packaging</b>						
<b>Ordering Information:</b>			406-43-2XX-30-068001				
Available on 44mm wide tape, 355 parts per 13" reel			←				
			XX=Plating Code See Below		For Electrical, Mechanical & Environmental Data, See page 264		
<b>SPECIFY PLATING CODE XX=</b>				99	41	43	44
Sleeve (Pin)				200 μ" Sn/Pb	200 μ" Sn	200 μ" Sn	200 μ" Sn
Contact (Clip)				100 μ" Sn/Pb	10 μ" Au	30 μ" Au	100 μ" Sn

