

SIGN	DATE	DESCRIPTION	APPROVER
△			
THIS IS CAD DRAWING, DO NOT REVISE MANUALLY!!!			

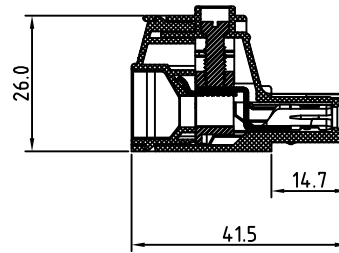
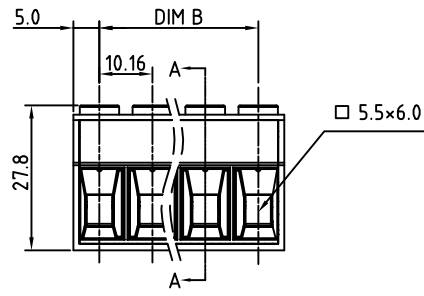
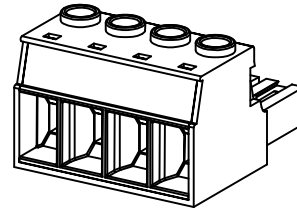
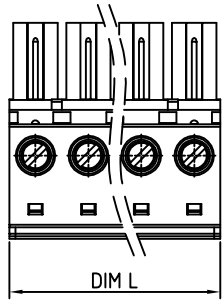

SECTION A-A

- Material**
- Insulating body Thermoplastic (UL94V-0)
 - Insulating cover Thermoplastic (UL94V-0)
 - Terminal screw Steel Cr3+ Zinc plating "-" slot type
 - Terminal body(house) Brass, Ni plated
 - Contact PIN PhBz (CuSn) Sn plated
 - Wire guard Stainless Steel

- Electrical cULus / IEC**
- Voltage rating: 600VAC / 1000VAC
 - Current rating: 55A / 76A
 - Solid wire: 6-20 / 0.5-16mm²
 - Stranded wire: 6-20 / 0.5-16mm²
 - Torque: 10.4 Lb-In / 1.2 N.m
 - Screw: M4
 - Wire strip length: 13-14mm
 - Withstanding Voltage: 2.2KV / 8KV
 - Operating temperature: -30°C to +105°C
 - Safety Approval: cULus

RoHS Compliant

PART NUMBER:

OSTEVXX6150

- | | |
|--------------|---------------------|
| No. of Poles | COLOR |
| 02 2 Poles | 0: Black |
| 03 3 Poles | 2: Red |
| ... | 5: Green (Standard) |
| 12 12 Poles | 8: Grey |

THESE DRAWINGS AND SPECIFICATIONS ARE THE PROPERTY OF ON-SHORE TECHNOLOGY, INC. AND SHALL NOT BE REPRODUCED, COPIED OR USED IN ANY MANNER WITHOUT THE PRIOR WRITTEN CONSENT OF ON-SHORE TECHNOLOGY, INC.

Poles	02	03	04	05	06	07	08	09	10	11	12
Dim L	20.16	30.32	40.48	50.64	60.80	70.96	81.12	91.28	101.44	111.60	121.76
Dim B	10.16	20.32	30.48	40.64	50.80	60.96	71.12	81.28	91.44	101.60	111.76
TOL	±0.25						±0.35				



TITLE		OST EV 10.16 Series 2p-12p			
PART NO.	OSTEVXX6150		DWG NO.	OSTEVXX6150.DWG	
APPROVED	CHECKED	DESIGNED	DRAWN	CUST NO.	Tolerance
		Aaron 2007.12.04	Aaron 2007.12.04		X. ±0.50 X.X ±0.30 X.XX ±0.10 X° ±1°
					UNIT: mm
				SHEET: 01/01	SCALE: NONE
				REV.: B	