

**ALL DIMENSIONS ARE REFERENCE  
(SEE XC-169-XX-XX-X-XX FOR CONTROLLING PRINT)**

DO NOT  
SCALE FROM  
THIS PRINT

CC69X-XXXX-01-X-XX

**SUPPLIED**  
-L: LOOSE  
-R: REEL

**LEAD STYLE**  
-2024 (20-24 AWG)  
-1620 (16-20 AWG)  
-2426 (24-26 AWG)(PTFE)

**OPTION**  
(INSULATION THICKNESS)  
-01

**MATERIAL SPECIFICATION**  
-SP: STANDARD POWER  
\* -HP: HIGH POWER

**PLATING**  
-T: MATTE TIN

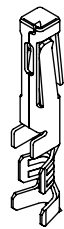

(SEE PP-C-169-XX-XX-X FOR PLATING INSTRUCTIONS)  
\* = EXISTING CUSTOMERS ONLY AS OF REV P

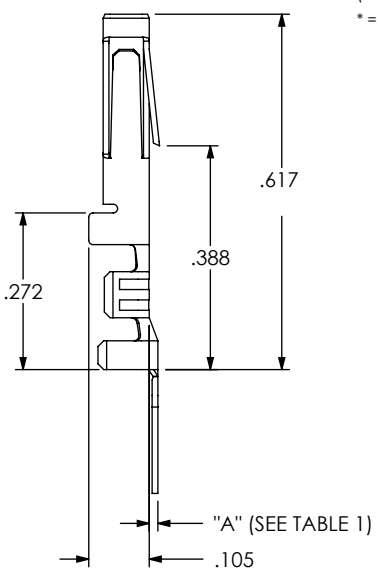
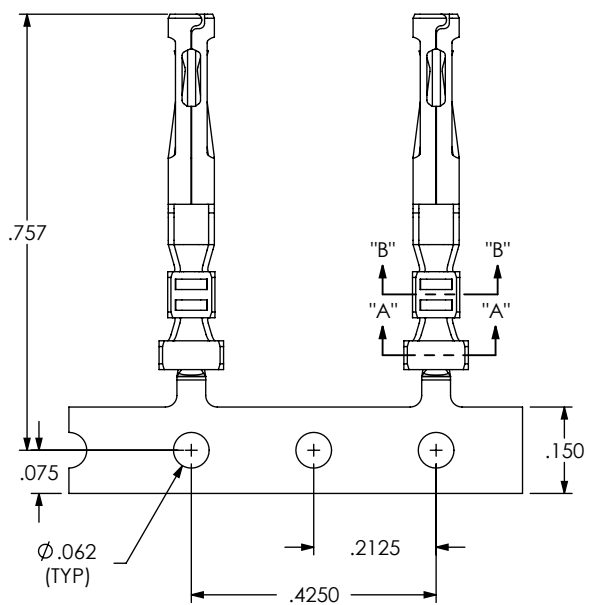
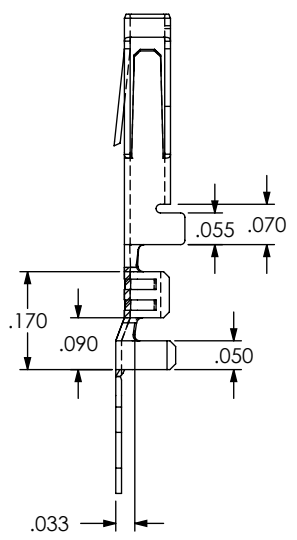

**FIG 1**  
(CC69X-XXXX-01-X-XX SHOWN)

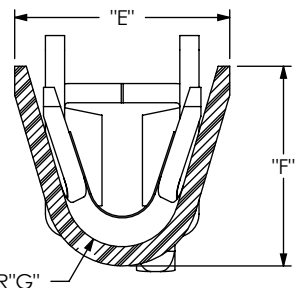

**SECTION "A"- "A"**  
SCALE 10 : 1

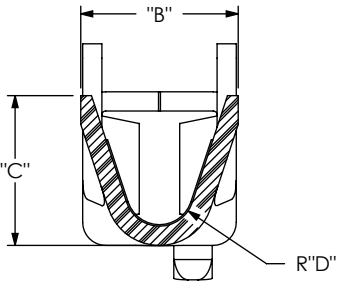

**SECTION "B"- "B"**  
SCALE 10 : 1

- NOTES:**
1. PLATED XC-169 PARTS TO BE PULLED, PLATING OPTION CONFIRMED, POSITIONED AS SHOWN ON SAMTEC REEL WITH VIEWPORTS, LABELED CC69R WITH APPROPRIATE PLATING CALLOUT AND LABEL PLACED AS SHOWN.
  2. MAXIMUM NO OF SPLICES PER REEL: 2.
  3. SPLICES ARE NOT TO BE CONNECTED.
  4. NUMBER OF SPLICES TO BE MARKED ON EACH REEL.
  5. REELED PARTS TO BE INTERLEAVED WITH PAPER BETWEEN EACH LAYER OF PARTS.
  6. ALLOWABLE INTERLEAF SPLICES PER REEL: 3.
  7. SECURELY CONNECT INTERLEAF SPLICE.
  8. OUTER WRAP SHALL RECEIVE PROTECTIVE REEL BAND PER BELOW: RB-24-1.00-P.
  9. DUE TO PLATING REQUIREMENTS CONTACT SAMPLES MAY BE REMOVED INTERMITTINGLY FROM THE CARRIER RESULTING IN SMALL GAPS BUT DOES NOT AFFECT FINAL COUNT.
  10. QTY PER REEL: 4,000 +100/-0 PCS.

**TABLE 1**

STYLE	"A"	"B"	"C"	"D"	"E"	"F"	"G"	"H"	"J"
-2024	.015	.082	.078	.018	.112	.104	.030	.005	30
-1620	.025	.110	.115	.025	.184	.168	.055	.005	30
-2426	.015	.082	.078	.018	.080	.067	.020	.005	30

UNLESS OTHERWISE SPECIFIED, DIMENSIONS ARE IN INCHES. TOLERANCES ARE:  
DECIMALS      ANGLES

**PROPRIETARY NOTE**  
THIS DOCUMENT CONTAINS INFORMATION CONFIDENTIAL AND PROPRIETARY TO SAMTEC, INC. AND SHALL NOT BE REPRODUCED OR TRANSFERRED TO OTHER DOCUMENTS OR DISCLOSED TO OTHERS OR USED FOR ANY PURPOSE OTHER THAN THAT WHICH IT WAS OBTAINED WITHOUT THE EXPRESSED WRITTEN CONSENT OF SAMTEC, INC.



520 PARK EAST BLVD, NEW ALBANY, IN 47150  
PHONE: 812-944-6733 FAX: 812-948-5047  
e-Mail: info@SAMTEC.com code 55322

**MATERIAL:** DO NOT SCALE DRAWING SHEET SCALE: 3:1  
-SP: PHOS BRONZE  
-HP: HIGH COPPER ALLOY  
THICKNESS: .0100

**DESCRIPTION:** .165 IPBD CONTACT  
**DWG. NO.** CC69X-XXXX-01-X-XX

REVISION X

TABLE 2								
P/N	AWG	STRANDS / AWG	INSULATION OD	"K"	"L"	"M"	"R" MAX (VESTIGE LENGTH)	"S" MAX (TAB LENGTH)
CC69X-2024-X	24	7/32	0.053-0.059	.0360	.0580	.128	.0020	.0200
	22	7/30	0.059-0.065	.0390	.0580	.128	.0020	.0200
	20	7/28	0.0660-0.0720	.0410	.0580	.128	.0020	.0200
CC69X-1620-X	20	7/28	0.097-0.103	.0470	.0740	.115	.0020	.0200
	18	16/30	0.107-0.113	.0520	.0740	.115	.0020	.0200
	18TC	19/30	0.0655-0.0688	.0520	.0740	.115	.0020	.0200
	16	26/30	0.121-0.125	.0620	.0740	.128	.0020	.0200
CC69X-2426-X	24TC	7/32	0.041-0.047	.0380	.0580	.128	.0020	.0200

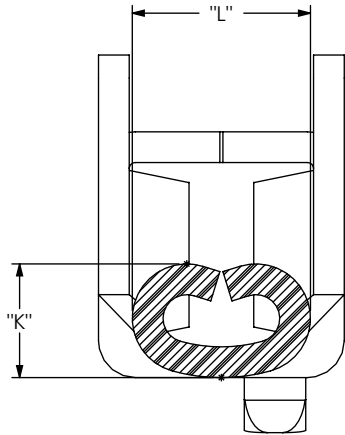

WIRE CRIMP  
SCALE 16:1

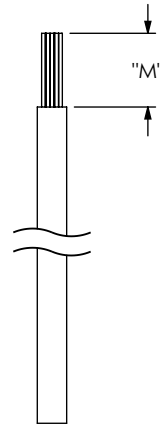

INSULATOR STRIP LENGTH

FIG 2  
RECOMENDED PROCESSING

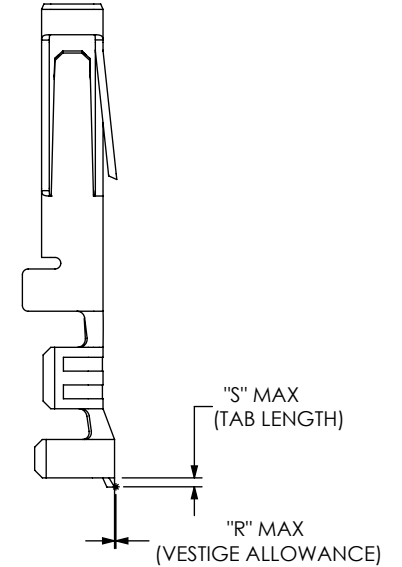

CARRIER TAB SPECIFICATION  
SCALE 4:1

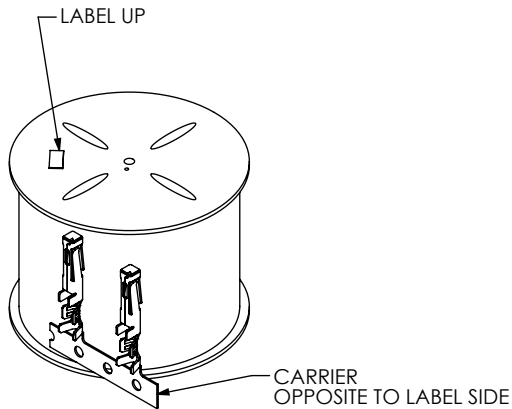

FIG 3  
REEL SPECIFICATIONS

UNWINDING DIRECTION

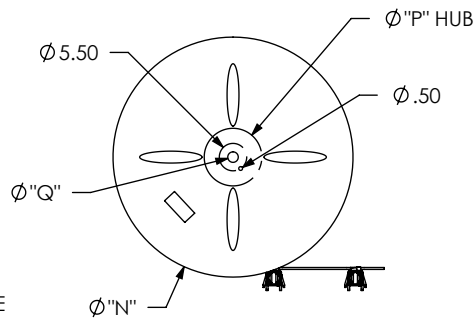

TABLE 3				
SUPPLIED	REEL PART NUMBER	"N"	"P"	"Q"
-R	R-24-08.00-1.00-P	24.00	8.000	1.125

**PROPRIETARY NOTE**  
THIS DOCUMENT CONTAINS INFORMATION CONFIDENTIAL AND PROPRIETARY TO SAMTEC, INC. AND SHALL NOT BE REPRODUCED OR TRANSFERRED TO OTHER DOCUMENTS OR DISCLOSED TO OTHERS OR USED FOR ANY PURPOSE OTHER THAN THAT WHICH IT WAS OBTAINED WITHOUT THE EXPRESSED WRITTEN CONSENT OF SAMTEC, INC.

DO NOT SCALE DRAWING

SHEET SCALE: 3:1

**samtec**

520 PARK EAST BLVD, NEW ALBANY, IN 47150  
PHONE: 812-944-6733 FAX: 812-948-5047  
e-Mail: info@SAMTEC.com code 55322

DESCRIPTION:  
.165 IPBD CONTACT

DWG. NO.  
CC69X-XXXX-01-X-XX

BY: BRATCHER 10/7/04

SHEET 2 OF 2