

THIS DRAWING IS UNPUBLISHED. RELEASED FOR PUBLICATION  
 © COPYRIGHT - By - ALL RIGHTS RESERVED.

LOC		DIST		REVISIONS					
FX		00		P	LTR	DESCRIPTION	DATE	DWN	APVD
				C1		REVISED PER ECO-11-005030	11MAR11	RK	HMR

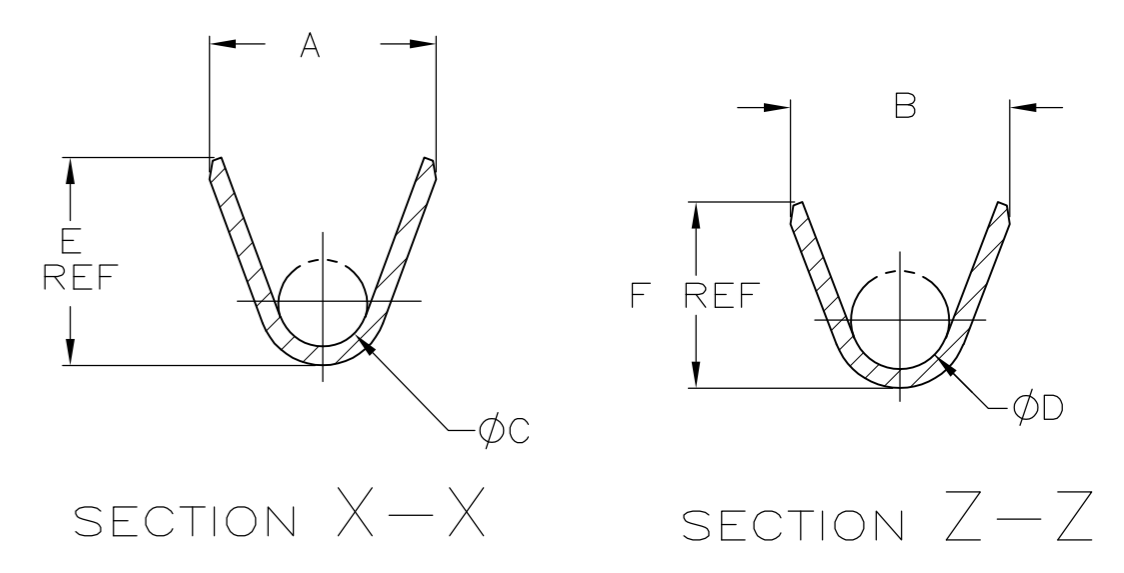
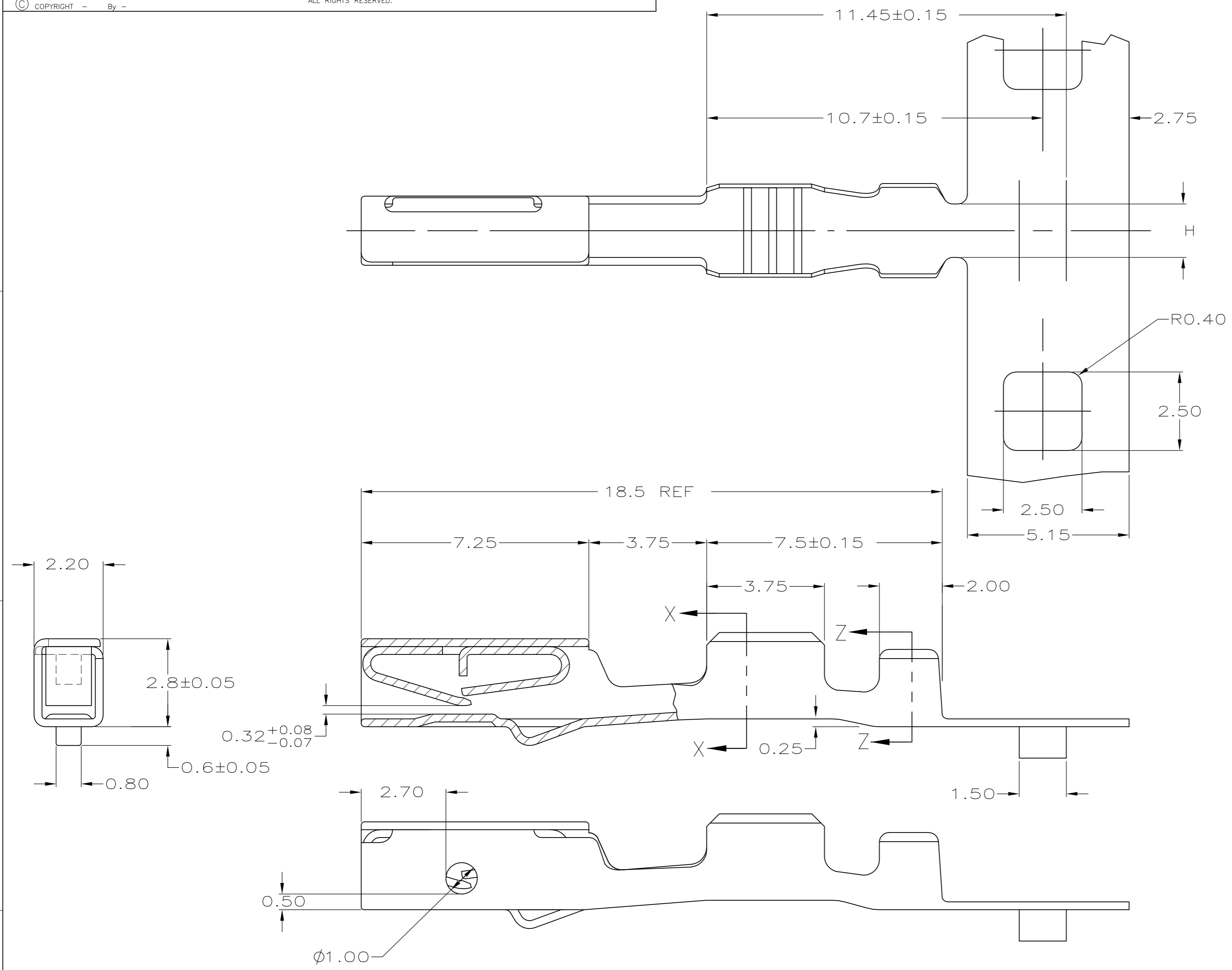

1 MATERIAL: 0.25 THK COPPER ALLOY, PRE-PLATED WITH 0.0008 MIN THK BRIGHT TIN.

638187-2 REELED LEFT TO RIGHT, OFF TOP, CARRIER INSIDE	638187-4		
638187-1 REELED LEFT TO RIGHT, OFF TOP, CARRIER INSIDE	638187-3		
1.6 1.80 2.04 1.45 0.90 2.40 2.30 0.35	22 638187-2		
1.6 1.80 2.04 1.45 0.90 2.40 2.30 0.34-0.36			
1.7 2.46 2.75 1.30 1.20 2.90 3.00 0.50	18-20 638187-1		
1.7 2.46 2.75 1.30 1.20 2.90 3.00 0.75			
1.7 2.46 2.75 1.30 1.20 2.90 3.00 1.00			
1.7 2.46 2.75 1.30 1.20 2.90 3.00 --			
H F E D C B A	METRIC WIRE SIZE	AWG	PART NUMBER

THIS DRAWING IS A CONTROLLED DOCUMENT.		DWN J MCNEAL 04-09-98	<b>STE</b> TE Connectivity	
DIMENSIONS: mm		CHK C PAUL 04-09-98		
TOLERANCES UNLESS OTHERWISE SPECIFIED:		APVD C PAUL 04-09-98	NAME RECEPTACLE CONTACT, DUAL BEAM	
0 PLC ± -		PRODUCT SPEC	SIZE CAGE CODE DRAWING NO RESTRICTED TO	
1 PLC ± 0.2		APPLICATION SPEC	A2 00779 C=638187	
2 PLC ± 0.1		114-6063	SCALE 4:1 SHEET 1 OF 1 REV C1	
3 PLC ± -		WEIGHT -		
4 PLC ± -		CUSTOMER DRAWING		
ANGLES ± 5°				
FINISH -				