

## Heavy Duty Connectors / Housing

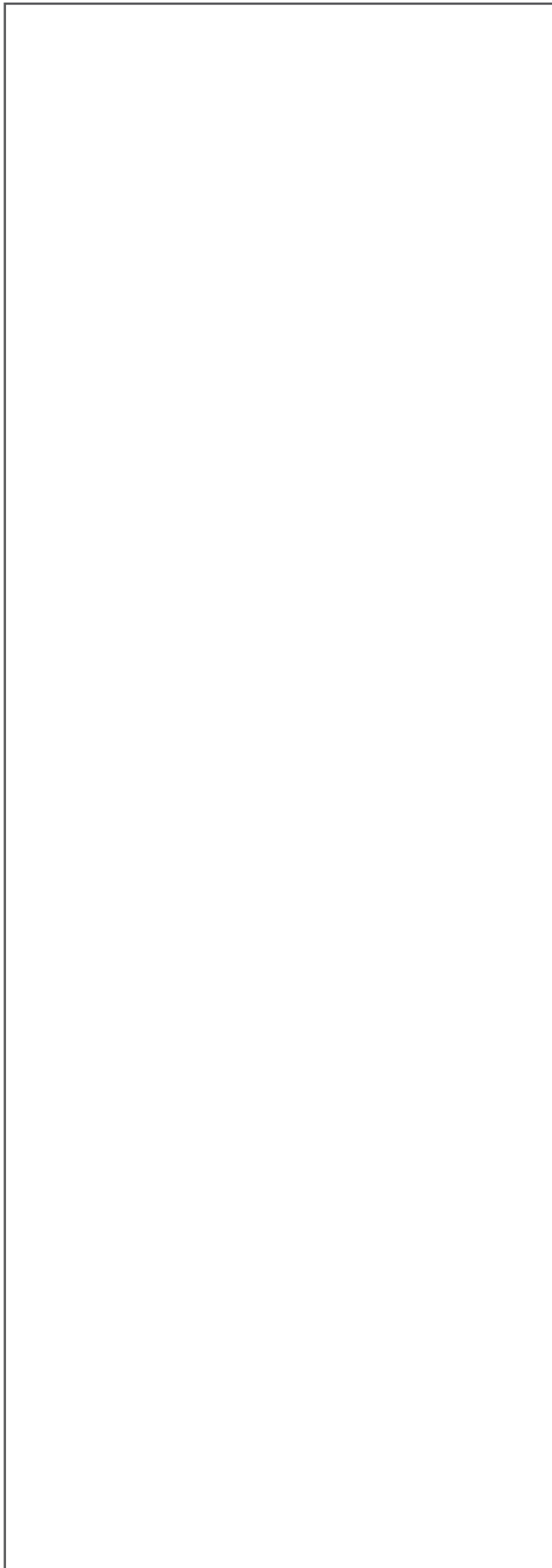

<b>RockClassic series</b>	
Overview	D.2 - D.3
<b>RockClassic – for standard use</b>	
Group size 1	D.4 - D.7
Group size 2	D.8 - D.9
Group size 3	D.10 - D.11
Group size 4	D.12 - D.17
Group size 5	D.18 - D.19
Group size 6	D.20 - D.25
Group size 7	D.26 - D.29
Group size 8	D.30 - D.35
Group size 9	D.36 - D.37
Group size 10	D.38 - D.42
Group size 12	D.43
<b>RockClassic Stainless – with corrosion protection</b>	
Group size 2	D.44
Group size 3	D.44
Group size 4	D.45
Group size 5	D.46
Group size 6	D.46 - D.47
Group size 8	D.47 - D.48
Group size 10	D.48
Group size 12	D.49
<b>RockStar series</b>	
Overview	D.50 - D.51
<b>RockStar Impact – for toughest demands</b>	
Group size 1	D.52
Group size 3	D.53
Group size 4	D.54
Group size 6	D.55
Group size 8	D.56 - D.57
<b>RockStar Shielded – with EMC-protection</b>	
Group size 1	D.58
Group size 3	D.59
Group size 4	D.60
Group size 6	D.61
Group size 8	D.62 - D.63
<b>RockStar Impact XXL – with maximum circuitry space</b>	
Group size 8	D.64
Group size 12	D.65
<b>RockStar Shielded XXL – with maximum circuitry space</b>	
Group size 8	D.66
Group size 12	D.67
<b>Motor connection housings</b>	
Group size 4	D.68

## RockClassic series

**RockClassic**  
– the solution for standard use

**RockClassic Stainless**  
– the version with corrosion protection



D

Weidmüller's RockClassic standard housings are robust enclosures made of aluminium die-casting or self-extinguishing thermoplastic (type HAD7).

They are available in different versions, with or without a fixed cover and with mobile protective covers.

RockClassic housings have metric or PG threads. Customers can use Weidmüller's specially developed PG-M Finder to identify every thread quickly and easily.

The black RockClassic Stainless housings with additionally hardened surface are ideal for particularly aggressive environmental and climatic conditions.

All metal parts consist of stainless steel to guarantee optimum corrosion protection.

Weidmüller also offers RockClassic housings with several cable entries as a standard feature.

This means that different cables can be introduced individually into the housings, offering the user enhanced strain relief and greater tightness. This version is particularly recommended when using Weidmüller's modular system.

- Sizes: 1, 2, 3, 4, 5, 6, 7, 8, 9, 10, 12
- Protection: IP65 / IP54 (plastic enclosure size 1)
- 2 types: high, low
- Fastening systems:
  - Side locking on top/bottom
  - End locking lever
  - Central lock in some cases
- Material: aluminium die-casting alloy
- Designs:
  - Silver-grey powder coating
  - Black corrosion protected

# RockClassic series

## Plug Hood Types

Plug hoods are used in most applications with the female inserts and the hot end of the connector. Modular connector inserts require a high configuration plug hoods.

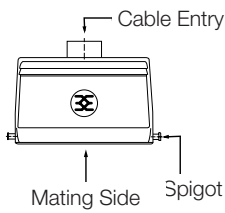
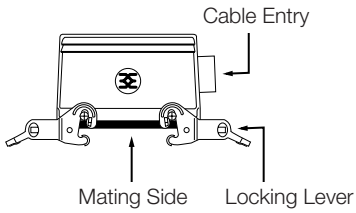

Side cable entry  
Side locking position  
Locking spigot  
Low construction



Side cable entry  
Center locking position  
One locking lever  
Low construction



Side cable entry  
End locking position  
Locking spigot  
High construction



Top cable entry  
Side locking position  
Two locking levers  
Low construction



Side cable entry  
End locking position  
Two locking levers  
High construction



Top cable entry  
End locking position  
Locking spigot  
High construction

## Bulkhead Housings

Bulkhead housings are used for tough panel bulkhead applications. Weidmüller supplies bulkhead housings with a gasket to create a seal between the panel cutout and the bulkhead housing. In addition, Weidmüller offers bulkhead housings with or without covers. For measurements of the panel cutout, see the dimensional drawings and chart on the page XIV.

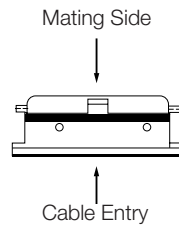

With cover  
Side locking position  
With locking spigot



Without cover  
Center locking position  
With locking spigot

## Base Housings

Base housing are used for surface mounting on a base plate. Weidmüller base housing are available for all pole numbers and group sizes and can have either one or two side-cable entries. Base housings are offered with or without covers.

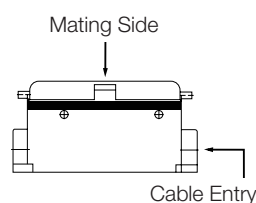

One side cable entry  
With cover  
Side locking position  
With locking spigot  
High construction



One side cable entry  
Without cover  
Side locking position  
With two locking levers  
Low construction

## Coupling Hoods

Coupling hoods, which are similar to plug hoods in almost every respect, are used with plug hoods to create a free standing coupling.

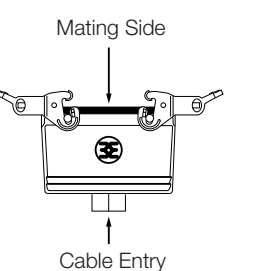

Top cable entry  
Without cover  
Side locking position  
With two locking levers  
High construction



Top cable entry  
Without cover  
End locking position  
With one locking lever  
High construction

# RockClassic

## Housing, tops Size 1 Metal housing

### Hood

### HA-3 TWVL

Cable entry sideways

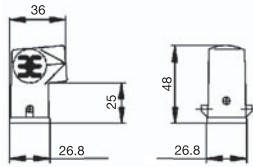

Metric version	Entry on top	Entry sideways	Qty.	Tall model	Standard model
w/o sleeve		1xM20	10		1788810000
<b>PG</b>					
w. sleeve		1xPG11	10		1652480000
w. cable gland		1xPG11	10		1498600000

### Hood

### HA-3 TOVL

Cable entry on top

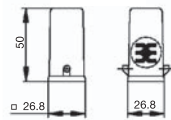

Metric version	Entry on top	Entry sideways	Qty.	Tall model	Standard model
w/o sleeve	1xM20		10		1788820000
<b>PG</b>					
w. sleeve	1xPG11		10		1652470000
w. cable gland	1xPG11		10		1498500000

Cable entry on top and on the side

Metric version	Entry on top	Entry sideways	Qty.	Tall model	Standard model
----------------	--------------	----------------	------	------------	----------------

### Cover for plug-, coupling- hood, bulkhead-, base housing

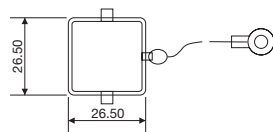

Version	Qty.	Order No.
for bush insertion	10	1665750000
for pin insertion	10	1665740000

## Housing, bottoms Size 1 Metal housing

### Bulkhead housing

### HA-3 AVL

Without cover

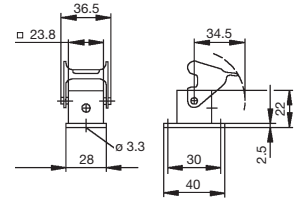

Version	Qty.	Standard model
	1	1497600000

### Bulkhead housing

### HA-3 AWL

with Cover

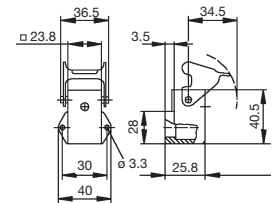

Version	Qty.	Standard model
	10	1497700000

### Cover for plug-, coupling- hood, bulkhead-, base housing

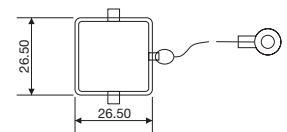

Version	Qty.	Order No.
for bush insertion	10	1665750000
for pin insertion	10	1665740000

# RockClassic

## Housing, bottoms Size 1

Metal housing

### Base housing

### HA-3 SVL

Without cover

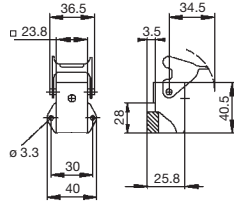

Metric version		Qty.	Tall model	Standard model
w. sleeve	1xM20	10		1788830000
<b>PG</b>				
w. sleeve	1xPG11	10		1652490000
w. cable gland	1xPG11	10		1497800000

## Housing, bottoms Size 1

Metal housing

### Coupling hood

### HA-3 KVL

Standard version

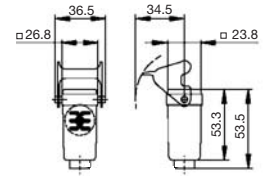

Metric version	Entry on top	Entry sideways	Qty.	Tall model	Standard model
w/o sleeve	1xM20		10		1788840000
<b>PG</b>					
w. sleeve	1xPG11		10		1652500000
w. cable gland	1xPG11		10		1497900000

### Cover for plug-, coupling- hood, bulkhead-, base housing

Version	Qty.	Order No.
for bush insertion	10	1665750000
for pin insertion	10	1665740000

### Cover for plug-, coupling- hood, bulkhead-, base housing

Version	Qty.	Order No.
for bush insertion	10	1665750000
for pin insertion	10	1665740000

Articles with coloured order number are kept permanently in stock at the central warehouse in Germany. Delivery times see page X.2

# RockClassic

## Housing, tops Size 1

Plastic housing

### Hood

### HAD-7 TWVL

Cable entry sideways

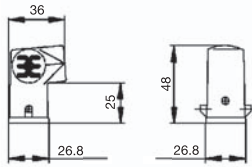

Metric version	Entry on top	Entry sideways	Qty.	Tall model	Standard model
w/o sleeve		1xM20	10		1788510000
<b>PG</b>					
w. sleeve		1xPG11	10		1652400000
w. cable gland		1xPG11	10		1652390000

## Housing, bottoms Size 1

Plastic housing

### Bulkhead housing

### HAD-7 AVL

Without cover

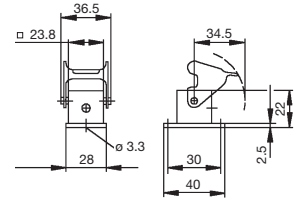

Version	Qty.	Standard model
	1	1652410000

D

### Hood

### HAD-7 TOVL

Cable entry on top

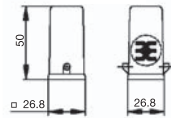

Metric version	Entry on top	Entry sideways	Qty.	Tall model	Standard model
w/o sleeve	1xM20		10		1788520000
<b>PG</b>					
w. sleeve	1xPG11		10		1652380000
w. cable gland	1xPG11		10		1652370000

### Bulkhead housing

### HAD-7 AWVL

with Cover

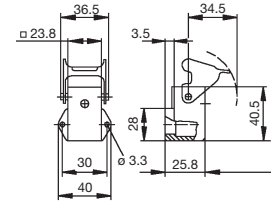

Version	Qty.	Standard model
	1	1652420000

Cable entry on top and on the side

Metric version	Entry on top	Entry sideways	Qty.	Tall model	Standard model
----------------	--------------	----------------	------	------------	----------------

### Cover for plug-, coupling- hood, bulkhead-, base housing

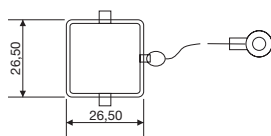

Version	Qty.	Order No.
for bush insertion	10	1665770000
for pin insertion	10	1665760000

### Cover for plug-, coupling- hood, bulkhead-, base housing

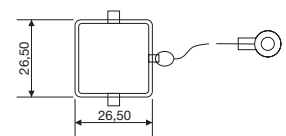

Version	Qty.	Order No.
for bush insertion	10	1665770000
for pin insertion	10	1665760000

# RockClassic

## Housing, bottoms Size 1

Plastic housing

### Base housing

### HAD-7 SVL

Without cover

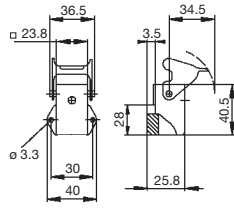

Metric version		Qty.	Tall model	Standard model
w/o sleeve	1xM20	10		<b>1788530000</b>
<b>PG</b>				
w. sleeve	1xPG11	10		<b>1652440000</b>
w. cable gland	1xPG11	10		<b>1652430000</b>

## Housing, bottoms Size 1

Plastic housing

### Coupling hood

### HAD-7 KVL

Standard version

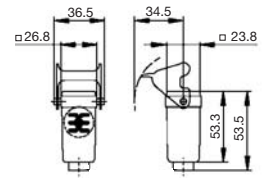

Metric version	Entry on top	Entry sideways	Qty.	Tall model	Standard model
w/o sleeve	1xM20		10		<b>1788540000</b>
<b>PG</b>					
w. sleeve	1xPG11		10		<b>1652460000</b>
w. cable gland	1xPG11		10		<b>1652450000</b>

### Cover for plug-, coupling- hood, bulkhead-, base housing

Version		Qty.	Order No.
for bush insertion		10	<b>1665770000</b>
for pin insertion		10	<b>1665760000</b>

### Cover for plug-, coupling- hood, bulkhead-, base housing

Version		Qty.	Order No.
for bush insertion		10	<b>1665770000</b>
for pin insertion		10	<b>1665760000</b>

Articles with coloured order number are kept permanently in stock at the central warehouse in Germany. Delivery times see page X.2

# RockClassic

## Housing, tops Size 2

End locking, bottom

### Hood

### HA-10 / HAD-15 TSVL

Cable entry sideways

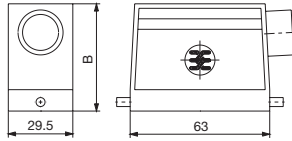

Tall model [mm] B = 67.3  
Standard model [mm] B = 53.5

Metric version	Entry on top	Entry sideways	Qty.	Tall model	Standard model
w. sleeve		1xM20	5		1788600000
w. sleeve		1xM25	5		1788590000
w/o sleeve		1xM20	5	1788860000	
w/o sleeve		1xM25	5	1788850000	
<b>PG</b>					
w. sleeve		1xPG16	5	1663850000	1663810000
w. cable gland		1xPG16	5	1663840000	1663800000
w. sleeve		1xPG21	5	1663870000	
w. cable gland		1xPG21	5	1663860000	

## Housing, bottoms Size 2

End locking, bottom

### Bulkhead housing

### HA-10 AVL

Without cover

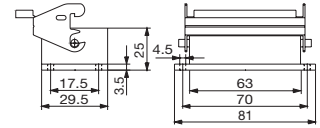

Version	Qty.	Standard model
	1	1664040000

D

### Hood

### HA-10 / HAD-15 TOVL

Cable entry on top

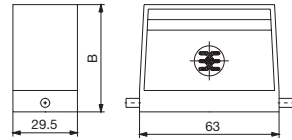

Tall model [mm] B = 67.3  
Standard model [mm] B = 53.5

Metric version	Entry on top	Entry sideways	Qty.	Tall model	Standard model
w/o sleeve	1xM20		5	1788880000	1788620000
w/o sleeve	1xM25		5	1788870000	1788610000
<b>PG</b>					
w. sleeve	1xPG16		5	1663970000	1663930000
w. cable gland	1xPG16		5	1663960000	1663920000
w. sleeve	1xPG21		5	1663990000	
w. cable gland	1xPG21		5	1663980000	

### Bulkhead housing

### HA-10 ADVL

with Cover

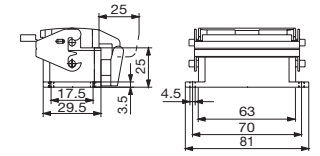

Version	Qty.	Standard model
	1	1664060000

Cable entry on top and on the side

Metric version	Entry on top	Entry sideways	Qty.	Tall model	Standard model

### Cover for hood

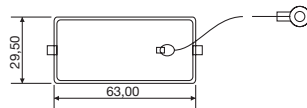

Version	Qty.	Order No.
	5	1665890000

### Cover for housing bottoms

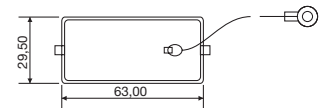

Version	Qty.	Order No.
	5	1665880000



# RockClassic

## Housing, bottoms Size 2 End locking, bottom

### Base housing

### HA-10 SVL

Without cover

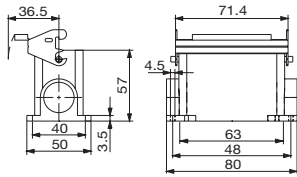

Metric version		Qty.	Tall model	Standard model
w/o sleeve	2xM20	5		1788640000
w/o sleeve	2xM25	5		1788630000
<b>PG</b>				
w. sleeve	1xPG16	5		1664170000
w. cable gland	1xPG16	5		1664160000
w. sleeve	1xPG21	5		1664210000
w. cable gland	1xPG21	5		1664200000
w. sleeve	2xPG16	5		1664190000
w. cable gland	2xPG16	5		1664180000

## Housing, bottoms Size 2 End locking, bottom

### Coupling hood

### HA-10 / HAD-15 KVL

Standard version

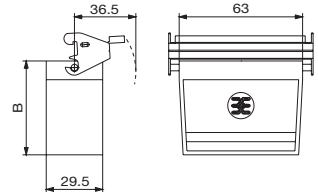

Metric version	Entry on top	Entry sideways	Qty.	Tall model	Standard model
w/o sleeve	1xM25		5	1788890000	1788670000
<b>PG</b>					
w. cable gland	1xPG16		5		1664560000
w. sleeve	1xPG21		2	1664630000	
w. cable gland	1xPG21		2	1664620000	

### Base housing

### HA-10 SDVL

With cover

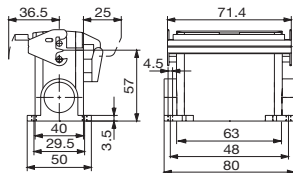

Metric version		Qty.	Tall model	Standard model
w/o sleeve	2xM20	5		1788660000
<b>PG</b>				
w. sleeve	1xPG16	5		1664410000
w. cable gland	1xPG16	5		1664400000

### Cover for housing bottoms

Version	Qty.	Order No.
	5	1665880000

### Cover for housing bottoms

Version	Qty.	Order No.
	5	1665880000

Articles with coloured order number are kept permanently in stock at the central warehouse in Germany. Delivery times see page X.2

# RockClassic

## Housing, tops Size 3

End locking, bottom

### Hood HB-6 / HBD-16 TSVL

Cable entry sideways

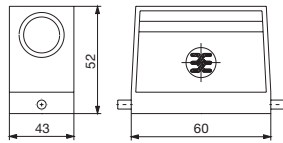

Tall model [mm] B = 72  
Standard model [mm] B = 52

Metric version	Entry on top	Entry sideways	Qty.	Tall model	Standard model
w. sleeve	1xM20	1xM20	10		1788100000
w/o sleeve	1xM20	1xM20	10		1805930000
w. sleeve	1xM25	1xM25	10		1788090000
w/o sleeve	1xM25	1xM25	10	1787480000	
<b>PG</b>					
w. sleeve	1xPG13	1xPG13	5		1670530000
w. cable gland	1xPG13	1xPG13	5		1201900000
w. sleeve	1xPG16	1xPG16	5		1652520000
w. cable gland	1xPG16	1xPG16	5		1652510000
w. sleeve	1xPG21	1xPG21	5	1652560000	
w. cable gland	1xPG21	1xPG21	5	1652550000	

### Hood HB-6 / HBD-16 TOVL

Cable entry on top

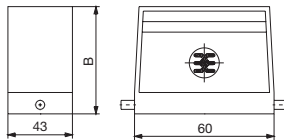

Tall model [mm] B = 72  
Standard model [mm] B = 52

Metric version	Entry on top	Entry sideways	Qty.	Tall model	Standard model
w/o sleeve	1xM20	1xM20	10		1788120000
w/o sleeve	1xM25	1xM25	10	1787500000	1788110000
w/o sleeve	1xM32	1xM32	10	1787490000	
<b>PG</b>					
w. sleeve	1xPG13	1xPG13	5		1670500000
w. cable gland	1xPG13	1xPG13	5		1201800000
w. sleeve	1xPG16	1xPG16	5		1652640000
w. cable gland	1xPG16	1xPG16	5		1652630000
w. sleeve	1xPG21	1xPG21	5	1652680000	
w. cable gland	1xPG21	1xPG21	5	1652670000	

### Hood HB-6 / HBD-16 TVL

Cable entry on top and on the side

Metric version	Entry on top	Entry sideways	Qty.	Tall model	Standard model
	1xM32	2xM16	10	1851840000	

### Cover for hood

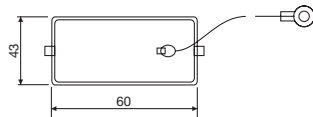

Version	Qty.	Order No.
	2	1665210000

## Housing, bottoms Size 3

End locking, bottom

### Bulkhead housing HB-6 AVL

Without cover

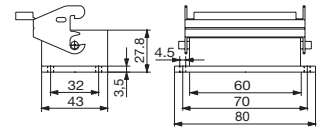

Version	Qty.	Standard model
	5	1202100000

### Bulkhead housing HB-6 ADVL

with Cover

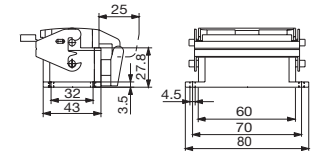

Version	Qty.	Standard model
	1	1202500000

### Cover for housing bottoms

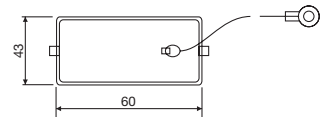

Version	Qty.	Order No.
	5	1665200000

# RockClassic

## Housing, bottoms Size 3

End locking, bottom

### Base housing

### HB-6 / HBD-16 SVL

Without cover

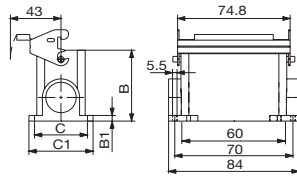

Tall model [mm] B = 74 / B1 = 6 / C = 45 / C1 = 58  
Standard model [mm] B = 54 / B1 = 4.5 / C = 40 / C1 = 54

Metric version		Qty.	Tall model	Standard model
w/o sleeve	2xM20	10		1788140000
w/o sleeve	2xM25	10	1787520000	1788130000
w/o sleeve	2xM32	10	1787510000	
<b>PG</b>				
w. sleeve	1xPG16	5		1652750000
w. cable gland	1xPG16	5		1202200000
w. sleeve	2xPG16	5		1652760000
w. cable gland	2xPG16	5		1202300000
w. sleeve	1xPG21	5	1652820000	
w. cable gland	1xPG21	5	1652810000	
w. sleeve	2xPG21	5	1652840000	

## Housing, bottoms Size 3

End locking, bottom

### Coupling hood

### HB-6 / HBD-16 KVL

Standard version

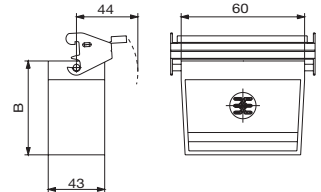

Tall model [mm] B = 74.8  
Standard model [mm] B = 54.8

Metric version	Entry on top	Entry sideways	Qty.	Tall model	Standard model
w/o sleeve	1xM20		5		1837550000
<b>PG</b>					
w. sleeve	1xPG16		5		1653200000
w. cable gland	1xPG16		5		1202400000
w. cable gland	1xPG21		5	1653230000	

### Base housing

### HB-6 / HBD-16 SDVL

With cover

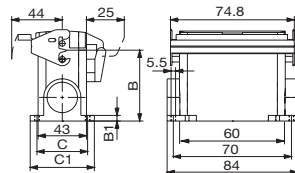

Tall model [mm] B = 74 / B1 = 6 / C = 45 / C1 = 58  
Standard model [mm] B = 54 / B1 = 4.5 / C = 40 / C1 = 54

Metric version		Qty.	Tall model	Standard model
w/o sleeve	1xM25	2	1787540000	1802240000
w/o sleeve	2xM20	10	1787530000	1788170000
w/o sleeve	2xM25	10		1788160000
<b>PG</b>				
w. sleeve	1xPG16	2		1652980000
w. cable gland	1xPG16	2	1653040000	1202600000
w. sleeve	2xPG16	2		1652990000
w. cable gland	2xPG16	2		1202700000

### Cover for housing bottoms

Version	Qty.	Order No.
	5	1665200000

### Cover for housing bottoms

Version	Qty.	Order No.
	5	1665200000

Articles with coloured order number are kept permanently in stock at the central warehouse in Germany. Delivery times see page X.2

# RockClassic

## Housing, tops Size 4

Side locking, bottom

## Housing, bottoms Size 4

Side locking, bottom

### Hood HB-10 / HBD-24 TSVU

### Bulkhead housing HB-10 AVU

Cable entry sideways

Without cover

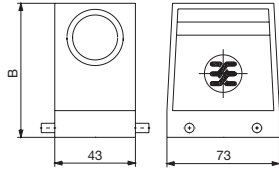

Tall model [mm] B = 72  
Standard model [mm] B = 52

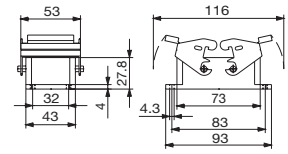

Metric version	Entry on top	Entry sideways	Qty.	Tall model	Standard model
w. sleeve		1xM20	10		1787560000
w. sleeve		1xM25	10		1787550000
w/o sleeve		1xM25	10	1787240000	
w/o sleeve		1xM32	10	1787230000	
<b>PG</b>					
w. sleeve		1xPG16	5		1654070000
w. cable gland		1xPG16	5		1204800000
w. sleeve		1xPG21	5	1654150000	1654090000
w. cable gland		1xPG21	5	1654140000	1654080000
w. sleeve		1xPG29	5	1654170000	
w. cable gland		1xPG29	5	1654160000	

Version	Qty.	Standard model
	1	1205000000

### Hood HB-10 / HBD-24 TOVU

Cable entry on top

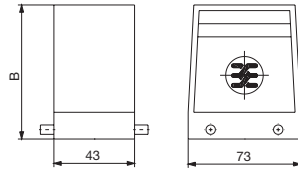

Tall model [mm] B = 72  
Standard model [mm] B = 52

Metric version	Entry on top	Entry sideways	Qty.	Tall model	Standard model
w/o sleeve	1xM20		10		1787600000
w/o sleeve	1xM25		10	1787300000	1787590000
w/o sleeve	1xM32		10	1787290000	
<b>PG</b>					
w. sleeve	1xPG16		5		1654220000
w. cable gland	1xPG16		5		1204700000
w. cable gland	1xPG21		5	1654290000	1654230000
w. sleeve	1xPG21		5		1654240000
w. sleeve	1xPG29		5	1654320000	
w. cable gland	1xPG29		5	1654310000	

### Hood HB-10 / HBD-24 TVU

Cable entry on top and on the side

Metric version	Entry on top	Entry sideways	Qty.	Tall model	Standard model
	1xM25	2xM16	10	1851850000	

### Cover for hood

### Cover for housing bottoms

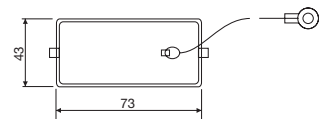
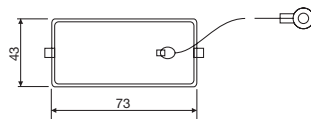

Version	Qty.	Order No.
	2	1665240000

Version	Qty.	Order No.
	5	1665230000

# RockClassic

## Housing, bottoms Size 4

Side locking, bottom

## Housing, bottoms Size 4

Side locking, bottom

### Base housing

### HB-10 / HBD-24 SVU

Without cover

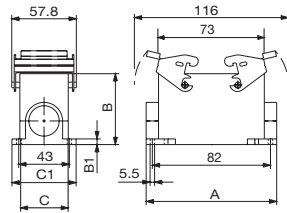

Tall model [mm] A = 97 / B = 74 / B1 = 6 / C = 45 / C1 = 58  
Standard model [mm] A = 94 / B = 57 / B1 = 4.5 / C = 40 / C1 = 54

Metric version		Qty.	Tall model	Standard model
w/o sleeve	2xM20	10		<b>1787640000</b>
w/o sleeve	2xM25	10	<b>1787350000</b>	<b>1787630000</b>
w/o sleeve	2xM32	10	<b>1787360000</b>	
<b>PG</b>				
w. sleeve	1xPG16	2		<b>1654370000</b>
w. cable gland	1xPG16	2		<b>1205100000</b>
w. sleeve	2xPG16	2		<b>1654380000</b>
w. cable gland	2xPG16	2		<b>1205200000</b>
w. sleeve	1xPG21	2	<b>1654430000</b>	
w. cable gland	1xPG21	2	<b>1654420000</b>	
w. sleeve	1xPG29	2	<b>1654470000</b>	
w. sleeve	2xPG21	2	<b>1654450000</b>	
w. cable gland	2xPG21	2	<b>1654440000</b>	
w. cable gland	2xPG29	2	<b>1654480000</b>	

### Coupling hood

### HB-10 / HBD-24 KVU

Standard version

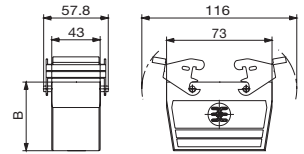

Tall model [mm] B = 74.8  
Standard model [mm] B = 54.8

Metric version	Entry on top	Entry sideways	Qty.	Tall model	Standard model
w/o sleeve	1xM20		10		<b>1787720000</b>
w/o sleeve	1xM25		10	<b>1787440000</b>	<b>1787710000</b>
w/o sleeve	1xM32		10	<b>1787430000</b>	
<b>PG</b>					
w. sleeve	1xPG16		5		<b>1654580000</b>
w. cable gland	1xPG16		5		<b>1205300000</b>
w. cable gland	1xPG21		5	<b>1654650000</b>	<b>1654590000</b>
w. cable gland	1xPG29		5	<b>1654670000</b>	

### Cover for housing bottoms

Version	Qty.	Order No.
	5	<b>1665230000</b>

### Cover for housing bottoms

Version	Qty.	Order No.
	5	<b>1665230000</b>

Articles with coloured order number are kept permanently in stock at the central warehouse in Germany. Delivery times see page X.2

# RockClassic

## Housing, tops Size 4 End locking, bottom

### Hood

### HB-10 / HBD-24 TSVL

Cable entry sideways

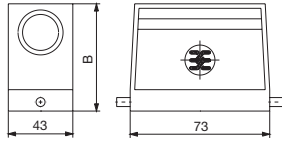

Tall model [mm] B = 72  
Standard model [mm] B = 52

Metric version	Entry on top	Entry sideways	Qty.	Tall model	Standard model
w. sleeve		1xM25	10		1787580000
w/o sleeve		1xM25	10	1787280000	
w/o sleeve		1xM32	10	1787270000	

### PG

w. sleeve		1xPG16	5		1655210000
w. cable gland		1xPG16	5		1206000000
w. sleeve		1xPG21	2	1655250000	
w. cable gland		1xPG21	2	1655240000	
w. sleeve		1xPG29	2	1655270000	
w. cable gland		1xPG29	2	1655260000	

### Hood

### HB-10 / HBD-24 TOVL

Cable entry on top

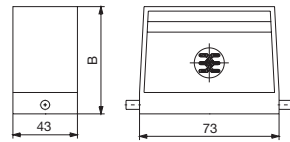

Tall model [mm] B = 72  
Standard model [mm] B = 52

Metric version	Entry on top	Entry sideways	Qty.	Tall model	Standard model
w/o sleeve	1xM25		10	1787340000	1787620000
w/o sleeve	1xM32		10	1787330000	

### PG

w. sleeve	1xPG16		5		1655320000
w. cable gland	1xPG16		5		1205900000
w. sleeve	1xPG21		2	1655360000	
w. cable gland	1xPG21		2	1655350000	
w. sleeve	1xPG29		2	1655380000	
w. cable gland	1xPG29		2	1655370000	

### Cable entry on top and on the side

Metric version	Entry on top	Entry sideways	Qty.	Tall model	Standard model

## Housing, bottoms Size 4 End locking, bottom

### Bulkhead housing

### HB-10 AVL

Without cover

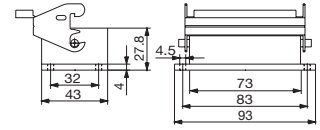

Version	Qty.	Standard model
	5	1206100000

### Bulkhead housing

### HB-10 ADVL

with Cover

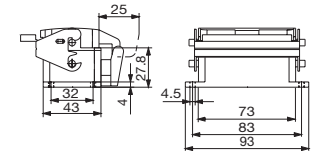

Version	Qty.	Standard model
	1	1206500000

# RockClassic

## Housing, bottoms Size 4 End locking, bottom

### Base housing

### HB-10 / HBD-24 SVL

Without cover

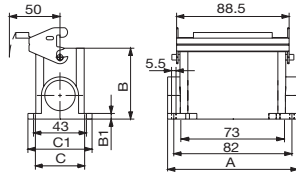

Tall model [mm] B = 74 / B1 = 6 / C = 45 / C1 = 58  
Standard model [mm] B = 57 / B1 = 4.5 / C = 40 / C1 = 54

Metric version		Qty.	Tall model	Standard model
w/o sleeve	2xM20	10		<b>1787660000</b>
w/o sleeve	2xM25	10	<b>1787380000</b>	<b>1787650000</b>
w/o sleeve	2xM32	10	<b>1787370000</b>	
<b>PG</b>				
w. sleeve	1xPG16	2		<b>1655460000</b>
w. cable gland	1xPG16	2		<b>1206200000</b>
w. sleeve	2xPG16	2		<b>1655470000</b>
w. cable gland	2xPG16	2		<b>1206300000</b>
w. cable gland	1xPG21	2	<b>1655510000</b>	
w. cable gland	1xPG29	2	<b>1655550000</b>	

## Housing, bottoms Size 4 End locking, bottom

### Coupling hood

### HB-10 / HBD-24 KVL

Standard version

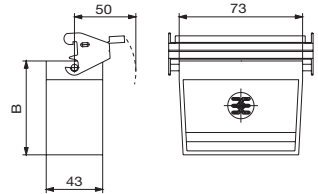

Tall model [mm] B = 74.8  
Standard model [mm] B = 54.8

Metric version	Entry on top	Entry sideways	Qty.	Tall model	Standard model
w/o sleeve	1xM20		10		<b>1787740000</b>
w/o sleeve	1xM25		10	<b>1787460000</b>	<b>1787730000</b>
w/o sleeve	1xM32		10	<b>1787450000</b>	
<b>PG</b>					
w. sleeve	1xPG16		2		<b>1655890000</b>
w. cable gland	1xPG16		2		<b>1655880000</b>
w. cable gland	1xPG21		2		<b>1655900000</b>

### Base housing

### HB-10 / HBD-24 SDVL

With cover

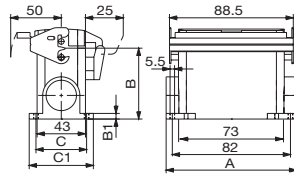

Tall model [mm] B = 74 / B1 = 6 / C = 45 / C1 = 58  
Standard model [mm] B = 57 / B1 = 4.5 / C = 40 / C1 = 54

Metric version		Qty.	Tall model	Standard model
w/o sleeve	2xM20	10	<b>1787420000</b>	<b>1787700000</b>
w/o sleeve	2xM25	10	<b>1787410000</b>	<b>1787690000</b>
<b>PG</b>				
w. sleeve	1xPG16	2		<b>1655670000</b>
w. cable gland	1xPG16	2	<b>1655720000</b>	<b>1206600000</b>
w. sleeve	2xPG16	2		<b>1655680000</b>
w. cable gland	2xPG16	2		<b>1206700000</b>

# RockClassic

## Top Size 4

Side locking, top

## Bottom Size 4

Side locking, top

### Hood

### HB-10 / HBD-24 TSVO

Cable entry sideways

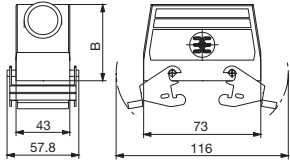

Tall model [mm] B = 72  
Standard model [mm] B = 52

Metric version	Entry on top	Entry sideways	Qty.	Tall model	Standard model
w. sleeve		1xM25	10		1787570000
w/o sleeve		1xM25	10	1787260000	
w/o sleeve		1xM32	10	1787250000	

### PG

w. sleeve		1xPG16	5		1654750000
w. cable gland		1xPG16	5		1205500000
w. sleeve		1xPG21	2	1654790000	
w. cable gland		1xPG21	2	1654780000	
w. sleeve		1xPG29	2	1654810000	
w. cable gland		1xPG29	2	1654800000	

### Hood

### HB-10 / HBD-24 TOVO

Cable entry on top

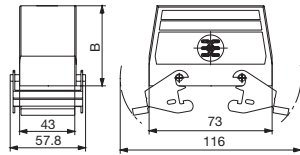

Tall model [mm] B = 72  
Standard model [mm] B = 52

Metric version	Entry on top	Entry sideways	Qty.	Tall model	Standard model
w/o sleeve	1xM25		10	1787320000	1787610000
w/o sleeve	1xM32		10	1787310000	

### PG

w. sleeve	1xPG16		5		1654860000
w. cable gland	1xPG16		5		1205400000
w. cable gland	1xPG21		2	1654890000	
w. sleeve	1xPG29		2	1654920000	
w. cable gland	1xPG29		2	1654910000	

### Bulkhead housing

### HB-10 ADVO

Without cover

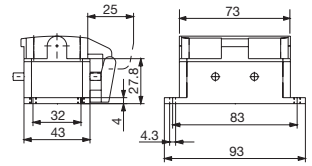

Metric version	Qty.	Standard model
	1	1205600000

### Base housing

### HB-10 / HBD-24 SDVO

Without cover

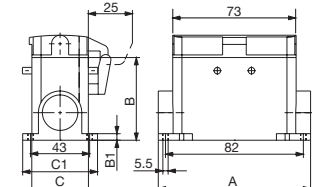

Tall model [mm] B = 74 / B1 = 6  
Standard model [mm] B = 57 / B1 = 4.5

Metric version	Entry on top	Entry sideways	Qty.	Tall model	Standard model
w/o sleeve		2xM20	10	1787400000	1787680000
w/o sleeve		2xM25	10	1787390000	1787670000

### PG

w. sleeve	1xPG16		2		1654990000
w. cable gland	1xPG16		2	1655050000	1205700000
w. sleeve	2xPG16		2		1655000000
w. cable gland	2xPG16		2	1655090000	1205800000
w. cable gland	2xPG29		1	1655110000	

### Cover for hood



Version	Qty.	Order No.
	5	1665250000





# RockClassic

## Housing, tops Size 5

End locking, bottom

## Housing, bottoms Size 5

End locking, bottom

### Hood

#### HA-16 / HAD-25 TSVL

Cable entry sideways

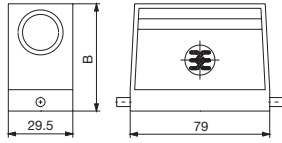

Tall model [mm] B = 72.3  
Standard model [mm] B = 58.3

Metric version	Entry on top	Entry sideways	Qty.	Tall model	Standard model
w. sleeve		1xM20	5		1804620000
w. sleeve		1xM25	5		1788740000
w/o sleeve		1xM20	5	1788680000	
w/o sleeve		1xM25	5	1788690000	
<b>PG</b>					
w. sleeve		1xPG16	5	1664730000	1664690000
w. cable gland		1xPG16	5	1664720000	1664680000
w. sleeve		1xPG21	5	1664750000	
w. cable gland		1xPG21	5	1664740000	

### Bulkhead housing

#### HA-16 AVL

Without cover

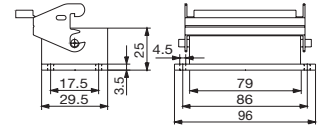

Version	Qty.	Standard model
	1	1664920000

D

### Hood

#### HA-16 / HAD-25 TOVL

Cable entry on top

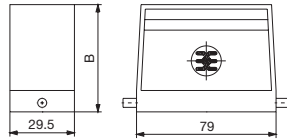

Tall model [mm] B = 72.3  
Standard model [mm] B = 58.3

Metric version	Entry on top	Entry sideways	Qty.	Tall model	Standard model
w/o sleeve	1xM20		5	1788710000	1804680000
w/o sleeve	1xM25		5	1788700000	1788750000
<b>PG</b>					
w. sleeve	1xPG16		5		1664810000
w. cable gland	1xPG16		5	1664840000	1664800000
w. sleeve	1xPG21		5	1664870000	
w. cable gland	1xPG21		5	1664860000	

### Bulkhead housing

#### HA-16 ADVL

with Cover

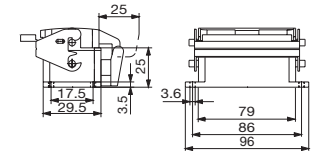

Version	Qty.	Standard model
	1	1664940000

### Cable entry on top and on the side

Metric version	Entry on top	Entry sideways	Qty.	Tall model	Standard model

### Cover for hood

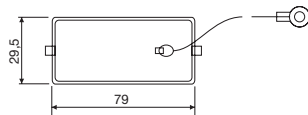

Version	Qty.	Order No.
	5	1665910000

### Cover for housing bottoms

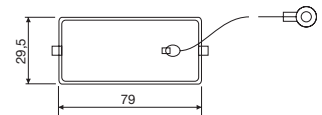

Version	Qty.	Order No.
	5	1665900000

# RockClassic

## Housing, bottoms Size 5 End locking, bottom

### Base housing

### HA-16 SVL

Without cover

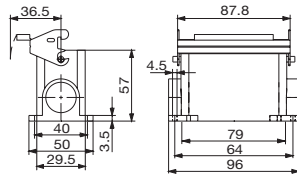

Metric version		Qty.	Tall model	Standard model
w/o sleeve	2xM20	5		1788770000
w/o sleeve	2xM25	5		1788760000
<b>PG</b>				
w. sleeve	1xPG16	5		1665050000
w. cable gland	1xPG16	5		1665040000
w. sleeve	1xPG21	5		1665090000
w. cable gland	1xPG21	5		1665080000
w. sleeve	2xPG16	2		1665070000
w. cable gland	2xPG16	2		1665060000
w. cable gland	2xPG21	2		1665100000

### Base housing

### HA-16 SDVL

With cover

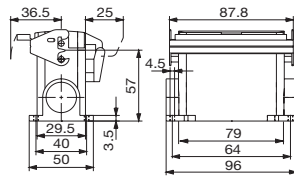

Metric version		Qty.	Tall model	Standard model
w/o sleeve	2xM20	5		1788790000
<b>PG</b>				
w. cable gland	1xPG16	2		1665280000
w. cable gland	2xPG16	2		1665300000
w. cable gland	2xPG21	2		1665340000

### Cover for housing bottoms

Version	Qty.	Order No.
	5	1665900000

## Housing, bottoms Size 5 End locking, bottom

### Coupling hood

### HA-16 / HAD-25 KVL

Standard version

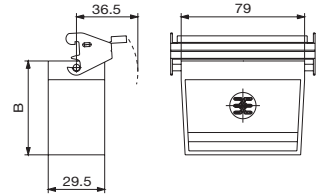

Tall model [mm] B = 67  
Standard model [mm] B = 53

Metric version	Entry on top	Entry sideways	Qty.	Tall model	Standard model
w/o sleeve	1xM25		5	1788720000	1788800000
w/o sleeve	1xM20		5	1788730000	
<b>PG</b>					
w. sleeve	1xPG16		5		1665450000
w. cable gland	1xPG16		5	1665480000	1665440000
w. cable gland	1xPG21		2	1665500000	

### Cover for housing bottoms

Version	Qty.	Order No.
	5	1665900000

Articles with coloured order number are kept permanently in stock at the central warehouse in Germany. Delivery times see page X.2

# RockClassic

## Housing, tops Size 6

Side locking, bottom

## Housing, bottoms Size 6

Side locking, bottom

### Hood

#### HB-16 / HBD-40 TSVU

Cable entry sideways

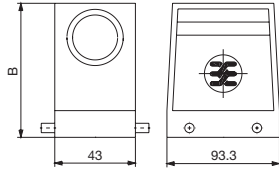

Tall model [mm] B = 76  
Standard model [mm] B = 61

Metric version	Entry on top	Entry sideways	Qty.	Tall model	Standard model
w. sleeve		1xM25	5		1788180000
w/o sleeve		1xM25	5	1787010000	
w/o sleeve		1xM32	5	1787000000	
<b>PG</b>					
w. sleeve		1xPG21	5	1656520000	1656480000
w. cable gland		1xPG21	5	1656510000	1208400000
w. sleeve		1xPG29	5	1656540000	
w. cable gland		1xPG29	5	1656530000	

### Bulkhead housing

#### HB-16 AVU

Without cover

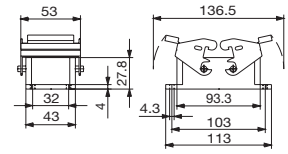

Version	Qty.	Standard model
	1	1208600000

D

### Hood

#### HB-16 / HBD-40 TOVU

Cable entry on top

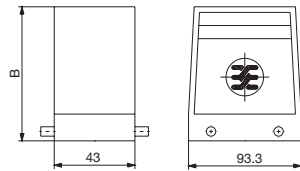

Tall model [mm] B = 76  
Standard model [mm] B = 61

Metric version	Entry on top	Entry sideways	Qty.	Tall model	Standard model
w/o sleeve	1xM25		5	1787070000	1788210000
w/o sleeve	1xM32		5	1787060000	
<b>PG</b>					
w. sleeve	1xPG21		5	1656630000	1656590000
w. cable gland	1xPG21		5	1656620000	1208300000
w. sleeve	1xPG29		5	1656650000	
w. cable gland	1xPG29		5	1656640000	

### Hood

#### HB-16 / HBD-40 TVU

Cable entry on top and on the side

Metric version	Entry on top	Entry sideways	Qty.	Tall model	Standard model
	1xM32	1xM25	5		1851860000

### Cover for hood

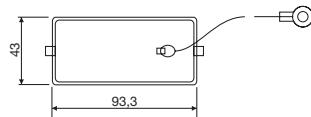

Version	Qty.	Order No.
	2	1665270000

### Cover for housing bottoms

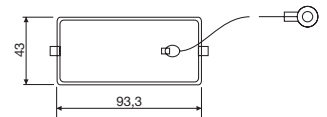

Version	Qty.	Order No.
	2	1665260000

# RockClassic

## Housing, bottoms Size 6

Side locking, bottom

## Housing, bottoms Size 6

Side locking, bottom

### Base housing

### HB-16 / HBD-40 SVU

Without cover

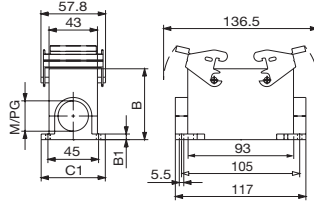

Tall model [mm] B = 84 / B1 = 6 / C1 = 58  
Standard model [mm] B = 64 / B1 = 4.5 / C1 = 57

Metric version		Qty.	Tall model	Standard model
w/o sleeve	1xM25	2		1802250000
w/o sleeve	2xM25	5	1787120000	1788240000
w/o sleeve	2xM32	5	1787110000	
<b>PG</b>				
w. sleeve	1xPG21	2		1656720000
w. cable gland	1xPG21	2	1656780000	1208700000
w. sleeve	2xPG21	2	1656810000	1656730000
w. cable gland	2xPG21	2	1656800000	1208800000
w. sleeve	1xPG29	2	1656830000	
w. cable gland	1xPG29	2	1656820000	
w. cable gland	2xPG29	2	1656840000	

### Coupling hood

### HB-16 / HBD-40 KVV

Standard version

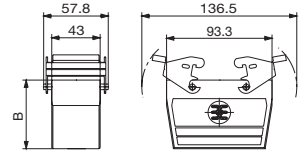

Tall model [mm] B = 78.8  
Standard model [mm] B = 63.8

Metric version	Entry on top	Entry sideways	Qty.	Tall model	Standard model
w/o sleeve	1xM25		5	1787200000	1788280000
w/o sleeve	1xM32		5	1787190000	
<b>PG</b>					
w. sleeve	1xPG21		2	1657310000	1657270000
w. cable gland	1xPG21		2	1657300000	1208900000
w. cable gland	1xPG29		2	1657320000	

### Cover for housing bottoms

Version	Qty.	Order No.
	2	1665260000

### Cover for housing bottoms

Version	Qty.	Order No.
	2	1665260000

Articles with coloured order number are kept permanently in stock at the central warehouse in Germany. Delivery times see page X.2

# RockClassic

## Housing, tops Size 6 End locking, bottom

### Hood

#### HB-16 / HBD-40 TSVL

Cable entry sideways

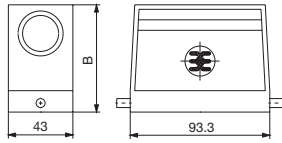

Tall model [mm] B = 76  
Standard model [mm] B = 61

Metric version	Entry on top	Entry sideways	Qty.	Tall model	Standard model
w. sleeve		1xM25	5		1788200000
w/o sleeve		1xM32	5	1787040000	1804640000
w/o sleeve		1xM40	10		1804650000
w/o sleeve		1xM25	5	1787050000	
<b>PG</b>					
w. sleeve		1xPG21	5	1657890000	1657850000
w. cable gland		1xPG21	5	1657880000	1209600000
w. sleeve		1xPG29	5	1657910000	
w. cable gland		1xPG29	5	1657900000	

## Housing, bottoms Size 6 End locking, bottom

### Bulkhead housing

#### HB-16 AVL

Without cover

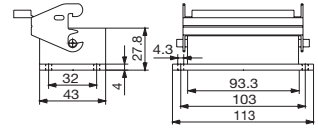

Version	Qty.	Standard model
	1	1209700000

D

### Hood

#### HB-16 / HBD-40 TOVL

Cable entry on top

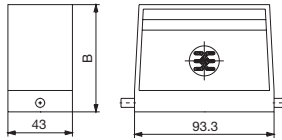

Tall model [mm] B = 76  
Standard model [mm] B = 61

Metric version	Entry on top	Entry sideways	Qty.	Tall model	Standard model
w/o sleeve	1xM25		5		1788230000
w/o sleeve	1xM32		10	1787100000	1804630000
<b>PG</b>					
w. sleeve	1xPG21		5	1658000000	1657960000
w. cable gland	1xPG21		5	1657990000	1209500000
w. sleeve	1xPG29		5	1658020000	
w. cable gland	1xPG29		5	1658010000	

### Bulkhead housing

#### HB-16 ADVL

with Cover

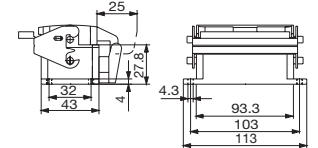

Version	Qty.	Standard model
	1	1210100000

### Hood

#### HB-16 / HBD-40 TVL

Cable entry on top and on the side

Metric version	Entry on top	Entry sideways	Qty.	Tall model	Standard model
	1xM25	1xM16, 1xM32	5	1851880000	

# RockClassic

## Housing, bottoms Size 6 End locking, bottom

### Base housing

### HB-16 / HBD-40 SVL

Without cover

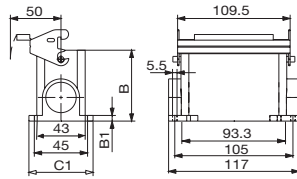

Tall model [mm] B = 84 / B1 = 6 / C1 = 58  
Standard model [mm] B = 64 / B1 = 4.5 / C1 = 57

Metric version		Qty.	Tall model	Standard model
w/o sleeve	2xM25	5	1787140000	1788250000
w/o sleeve	1xM32	5	1804660000	
w/o sleeve	1xM32	5	1787130000	
<b>PG</b>				
w. sleeve	1xPG21	2		1658110000
w. cable gland	1xPG21	2		1209800000
w. sleeve	2xPG21	2		1658120000
w. cable gland	2xPG21	2		1209900000
w. cable gland	1xPG29	2	1658200000	

## Housing, bottoms Size 6 End locking, bottom

### Coupling hood

### HB-16 / HBD-40 KVL

Standard version

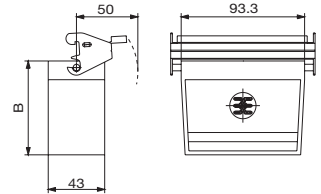

Tall model [mm] B = 78.5  
Standard model [mm] B = 63.5

Metric version	Entry on top	Entry sideways	Qty.	Tall model	Standard model
w/o sleeve	1xM25		5	1787220000	1788290000
w/o sleeve	1xM32		5	1787210000	
<b>PG</b>					
w. cable gland	1xPG21		2		1210000000
w. sleeve	1xPG21		2	1658570000	
w. cable gland	1xPG29		2	1658580000	

### Base housing

### HB-16 / HBD-40 SDVL

With cover

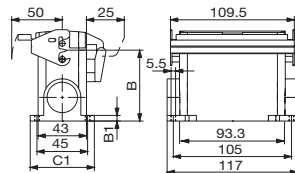

Tall model [mm] B = 84 / B1 = 6 / C1 = 58  
Standard model [mm] B = 64 / B1 = 4.5 / C1 = 57

Metric version		Qty.	Tall model	Standard model
w/o sleeve	2xM25	5	1787180000	1788270000
w/o sleeve	2xM32	5	1787170000	
<b>PG</b>				
w. sleeve	1xPG21	2	1658400000	1658320000
w. cable gland	1xPG21	2	1658370000	1210200000
w. sleeve	2xPG21	2		1658330000
w. cable gland	2xPG21	2	1658410000	1210300000
w. cable gland	2xPG29	2	1658430000	

# RockClassic

**Top Size 6**  
Side locking, top

**Bottom Size 6**  
Side locking, top

## Hood

### HB-16 / HBD-40 TSVO

Cable entry sideways

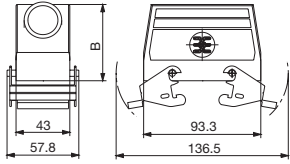

Tall model [mm] B = 76  
Standard model [mm] B = 61

Metric version	Entry on top	Entry sideways	Qty.	Tall model	Standard model
w. sleeve		1xM25	5		1788190000
w/o sleeve		1xM25	5	1787030000	
w/o sleeve		1xM32	5	1787020000	

## PG

w. sleeve		1xPG21	2	1657420000	1657380000
w. cable gland		1xPG21	2	1657410000	1209100000
w. cable gland		1xPG29	2	1657430000	

## Hood

### HB-16 / HBD-40 TOVO

Cable entry on top

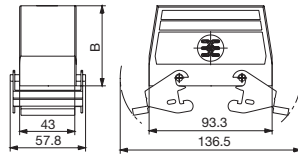

Tall model [mm] B = 76  
Standard model [mm] B = 61

Metric version	Entry on top	Entry sideways	Qty.	Tall model	Standard model
w/o sleeve	1xM25		5	1787090000	1788220000
w/o sleeve	1xM32		5	1787080000	

## PG

w. sleeve	1xPG21		2		1657490000
w. cable gland	1xPG21		2	1657520000	1209000000
w. sleeve	1xPG29		2	1657550000	
w. cable gland	1xPG29		2	1657540000	

## Cover for hood

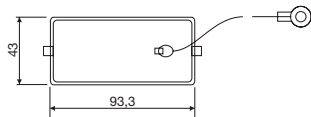

Version	Qty.	Order No.
	2	1665620000

## Bulkhead housing

### HB-16 ADVO

Without cover

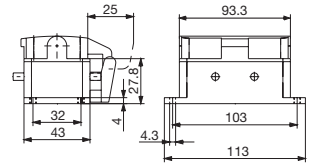

Metric version	Qty.	Standard model
	1	1209200000



# RockClassic

## Top Size 6

Central lock, top

## Bottom Size 6

Central lock, top

### Hood

### HBD-40 TSVZ

Cable entry sideways

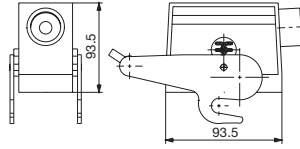

Metric version	Entry on top	Entry sideways	Qty.	Tall model	Standard model
<b>PG</b>					
w. cable gland		1xPG21	2	1658680000	
w. cable gland		1xPG29		1658700000	

### Bulkhead housing

### HB-16 AVZ

Without cover

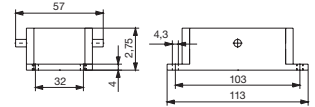

Metric version	Qty.	Standard model
	1	1611360000

### Base housing

### HB-16 / HBD-40 SVZ

Without cover

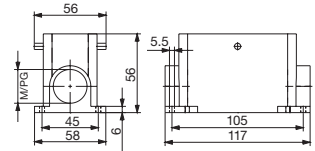

Metric version	Entry on top	Entry sideways	Qty.	Tall model	Standard model
<b>PG</b>					
w. sleeve		1xPG21	2		1600610000
w. cable gland		2xPG21	2		1658870000

# RockClassic

## Housing, tops Size 7

Side locking, bottom

## Housing, bottoms Size 7

Side locking, bottom

### Hood

#### HA-32 TSVU

Cable entry sideways

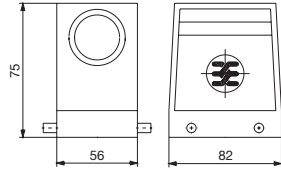

### Bulkhead housing

#### HA-32 AVU

Without cover

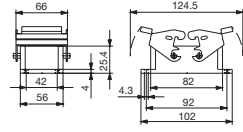

Metric version	Entry on top	Entry sideways	Qty.	Tall model	Standard model
w/o sleeve		1xM25	5		1787960000
w/o sleeve		1xM32	5		1787950000
<b>PG</b>					
w. sleeve		1xPG21	2		1665670000
w. cable gland		1xPG21	2		1665660000
w. sleeve		1xPG29	2		1665690000
w. cable gland		1xPG29	2		1665680000

Version	Qty.	Standard model
	1	1665860000

D

### Hood

#### HA-32 TOVU

Cable entry on top

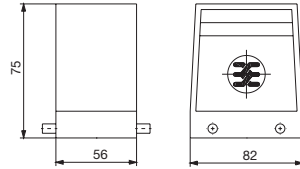

Metric version	Entry on top	Entry sideways	Qty.	Tall model	Standard model
w/o sleeve	1xM25		5		1788000000
w/o sleeve	1xM32		5		1787990000
<b>PG</b>					
w. sleeve	1xPG21		2		1665790000
w. cable gland	1xPG21		2		1665780000
w. sleeve	1xPG29		2		1665810000
w. cable gland	1xPG29		2		1665800000

Cable entry on top and on the side

Metric version	Entry on top	Entry sideways	Qty.	Tall model	Standard model
----------------	--------------	----------------	------	------------	----------------

### Cover for hood

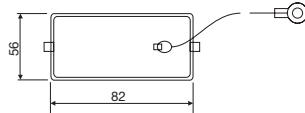

Version	Qty.	Order No.
	2	1665930000

### Cover for housing bottoms

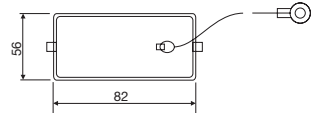

Version	Qty.	Order No.
	2	1665920000

# RockClassic

## Housing, bottoms Size 7

Side locking, bottom

## Housing, bottoms Size 7

Side locking, bottom

### Base housing

### HA-32 SVU

Without cover

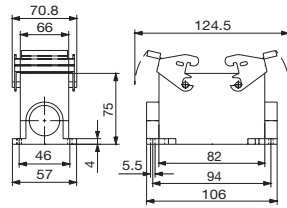

### Coupling hood

### HA-32 KVU

Standard version

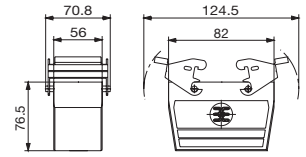

Metric version		Qty.	Tall model	Standard model
w/o sleeve	2xM20	5		1788040000
w/o sleeve	2xM32	5		1788030000
<b>PG</b>				
w. cable gland	1xPG21	2		1665960000
w. sleeve	1xPG29	2		1666010000
w. cable gland	1xPG29	2		1666000000
w. cable gland	2xPG21	2		1665980000
w. cable gland	2xPG29	2		1666020000

Metric version	Entry on top	Entry sideways	Qty.	Tall model	Standard model
w/o sleeve	1xM25		5		1788080000
w/o sleeve	1xM32		5		1788070000
<b>PG</b>					
w. cable gland	1xPG21		2		1666120000
w. cable gland	1xPG29		2		1666140000

### Cover for housing bottoms

Version	Qty.	Order No.
	2	1665920000

### Cover for housing bottoms

Version	Qty.	Order No.
	2	1665920000

Articles with coloured order number are kept permanently in stock at the central warehouse in Germany. Delivery times see page X.2

# RockClassic

**Top Size 7**  
Side locking, top

**Bottom Size 7**  
Side locking, top

## Hood

### HA-32 TSVO

Cable entry sideways

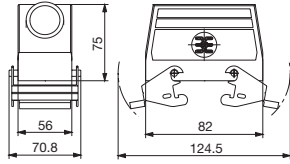

Without cover

Metric version	Entry on top	Entry sideways	Qty.	Tall model	Standard model
w/o sleeve		1xM25	5		1787980000
w/o sleeve		1xM32	5		1787970000
<b>PG</b>					
w. cable gland		1xPG21	2		1666240000
w. sleeve		1xPG29	2		1666270000
w. cable gland		1xPG29	2		1666260000

Metric version	Qty.	Standard model

D

## Hood

### HA-32 TOVO

Cable entry on top

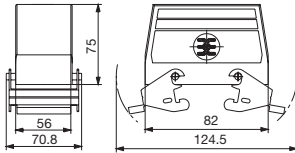

Metric version	Entry on top	Entry sideways	Qty.	Tall model	Standard model
w/o sleeve	1xM25		5		1788020000
w/o sleeve	1xM32		5		1788010000
<b>PG</b>					
w. cable gland	1xPG21		2		1666360000
w. cable gland	1xPG29		2		1666380000

## Base housing

### HA-32 SDVO

Without cover

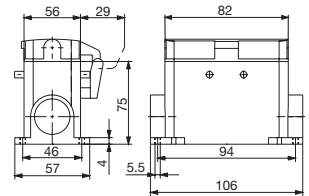

Metric version	Entry on top	Entry sideways	Qty.	Tall model	Standard model
w/o sleeve		2xM25	5		1788060000
w/o sleeve		2xM32	5		1788050000
<b>PG</b>					
w. sleeve		1xPG21	2		1666550000
w. cable gland		1xPG21	2		1666540000
w. sleeve		1xPG29	2		1666590000
w. cable gland		2xPG21	2		1666560000



# RockClassic

## Housing, tops Size 8 End locking, bottom

### Hood

### HB-24 / HBD-64 TSVU

Cable entry sideways

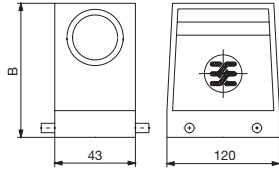

Tall model [mm] B = 76  
Standard model [mm] B = 61

Metric version	Entry on top	Entry sideways	Qty.	Tall model	Standard model
w. sleeve		1xM25	5		1787760000
w. sleeve		1xM32	5		1787750000
w/o sleeve		1xM25	5	1786780000	
w/o sleeve		1xM32	5	1786770000	
<b>PG</b>					
w. sleeve		1xPG21	2	1661300000	1661230000
w. cable gland		1xPG21	2	1661290000	1212100000
w. sleeve		1xPG29	2	1661320000	1661240000
w. cable gland		1xPG29	2	1661310000	1212200000

### Hood

### HB-24 / HBD-64 TOVU

Cable entry on top

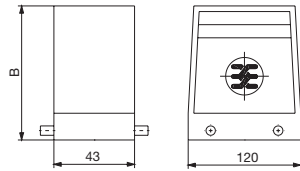

Tall model [mm] B = 76  
Standard model [mm] B = 61

Metric version	Entry on top	Entry sideways	Qty.	Tall model	Standard model
w/o sleeve	1xM25		5		1787820000
w/o sleeve	1xM32		5	1786830000	1787810000
<b>PG</b>					
w. sleeve	1xPG21		2	1661440000	1661370000
w. cable gland	1xPG21		2	1661430000	1211900000
w. sleeve	1xPG29		2	1661460000	1661380000
w. cable gland	1xPG29		2	1661450000	1212000000

### Hood

### HB-24 / HBD-64 TVU

Cable entry on top and on the side

Metric version	Entry on top	Entry sideways	Qty.	Tall model	Standard model
	1xM25	1xM16, 1xM32	5		1851890000

### Cover for hood

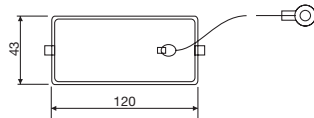

Version	Qty.	Order No.
	2	1665640000

## Housing, bottoms Size 8 End locking, bottom

### Bulkhead housing

### HB-24 AVU

Without cover

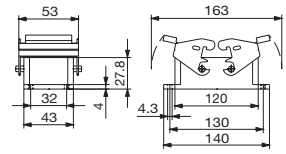

Version	Qty.	Standard model
	1	1212400000

### Cover for housing bottoms

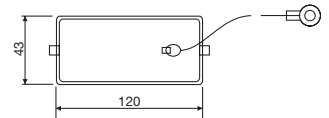

Version	Qty.	Order No.
	2	1665630000

# RockClassic

## Housing, bottoms Size 8 End locking, bottom

## Housing, bottoms Size 8 End locking, bottom

### Base housing

### HB-24 / HBD-64 SVU

Without cover

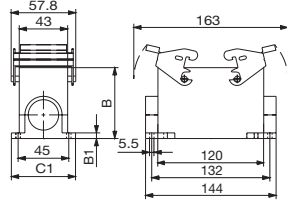

Tall model [mm] B = 84 / B1 = 6 / C1 = 58  
Standard model [mm] B = 64 / B1 = 4.5 / C1 = 57

Metric version		Qty.	Tall model	Standard model
w/o sleeve	1xM25	2		1802230000
w/o sleeve	2xM25	5	1786890000	1787870000
w/o sleeve	2xM32	5	1786880000	
<b>PG</b>				
w. sleeve	1xPG21	2	1661570000	1661510000
w. cable gland	1xPG21	2	1661560000	1212500000
w. sleeve	2xPG21	2	1661590000	1661520000
w. cable gland	2xPG21	2	1661580000	1212600000
w. sleeve	1xPG29	2	1661610000	
w. cable gland	1xPG29	2	1661600000	
w. sleeve	2xPG29	2	1661630000	
w. cable gland	2xPG29	2	1661620000	

### Coupling hood

### HB-24 / HBD-64 KVV

Standard version

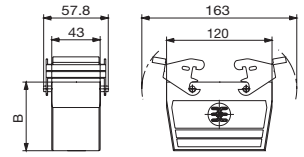

Tall model [mm] B = 78.8  
Standard model [mm] B = 63.8

Metric version	Entry on top	Entry sideways	Qty.	Tall model	Standard model
w/o sleeve	1xM25		5	1786970000	1787920000
w/o sleeve	1xM32		5	1786960000	1787910000
<b>PG</b>					
w. sleeve	1xPG21		2	1661790000	1661720000
w. cable gland	1xPG21		2	1661780000	1212700000
w. sleeve	1xPG29		2	1661810000	1661730000
w. cable gland	1xPG29		2	1661800000	1212800000

### Cover for housing bottoms

Version	Qty.	Order No.
	2	1665630000

### Cover for housing bottoms

Version	Qty.	Order No.
	2	1665630000

Articles with coloured order number are kept permanently in stock at the central warehouse in Germany. Delivery times see page X.2

# RockClassic

## Housing, tops Size 8

End locking, bottom

### Hood

### HB-24 / HBD-64 TSVL

Cable entry sideways

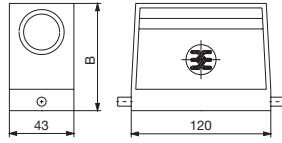

Tall model [mm] B = 76  
Standard model [mm] B = 61

Metric version	Entry on top	Entry sideways	Qty.	Tall model	Standard model
w. sleeve		1xM25	5		1787800000
w. sleeve		1xM32	5		1787790000
w/o sleeve		1xM25	5	1786820000	
w/o sleeve		1xM32	5	1786810000	
<b>PG</b>					
w. sleeve		1xPG21	2	1662470000	1662390000
w. cable gland		1xPG21	2	1662460000	1213800000
w. sleeve		1xPG29	2	1662490000	1662410000
w. cable gland		1xPG29	2	1662480000	1662400000

## Housing, bottoms Size 8

End locking, bottom

### Bulkhead housing

### HB-24 AVL

Without cover

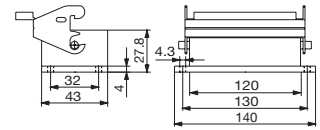

Version	Qty.	Standard model
	1	1213900000

D

### Hood

### HB-24 / HBD-64 TOVL

Cable entry on top

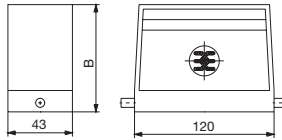

Tall model [mm] B = 76  
Standard model [mm] B = 61

Metric version	Entry on top	Entry sideways	Qty.	Tall model	Standard model
w/o sleeve	1xM25		5	1786870000	1787860000
w/o sleeve	1xM32		5	1786860000	1787850000
<b>PG</b>					
w. sleeve	1xPG21		2	1662610000	1662540000
w. cable gland	1xPG21		2		1213600000
w. sleeve	1xPG29		2	1662630000	1662550000
w. cable gland	1xPG29		2	1662620000	1213700000

### Bulkhead housing

### HB-24 ADVL

with Cover

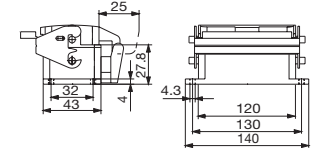

Version	Qty.	Standard model
	1	1214300000

### Hood

### HB-24 / HBD-64 TVL

Cable entry on top and on the side

Metric version	Entry on top	Entry sideways	Qty.	Tall model	Standard model
	1xM32	1xM25, 1xM16	5		1851910000



# RockClassic

## Housing, bottoms Size 8 End locking, bottom

### Base housing

### HB-24 / HBD-64 SVL

Without cover

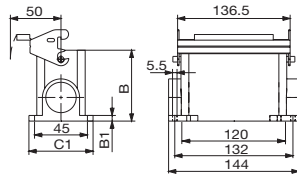

Tall model [mm] B = 84 / B1 = 6 / C1 = 58  
Standard model [mm] B = 64 / B1 = 4.5 / C1 = 57

Metric version		Qty.	Tall model	Standard model
w/o sleeve	2xM25	5	1786910000	1787880000
w/o sleeve	2xM32	5	1786900000	
<b>PG</b>				
w. sleeve	1xPG21	2		1662710000
w. cable gland	1xPG21	2	1662760000	1214000000
w. sleeve	2xPG21	2		1662720000
w. cable gland	2xPG21	2	1662780000	1214100000

## Housing, bottoms Size 8 End locking, bottom

### Coupling hood

### HB-24 / HBD-64 KVL

Standard version

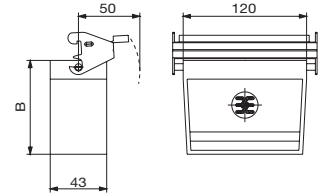

Tall model [mm] B = 78.8  
Standard model [mm] B = 63.8

Metric version	Entry on top	Entry sideways	Qty.	Tall model	Standard model
w/o sleeve	1xM25		5	1786990000	1787940000
w/o sleeve	1xM32		5	1786980000	1787930000
<b>PG</b>					
w. cable gland	1xPG21		2		1663130000
w. cable gland	1xPG29		2	1663220000	1214200000

### Base housing

### HB-24 / HBD-64 SDVL

With cover

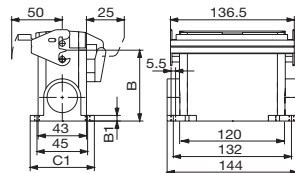

Tall model [mm] B = 84 / B1 = 6 / C1 = 58  
Standard model [mm] B = 64 / B1 = 4.5 / C1 = 57

Metric version		Qty.	Tall model	Standard model
w/o sleeve	2xM25	5	1786950000	1787900000
w/o sleeve	2xM32	5	1786940000	
<b>PG</b>				
w. sleeve	1xPG21	2	1663040000	1662920000
w. cable gland	1xPG21	2	1662970000	1214400000
w. cable gland	2xPG21	2	1663010000	1214500000

# RockClassic

**Top Size 8**  
Side locking, top

**Bottom Size 8**  
Side locking, top

## Hood

### HB-24 / HBD-64 TSVO

Cable entry sideways

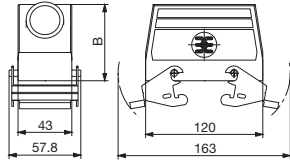
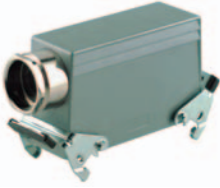

Tall model [mm] B = 76  
Standard model [mm] B = 61

Metric version	Entry on top	Entry sideways	Qty.	Tall model	Standard model
w. sleeve		1xM25	5		1787780000
w/o sleeve		1xM32	5	1786790000	1787770000
w/o sleeve		1xM25	5	1786800000	

## PG

w. sleeve		1xPG21	2	1661940000	1661860000
w. cable gland		1xPG21	2	1661930000	1213100000
w. sleeve		1xPG29	2	1661960000	1661880000
w. cable gland		1xPG29	2	1661950000	1661870000

## Hood

### HB-24 / HBD-64 TOVO

Cable entry on top

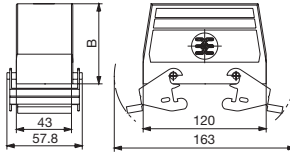

Tall model [mm] B = 76  
Standard model [mm] B = 61

Metric version	Entry on top	Entry sideways	Qty.	Tall model	Standard model
w/o sleeve	1xM25		5	1786850000	1787840000
w/o sleeve	1xM32		5	1804670000	1787830000

## PG

w. cable gland	1xPG21		2		1212900000
w. sleeve	1xPG29		2	1662100000	1662020000
w. cable gland	1xPG29		2	1662090000	1213000000
w. sleeve	1xPG21		2	1662080000	

## Cover for hood

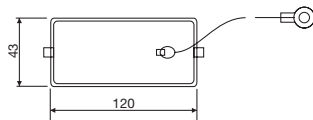

Version	Qty.	Order No.
	2	1665650000

## Bulkhead housing

### HB-24 ADVO

Without cover

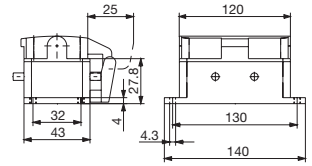

Metric version	Qty.	Standard model
	1	1213300000

## Base housing

### HB-24 / HBD-64 SDVO

Without cover

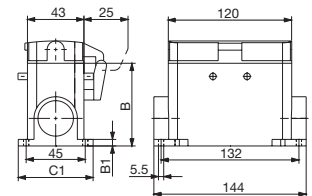

Tall model [mm] B = 84 / B1 = 6 / C1 = 58  
Standard model [mm] B = 64 / B1 = 4.5 / C1 = 57

Metric version	Entry on top	Entry sideways	Qty.	Tall model	Standard model
w/o sleeve		2xM25	5	1786930000	1787890000
w/o sleeve		2xM32	5	1786920000	

## PG

w. sleeve		1xPG21	2	1662280000	1662170000
w. cable gland		1xPG21	2	1662270000	1213400000
w. sleeve		2xPG21	2		1662180000
w. cable gland		2xPG21	2	1662250000	1213500000

# RockClassic

**Top Size 8**  
Central lock, top

**Bottom Size 8**  
Central lock, top

## Hood

### HBD-64 TSVZ

Cable entry sideways

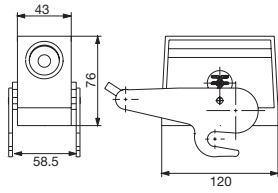

## Bulkhead housing

### HB-24 AVZ

Without cover

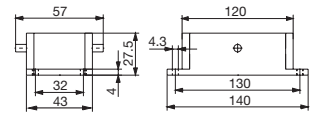

Metric version	Entry on top	Entry sideways	Qty.	Tall model	Standard model
<b>PG</b>					
w. sleeve		1xPG21	2	1663370000	
w. cable gland		1xPG21	2	1663360000	
w. cable gland		1xPG29	2	1603510000	

Metric version	Qty.	Standard model
	1	1611350000

## Base housing

### HB-24 / HBD-64 SVZ

Without cover

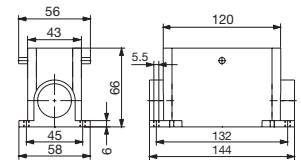

Metric version	Entry on top	Entry sideways	Qty.	Tall model	Standard model
<b>PG</b>					
w. cable gland		1xPG21	1		1600620000

# RockClassic

**Top Size 9**  
End locking, bottom

**Bottom Size 9**  
End locking, bottom

## Hood

### HA-48 TSVL

Cable entry sideways

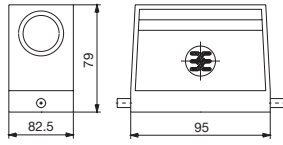

Metric version	Entry on top	Entry sideways	Qty.	Tall model	Standard model
w/o sleeve		1xM32	1		1788550000
<b>PG</b>					
w. sleeve		1xPG29	1		1666710000
w. cable gland		1xPG29	1		1666700000

## Bulkhead housing

### HA-48 ADVL

Without cover

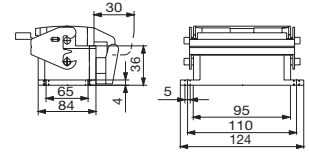

Metric version	Qty.	Standard model
	1	1666750000

D

## Hood

### HA-48 TOVL

Cable entry on top

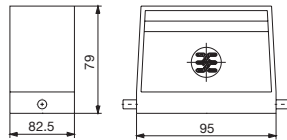

Metric version	Entry on top	Entry sideways	Qty.	Tall model	Standard model
w/o sleeve	1xM32		1		1788560000
<b>PG</b>					
w. sleeve	1xPG29		1		1666730000
w. cable gland	1xPG29		1		1666720000

## Base housing

### HA-48 SDVL

Without cover

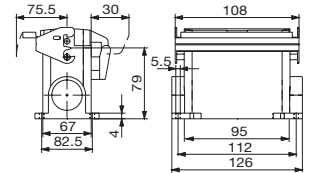

Standard model [mm] B = 79 / B1 = 4

Metric version	Entry on top	Entry sideways	Qty.	Tall model	Standard model
w. sleeve		1xM32	1		1824530000
w/o sleeve		2xM32	1		1788580000
w. sleeve w/o cover		1xM32	1		1824540000
w/o sleeve w/o cover		2xM32	1		1788570000
<b>PG</b>					
w. sleeve		1xPG29	1		1666810000
w. cable gland		1xPG29	1		1666800000
w. sleeve w/o cover		1xPG29	1		1666770000
w. cable gland w/o cover		1xPG29	1		1666760000



# RockClassic

## Housing, tops Size 10

Side locking, bottom

## Housing, bottoms Size 10

Side locking, bottom

### Hood

### HB-32 TSVU

Cable entry sideways

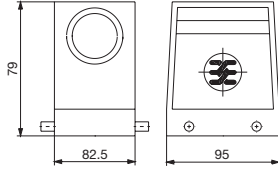

### Bulkhead housing

Without cover

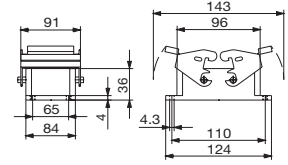

Metric version	Entry on top	Entry sideways	Qty.	Tall model	Standard model
w/o sleeve		1xM32	1		1788400000
<b>PG</b>					
w. sleeve		1xPG29	1		1666840000
w. cable gland		1xPG29	1		1217500000

Version	Qty.	Standard model
	1	1217800000

D

### Hood

### HB-32 TOVU

Cable entry on top

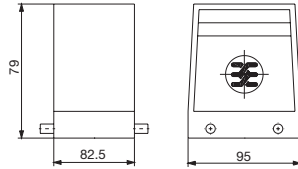

Metric version	Entry on top	Entry sideways	Qty.	Tall model	Standard model
w/o sleeve	1xM32		1		1788430000
<b>PG</b>					
w. sleeve	1xPG29		1		1666870000
w. cable gland	1xPG29		1		1217300000

Cable entry on top and on the side

Metric version	Entry on top	Entry sideways	Qty.	Tall model	Standard model
----------------	--------------	----------------	------	------------	----------------

# RockClassic

## Housing, bottoms Size 10

Side locking, bottom

### Base housing

### HB-32 SVU

Without cover

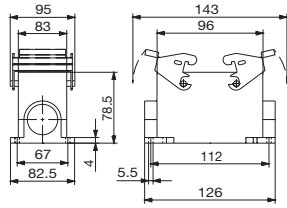

## Housing, bottoms Size 10

Side locking, bottom

### Coupling hood

### HB-32 KVV

Standard version

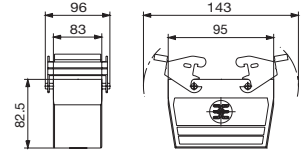

Metric version		Qty.	Tall model	Standard model
w/o sleeve	2xM32	1		<b>1788460000</b>
<b>PG</b>				
w. sleeve	1xPG29	1		<b>1666910000</b>
w. cable gland	1xPG29	1		<b>1217900000</b>
w. sleeve	2xPG29	1		<b>1666920000</b>
w. cable gland	2xPG29	1		<b>1218000000</b>

Metric version	Entry on top	Entry sideways	Qty.	Tall model	Standard model
<b>PG</b>					
w. cable gland	1xPG29		1		<b>1218100000</b>

Articles with coloured order number are kept permanently in stock at the central warehouse in Germany. Delivery times see page X.2

# RockClassic

## Housing, tops Size 10

End locking, bottom

### Hood

### HB-32 TSVL

Cable entry sideways

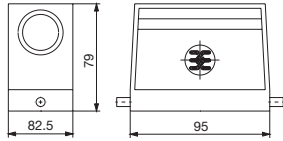
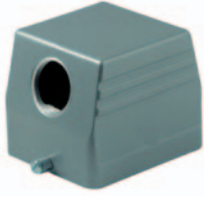

Metric version	Entry on top	Entry sideways	Qty.	Tall model	Standard model
w/o sleeve		1xM32	1		1788420000
<b>PG</b>					
w. sleeve		1xPG29	1		1667120000
w. cable gland		1xPG29	1		1219300000

### Hood

### HB-32 TOVL

Cable entry on top

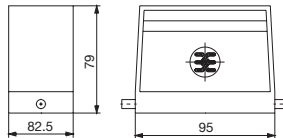

Metric version	Entry on top	Entry sideways	Qty.	Tall model	Standard model
w/o sleeve	1xM32		1		1788450000
<b>PG</b>					
w. cable gland	1xPG29		1		1219200000

Cable entry on top and on the side

Metric version	Entry on top	Entry sideways	Qty.	Tall model	Standard model

## Housing, bottoms Size 10

End locking, bottom

### Bulkhead housing

### HB-32 AVL

Without cover

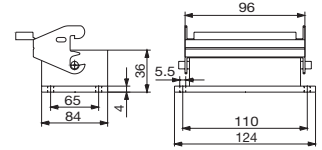

Version	Qty.	Standard model
	1	1219500000

### Bulkhead housing

### HB-32 ADVL

with Cover

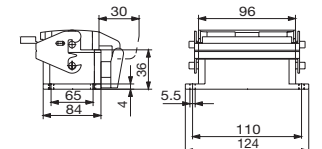

Version	Qty.	Standard model
	1	1219800000





# RockClassic

**Top Size 10**  
Side locking, top

**Bottom Size 10**  
Side locking, top

## Hood

### HB-32 TSV0

Cable entry sideways

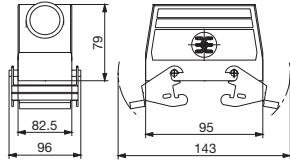

Metric version	Entry on top	Entry sideways	Qty.	Tall model	Standard model
w/o sleeve		1xM32	1		1788410000
<b>PG</b>					
w. cable gland		1xPG29	1		1218500000

## Bulkhead housing

### HB-32 ADVO

Without cover

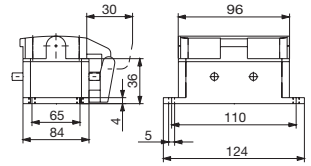

Metric version	Qty.	Standard model
	1	1218800000

D

## Hood

### HB-32 TOVO

Cable entry on top

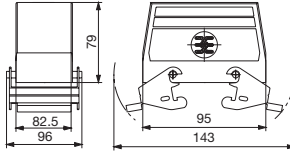

Metric version	Entry on top	Entry sideways	Qty.	Tall model	Standard model
w/o sleeve	1xM32		1		1788440000
<b>PG</b>					
w. cable gland	1xPG29		1		1218300000

## Base housing

### HB-32 SDVO

Without cover

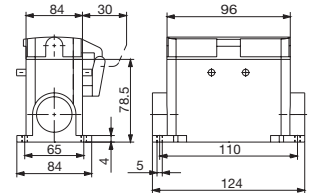

Metric version	Entry on top	Entry sideways	Qty.	Tall model	Standard model
w/o sleeve		2xM32	1		1788480000
<b>PG</b>					
w. cable gland		1xPG29	1		1218900000

# RockClassic

**Top Size 12**  
End locking, bottom

**Bottom Size 12**  
End locking, bottom

## Hood

### HB-48 TSVL

Cable entry sideways

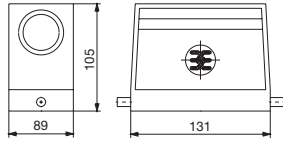

Standard model [mm] A = 132 / B = 95 / C = 90

Metric version	Entry on top	Entry sideways	Qty.	Tall model	Standard model
w/o sleeve		1xM32	1		1788320000
w/o sleeve		1xM40	1		1788310000
w/o sleeve		1xM50	1		1788300000

### PG

w. sleeve		1xPG29	1		1650850000
w. cable gland		1xPG29	1		1222600000
w. sleeve		1xPG36	1		1650860000
w. sleeve		1xPG42	1		1670470000
w. cable gland		1xPG42	1		1222800000

## Hood

### HB-48 TOVL

Cable entry on top

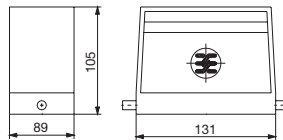

Standard model [mm] A = 132 / B = 95 / C = 90

Metric version	Entry on top	Entry sideways	Qty.	Tall model	Standard model
w/o sleeve	1xM32		1		1788350000
w/o sleeve	1xM40		1		1788340000
w/o sleeve	1xM50		1		1788330000

### PG

w. sleeve	1xPG29		1		1650980000
w. cable gland	1xPG29		1		1222300000
w. sleeve	1xPG36		1		1651000000
w. cable gland	1xPG36		1		1222400000
w. cable gland	1xPG42		1		1222500000

## Bulkhead housing

### HB-48 ADVL

Without cover

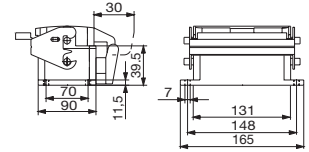

Metric version	Qty.	Standard model
	1	1222900000

## Base housing

### HB-48 SDVL

Without cover

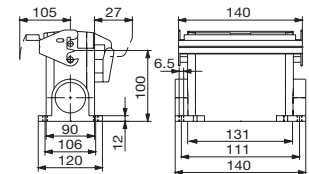

Metric version	Entry on top	Entry sideways	Qty.	Tall model	Standard model
w/o sleeve		2xM32	1		1788390000
w/o sleeve w/o cover		2xM32	1		1788370000

### PG

w. cable gland		1xPG29	1		1223400000
w. sleeve		2xPG29	1		1667560000
w. sleeve w/o cover		1xPG29	1		1651100000
w. cable gland w/o cover		1xPG29	1		1223000000

# RockClassic Stainless

## Upper part Size 2 End locking, bottom

### Hood

### HA-K-10 / HAD-15 TOVL

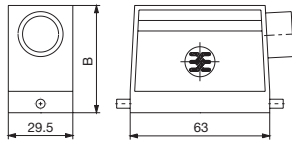

Tall model [mm] B = 67.3  
Standard model [mm] B = 53.5

Metric version	Entry on top	Entry sideways	Qty.	Tall model	Standard model
<b>PG</b>					
w. cable gland	1xPG16		2		1663940000
w. cable gland		1xPG16	5	1663880000	1663820000
w. cable gland		1xPG21	2	1663900000	

## Upper part Size 3 End locking, bottom

### Hood

### HB-K-6 / HBD-K-16 TOVL

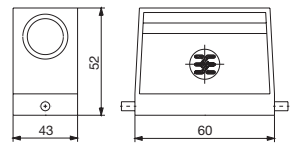

Tall model [mm] B = 72  
Standard model [mm] B = 52

Metric version	Entry on top	Entry sideways	Qty.	Tall model	Standard model
w/o sleeve	1xM25		10	1854130000	1854040000
<b>PG</b>					
w. cable gland	1xPG16		2		1652650000
w. cable gland		1xPG13	2		1670540000
w. cable gland		1xPG16	2		1652530000

## Lower part Size 2 End locking, bottom

### Bulkhead housing

### HA-K-10 AVL

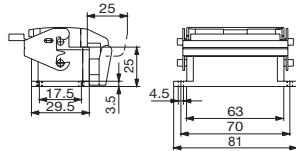

Version	Qty.	Standard model
	1	1664050000
<b>PG</b>		
	1	1664070000

## Lower part Size 3 End locking, bottom

### Bulkhead housing

### HB-K-6 AVL

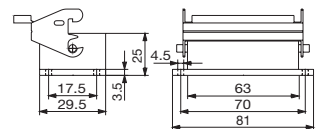

Version	Qty.	Standard model
	1	1593490000
<b>PG</b>		
	1	1593480000

### Base housing

### HA-K-10 SDVL

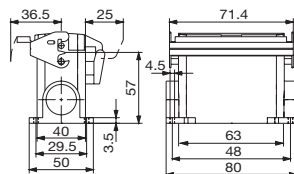

Metric without cable gland	Entry sideways	Qty.	Tall model	Standard model
	1xPG16	2		1664240000
<b>PE with cable gland</b>				
	1xPG16	2		1664480000

### Base housing

### HB-K-6 / HBD-K-16 SDVL

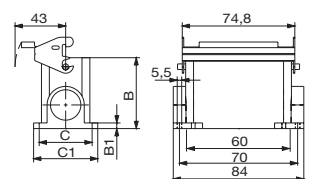

Tall model [mm] B = 74 / B1 = 6 / C = 43 / C1 = 58  
Standard model [mm] B = 54 / B1 = 4.5 / C = 43 / C1 = 58

Metric without cable gland	Entry sideways	Qty.	Tall model	Standard model
	2xM32	10	1854020000	
<b>PE with cable gland</b>				
	2xM32	10	1854010000	
	2xM32	10	1854020000	
	2xPG16	2		1652790000

# RockClassic Stainless

## Upper part Size 4 Side locking, bottom

### Hood

### HB-K-10 / HBD-K-24 TSVU

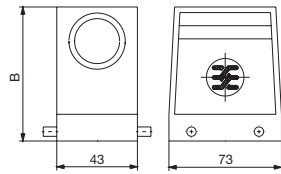

Standard model [mm] B = 52

Metric version	Entry on top	Entry sideways	Qty.	Tall model	Standard model
<b>PG</b>					
w. cable gland		1xPG21	2		<b>1654120000</b>

## Upper part Size 4 End locking, bottom

### Hood

### HB-K-10 / HBD-K-24 TSVL

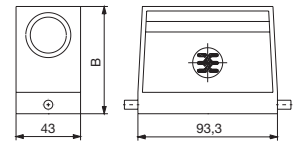

Standard model [mm] B = 52

Metric version	Entry on top	Entry sideways	Qty.	Tall model	Standard model
<b>PG</b>					
w. cable gland		1xPG16	2		<b>1655220000</b>

## Lower part Size 4 Side locking, bottom

### Bulkhead housing

### HB-K-10 AVU

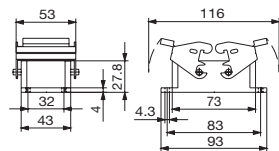

Version	Qty.	Standard model
	1	<b>1579930000</b>
<b>PG</b>		

## Lower part Size 4 End locking, bottom

### Bulkhead housing

### HB-K-10 AVL

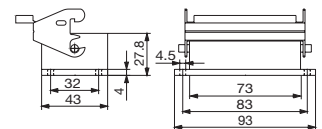

Version	Qty.	Standard model
	1	<b>1579870000</b>
<b>PG</b>		
	1	<b>1579900000</b>

### Base housing

### HB-K-10 / HBD-K-24 SDVL

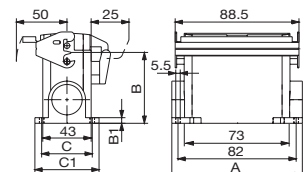

Standard model [mm] A = 97 / B = 74 / B1 = 6 / C = 43 / C1 = 58

Metric without cable gland	Entry sideways	Qty.	Tall model	Standard model
	2xPG16	1		<b>1655490000</b>
<b>PE with cable gland</b>				
	2xPG16	1		<b>1655700000</b>
	2xPG16	1		<b>1655490000</b>

Articles with coloured order number are kept permanently in stock at the central warehouse in Germany. Delivery times see page X.2

# RockClassic Stainless

## Upper part Size 5 End locking, bottom

### Hood

### HA-K-16 / HAD-K-25 TSVL

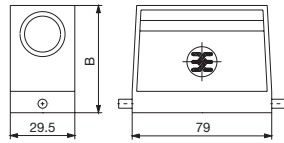

Tall model [mm] B = 72.3  
Standard model [mm] B = 58.3

Metric version	Entry on top	Entry sideways	Qty.	Tall model	Standard model
<b>PG</b>					
w. cable gland		1xPG16	2	1664760000	1664700000
w. cable gland		1xPG21	2	1664780000	

## Upper part Size 6 Side locking, bottom

### Hood

### HB-K-16 / HBD-K-40 TSVU

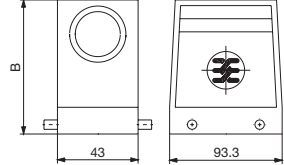

Tall model [mm] B = 76  
Standard model [mm] B = 61

Metric version	Entry on top	Entry sideways	Qty.	Tall model	Standard model
<b>PG</b>					
w. cable gland		1xPG21	2	1656550000	1656490000

D

## Lower part Size 5 End locking, bottom

### Bulkhead housing

### HA-K-16 AVL

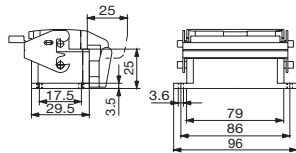

Version	Qty.	Standard model
	1	1664950000
<b>PG</b>		

## Lower part Size 6 Side locking, bottom

### Bulkhead housing

### HB-K-16 AVU

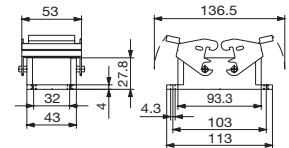

Version	Qty.	Standard model
	1	1579940000
<b>PG</b>		

### Base housing

### HA -K-16 SDVL

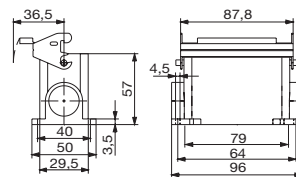

Standard model [mm] A = 79 / B = 57 / B1 = 3,5 / C = 29,5 / C1 = 50

Metric without cable gland	Entry sideways	Qty.	Tall model	Standard model
	1xPG21	1		1665160000
<b>PE with cable gland</b>				
	1xPG16	1		1665360000
	1xPG21	1		1665160000

### Base housing

### HB-K-16 / HBD-K-40 SVU

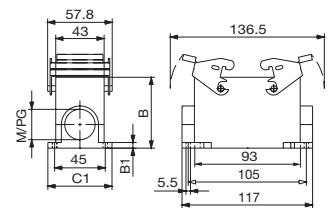

Tall model [mm] B = 84 / B1 = 6 / C1 = 58  
Standard model [mm] B = 64 / B1 = 4,5 / C1 = 57

Metric without cable gland	Entry sideways	Qty.	Tall model	Standard model
	2xPG21	1		1656760000
	1xPG21	1	1656860000	

# RockClassic Stainless

## Upper part Size 6 End locking, bottom

### Hood

### HB-K-16 / HBD-K-40 TVL

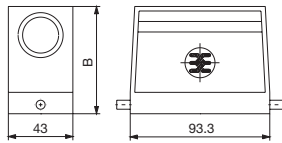

Standard model [mm] B = 61

Metric version	Entry on top	Entry sideways	Qty.	Tall model	Standard model
<b>PG</b>					
w. cable gland	1xPG21		2	1658050000	1657970000
w. cable gland		1xPG21	2		1657860000

## Upper part Size 8 Side locking, bottom

### Hood

### HB-K-24 / HBD-K-64 TSVU

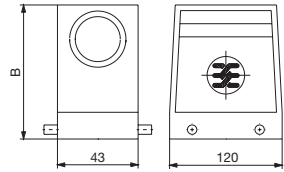

Tall model [mm] B = 76

Metric version	Entry on top	Entry sideways	Qty.	Tall model	Standard model
<b>PG</b>					
w. cable gland		1xPG29	1	1661350000	

## Lower part Size 6 End locking, bottom

### Bulkhead housing

### HB-K-16 AVL

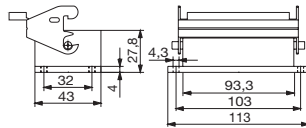

Version	Qty.	Standard model
	1	1579880000
<b>PG</b>	1	1579910000

## Lower part Size 8 Side locking, bottom

### Bulkhead housing

### HB-K-24 AVU

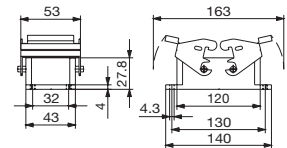

Version	Qty.	Standard model
	1	1579950000
<b>PG</b>		

### Base housing

### HB-K-16 / HBD-K-40 SDVL

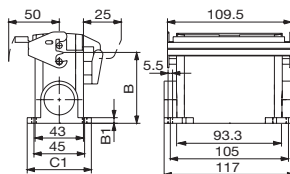

Standard model [mm] B = 64 / B1 = 4.5 / C1 = 57

Metric without cable gland	Entry sideways	Qty.	Tall model	Standard model
<b>PE with cable gland</b>				
	2xPG21	1		1658350000

Articles with coloured order number are kept permanently in stock at the central warehouse in Germany. Delivery times see page X.2

# RockClassic Stainless

**Upper part Size 8**  
End locking, bottom

**Upper part Size 10**  
Side locking, bottom

## Hood HB-K-24 / HBD-K-64 TSVL

## Hood HB-K-32 TSVU

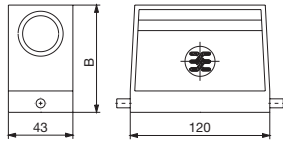

Tall model [mm] B = 76  
Standard model [mm] B = 61

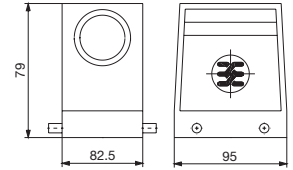

Metric version	Entry on top	Entry sideways	Qty.	Tall model	Standard model
<b>PG</b>					
w. cable gland		1xPG29	1	1662520000	1662440000
w. cable gland	1xPG29		1	1662660000	

Metric version	Entry on top	Entry sideways	Qty.	Tall model	Standard model
<b>PG</b>					
w. cable gland		1xPG29	1		1666850000

D

**Lower part Size 8**  
End locking, bottom

**Lower part Size 10**  
Side locking, bottom

## Bulkhead housing HB-K-24 AVL

## Bulkhead housing HB-K-32 AVU

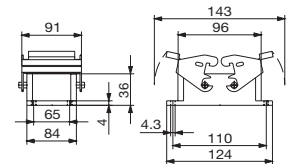
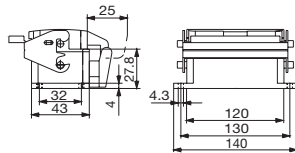

Version	Qty.	Standard model
	1	1579890000
<b>PG</b>	1	1579920000

Version	Qty.	Standard model
	1	1666900000
<b>PG</b>		

## Base housing HB-K-24 / HBD-K-64 SDVL

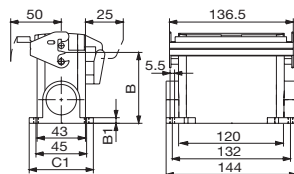

Standard model [mm] B = 64 / B1 = 4.5 / C1 = 57

Metric without cable gland	Entry sideways	Qty.	Tall model	Standard model
<b>PE with cable gland</b>				
	2xPG21	1		1611330000



# RockClassic Stainless

## Upper part Size 12

End locking, bottom

### Hood

### HB-K-48 TOVL

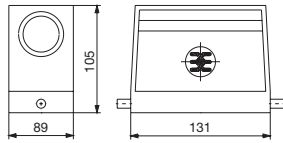
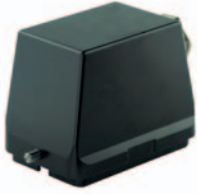

Standard model [mm] B = 95

Metric version	Entry on top	Entry sideways	Qty.	Tall model	Standard model
<b>PG</b>					
w. cable gland	1xPG36		1		1651050000
w. cable gland		1xPG29	1		1670480000

## Lower part Size 12

End locking, bottom

### Bulkhead housing

### HB-K-48 ADVL

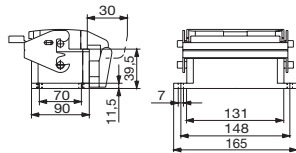

Version	Qty.	Standard model
<b>PG</b>		
	1	1651090000

### Base housing

### HB-K-48 SDVL

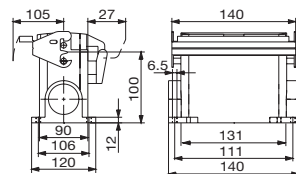

Metric without cable gland	Entry sideways	Qty.	Tall model	Standard model
<b>PE with cable gland</b>				
	1xPG36	1		1667630000
	2xPG29	1		1667610000

Articles with coloured order number are kept permanently in stock at the central warehouse in Germany. Delivery times see page X.2

## RockStar series

For the toughest demands and special needs

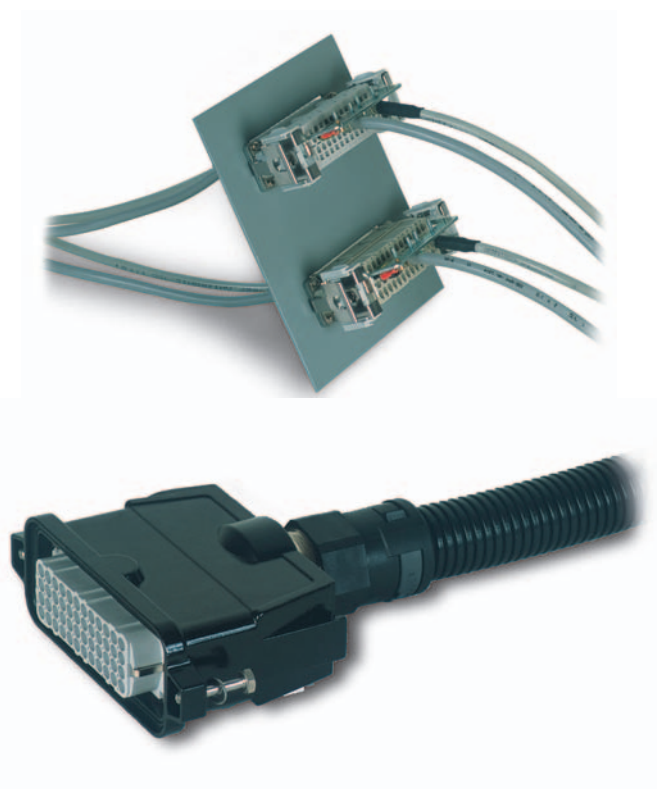

Weidmüller RockStar housings are robust and consist of aluminium die-casting. They comply with the high protection rating IP68 and are pressure proof up to 5 bar.

The housings in the RockStar Impact family have a special coating to withstand even the toughest mechanical loads.

Weidmüller also supplies housings in the RockStar XXL family with maximum circuitry space and enough room for large cable glands.

All fixing screws are produced in top quality VA steel.

Available in various designs with mobile protective covers.

Weidmüller offers RockStar housings with metric thread.

- Sizes: 1, 3, 4, 6, 8, 12
- Protection: IP68 / 5 bar
- 2 types: high, low
- Fastening systems:
  - Screw closure, free choice of screw type, fixing screws with seal
- Material: aluminium die-casting alloy
- Designs:
  - Black powder coating
- Integrated peripheral metal protective collar on the hood
- Seals on the bulkhead housing:
  - Interior O-ring or
  - Peripheral flange seal
- Corrosion protected, no risk of contact corrosion

## RockStar series

with additional protection from electromagnetic interference (EMC)



RockStar Shielded housings are immune to electromagnetic interference.

This series is also available in the XXL version, providing maximum circuitry space and sufficient room for large cable glands.

- Sizes: 1, 3, 4, 6, 8, 12
- Protection: IP68 / 5 bar
- 2 types: high, low
- Fastening systems:
  - Screw closure, free choice of screw type, fixing screws with seal
- Material: aluminium die-casting alloy
- Designs:
  - Black powder coating
- Integrated peripheral metal protective collar on the plug housing
- Seals on the bulkhead housing:
  - Interior O-ring or
  - Peripheral flange seal
- Corrosion protected, contact corrosion precluded
- Protection from electromagnetic interference

# RockStar Impact

**Top Size 1**  
Screw locking

**Bottom Size 1**  
Screw locking

## Bulkhead housing

HA IP683 AS

With fixing screws M4

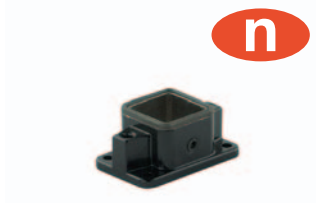

Version	Qty.	Order No.
	1	1827580000

## Hood

HA IP683 TOS

Cable entry on top



Metric version	Input	Qty.	Order No.
w/o sleeve	1xM16	1	1827440000

## Base housing

HA IP683 SS

Without cover



Metric version	Input	Qty.	Order No.
w/o sleeve	1xM16	1	1827680000

## Cover for housing bottoms



Version	Qty.	Order No.
	1	1826760000

# RockStar Impact

**Top Size 3**  
Screw locking

**Bottom Size 3**  
Screw locking

## Hood

**HB IP686 TSS**

Cable entry sideways



Metric version	Input	Qty.	Order No.
w/o sleeve	1xM25	1	1827390000

## Bulkhead housing

**HB IP686 AS**

With fixing screws M4



Version	Qty.	Order No.
Seal inside	1	1827560000

## Hood

**HB 6 IP68 TOS**

Cable entry on top



Metric version	Input	Qty.	Order No.
w/o sleeve	1xM25	1	1827400000

## Bulkhead housing

**HB IP686 AS**

With fixing screws M6



Version	Qty.	Order No.
Robust flange	1	1828550000
Seal inside	1	1828590000

## Base housing

**HB IP686 SS**

Without cover



Metric version	Input	Qty.	Order No.
w/o sleeve	2xM25	1	1827660000

## Cover for housing bottoms



Version	Qty.	Order No.
	1	1826750000

# RockStar Impact

**Top Size 4**  
Screw locking

**Bottom Size 4**  
Screw locking

**Hood**

**HB IP6810 TSS**

**Bulkhead housing**

**HB IP6810 AS**

Cable entry sideways

With fixing screws M4



Metric version	Input	Qty.	Order No.
w/o sleeve	1xM32	1	1827350000

Version	Qty.	Order No.
Seal inside	1	1827540000

**Hood**

**HB IP6810 TOS**

**Bulkhead housing**

**HB IP6810 AS**

Cable entry on top

With fixing screws M6



Metric version	Input	Qty.	Order No.
w/o sleeve	1xM32	1	1827360000

Version	Qty.	Order No.
Robust flange	1	1828530000
Seal inside	1	1828580000

**Base housing**

**HB IP6810 SS**

Without cover



Metric version	Input	Qty.	Order No.
w/o sleeve	2xM32	1	1827640000

**Cover for housing bottoms**



Version	Qty.	Order No.
	1	1826740000

D

# RockStar Impact

**Top Size 6**  
Screw locking

**Bottom Size 6**  
Screw locking

## Hood

**HB IP 6816 TSS**

Cable entry sideways



Metric version	Input	Qty.	Order No.
w/o sleeve	1xM32	1	1827290000

## Bulkhead housing

**HB IP6816 AS**

With fixing screws M4



Version	Qty.	Order No.
Seal inside	1	1827520000

## Hood

**HB IP6816 TOS**

Cable entry on top



Metric version	Input	Qty.	Order No.
w/o sleeve	1xM32	1	1827310000

## Bulkhead housing

**HB IP6816 AS**

With fixing screws M6



Version	Qty.	Order No.
Robust flange	1	1828510000
Seal inside	1	1828570000

## Base housing

**HB IP6816 SS**

Without cover



Metric version	Input	Qty.	Order No.
w/o sleeve	2xM32	1	1827620000

## Cover for housing bottoms



Version	Qty.	Order No.
	1	1826730000

Articles with coloured order number are kept permanently in stock at the central warehouse in Germany.  
Delivery times see page X.2

# RockStar Impact

**Top Size 8**  
Screw locking

**Bottom Size 8**  
Screw locking

**Hood**

**HB IP6824 TSS**

Cable entry sideways



Metric version	Input	Qty.	Order No.
w/o sleeve	1xM32	1	1827240000

**Bulkhead housing**

**HB IP6824 AS**

With fixing screws M4



Version	Qty.	Order No.
Seal inside	1	1827500000

**D**

**Hood**

**HB IP6824 TOS**

Cable entry on top



Metric version	Input	Qty.	Order No.
w/o sleeve	1xM32	1	1827250000

**Bulkhead housing**

**HB IP6824 AS**

With fixing screws M6



Version	Qty.	Order No.
Robust flange	1	1828490000
Seal inside	1	1828560000

**Base housing**

**HB IP6824 SS**

Without cover



Metric version	Input	Qty.	Order No.
w/o sleeve	2xM32	1	1827600000

**Cover for housing bottoms**



Version	Qty.	Order No.
	1	1826720000





# RockStar Shielded

**Top Size 1**  
Screw locking

**Bottom Size 1**  
Screw locking

## Bulkhead housing

HA EMVK3 AS

With fixing screws M4



Version	Qty.	Order No.
	1	1827570000

## Hood

Cable entry on top



Metric version	Input	Qty.	Order No.
w/o conn. pce	1xM16	1	1827420000

## Base housing

HA EMVK3 SS

Without cover



Metric version	Input	Qty.	Order No.
w/o conn. pce	1xPG16	1	1827670000

## Cover for housing bottoms



Version	Qty.	Order No.
	1	1826760000

# RockStar Shielded

**Top Size 3**  
Screw locking

**Bottom Size 3**  
Screw locking

## Hood

**HB EMVK6 TSS**

Cable entry sideways



Metric version	Input	Qty.	Order No.
w/o conn. pce	1xM25	1	1827370000

## Bulkhead housing

**HB-6 EMVK AS**

With fixing screws M4



Version	Qty.	Order No.
Seal inside	1	1827550000

## Hood

**HB EMVK6 TOS**

Cable entry on top



Metric version	Input	Qty.	Order No.
w/o conn. pce	1xM25	1	1827380000

## Bulkhead housing

**HB-6 EMVK AS**

With fixing screws M6



Version	Qty.	Order No.
Seal inside	1	1828540000

## Base housing

**HB EMVK6 SS**

Without cover



Metric version	Input	Qty.	Order No.
w/o conn. pce	2xM25	1	1827650000

## Cover for housing bottoms



Version	Qty.	Order No.
	1	1826750000

# RockStar Shielded

**Top Size 4**  
Screw locking

**Bottom Size 4**  
Screw locking

**Hood**

**HB EMVK10 TSS**

Cable entry sideways



**Bulkhead housing**

**HB EMVK10 AS**

With fixing screws M4



Metric version	Input	Qty.	Order No.
w/o conn. pce	1xM32	1	1827330000

Version	Qty.	Order No.
Seal inside	1	1827530000

**D**

**Hood**

**HB-10 EMVK TOS**

Cable entry on top



**Bulkhead housing**

**HB EMVK10 AS**

With fixing screws M6



Metric version	Input	Qty.	Order No.
w/o conn. pce	1xM32	1	1827340000

Version	Qty.	Order No.
Seal inside	1	1828520000

**Base housing**

**HB EMVK10 SS**

Without cover



Metric version	Input	Qty.	Order No.
w/o conn. pce	2xM32	1	1827630000

**Cover for housing bottoms**



Version	Qty.	Order No.
	1	1826740000

# RockStar Shielded

**Top Size 6**  
Screw locking

**Bottom Size 6**  
Screw locking

## Hood

**HB EMVK16 TSS**

Cable entry sideways



Metric version	Input	Qty.	Order No.
w/o conn. pce	1xM32	1	1827260000

## Bulkhead housing

**HB EMVK16 AS**

With fixing screws M4



Version	Qty.	Order No.
Seal inside	1	1827510000

## Hood

**HB EMVK16 TOS**

Cable entry on top



Metric version	Input	Qty.	Order No.
w/o conn. pce	1xM32	1	1827280000

## Bulkhead housing

**HB EMVK16 AS**

With fixing screws M6



Version	Qty.	Order No.
Seal inside	1	1828500000

## Base housing

**HB EMVK16 SS**

Without cover



Metric version	Input	Qty.	Order No.
w/o conn. pce	2xM32	1	1827610000

## Cover for housing bottoms



Version	Qty.	Order No.
	1	1826730000

Articles with coloured order number are kept permanently in stock at the central warehouse in Germany.  
Delivery times see page X.2

# RockStar Shielded

**Top Size 8**  
Screw locking

**Bottom Size 8**  
Screw locking

## Hood

**HB EMVK24 TSS**

Cable entry sideways



Metric version	Input	Qty.	Order No.
w/o conn. pce	1xM32	1	1827220000

## Bulkhead housing

**HB EMVK24 AS**

With fixing screws M4



Version	Qty.	Order No.
Seal inside	1	1827490000

D

## Hood

**HB EMVK16 SS**

Cable entry on top



Metric version	Input	Qty.	Order No.
w/o conn. pce	1xM32	1	1827210000

## Bulkhead housing

**HB EMVK24 AS**

With fixing screws M6



Version	Qty.	Order No.
Seal inside	1	1828480000

## Base housing

**HB EMVK24 SS**

Without cover



Metric version	Input	Qty.	Order No.
w/o conn. pce	2xM32	1	1827590000

## Cover for housing bottoms



Version	Qty.	Order No.
	1	1826720000



# RockStar Impact XXL

**Top Size 8**  
Screw locking

**Bottom Size 8**  
Screw locking

**Hood**

**HB TIP 24 TSS**

Cable entry sideways



**Bulkhead housing**

**HB/HBD TIP24 AS**

With fixing screws M4



Metric version	Input	Qty.	Order No.
w/o sleeve	1xM50G	1	1827190000

Version	Qty.	Order No.
Seal inside, standard	1	1827480000
Seal inside, high	1	1846020000

**D**

**Hood**

**HB TIP24 TOS**

Cable entry on top



Metric version	Input	Qty.	Order No.
w/o sleeve	1xM50	1	1827200000



# RockStar Impact XXL

**Top Size 12**  
Screw locking

**Bottom Size 12**  
Screw locking

## Hood

**HB TIP48 TSS**

Cable entry sideways



Metric version	Input	Qty.	Order No.
w/o sleeve	1xM50	1	1827140000

## Bulkhead housing

**HB TIP48 TVS**

With fixing screws M4



Version	Qty.	Order No.
Seal inside, standard	1	1827460000
Seal inside, high	1	1846000000

## Hood

**HB TIP48 TOS**

Cable entry on top



Metric version	Input	Qty.	Order No.
w/o sleeve	1xM50	1	1827150000

## Hood

**HB TIP48 TVS**

Cable entry in the front



Metric version	Input	Qty.	Order No.
w/o sleeve		1	1853300000

# RockStar Shielded XXL

**Top Size 8**  
Screw locking

**Bottom Size 8**  
Screw locking

## Hood

**HB TEK24 TSS**

Cable entry sideways



## Bulkhead housing

**HB/HBD TEK AS**

With fixing screws M4



Metric version	Input	Qty.	Order No.
w/o sleeve	1xM50	1	1827160000

Version	Qty.	Order No.
Seal inside, standard	1	1827470000
Seal inside, high	1	1846010000

## Hood

**HB TEK24 TOS**

Cable entry on top



Metric version	Input	Qty.	Order No.
w/o sleeve	1xM50	1	1827170000

D

# RockStar Shielded XXL

## Top Size 12

## Bottom Size 12

Screw locking

### Hood

### HB TEK 48 TSS

Cable entry sideways



Metric version	Input	Qty.	Order No.
w/o sleeve	1xM50	1	1827120000

### Bulkhead housing

### HB/HBD TEK48 AS

With fixing screws M4



Version	Qty.	Order No.
Seal inside, standard	1	1827450000
Seal inside, high	1	1845980000

### Hood

### HB TEK48 TOS

Cable entry on top



Metric version	Input	Qty.	Order No.
w/o sleeve	1xM50	1	1827130000

### Hood

### HB TEK48 TVS

Cable entry in the front



Metric version	Input	Qty.	Order No.
w/o sleeve		1	1853310000

# Motor connection housings

## Size 4

### Long locking clamp on the lower part

The plug-and-play solution for your motor.

With short assembly times and free choice of connection technology, this is Weidmüller's low-cost solution for heavy-duty connectors.

The angled housings HDC HB 10 AWVL replaces the motor terminal box.

The fitting position can be offset by 90° at a time thanks to the fastening grid of 68 x 68 mm.

Compatible with all standard connector housings with long locking clamp.

Suitable for use with standard inserts of the HE-10 series 8 (either screw, tension spring or crimp connection technology) or inserts from the modular ConConcept system.

**D** You will have never changed a motor this quickly!

HDC HB 10 AWVL



Type	Qty	Order no.
HDC HB 10 AWVL	1	1790040000

### Technical data

Material	Aluminium die-casting alloy
Surface	Power coated RAL 7037
Locking elements	Galvanised steel
Seals	NBR
Temperature range	-40 ... +125°C
Protection in locked state	IP5 acc. to DIN 40050

### Dimensional drawing

