

**PART NUMBER CODING**

SFH213-PP\_C-D- -ID-BK

**COLOR**

BK= BLACK

**NUMBER OF POSITIONS**

(CONTACTS PER ROW)

**PLATING**

(SEE PLATING TABLE)

**PLATING TABLE**

(.000030" MIN NICKEL UNDERPLATE)

CONTACT SURFACE	TERMINATION
P = GOLD FLASH	GOLD FLASH
V = GOLD FLASH	NICKEL
K = .000015" GOLD	NICKEL
J = .000015" GOLD	GOLD FLASH
E = .000100" PURE TIN, MATTE	.000100" PURE TIN, MATTE

**REVISIONS**

REV.	ECO. NO	DESCRIPTION	DATE	BY
B	2159	UPDATE NOTE 10 FOR FLAT RIBBON CABLE SPEC	07/05/2010	LH
C	3374	UPDATE DIMENSION TABLE ' C ' OF 03 AND 04 POSITION 526[13.35] (WAS .516[13.10]). REMOVE 30 AND 32 POSITION OF DIMENSION .047[1.20] ON PAGE 2	02/01/2015	LH
D	3697	ADD 30 AND 32 POSITIONS DIM B TOLERANCE	06/16/2017	LH

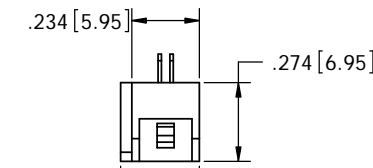
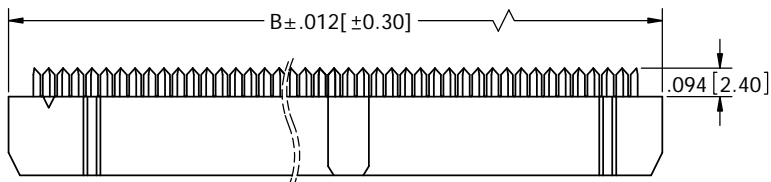
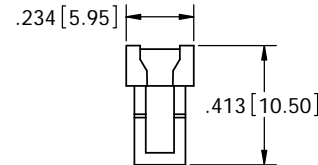
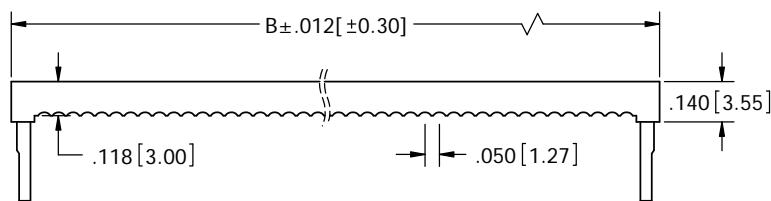
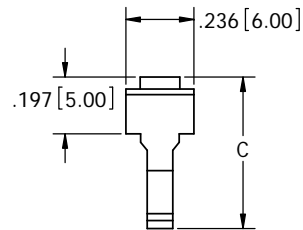
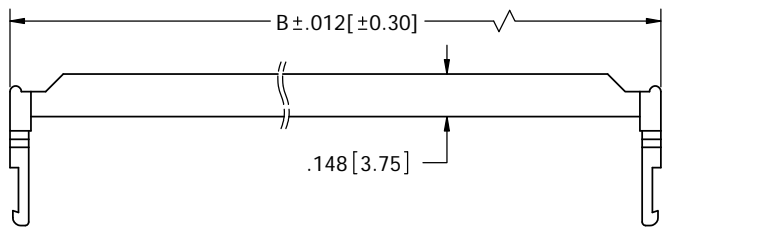

(POSITION 07 THRU 25)

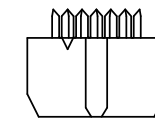
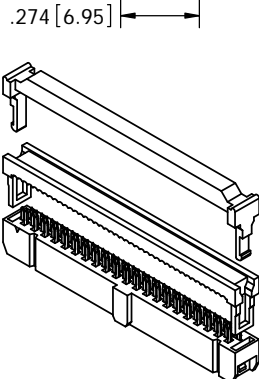
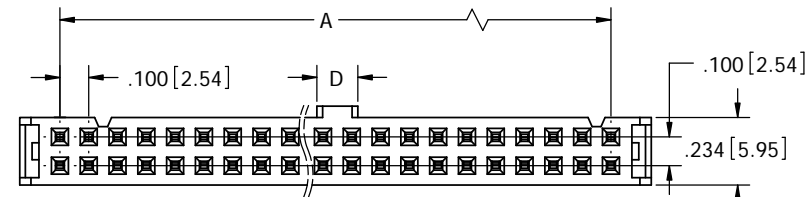

(POSITION 03)

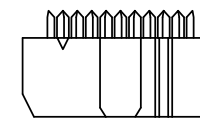

(POSITION 05)

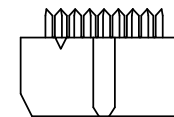

(POSITION 04)

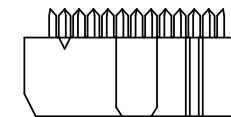

(POSITION 06)

PART NUMBER	POSITIONS/ CONTACTS	A		B		C		D	
		INCH	MM	INCH	MM	INCH	MM	INCH	MM
SFH213-PP_C-D03-ID-BK	03/06	0.200	5.08	0.480	12.18	0.526	13.35	0.075	1.90
SFH213-PP_C-D04-ID-BK	04/08	0.300	7.62	0.580	14.72				
SFH213-PP_C-D05-ID-BK	05/10	0.400	10.16	0.680	17.26	0.526	13.35	0.142	3.60
SFH213-PP_C-D06-ID-BK	06/12	0.500	12.70	0.780	19.80				
SFH213-PP_C-D07-ID-BK	07/14	0.600	15.24	0.880	22.34	0.533	13.55	0.142	3.60
SFH213-PP_C-D08-ID-BK	08/16	0.700	17.78	0.980	24.88				
SFH213-PP_C-D09-ID-BK	09/18	0.800	20.32	1.080	27.42	0.526	13.35	0.142	3.60
SFH213-PP_C-D10-ID-BK	10/20	0.900	22.86	1.180	29.96				
SFH213-PP_C-D12-ID-BK	12/24	1.100	27.94	1.380	35.04	0.526	13.35	0.142	3.60
SFH213-PP_C-D13-ID-BK	13/26	1.200	30.48	1.480	37.58				
SFH213-PP_C-D15-ID-BK	15/30	1.400	35.56	1.680	42.66	0.526	13.35	0.142	3.60
SFH213-PP_C-D17-ID-BK	17/34	1.600	40.64	1.880	47.74				
SFH213-PP_C-D20-ID-BK	20/40	1.900	48.26	2.180	55.36	0.526	13.35	0.142	3.60
SFH213-PP_C-D25-ID-BK	25/50	2.400	60.96	2.680	68.06				
POSITION 30 & 32:	30/60	SEE SHEET 2 FOR DIMENSIONS							
SEE SHEET 2 FOR P/N	32/64	SEE SHEET 2 FOR DIMENSIONS							

**NOTES:**

1. INSULATOR MATERIAL: PBT 30% GLASS FIBER.
2. CONTACT MATERIAL: PHOSPHOR BRONZE.
3. OPERATING TEMPERATURE: -40 °C TO +105 °C.
4. UL FLAMMABILITY RATING: 94V-0.
5. CURRENT RATING: 1 AMP
6. INSULATION RESISTANCE: 3,000 MEGOHMS MIN.
7. CONTACT RESISTANCE: 30m OHMS MAX.
8. DIELECTRIC WITHSTANDING: 500 V AC.
9. MATES WITH SBH11 SERIES
10. FOR .050"[1.27mm] PITCH FLAT RIBBON CABLE, 26 - 28 AWG WIRE RANGE.



RoHS COMPLIANT

UNLESS OTHERWISE SPECIFIED:  
DIMENSIONS ARE IN INCHES (MM)

TOLERANCES:

ANGULAR: ± 30'

DECIMALS  
XX=± .012 [3]  
XXX=± .008 [20]  
XXXX=± .0040 [100]

DRAWN	DATE	NAME
JH	3/24/2009	JH

THE INFORMATION HEREIN CONTAINS PROPRIETARY INFORMATION OF SULLINS ELECTRONICS AND IS NOT TO BE REPRODUCED, USED OR DISCLOSED TO OTHERS FOR ANY PURPOSE EXCEPT AS SPECIFICALLY AUTHORIZED IN WRITING BY AN OFFICER OF SULLINS ELECTRONICS.

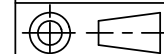

DRAWN		DATE		NAME	
JH		3/24/2009		JH	
<p><b>SULLINS</b> CONNECTOR SOLUTIONS</p>					
TITLE IDC SOCKET .100" CC/RS, w/ SR					
PART NUMBER SFH213-PP_C-D- -ID-BK					
SIZE	CAGE CODE	DWG. NO.	REV		
C	54453	11223	D		
SCALE: 2:1			SHEET 1 OF 2		

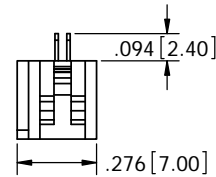
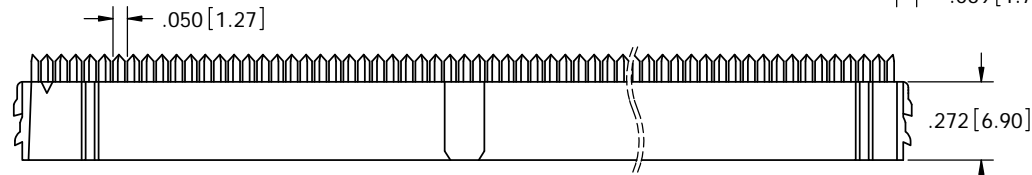
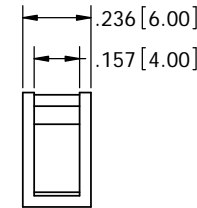
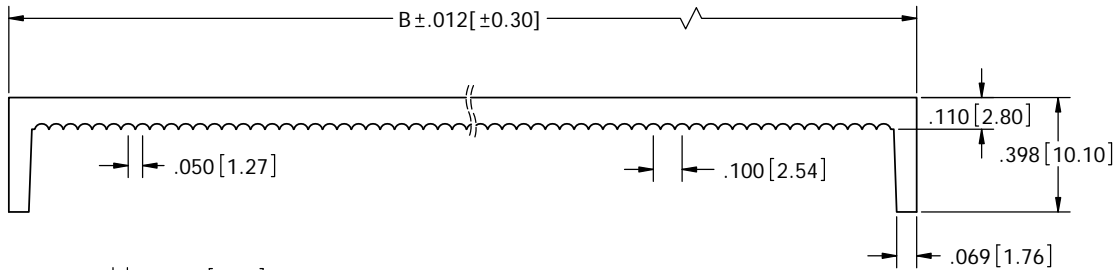
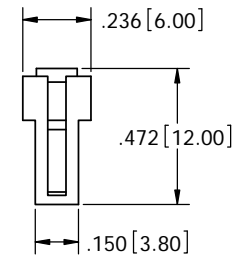
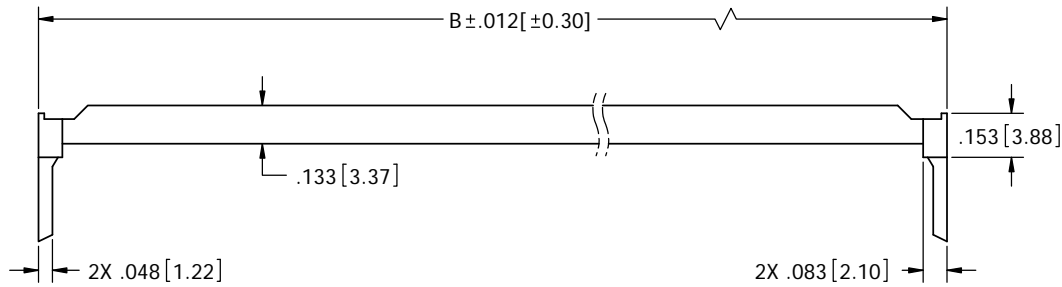

(POSITION 30 & 32)

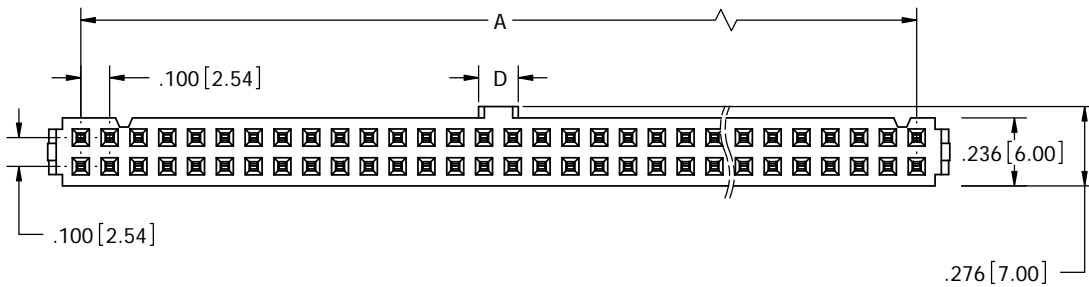
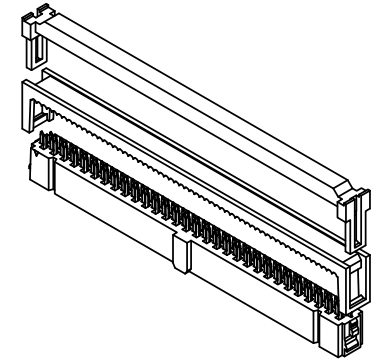

PART NUMBER	POSITIONS/ CONTACTS	A		B		D	
		INCH	MM	INCH	MM	INCH	MM
POSITION 03 THRU 25: SEE SHEET 1 FOR PART NUMBERS	03/06	SEE SHEET 1 FOR DIMENSIONS					
	04/08						
	05/10						
	06/12						
	07/14						
	08/16						
	09/18						
	10/20						
	12/24						
	13/26						
	15/30						
	17/34						
	20/40						
25/50							
SFH213-PP_C-D30-ID-BK	30/60	2.900	73.66	3.179	80.74	0.138	3.50
SFH213-PP_C-D32-ID-BK	32/64	3.100	78.74	3.379	85.82		

- NOTES:
- INSULATOR MATERIAL: PBT 30% GLASS FIBER.
  - CONTACT MATERIAL: PHOSPHOR BRONZE.
  - OPERATING TEMPERATURE: -40 °C TO +105 °C.
  - UL FLAMMABILITY RATING: 94V-0.
  - CURRENT RATING: 1 AMP
  - INSULATION RESISTANCE: 3,000 MEGOMHS MIN.
  - CONTACT RESISTANCE: 30m OHMS MAX.
  - DIELECTRIC WITHSTANDING: 500 V AC.
  - MATES WITH SBH11 SERIES
  - FOR .050" [1.27mm] PITCH FLAT RIBBON CABLE, 26 - 28 AWG WIRE RANGE.



RoHS COMPLIANT

UNLESS OTHERWISE SPECIFIED:  
DIMENSIONS ARE IN INCHES (MM)

TOLERANCES:

ANGULAR: ± 30°

DECIMALS  
 .XX = ± .012 [3]  
 .XXX = ± .008 [20]  
 .XXXX = ± .0040 [100]

DRAWN 3/24/2009 NAME JH

THE INFORMATION HEREIN CONTAINS  
 PROPRIETARY INFORMATION OF  
 SULLINS ELECTRONICS AND IS NOT  
 TO BE REPRODUCED, USED OR  
 DISCLOSED TO OTHERS FOR ANY  
 PURPOSE EXCEPT AS SPECIFICALLY  
 AUTHORIZED IN WRITING BY AN  
 OFFICER OF SULLINS ELECTRONICS.

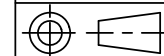

TITLE IDC SOCKET, .100" CC/RS w/ SR

PART NUMBER SFH213-PP\_C-D\_-ID-BK

SIZE C CAGE CODE 54453 DWG. NO. 11223 REV D

SCALE: 2:1 SHEET 2 OF 2