

## Pedestal and Base *1495 Series*



### Features

- Used for floor mounting for many types of enclosures, consolets or pushbutton boxes
- Provides wiring feature through the column.
- Meets NEMA Type 12 and 13 requirements.
- Finished in grey.

### Pedestal Column

- Columns are formed from 14 gauge steel with 10 gauge flanges.
- Column access opening with gasketed cover.
- Columns include flange gaskets and a box connector.

### Pedestal Base

- Bases are formed from 10 gauge steel with additional reinforcing.
- Bases include levelling screws.

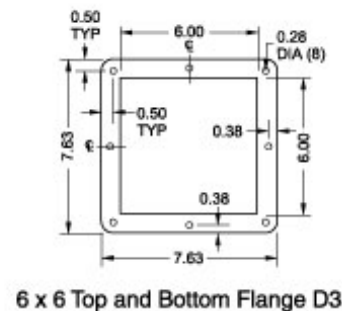
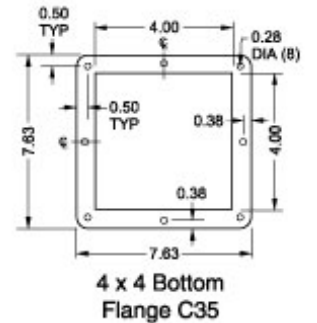
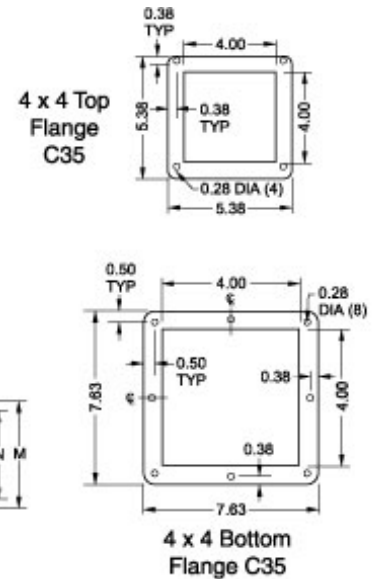
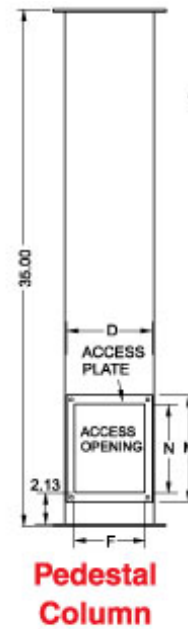
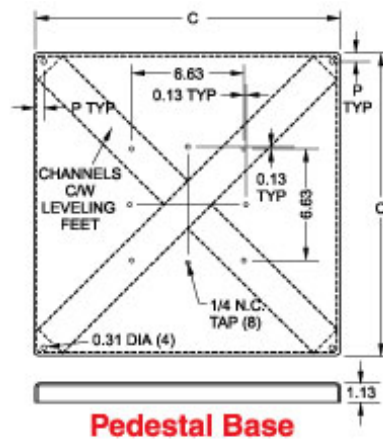

Part No.	Description	C	D	F	M	N	P
1495C35	Straight Column	-	3.75	2.75	7.25	6.00	-

<b>Part No.</b>	<b>Description</b>	<b>C</b>	<b>D</b>	<b>F</b>	<b>M</b>	<b>N</b>	<b>P</b>
<b>1495D35</b>	Straight Column	-	5.75	4.75	7.25	6.00	-
<b>1495XK</b>	Pedestal Base	18.00	-	-	-	-	0.50
<b>1495XN</b>	Pedestal Base	24.00	-	-	-	-	0.50

*Data subject to change without notice*

© 2017. Hammond Manufacturing Ltd. All rights reserved.