

1 0 1 0 2  
3 0 0 4  
a-L-b (+)

SPST  
CONTACT CONFIGURATION

NOTES:

1. ALL DIMENSIONS IN MM
2. GENERAL TOLERANCE: X.X=±0.4  
X.XX=±0.25
3. RATINGS: 5A @250V AC  
8A @125V AC
4. CONTACT MATERIAL:  
COPPER ALLOY W/Silver Plating
5. LAMP VOLTAGE: 28V AC/DC 40ma

PARTS LIST

ITEM	QTY.	PART NO.	PART DESCRIPTION
1	1	F040008	D16 OA S1 1
2	1	F050405	50-004-05 (Incandescent bulb)
3	1	F052304	50-003-04 (OPAQUE RED lens)

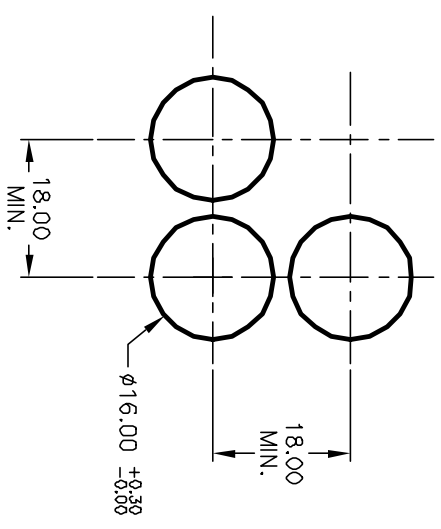

RECOMMENDED PANEL MOUNTING  
SCALE 1:1

REV.	ECN No.	DESCRIPTION	DATE	CHKD
A	12368	RELEASED FOR PRODUCTION	8/12/02	CJB

TITLE	SCALE	DATE	DR	DWG	REV
D16 OA S11 C RED (Momentary) OPAQUE/CONCAVE LENS	1.5:1	8/12/02	CB	XF0493P	A

**E-SWITCH®**

THE INFORMATION CONTAINED IN THIS DOCUMENT IS PROPRIETARY TO E-SWITCH AND IS NOT TO BE COPIED OR TRANSFERRED