

DWG. NO. SD-500813-001

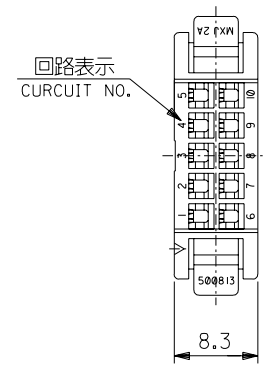
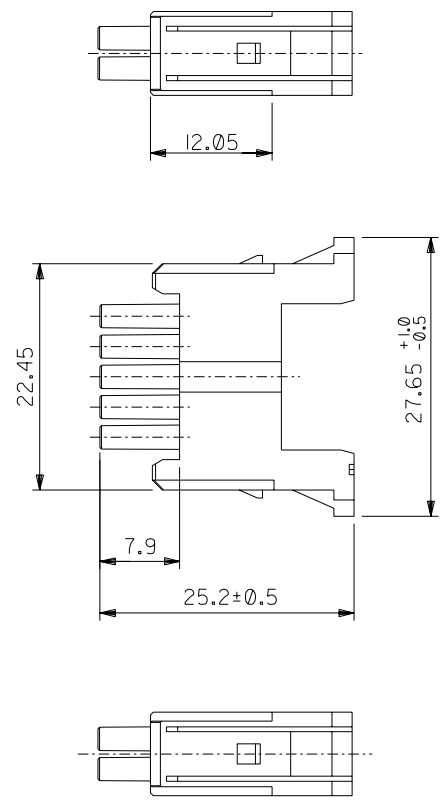
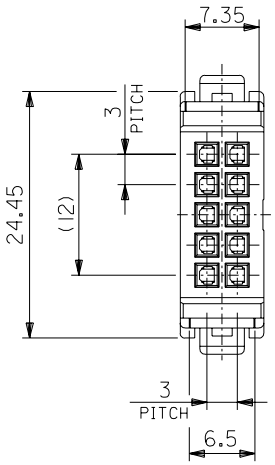

注記:  
NOTES.

1. 適用ターミナル : 56120-\*\*\*\*/56121-\*\*\*\*  
APPLICABLE TERMINAL

DO NOT SCALE DRAWING

EC NO. DRWN: CHK: APPR:	EC NO. DRWN: CHK: APPR:	EC NO. DRWN: CHK: APPR:	REVISED '03/10/07 EC NO. J2004-0781 DRWN: S.AKIYAMA CHK: N.MATSUURA APPR: YO.ITO	EC NO. J2004-0013 DRWN: S.AKIYAMA CHK: J.MIYAZAWA APPR: YO.ITO
A	0			

MATERIAL 材料 ガラス入り66ナイロン樹脂 UL94V-0 色:自然色(白) 66 NYLON G.F UL94V-0 COLOR : NATURAL(WHITE)	FINISH 仕上げ #	WIRE RANGE 適用線径範囲 #	INS. RANGE 被覆外径 #
--	-----------------	------------------------	----------------------

GENERAL TOLERANCES: (UNLESS SPECIFIED) 一般公差	SCALE	DESIGN UNITS
10 UNDER 未満 ±0.2	10 OVER 30 UNDER 未満 ±0.25	30 OVER 以上 ±0.3
ANGLE 角度 ±3°		

DRAWN BY & DATE S. Akiyama '03/06/25	CHECKED BY & DATE Y. Ito '03/07/02	APPROVED BY & DATE Y. Ito '03/07/02
CAD FILENAME SD-500813-001.S01	MATERIAL NO. SEE CHART	DRAWING NO. SD-500813-001

THIRD ANGLE PROJECTION	DIMENSIONS: <input type="checkbox"/> mm <input type="checkbox"/> INCH <input checked="" type="checkbox"/> mm ONLY	SHT REVISE ON CAD ONLY
TITLE: MINI ROBOT CONN. 10P SOCKET HOUSING		
MOLEX INCORPORATED		
SHEET NO. 1 OF 1	SIZE B	

500813-1000	500813-****
MATERIAL NO.	MODEL NO.