

## Core **ER48/18/18**

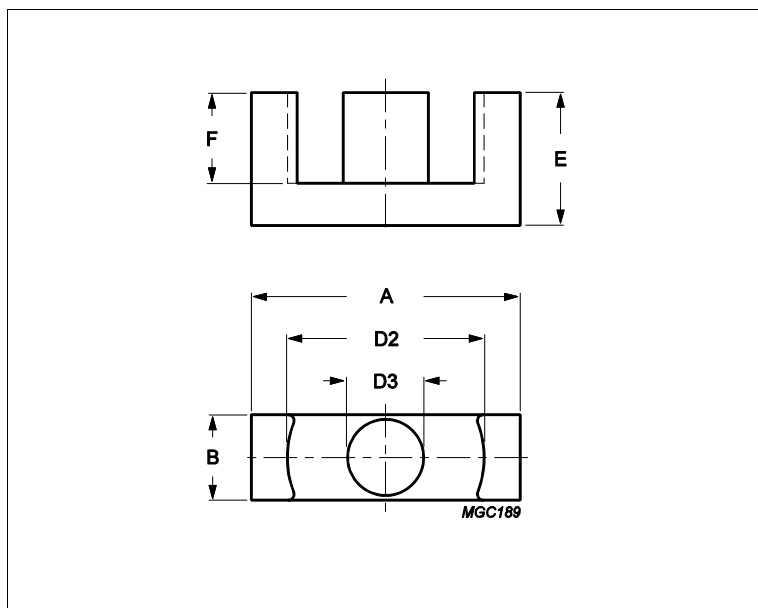

Effective parameters				
	Parameter	Value	Unit	
	$\Sigma(I/A)$	core factor (C1)	0.377	mm <sup>-1</sup>
	<b>Ve</b>	effective volume	20300	mm <sup>3</sup>
	<b>Le</b>	effective length	87	mm
	<b>Ae</b>	effective area	231	mm <sup>2</sup>
	<b>Amin</b>	minimum area	221	mm <sup>2</sup>
	<b>m</b>	ER48/18/18	≈ 51	g/pcs

### Dimensions for product: ER48/18/18

	Nom	Tol +	Tol -	Max	Min	Unit
<b>A</b>	48.00	1.00	1.00	49.00	47.00	mm
<b>B</b>	17.60	0.40	0.40	18.00	17.20	mm
<b>D2</b>	36.80	0.80	0.80	37.60	36.00	mm
<b>D3</b>	17.60	0.40	0.40	18.00	17.20	mm
<b>E</b>	18.00	0.20	0.20	18.20	17.80	mm
<b>F</b>	11.45	0.25	0.25	11.70	11.20	mm

### Inductance factor

Material	Value	Tol +	Tol -	Unit
3C94	6400	25%	25%	nH/turns <sup>2</sup>

### Power loss: 3C94

Measuring conditions			Max	Unit
100 kHz	200 mT	100 °C	10.000	W/set

### Bsat

Measuring conditions			Material	Min	Unit
25 kHz	250 A/m	100 °C	3C94	320	mT