

Ferrites and accessories

Double-aperture cores

Series/Type: **B62152**

Date: June 2013

© EPCOS AG 2015. Reproduction, publication and dissemination of this publication, enclosures hereto and the information contained therein without EPCOS' prior express consent is prohibited.

EPCOS AG is a TDK Group Company.

Primarily used for broadband transformers up to high frequencies

Application examples

- SIFERRIT material N30 for low frequencies and for pulse applications
- SIFERRIT material K1 for matching transformers and baluns up to about 250 MHz in antenna feeders or in input circuits of VHF and TV receivers

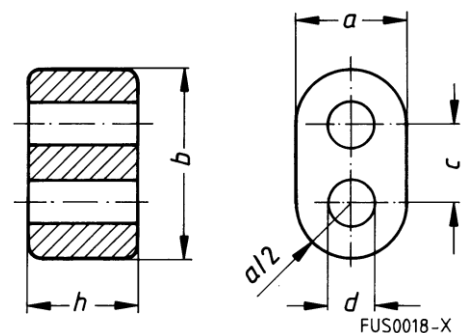

Dimensions ¹⁾	Magnetic characteristics	Weight
--------------------------	--------------------------	--------

¹⁾ Cores made of NiZn ferrite may exceed the specified dimensions by up to 5%.

Double-aperture cores

B62152

h (mm)	b (mm)	a (mm)	c (mm)	d (mm)	$\square I/A^{(1)}$ mm ⁻¹	I_{e2} mm	A_{e2} mm ²	V_{e2} mm ²	g
14.5 – 1.0	14.50 – 1.0	8.5 – 0.5	5.85 \square 0.25	3.4 + 0.60	0.31	15.3	49.7	760	4.0
8.3 – 0.6	14.50 – 1.0	8.5 – 0.5	5.85 \square 0.25	3.4 + 0.60	0.54	15.3	28.4	435	2.5
6.2 – 0.5	7.25 – 0.5	4.2 – 0.4	2.90 \square 0.15	1.7 + 0.30	0.75	7.6	10.2	78	0.4
2.5 – 0.2	3.60 – 0.3	2.1 – 0.3	1.45 \square 0.10	0.8 + 0.15	1.78	3.7	2.1	7.8	0.1
2.0 – 0.2	3.60 – 0.3	2.1 – 0.3	1.45 \square 0.10	0.8 + 0.15	2.20	3.7	1.7	6.3	0.1
1.4 – 0.2	3.60 – 0.3	2.1 – 0.3	1.45 \square 0.10	0.8 + 0.15	3.22	3.7	1.2	4.5	0.05

Dimensions with parylene coating³⁾

Core	Max. coated h (mm)	Max. coated b (mm)	Max. coated a (mm)	Min. coated d (mm)
DL 14.5/14.5 /8.5	14.55	14.55	8.55	3.35
DL 8.3/14.5 /8.5	8.35	14.55	8.55	3.35
DL 6.2/ 7.25/4.2	6.25	7.30	4.25	1.65
DL 2.5/ 3.6 /2.1	2.55	3.65	2.15	0.75
DL 2.0/ 3.6 /2.1	2.05	3.65	2.15	0.75
DL 1.4/ 3.6 /2.1	1.45	3.65	2.15	0.75

Overview of available types

Core height h (mm)	Material	A_L value ³⁾ nH (Tol. \square 30%)	Ordering code ⁴⁾
14.5 – 1.0	K1	330	B62152A0001X001
8.3 – 0.6	K1 N30	190 10000	B62152A0004X001 B62152A0004X030
6.2 – 0.5	K1 N30	140 7300	B62152A0007X001 B62152A0007X030

¹⁾ Magnetic characteristics and A_L value are based on winding of center leg.

²⁾ Double-aperture cores are available with parylene coating on request. Ordering code for coated version: B62152P...

Please read *Cautions and warnings* and *Important notes* at the end of this document.

³⁾ Magnetic characteristics and A_L value are based on winding of center leg.

⁴⁾ Double-aperture cores are available with parylene coating on request.

Ordering code for coated version: B62152P...

Please read *Cautions and warnings* and *Important notes* at the end of this document.

2.5 -0.2	K1 N30 M13	60 3100 1440	B62152A0008X001 B62152A0008X030 B62152A0008X013
2.0 -0.2	K1 N30 M13	42 2400 1100	B62152A0027X001 B62152A0027X030 B62152A0027X013
1.4 -0.2	N30	1600	B62152A0015X030

Mechanical stress and mounting

Ferrite cores have to meet mechanical requirements during assembling and for a growing number of applications. Since ferrites are ceramic materials one has to be aware of the special behavior under mechanical load.

As valid for any ceramic material, ferrite cores are brittle and sensitive to any shock, fast changing or tensile load. Especially high cooling rates under ultrasonic cleaning and high static or cyclic loads can cause cracks or failure of the ferrite cores.

For detailed information see chapter “*Definitions*”, section 8.1.

Effects of core combination on A_L value

Stresses in the core affect not only the mechanical but also the magnetic properties. It is apparent that the initial permeability is dependent on the stress state of the core. The higher the stresses are in the core, the lower is the value for the initial permeability. Thus the embedding medium should have the greatest possible elasticity.

For detailed information see chapter “*Definitions*”, section 8.2.

Heating up

Ferrites can run hot during operation at higher flux densities and higher frequencies.

NiZn-materials

The magnetic properties of NiZn-materials can change irreversible in high magnetic fields.

Processing notes

- The start of the winding process should be soft. Else the flanges may be destroyed.
- To strong winding forces may blast the flanges or squeeze the tube that the cores can no more be mounted.
- To long soldering time at high temperature (>300 °C) may effect coplanarity or pin arrangement.
- Not following the processing notes for soldering of the J-leg terminals may cause solderability problems at the transformer because of pollution with Sn oxyd of the tin bath or burned insulation of the wire. For detailed information see chapter “*Processing notes*”, section 8.2.
- The dimensions of the hole arrangement have fixed values and should be understood as a recommendation for drilling the printed circuit board. For dimensioning the pins, the group of holes can only be seen under certain conditions, as they fit into the given hole arrangement. To avoid problems when mounting the transformer, the manufacturing tolerances for positioning the customers’ drilling process must be considered by increasing the hole diameter.

Ferrites and accessories**Symbols and terms**

Symbol	Meaning	Unit
--------	---------	------

Ferrites and accessories

Symbols and terms

A	Cross section of coil	
A_e	Effective magnetic cross section	mm ²
A_L	Inductance factor; $A_L = L/N^2$	mm ²
A_{L1}	Minimum inductance at defined high saturation (\square_a)	nH
A_{min}	Minimum core cross section	nH
A_N	Winding cross section	mm ²
A_R	Resistance factor; $A_R = R_{Cu}/N^2$	mm ²
B	RMS value of magnetic flux density	$\square\square = 10^-$
$\square B$	Flux density deviation	$^6\square\square$ Vs/m ² ,
\hat{B}	Peak value of magnetic flux density	mT
$\square\hat{B}$	Peak value of flux density deviation	Vs/m ² , mT
BDC	DC magnetic flux density	Vs/m ² , mT
B_R	Remanent flux density	Vs/m ² , mT
B_S	Saturation magnetization	Vs/m ² , mT
C_0	Winding capacitance	Vs/m ² , mT
CDF	Core distortion factor	Vs/m ² , mT
DF	Relative disaccommodation coefficient $DF = d/\square_i$	F = As/V
d	Disaccommodation coefficient	mm ^{-4.5}
E_a	Activation energy	
f	Frequency	
f_{cutoff}	Cut-off frequency	J s ⁻¹ ,
f_{max}	Upper frequency limit	Hz s ⁻¹ ,
f_{min}	Lower frequency limit	Hz s ⁻¹ ,
f_r	Resonance frequency	Hz s ⁻¹ ,
f_{Cu}	Copper filling factor	Hz s ⁻¹ ,
g	Air gap	Hz s ⁻¹ ,
H	RMS value of magnetic field strength	Hz
\hat{H}	Peak value of magnetic field strength	
HDC	DC field strength	mm
$H_c h$	Coercive field strength	A/m
h/\square_{i2}	Hysteresis coefficient of material	A/m
I	Relative hysteresis coefficient	A/m
lDC	RMS value of current	A/m
\hat{l}	Direct current	A/m
	Peak value of current	10 ⁻⁶ cm/A
	Polarization	10 ⁻⁶ cm/A
	Boltzmann constant	A
	Third harmonic distortion	A
	Circuit third harmonic distortion	A
	Inductance	

Ferrites and accessories
Symbols and terms

J k		Vs/m ²
k ₃		J/K
k _{3c}		
L		H = Vs/A

Ferrites and accessories
Symbols and terms

Symbol	Meaning	Unit
$\Delta L/L$	Relative inductance change	
L_0	Inductance of coil without core	H
L_H	Main inductance	H
L_p	Parallel inductance	H
L_{rev}	Reversible inductance	H
L_s	Series inductance	H H
l_e	Effective magnetic path length	mm
l_N	Average length of turn	mm
N	Number of turns	
P_{Cu}	Copper (winding) losses	W
P_{trans}	Transferrable power	W
P_V	Relative core losses	mW/g
PF	Performance factor	
PF	Quality factor ($Q = \omega L/R_s = 1/\tan \delta_L$)	
Q	Resistance	Ω
R	Copper (winding) resistance ($f = 0$)	Ω
R_{Cu}	Hysteresis loss resistance of a core	Ω
R_h	R_h change	Ω
ΔR_h	Internal resistance	Ω
R_i	Parallel loss resistance of a core	Ω
R_p	Series loss resistance of a core	Ω
R_s	Thermal resistance	K/W
R_s	Effective loss resistance of a core	Ω mm
R_{th}	Total air gap	$^\circ\text{C}$
R_V	Temperature	K
s	Temperature difference	$^\circ\text{C}$
ΔT	Curie temperature	s
T_c	Time	
t	Pulse duty factor	
t_v	Loss factor	
$\tan \delta$	Loss factor of coil	
$\tan \delta_L$	(Residual) loss factor at $H = 0$	
$\tan \delta_r$	Relative loss factor	
$\tan \delta_r$	Hysteresis loss factor	
$\tan \delta_e$	Relative loss factor of material at $H = 0$	V V
$\tan \delta_h$	RMS value of voltage	mm ³
$\tan \delta/\delta_i$	Peak value of voltage	Ω
U	Effective magnetic volume	Ω/mm
\hat{U}	Complex impedance	

Ferrites and accessories

Symbols and terms

$V_e Z$
 Z_n

Normalized impedance $|Z|_n = |Z| / N^2 \mu \mu_0 (l_e/A_e)$

Symbol

Meaning

Unit

Ferrites and accessories

Symbols and terms

α		
α_F	Temperature coefficient (TK)	
α_e	Relative temperature coefficient of material	1/K
α_r	Temperature coefficient of effective permeability	1/K
ϵ	Relative permittivity	1/K
Φ	Magnetic flux	
η	Efficiency of a transformer	Vs
α_B	Hysteresis material constant	
α_i	Hysteresis core constant	mT-1 A-1H-
α_s	Magnetostriction at saturation magnetization	1/2
$\bar{\mu}$	Relative complex permeability	
μ_0	Magnetic field constant	
μ_a	Relative amplitude permeability	Vs/Am
μ_{app}	Relative apparent permeability	
μ_e	Relative effective permeability	
μ_i	Relative initial permeability	
μ_i	Relative real (inductive) component of $\bar{\mu}$ (for parallel components)	
μ_p'	Relative imaginary (loss) component of $\bar{\mu}$ (for parallel components)	
μ_p''	Relative permeability	
μ_r	Relative reversible permeability	
μ_{rev}	Relative real (inductive) component of $\bar{\mu}$ (for series components)	
μ_s'	Relative imaginary (loss) component of $\bar{\mu}$ (for series components)	
μ_s''	Relative total permeability	
μ_{tot}	derived from the static magnetization curve	
ρ	Resistivity	$\Omega\text{m}^{-1}\text{mm}^{-1}$
μ	Magnetic form factor	1
$\tau/L/A$	DC time constant $\tau_{Cu} = L/R_{Cu} = A_L/A_R$	s s-
ω_{Cu}	Angular frequency; $\omega = 2\pi f$	1
ω		

All dimensions are given in mm.

SMD Surface-mount device

The following applies to all products named in this publication:

1. Some parts of this publication contain **statements about the suitability of our products for certain areas of application**. These statements are based on our knowledge of typical requirements that are often placed on our products in the areas of application concerned. We nevertheless expressly point out **that such statements cannot be regarded as binding statements about the suitability of our products for a particular customer application**. As a rule, EPCOS is either unfamiliar with individual customer applications or less familiar with them than the customers themselves. For these reasons, it is always ultimately incumbent on the customer to check and decide whether an EPCOS product with the properties described in the product specification is suitable for use in a particular customer application.
2. We also point out that **in individual cases, a malfunction of electronic components or failure before the end of their usual service life cannot be completely ruled out in the current state of the art, even if they are operated as specified**. In customer applications requiring a very high level of operational safety and especially in customer applications in which the malfunction or failure of an electronic component could endanger human life or health (e.g. in accident prevention or lifesaving systems), it must therefore be ensured by means of suitable design of the customer application or other action taken by the customer (e.g. installation of protective circuitry or redundancy) that no injury or damage is sustained by third parties in the event of malfunction or failure of an electronic component.
3. **The warnings, cautions and product-specific notes must be observed.**
4. In order to satisfy certain technical requirements, **some of the products described in this publication may contain substances subject to restrictions in certain jurisdictions (e.g. because they are classed as hazardous)**. Useful information on this will be found in our Material Data Sheets on the Internet (www.epcos.com/material). Should you have any more detailed questions, please contact our sales offices.
5. We constantly strive to improve our products. Consequently, **the products described in this publication may change from time to time**. The same is true of the corresponding product specifications. Please check therefore to what extent product descriptions and specifications contained in this publication are still applicable before or when you place an order. We also **reserve the right to discontinue production and delivery of products**. Consequently, we cannot guarantee that all products named in this publication will always be available. The aforementioned does not apply in the case of individual agreements deviating from the foregoing for customer-specific products.
6. Unless otherwise agreed in individual contracts, **all orders are subject to the current version of the "General Terms of Delivery for Products and Services in the Electrical Industry" published by the German Electrical and Electronics Industry Association (ZVEI)**.
7. The trade names EPCOS, BAOKE, Alu-X, CeraDiode, CeraLink, CSMP, CSSP, CTVS, DeltaCap, DigiSiMic, DSSP, FilterCap, FormFit, MiniBlue, MiniCell, MKD, MKK, MLSC, MotorCap, PCC, PhaseCap, PhaseCube, PhaseMod, PhiCap, SIFERRIT, SIFI, SIKOREL,

SilverCap, SIMDAD, SiMic, SIMID, SineFormer, SIOV, SIP5D, SIP5K, ThermoFuse, WindCap are **trademarks registered or pending** in Europe and in other countries. Further information will be found on the Internet at www.epcos.com/trademarks.