

PART NUMBER	SSF-LXH4RA5GD	REV.	C
DATE	E.C.N. NUMBER AND REVISION COMMENTS		REV
07.20.93	CHANGED DIMENSIONS WHERE NOTED		A
05.04.95	UPDATED SAFE OP. SPECS., ADDED CTR. LINE DIM.		B
07.05.95	UPDATED WHERE NOTED		C

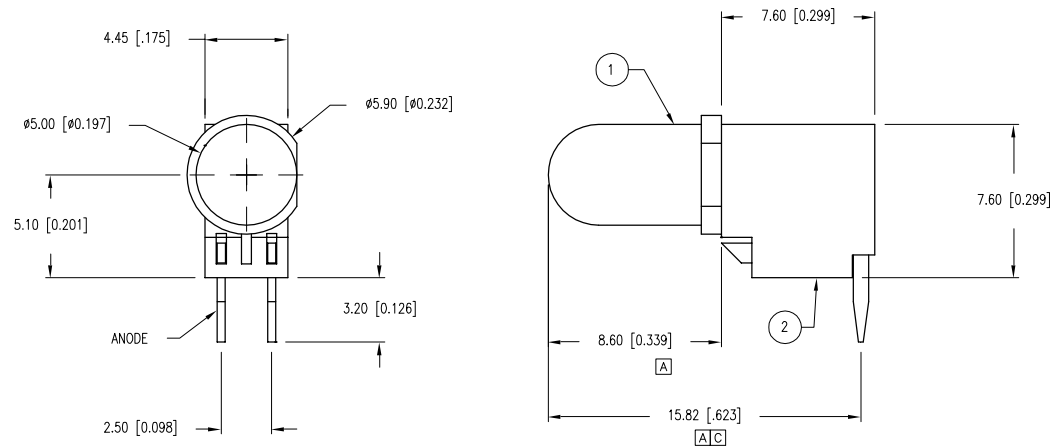

ELECTRO-OPTICAL CHARACTERISTICS $T_A=25^\circ\text{C}$ $I_f=20\text{mA}$				
PARAMETER	MIN	TYP	MAX	TEST COND
PEAK WAVELENGTH		565		nm
FORWARD VOLTAGE		2.1	2.8	$V_f$
REVERSE VOLTAGE	5.0			$V_r$ $I_f=100\mu\text{A}$
AXIAL INTENSITY		30		mcd $I_f=20\text{mA}$
VIEWING ANGLE		60		2x theta
EMITTED COLOR: GREEN				
EPOXY LENS FINISH: GREEN DIFFUSED				

LIMITS OF SAFE OPERATION AT 25°C		
PARAMETER	MAX	UNITS
PEAK FORWARD CURRENT*	150	mA
STEADY CURRENT	25	mA
POWER DISSIPATION	105	mW
DERATE FROM 25°C	-1.6	mW/°C
OPERATING, STORAGE TEMP.	-40 TO +85	°C
SOLDERING TEMP.	+260	°C
2.0mm FROM BODY	3	SEC. MAX

\*  $t < 10\mu\text{s}$

- NOTES:
1. SSL-LX5093GD LED.
  2. IFS-LX4FRA-1 LAMP SOCKET.
  3. CUT LED LEADS 5mm LONG.
  4. ASSEMBLE IN SOCKET, POLARITY AS SHOWN.

\*UNLESS OTHERWISE SPECIFIED TOLERANCES PER DECIMAL PRECISION ARE: X=±1 (±0.039), X.X=±0.5 (±0.020), X.XX=±0.25 (±0.010), X.XXX=±0.127 (±0.005). LEAD SIZE=±0.05 (±0.002), LEAD LENGTH=±0.75 (±0.030). MIN= +DECIMAL PRECISION -0.00, MAX.= +0.00 -DECIMAL PRECISION UNCONTROLLED DOCUMENT



290 E. HELEN ROAD  
 PALATINE, IL 60067-6976  
 PHONE: +1.847.359.2790  
 FAX: +1.847.359.6538  
 WEB: WWW.LUMEX.COM

T-1 3/4 LAMP, GREEN FAULT INDICATOR

\*\*THE SPECIFICATIONS MAY CHANGE AT ANY TIME WITHOUT NOTICE DUE TO NEW MATERIALS OR PRODUCT IMPROVEMENT.\*\*

CONFIDENTIAL INFORMATION

THE INFORMATION CONTAINED IN THIS DOCUMENT IS THE PROPERTY OF LUMEX INC. EXCEPT AS SPECIFICALLY AUTHORIZED IN WRITING BY LUMEX INC., THE HOLDER OF THIS DOCUMENT SHALL KEEP ALL INFORMATION CONTAINED HEREIN CONFIDENTIAL AND SHALL PROTECT SAME IN WHOLE OR IN PART FROM DISCLOSURE AND DISSEMINATION TO ALL THIRD PARTIES.

DATE:	04.15.93	DRAWN BY:	JH
PAGE:	1 OF 1	CHKD BY:	KF
SCALE:	N/A	APRVD BY:	SS
UNIT:	mm [INCH]		(R)