

PART NUMBER	REV	TERMINATOR	FEED TYPE	DESCRIPTION
1528573-1	B	LEADMAKER	MECH POST FEED	CUTS CARRIER
1528573-2	B	BENCH	MECH PRE FEED	CUTS CARRIER
1528573-6	B	LEADMAKER	MECH POST FEED	CONTINUOUS CARRIER
7-1528573-1	B	LEADMAKER	MECH POST FEED	-1 AND SPARE PARTS
7-1528573-2	B	BENCH	MECH PRE FEED	-2 AND SPARE PARTS
7-1528573-6	B	LEADMAKER	MECH POST FEED	-6 AND SPARE PARTS
7-1528573-7	A	-	-	SPARE PARTS KIT

CRIMP DATA	FCI TERMINAL	FCI CRIMP SPEC
TERMINAL NAME: DCS-2 1.5MM FEMALE TERMINAL		
CRIMP	SIZE	TYPE
WIRE	2.03 [0.80 IN]	F
INSUL	2.29 [0.90 IN]	O
WIRE STRIP LENGTH		APPL INSTRUCTIONS
3.70-4.50mm [0.146-0.177 IN]		408-8322 & 408-8490
TERMINAL APPL SPEC	FCI	FEED
-	-	8.00 [0.315 IN]

TE PN	MANU PN	TE PN	MANU PN
1572788-1	6 000 03 31	1949766-1	6 010 02 31
1572788-2	6 000 05 31	1949766-2	6 010 02 34
1572788-3	6 000 03 34	1949766-3	6 010 06 31
1572788-4	6 000 05 34	1949766-4	6 010 06 34
1572788-5	6 000 13 34	1949766-5	6 010 19 31
		1949766-4	6 010 19 34

WIRE SIZE	CRIMP HEIGHT	REF SETTING
1.00mm ²	1.30 ±0.05 [0.051 ±0.002 IN]	B 6
0.75mm ²	1.25 ±0.05 [0.049 ±0.002 IN]	B 9
0.50mm ²	1.20 ±0.05 [0.047 ±0.002 IN]	C 2

- △ RECOMMENDED SPARE PARTS
- 2. GREASE RAM, CAM, CAM FOLLOWER AND FEED ROD LIGHTLY
- 3. LUBRICATE DAILY PER THE APPLICATOR INSTRUCTION SHEET SUPPLIED WITH THE APPLICATOR
- △ FCI SPECS: C33/97/3 REFERS TO 0.50mm² WIRE.
C35/97/3 REFERS TO 0.75mm² WIRE.
C36/97/3 REFERS TO 1.00mm² WIRE.

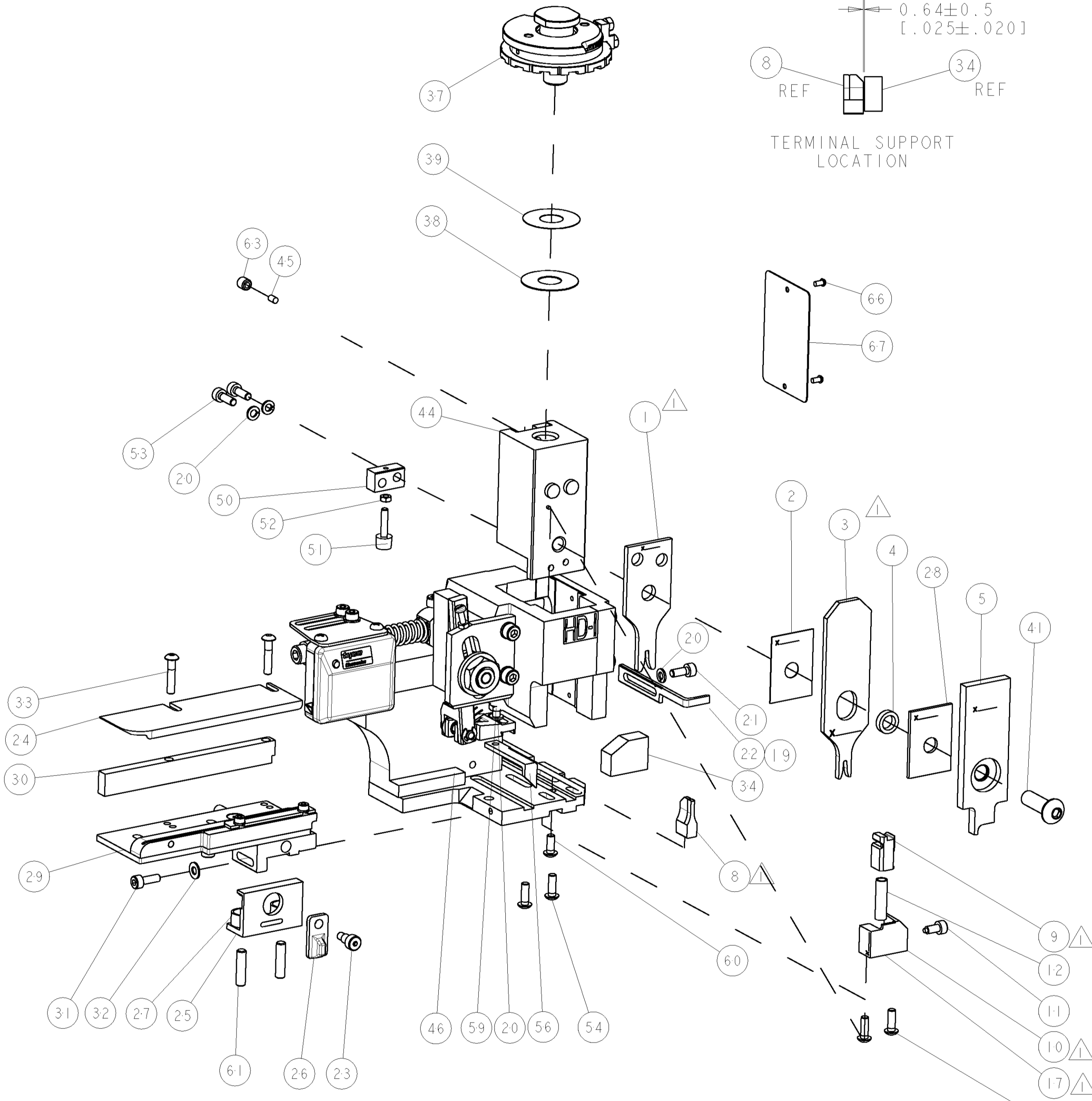

* WARNING
ON INSTALLATION, SET WIRE DISC TO LARGEST WIRE SIZE SETTING. USE OF SETTINGS BELOW MIN. REQUIRED CRIMP HEIGHT SETTING WILL CAUSE DAMAGE TO CRIMP TOOLING.

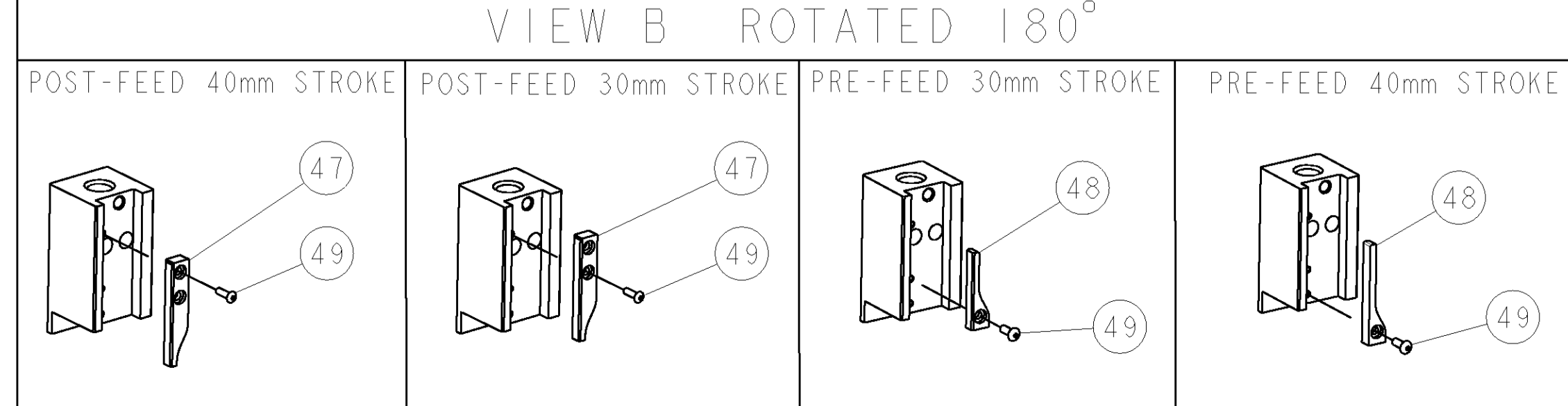

-77	-76	-72	-71	-6	-2	-1	PART NO	DESCRIPTION	ITEM NO
-	-	-	-	-	-	-	-	-	84
-	-	-	-	-	-	-	-	-	83
-	-	-	-	-	-	-	-	-	82
-	-	-	-	-	-	-	-	-	81
-	-	-	-	-	-	-	-	-	80
-	-	-	-	-	-	-	-	-	79
-	-	-	-	-	-	-	-	-	78
-	-	-	-	-	-	-	-	-	77
-	-	-	-	-	-	-	-	-	76
-	-	-	-	-	-	-	-	-	75
-	-	-	-	-	-	-	-	-	74

SET UP GAGE 458637-3		LOC	DIST	REVISONS			
A	66			REV	DATE	BY	APPV
				B	02SEP2008	RK	GB

REV	DATE	DESCRIPTION	ITEM NO
-	-	-	73
-	-	-	72
-	-	-	71
-	-	-	70
-	-	-	69
-	-	-	68
-	-	-	67
-	-	-	66
-	-	-	65
-	-	-	64
-	-	-	63
-	-	-	62
-	-	-	61
-	-	-	60
-	-	-	59
-	-	-	58
-	-	-	57
-	-	-	56
-	-	-	55
-	-	-	54
-	-	-	53
-	-	-	52
-	-	-	51
-	-	-	50
-	-	-	49
-	-	-	48
-	-	-	47
-	-	-	46
-	-	-	45
-	-	-	44
-	-	-	43
-	-	-	42
-	-	-	41
-	-	-	40
-	-	-	39
-	-	-	38
-	-	-	37
-	-	-	36
-	-	-	35
-	-	-	34
-	-	-	33
-	-	-	32
-	-	-	31
-	-	-	30
-	-	-	29
-	-	-	28
-	-	-	27
-	-	-	26
-	-	-	25
-	-	-	24
-	-	-	23
-	-	-	22
-	-	-	21
-	-	-	20
-	-	-	19
-	-	-	18
-	-	-	17
-	-	-	16
-	-	-	15
-	-	-	14
-	-	-	13
-	-	-	12
-	-	-	11
-	-	-	10
-	-	-	9
-	-	-	8
-	-	-	7
-	-	-	6
-	-	-	5
-	-	-	4
-	-	-	3
-	-	-	2
-	-	-	1

DIMENSIONS:	TOLERANCES UNLESS OTHERWISE SPECIFIED:
mm [IN]	9 PLC ±
	1 PLC ±
	3 PLC ±
	4 PLC ±
	ANGLES ±

MATERIAL	FINISH	WEIGHT	CUSTOMER DRAWING
-	-	-	-

DATE	BY	APPV	NAME
08SEP2005	M. CLIFFORD		
08SEP2005	E. BACKHURST		

SIZE	CAGE CODE	DRAWING NO	RESTRICTED TO
A	00779	1528573	-

SCALE	SHEET	OF	REV
3:5	1	1	B