

a. Part as supplied

101A062-3-G03

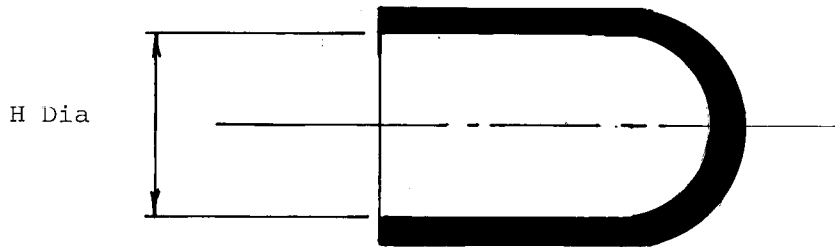

b. Part after unrestricted recovery

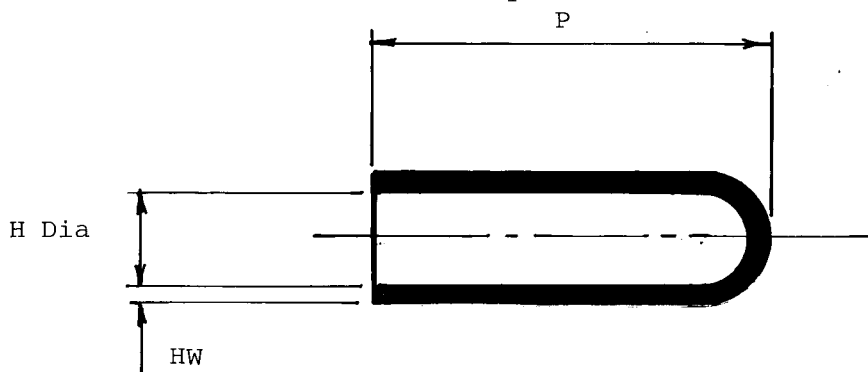

Dimensions (in millimetres)

Part No.	H		P	HW
	Min a	Max b	+ 10% b	+ 20% b
101A062-3-G03	27	12.7	25	2.3

Drawn S. Dixon Checked *[Signature]* Issue 1 Date June '84

Approval

Design *[Signature]* MKTG *[Signature]* Q.C. *[Signature]*

Conforms to ISO Recommendations
3rd Angle Projection
Not to scale



(Ordering Information)

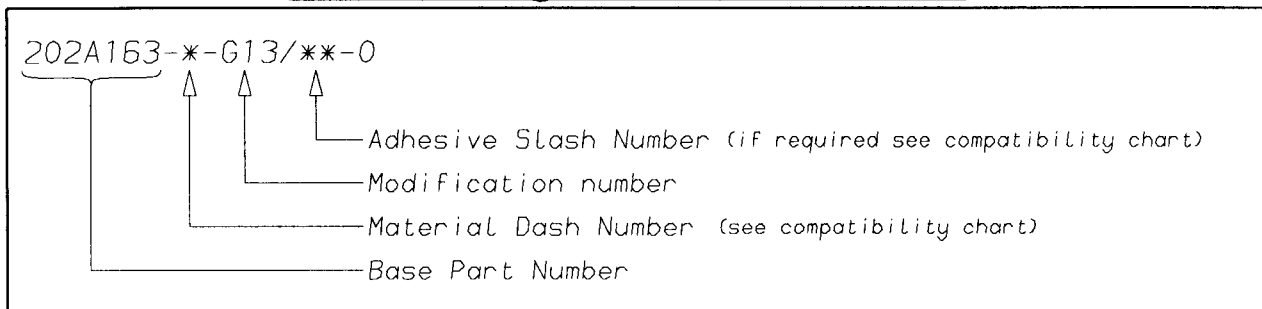

(COMPATIBILITY CHART)

MATERIAL DASH NUMBER	MATERIAL DESCRIPTION	COATING SLASH NUMBER
-3	POLYOLEFIN, SEMI-RIGID	/42, /86
-4	POLYOLEFIN, FLEXIBLE	/42, /86
-25	ELASTOMER, FLUID RESISTANT	/86, /225

AS SUPPLIED DIMENSIONS ARE FOR UNCOATED PARTS,
 WHEN COATING IS ADDED, ENTRY DIAMETERS WILL REDUCE BY 1.5mm MAX.

Raychem
 Electronics OEM Division Europe
 Swindon, Wiltshire, England.
 Telephone: (01793) 528171 Fax: 573923