

THIS DRAWING IS UNPUBLISHED. RELEASED FOR PUBLICATION ,19 .
 © COPYRIGHT 19 BY AMP INCORPORATED. ALL RIGHTS RESERVED.

| LOC | DIST | REVISIONS | | | | | |
|-----|------|-----------|-----|--------------------|---------|-----|------|
| | | P | LTR | DESCRIPTION | DATE | DWN | APVD |
| G | 14 | | E | REV / 0720-0868-96 | 26FEB96 | ME | SB |

| | | |
|--------------------------------|--------------------------------|--------------------------------|
| AMP WIRE RANGE | UL E13288 | SP LR7189 Certified |
| 22-16 AWG SOLID OR STRANDED | 22-16 AWG SOLID OR STRANDED | 22-16 AWG SOLID OR STRANDED |

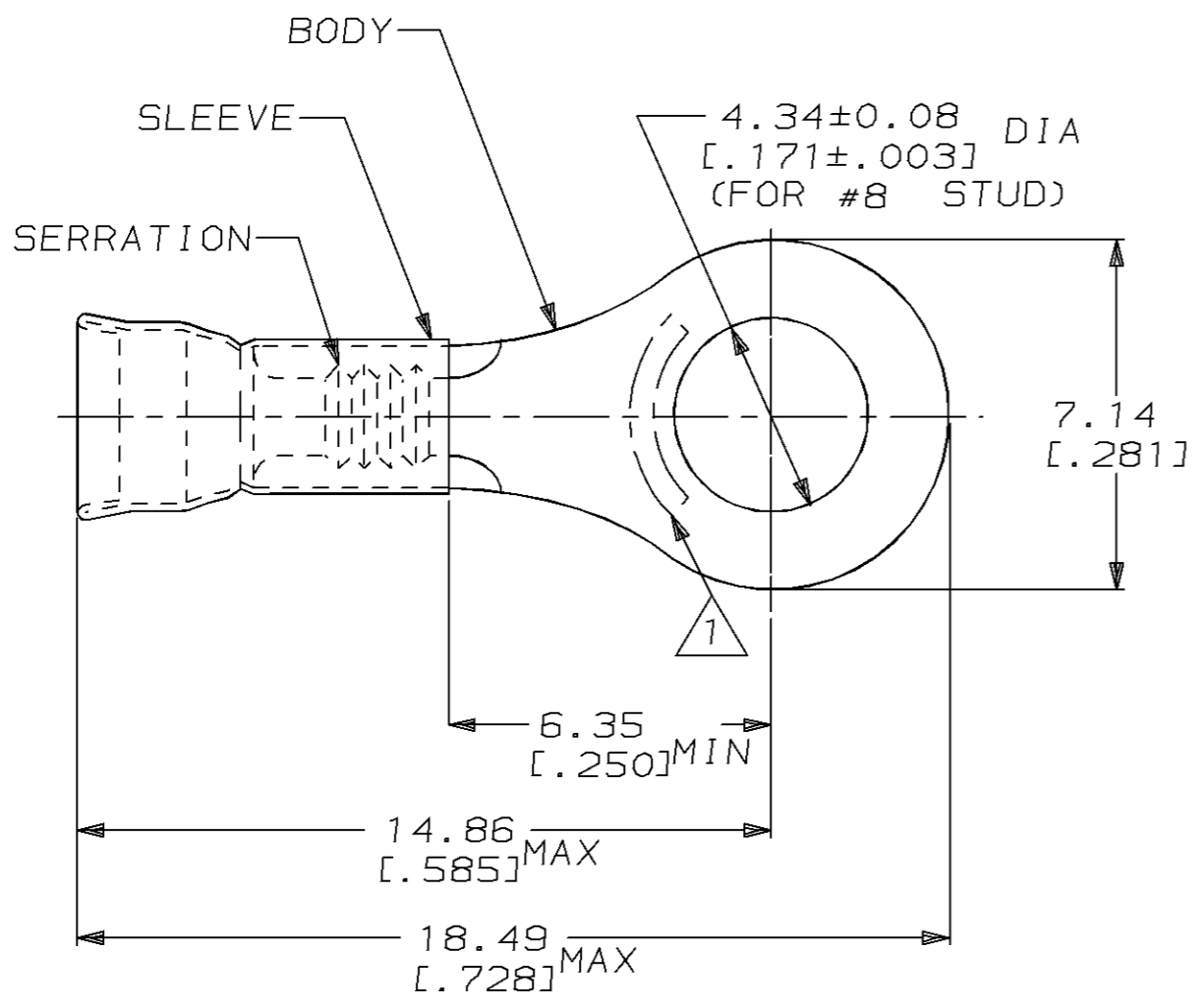

- ① STAMP AMP 22-18* APPROX AS SHOWN
22-16 TERMINALS ARE STAMPED 22-18 IN
ACCORDANCE WITH MILITARY SPEC MIL-T-7928
COMMERCIAL WIRE RANGE IS 22-16
- 2. WIRE INSUL DIA, 2.67-3.56 [.105-.140]
- 3. TONGUE MATL THK, 0.79±0.05 [.031±.002]
- ④ TIN PLATE PER MIL-T-10727
- ⑤ GOLD PLATE PER MIL-G-45204 OVER NICKEL
PLATE PER QQ-N-290

| | | | |
|---|------|---------------|-----------|
| ⑤ | 1000 | LOOSE PIECE | 31397-1 |
| ④ | 5000 | ON TAPE, REEL | 2-31397-1 |
| ④ | 1000 | LOOSE PIECE | 31397 |
| | QTY | PACKAGE TYPE | PART NO |

| | | | | | | |
|---|--|---|---|------------------------|---|--|
| AMP INCORPORATED CUSTOMER SERVICE SYSTEM | | MAX RECOMMENDED OPERATING TEMPERATURE: 170°C [338°F] | THIS DRAWING IS A CONTROLLED DOCUMENT FOR AMP INCORPORATED. IT IS SUBJECT TO CHANGE AND THE CONTROLLING ENGINEERING ORGANIZATION SHOULD BE CONTACTED FOR THE LATEST REVISION. | | DWN L OLMEDA 23JAN95 | AMP AMP Incorporated Harrisburg, PA 17105-3608 |
| FOR ADDITIONAL PRODUCT INFORMATION OR COPIES OF DRAWINGS AND TECHNICAL DOCUMENTS | PRODUCT INFORMATION CENTER 1-800-522-6752 | | VOLTAGE RATING: - | DIMENSIONS: mm [in] | TOLERANCES UNLESS OTHERWISE SPECIFIED: | |
| FOR APPLICATION TOOLING INFORMATION | TOOLING ASSISTANCE CENTER 1-800-722-1111 | CIRCULAR MIL AREA: 0.26mm ² -1.65mm ² [509-3260] | | 0 PLC ±- | APVD S BORTNER 23JAN95 | NAME TERMINAL, RING, DIAMOND GRIP™ WIRE SIZE, 22-16 AWG |
| FOR ORDER ENTRY | 1-800-526-5142 | MATERIAL BODY, CU, SLV, CU PER ASTM B152 | | 1 PLC ±- | 2 PLC ±0.20 [.008] | PRODUCT SPEC UL486A |
| | | | | 3 PLC ±- | APPLICATION SPEC - | CAGE CODE 00779 |
| | | | | 4 PLC ±- | WEIGHT - | DRAWING NO C-31397 |
| | | | | ANGLES ±- | CUSTOMER DRAWING | SCALE 6:1 |
| | | | | FINISH SEE NOTE | | SHEET 1 OF 1 |
| | | | | | | REV E |