

LOC	DIST	REV	ZONE	LTR	DESCRIPTION	DATE	APPD
6	14		A		REVISED PER 0720-0230-93	2/28/94	DAP

**METRIC**  
 DIMENSIONS LISTED IN MM ( INCHES )

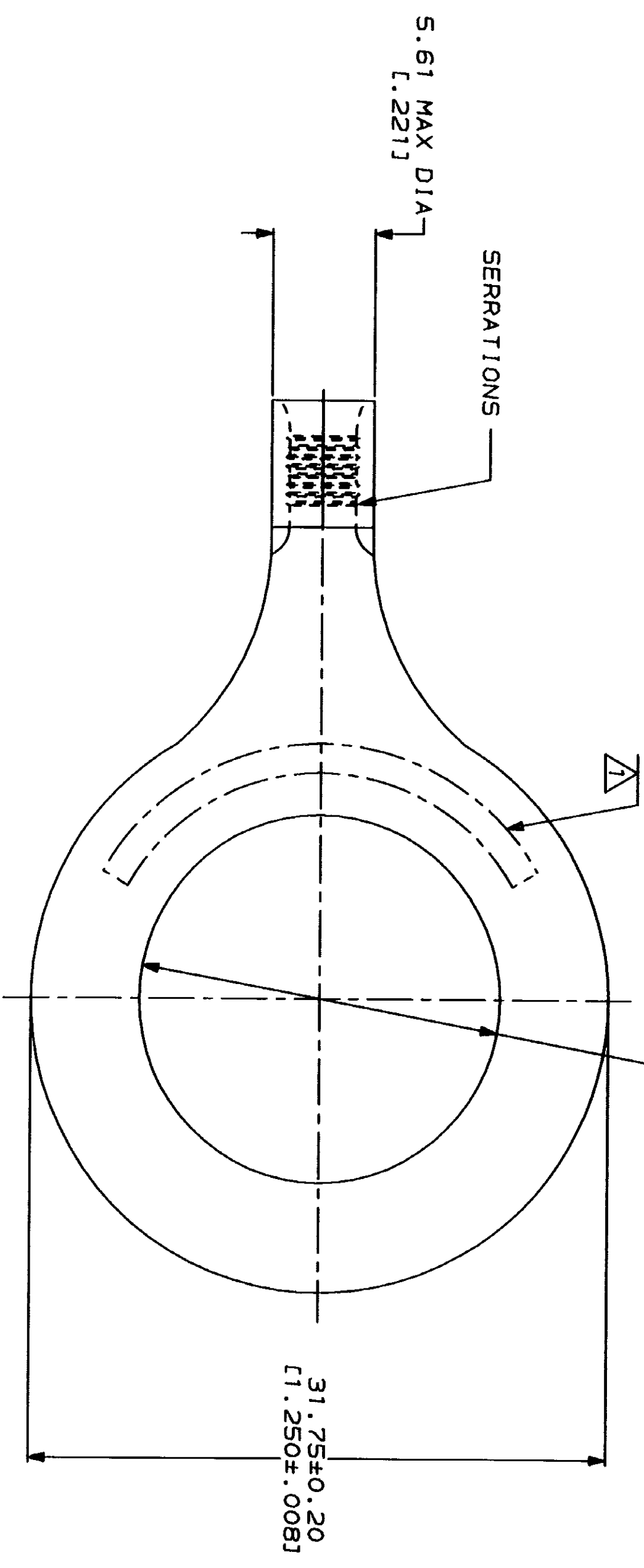

<b>AMP</b> WIRE RANGE 12-10 AWG STRANDED	<b>UL</b> E13288 Listed
<b>LR7189</b> Certified	MILITARY P/N AND CLASS
NOT CERTIFIED	NOT APPLICABLE

△ STAMP AMP 12-10\* APPROX AS SHOWN

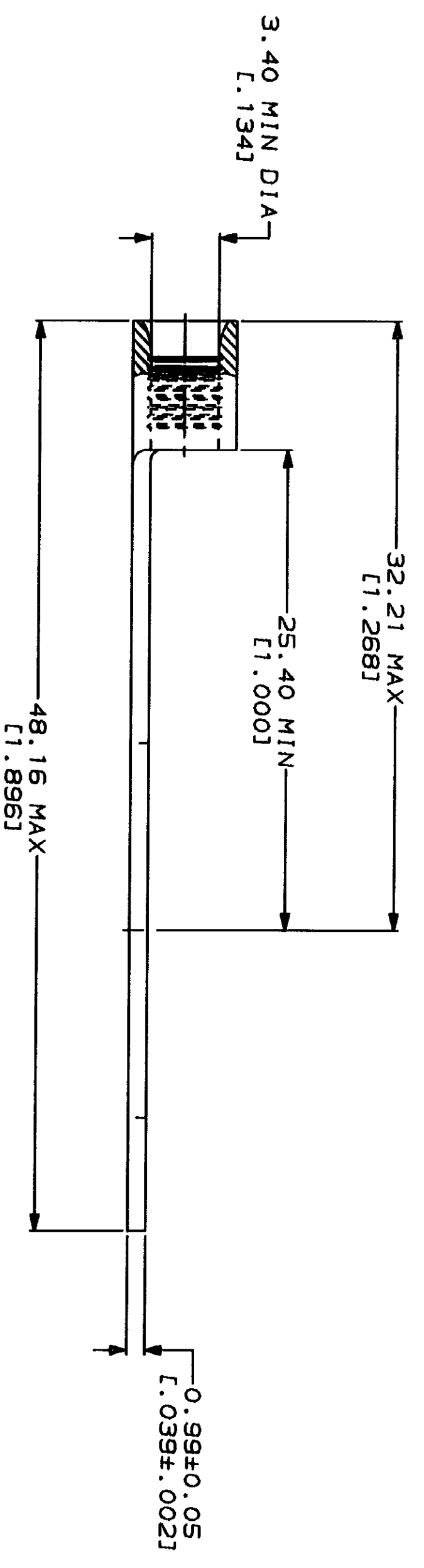

AMP INCORPORATED  
 CUSTOMER SERVICE SYSTEMS

FOR ADDITIONAL PRODUCT INFORMATION OR COPIES OF DRAWINGS AND TECHNICAL DOCUMENTS	PRODUCT INFORMATION CENTER 1-800-522-6752
FOR APPLICATION TOOLING INFORMATION	TOOLING ASSISTANCE CENTER 1-800-722-1111
FOR ORDER ENTRY	1-800-526-5142

MAX RECOMMENDED OPERATING  
 TEMPERATURE:  
 170°C MAX

VOLTAGE RATING:  
 NOT APPLICABLE

WIRE CROSS SECTIONAL AREA RANGE:  
 2.62-6.64mm<sup>2</sup> (5, 180-13, 100) CIR MILS  
 STRANDED

DO NOT SCALE PRINT.  
 UNLESS SPECIFIED  
 DIMENSIONS IN mm (INCHES)  
 TOLERANCES ON:  
 2 PLC DEC ± .  
 3 PLC DEC ± .  
 ANGLES  
 MATERIAL:  
 COPPER PER  
 ASTM B-152  
 ANNEALED

DR 2-9-93  
 TA BRINKMAN  
 CHK 2-9-93  
 DA PATTERSON  
 APPD 2-9-93  
 DE MILLER  
 APPD 2-9-93  
 JL NECKLEY  
 PRODUCT SPEC

FINISH  
 TIN PLATE  
 0.00254 [1.000100] MIN  
 THK PER MIL-T-10727

APPLICATION SPEC  
 WEIGHT

NAME  
 AMP  
 AMP Incorporated  
 Harrisburg, PA 17105-3608

TERMINAL, RING TONGUE,  
 BUDGET  
 SIZE  
 CAGE CODE  
 00779  
 DRAWING NO  
 320762  
 SCALE  
 4:1  
 SHEET  
 1 OF 1