

SUMMARY

Wires

| | |
|---------|---|
| Low | 0 |
| High | 0 |
| Coax | 1 |
| Triax | 0 |
| Quad | 0 |
| Fiber | 0 |
| Fluidic | 0 |



Image is for illustrative purpose only

Download

[Request a quote](#)

[Catalog](#)

| | |
|------------------|-------------------|
| Series | 1S |
| Termination type | Male solder |
| IP rating | 50 |
| Cable Ø | 7.20 - 8.20 mm |
| Matching parts | ERA.1S.275.CTL |
| Status | NRND |
| Alternative part | FFA.1S.275.CTAK82 |

TECHNICAL DETAILS

Mechanics

| | |
|-------------------|---|
| Shell Style/Model | FFA*: Straight plug with oversize cable collet |
| Keying | |
| Housing Material | Brass (chrome plated) shell and collet nut, nickel plated brass latch sleeve and mid pieces |
| Cable Fixing | K77: 7.2 - 8.2 mm |
| Variant | |

Performance

| | |
|---------------|--------------------------|
| Configuration | 1S.275 : 1 Coax (75 Ohm) |
| Insulator | T: PTFE |
| Rated Current | 10 Amps |

Specifications

| |
|---------------------------------------|
| Contact Type: Coaxial 75 Ohm (Solder) |
| Max. Matings: 1000 |
| Contact Dia.: 1.3 mm (0.0512in) |
| Bucket Dia.: 1.1 mm (0.0432in) |
| Vtest: 2400 V (AC), 3300 V (DC) |
| Impedance: 75 Ohm |

VSWR: $1.02 + 0.08 \cdot f/\text{GHz}$

Cable type: RG 179 B/U, RG 187 A/U, RG 58 C/U, RG 302 /U, RG 400 /U, 2YCCY, RG 59 B/U, RG 223 /U, HF-5408

Others

Endurance (Shell): 5000 mating cycles

Temp (min / max): $-55^{\circ}\text{C} / +250^{\circ}\text{C}$

Humidity (max): $\leq 95\%$ [at $60^{\circ}\text{C} / 140^{\circ}\text{F}$]

Vibration: 15 g [10 Hz - 2000 Hz]

Shock Resistance: 100 g [6 ms]

Salt Spray Corrosion: >144 hr

Climatical Category: 50/175/21

Shielding (min): 75 dB (10 MHz)

Shielding (min): 40 dB (1 GHz)

IP Rating: 50

DRAWINGS

Draws

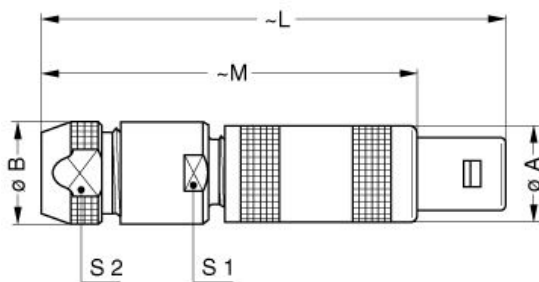

Dimensions

| | A | B | L | M | S1 | S2 |
|-----|------|------|------|------|------|------|
| mm. | 12 | 13 | 57 | 46 | 12 | 11 |
| in. | 0,47 | 0,51 | 2,24 | 1,81 | 0,47 | 0,43 |

RECOMMENDED BY LEMO

Tools

Spanner wrench: DCD.15.015.PA085

Cables

