

PRODUCT NUMBER	PITCH
YK551xx0x0JOG	11.00 mm

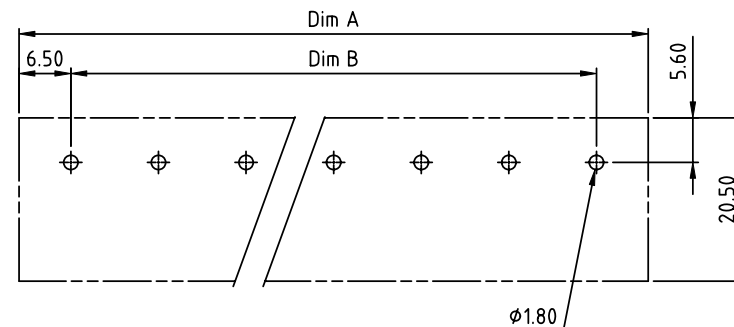

RECOMMENDED P.C.B LAYOUT  
TOP VIEW

**MATERIALS & ELECTRICAL**  
 RATED VOLTAGE & CURRENT: 300 V, 30 A  
 WITHSTAND VOLTAGE: AC 2000 V/Min  
 INSULATION RESISTANCE: 1000 MΩ OR MORE AT DC 500 V  
 OPERATING TEMPERATURE RANG: -40 °C ~ +115 °C  
 SCREW TORQUE VALUE: 9.5 Lb-In.  
 WIRE RANGE: 22-10AWG str/sol  
 1) HOUSING: Thermoplastic, UL 94 V-0 BLACK  
 2) TERMINAL: BRASS, 0.8t  
 3) TERMINAL SCREWS: STEEL, M4  
 APPROVAL:

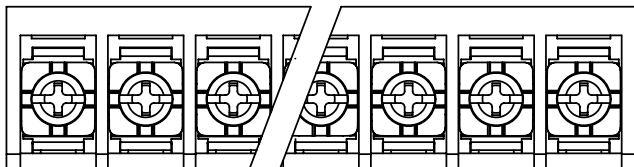
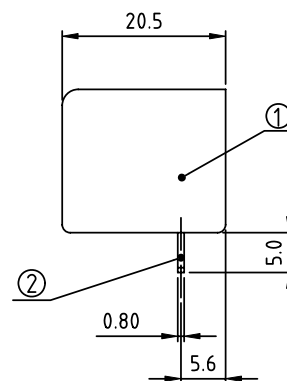
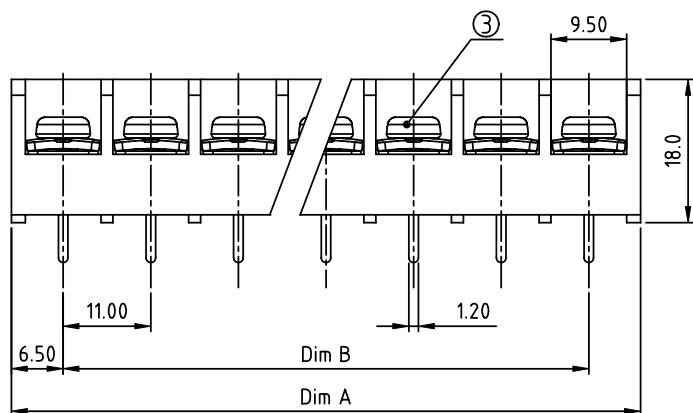

DIMENSION

Dim A	N×11.0+2.0
Dim B	(N-1)×11.0

N=Number of poles

Poles	Tolerance
2p-4p	±0.30
5p-8p	±0.40
9p-16p	±0.50
17p-23p	±0.60
24p-32p	±0.80

PART NO.: YK 551xx 0 x 0 JOG

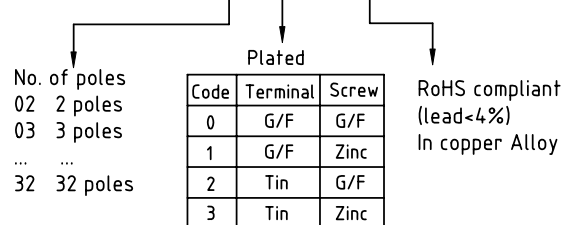

mat'l. code		surface ASME Y14.5	tolerance ASME Y14.5	projection 	product family TERMINAL BLOCK
ltr	ecn no	dr	date	tolerances unless otherwise specified	title TERMINAL BLOCK
				angles 0° 15° 30° 45° 60° 75° 90° 120° 150° 180°	BARRIER TYPE
				X±0.5 X.X±0.3 X.XX±0.1	scale MM
		dr	EVAN LU	061614	sheet 1 of 1 size
		enr	EVAN LU	061614	YK551xx0x0JOG A4
		chr	HANKE FENG	061614	
		appd	SHI JUN	061614	type CUSTOMER Drawing
sheet index	revision sheet	A	1		