

LOC	DIST	REVISIONS					
		P	LTR	DESCRIPTION	DATE	DWN	APVD
-	-	-	-	SEE SHEET 1	-	-	-

- ① CIRCUITS LOADED: ALL
- ② PRELIMINARY PART NUMBER
- ③ CIRCUITS LOADED: 1, 2, 3, 4, 5, 6, 7, 8, 9, 11, 12, 13, 14, 15, 16, 17, 18, 19.
- ④ CIRCUITS LOADED: 1, 2, 3, 4, 5, 6, 7, 8, 10, 12, 13, 14, 15, 16, 17, 18, 19.
- ⑤ CIRCUITS LOADED: 1, 2, 3, 4, 5, 6, 7, 8, 12, 13, 14, 15, 16, 17, 18, 19.
- ⑥ CIRCUITS LOADED: 1, 2, 3, 4, 7, 8, 9, 10, 11, 12, 13, 16, 17, 18, 19.
- ⑦ CIRCUITS LOADED: 1, 2, 3, 4, 7, 8, 9, 11, 12, 13, 16, 17, 18, 19.
- ⑧ CIRCUITS LOADED: 1, 2, 3, 4, 7, 8, 10, 12, 13, 16, 17, 18, 19.
- ⑨ CIRCUITS LOADED: 1, 2, 3, 4, 7, 8, 12, 13, 16, 17, 18, 19.

WHITE	⑨	12	BREAKAWAY	30°	② 1-1445757-6
BLACK	⑨	12	POSITIVE	0°	② 1-1445757-5
WHITE	⑧	13	BREAKAWAY	30°	② 1-1445757-4
BLACK	⑧	13	POSITIVE	0°	② 1-1445757-3
WHITE	⑦	14	BREAKAWAY	30°	② 1-1445757-2
BLACK	⑦	14	POSITIVE	0°	② 1-1445757-1
WHITE	⑥	15	BREAKAWAY	30°	② 1-1445757-0
BLACK	⑥	15	POSITIVE	0°	② 1445757-09
WHITE	⑤	16	BREAKAWAY	30°	② 1445757-08
BLACK	⑤	16	POSITIVE	0°	② 1445757-07
WHITE	④	17	BREAKAWAY	30°	② 1445757-06
BLACK	④	17	POSITIVE	0°	② 1445757-05
WHITE	③	18	BREAKAWAY	30°	② 1445757-04
BLACK	③	18	POSITIVE	0°	② 1445757-03
WHITE	①	19	BREAKAWAY	30°	② 1445757-02
BLACK	①	19	POSITIVE	0°	1445757-01

HOUSING COLOR	CIRCUITS LOADED	CONTACT QTY	LATCH	A REF	PART NUMBER
<small>TYPE SPECIFIC TO A CONTROLLED DOCUMENT FOR TYCO ELECTRONICS CORPORATION IF A SUBJECT IS CHANGED THE DOCUMENT IS OBSOLETE. ORGANIZATION SHOULD BE CONTACTED FOR THE LATEST REVISION.</small>					
DIMENSIONS:		TOLERANCES UNLESS OTHERWISE SPECIFIED:		DWN: 17AUG2001 SHANE WILES CWR: 17AUG2001 G. DOUZY APVD: - NAME: Tyco Electronics Harrisburg, PA 17105-3608 PRODUCT SPEC: ASSMELY, RECEPTACLE, SPRING PROBE APPLICATION SPEC: SOLDER CUP, 19 POSITION, MICRO CPC SIZE: A2 CAGE CODE: 00779 DRAWING NO: 1445757 RESTRICTED TO: -	
mm	0 PLC ±.1 1 PLC ±.1 2 PLC ±.13 3 PLC ±.1 4 PLC ±.1	ANGLES ±.1	MATERIAL	FINISH	WEIGHT
CUSTOMER DRAWING			SCALE: 5:1	SHEET: 2 OF 2	REV: 10

LOC	DIST	REVISIONS				
P	LTR	DESCRIPTION	DATE	DWN	APVD	
7		REVISED	13MAY03	BH	KD	
8		ADDED 'B'. A REF. 30° WAS 10°	5-28-03	GD	KD	
9		REVISED	3-15-04	GD	KD	
10		ADDED P/N: -03 THRU 1--6, NOTES, SHEET 2.	4-08-04			

LATCH IDENTIFIER
 B-BREAKAWAY LATCH
 BREAKAWAY VERSION ONLY,
 MAY BE ORIENTED
 IN ANY DIRECTION

ALIGNMENT
 INDICATORS

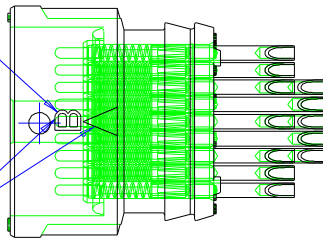

THIS PRODUCT HAS NOT COMPLETED
 VALIDATION TESTING

Ø 13.5 ± 0.1

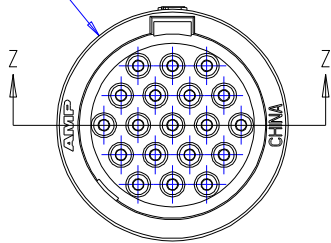

6.63
 REF

6.25 ± 0.25

MATERIAL: THERMOPLASTIC, COLOR-SEE TABLE

HOUSING, QTY-1

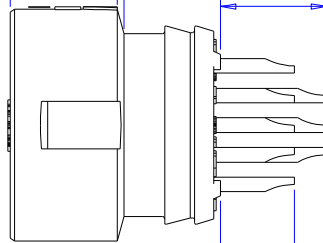

6.2 ± 0.1 TYP

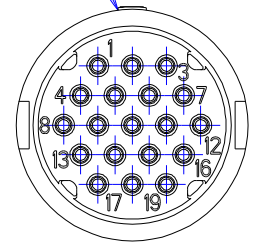

12.25 ± 0.36

4.3 ± 0.1
 TYP

CONTACT, PISTON, QTY-19
 MATERIAL: BRASS
 FINISH: GOLD OVER NICKEL

SEAL, INTERFACIAL, QTY-1
 MATERIAL: SILICONE, COLOR-RED

SOLDER TERMINATION AREA OF ALL
 CONTACTS IN CIRCUITS #8 THRU #12
 MAY BE ORIENTED UP OR DOWN.

DIM A

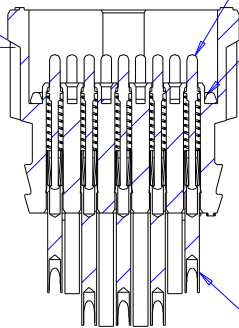

CONTACT, SOLDER CUP, QTY-19
 MATERIAL: BRASS
 FINISH: TIN-LEAD OVER NICKEL
 SEE VIEW W FOR CONTACT ORIENTATION

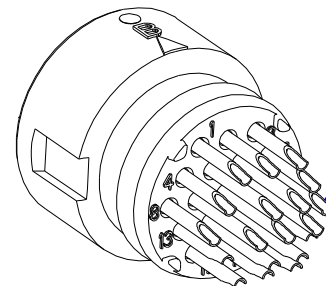

VIEW W

SECTION Z-Z

<small>THIS DRAWING IS A CONTROLLED DOCUMENT FOR TYCO ELECTRONICS CORPORATION IT IS SUBJECT TO CHANGE AND THE USER SHALL BE RESPONSIBLE FOR OBTAINING THE LATEST REVISION. DIMENSIONS SHALL BE IN MILLIMETERS UNLESS OTHERWISE SPECIFIED.</small>		DWN: 17AUG2001 SHANE WIESE CDR: 17AUG2001 G. DOUTY	Tyco Electronics Harrisburg, PA 17105-3608
DIMENSIONS: mm 0 PLC ±: 1 PLC ±: 2 PLC ±0.13 3 PLC ±: 4 PLC ±: ANGLES ±: FINISH	TOLERANCES UNLESS OTHERWISE SPECIFIED: ±: ±: ±: ±: ±: ±: ±:	APVD: PRODUCT SPEC: APPLICATION SPEC:	NAME: ASSMELY, RECEPTACLE, SPRING PROBE SOLDER CUP, 19 POSITION, MICRO CPC
MATERIAL	SEE CALLOUT	WEIGHT	RESTRICTED TO
CUSTOMER DRAWING		SIZE: A2	CAGE CODE: 00779
SCALE: 5:1		DRAWING NO: C-1445757	REV: 10