

NOTES:

- MATERIAL: COPPER ALLOY 151, 0.50mm THICK.
- PLATING:
OVERALL *TIN: 0.00254 MIN BRIGHT TIN
OVER 0.00127 MIN NICKEL.

SELECT GOLD: 0.00076 MIN. SELECT GOLD IN CONTACT AREA,
0.00127 MIN. SELECT *TIN IN CRIMP AREA. OVER 0.00127 MIN NICKEL.

*THE PRIMARY SHIPPING CARTON WILL BE LABELED "COMPLIANT TO RoHS
DIRECTIVE 2002/95/EC AND ELV ANNEX II OF DIRECTIVE 2000/53/EC".
CARTONS WITHOUT THIS LABEL MAY CONTAIN PRODUCT WITH TIN-LEAD.

- PRODUCT SPECIFICATION: PS-42815-001.
- PART IS DESIGNED IN METRIC.
- TERMINALS FOR USE WITH STRANDED WIRE ONLY.
STRANDED TINNED WIRE IS RECOMMENDED.
- AFTER CRIMPING, THIS DIMENSION IS 3.55mm MINIMUM.
- CRIMP SPECIFICATION: 638301000.
- WHEN USING TIN-PLATED TERMINALS FOR APPLICATIONS
INVOLVING VIBRATION AND/OR THERMAL CYCLING,
MOLEX STRONGLY RECOMMENDS THE USE OF NYE LUBRICANT,
NYOGEL 760G, ON THE MATING AREA OF THE TERMINAL.
LUBRICANT SHOULD BE APPLIED AFTER THE TERMINALS ARE
INSERTED INTO THE HOUSING.

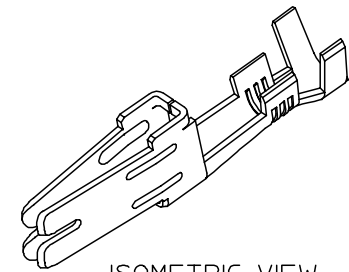
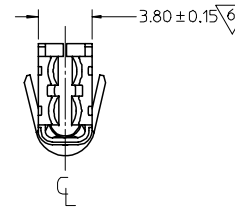
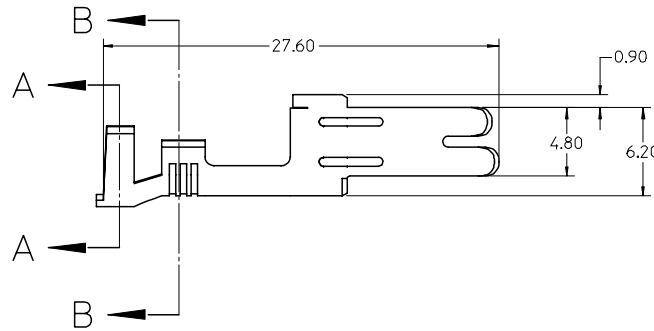
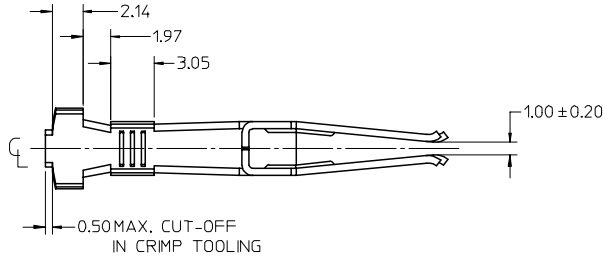

ISOMETRIC VIEW

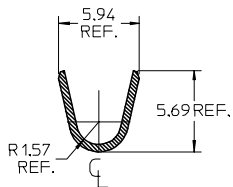

SECTION A-A
INSULATION CRIMP

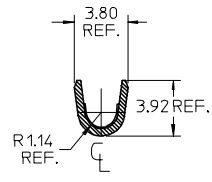

SECTION B-B
CONDUCTOR CRIMP

MATERIAL NO.	PLATING
42815-0041	TIN
42815-0042	SELECT GOLD

REVISED SECTIONS EC NO: UCP2006-1068 DRAWN: JCOMERC 2005/11/07 CHKD: CHIKO 2005/11/07 APPR: JCOMERC 2005/11/08	QUALITY SYMBOLS	GENERAL TOLERANCES (UNLESS SPECIFIED)
	DESCRIPTION	SCALE 4:1
REV	DESCRIPTION	DESIGN UNITS METRIC
B2	REV	THIRD ANGLE PROJECTION

4 PLACES	± ---	± ---
3 PLACES	± ---	± .010
2 PLACES	± 0.25	± .016
1 PLACE	± 0.40	± ---
ANGULAR ±1/2°		
DRAFT WHERE APPLICABLE MUST REMAIN WITHIN DIMENSIONS		

DRAWN BY	DATE
MFIRLEJ	2002/05/15
CHECKED BY	DATE
JCOMERC	2002/05/15
APPROVED BY	DATE
JCOMERC	2002/05/15

TITLE	MINIFIT SR. FEMALE CRIMP TERMINAL, 14-16 AWG GOLD PLATED
MATERIAL NO.	SEE CHART
DOCUMENT NO.	SD-42815-020
SHEET NO.	1 OF 1
THIS DRAWING CONTAINS INFORMATION THAT IS PROPRIETARY TO MOLEX INCORPORATED AND SHOULD NOT BE USED WITHOUT WRITTEN PERMISSION	