

THIS DRAWING IS UNPUBLISHED.		RELEASED FOR PUBLICATION	
COPYRIGHT BY TYCO ELECTRONICS CORPORATION. ALL RIGHTS RESERVED.			
PART NUMBER	REV	FIRST USED	
565816-3	D	-	

LOC	DIST	REVISIONS					
A	66	P	LTR	DESCRIPTION	DATE	DWN	APVD
		D1		ECN 0150-0081-05	1-05	MY	TE

APPLICATOR PARTS LIST				TYPE			LEFT AMP INCORPORATED BOTH				
				ENDFEED			FLAG HARRISBURG, PENNA. LEGS ON BLADE				
NO.	DESCRIPTION	REQ.	PART NO.	NO.	DESCRIPTION	REQ.	PART NO.	CRIMPING DATA			TERMINALS
1	WIRE CRIMPER	1	686916-2	42				TO APPLY TERMINAL			61148-
2	INS. CRIMPER	1	686917-1	43	SCREW, BUT. HD. 1/4x20	1	3-21002-2	WIRE SIZE	CRIMP HEIGHT		
3	ANVIL WIRE	1	464820-1	44				21	.058		
4	ANVIL SPACER INS.	1	810685-2	45				20	.059		
5	SHEAR BLADE	1	464821-1	46				19	.061		
6	REAR SHEAR PLATE	1	385013-4	47				18	.063		
7	SHEAR BLADE SPACER - FRONT	1	374083	48	TERMINAL STOP (REF. 4)	1	686936-1	17	.066		
8	SHEAR BLADE SPACER - REAR	1	686918-1	49	DRAG STOP	1	452835-1	CRIMP	SIZE	TYPE	FEED
9	REAR ANVIL SPACER PLT.			50	DRAG BUSHING - FRT.	1	452836-1	WIRE	.090	F	
10	FRONT ANVIL SPACER PLT.			51	DRAG STUD - FRT.	1	452837-1	INSUL.	.170	0	.500
11	TOOL SPACER			52	DRAG SPRING - FRT.	1	370572	SLEEVED			
12	CRIMP SPACER	1	854652-8	53				INSULATION RANGE	WIRE RANGE		
13	FRONT STRIP GUIDE - TOP	1	691059-1	54				.095-.115	21-17 MAG.		
14	REAR STRIP GUIDE	1	379034-2	55				EXPLODED VIEW			
13A	FRONT STRIP GUIDE - BOT.	1	372895	56				REMARKS: BUILT UP ANVIL TO RETAIN BLADE			
15	RAM	1	471911	57				WIRE LOCATOR			
16	TOOL HOLDER			58				1" AIR FEED ASSY.			
17	ADJ. CRIMP MOUNT ASSY.	1	465392-1	59				TENSION ADJ. PLATE			
18	ADJ. BLOCK			60				MISCELLANEOUS			
19	APPLICATOR MOUNT ASSY.	1	471707-7	61				LUBRICATOR ASSY.			
20	BASE PLATE			62				TERMINAL LUBRICANT REF.			
21	BASE BLOCK			63				AIR BLAST ASSY.			
22	STRIP GUIDE PLATE			64				ELBOW			
23	ANVIL HOLDER			65				COPPER TUBE			
24	AUX. ANVIL HOLDER			66				DENOTES WEARING PARTS RECOMMEND PURCHASE REPLACEMENT			
25	STRIPPER	1	686914-1	66				THIS APPLICATOR IS TO BE USED ON			
26	STRIPPER MOUNT (REAR MT.)	1	686912-1	67				AMP-O-ELECTRIC 1-471273-2			
27	RETAINER PLATE	1	372251	68				AUTOMATIC AIR FEED			
28	STRIPPER SPACER ^{MT. REF} 25461	1	471505-9	69				ALIGN. GA. 679597-1			
29	STRIPPER BUSHING			70				SERIAL NO.	DATE SHIPPED	DESIGNED	
30	STOCK DRAG	1	810917-1	71				CUSTOMER NAME AND ADDRESS			
31	STOCK DRAG HANDLE	1	375382	72				CHK'D.			
32	STOCK DRAG STUD	1	354045-1					APP'D.			
33	STOCK DRAG SPRING	1	1-23847-0					APPLICATOR NUMBER			
34	STOCK DRAG ADJ. SCREW	2	372997					REV.			
35	FEED FINGER HOLDER							SHEET			
36	FEED FINGER	1	452817-1					CF			
37	FEED FINGER TIP										
38	FEED FINGER SPACER										
39	BASE CASTING	1	570238								
40	GUARD	1	457664-3								
41											

AMPLIYAR ^{2/1/06} 17 SEE 68149

THIS DRAWING IS A CONTROLLED DOCUMENT.		DWN	27JAN05	Tyco Electronics Corporation Harrisburg, Pa 17105-3608
		M. YOUNGER	27JAN05	
DIMENSIONS: INCHES		CHK	27JAN2005	END FEED STANDARD APPLICATOR
		C. ERISMAN	27JAN2005	
TOLERANCES UNLESS OTHERWISE SPECIFIED:		APVD	28JAN2005	RESTRICTED TO
		T. ELBIN	28JAN2005	
0 PLC ± -		NAME		SIZE
1 PLC ± -		PRODUCT SPEC		
2 PLC ± -		APPLICATION SPEC		DRAWING NO
3 PLC ± -		WEIGHT		
4 PLC ± -		CUSTOMER DRAWING		OF
ANGLES ± -		SCALE		
FINISH		1 4		D1

AMP 830 (3/63) **APPLICATOR PARTS LIST (BOLT, NUT, SCREW, WASHER etc.)**

NO.	DESCRIPTION	SIZE	LGTH.	REQ.	PART NO.	NO.	DESCRIPTION	SIZE	LGTH.	REQ.	PART NO.
101	SCREW SOC. SET. S/L RAM PIN TO RAM (15)	1/4-20	1/2	1	21009-6	130	NUT, HEX S/L FRONT DRAG STUD (51)	8-32	~	1	21021-3
102	SCREW, HEX. HD. APPL. MT. (19) TO BASE CASTING (39)	3/8-16	1 1/4	3	3-21015-2	131	SCREW, SOC. HD. CAP DRAG STOP (49) TO APPL. MT. (19)	10-24	3/8	1	5-21000-2
103	WASHER, FLAT FRONT STRIP GUIDE (13 & 13A) TO APPL. MT. (19)	3/8 ID	~	3	371178	133	SCREW, SOC. HD. CAP	1/4-20	1/4	1	9-21001-0
104	SCREW SOC. HD. CAP REAR STRIP GUIDE (14) TO APPL. MT. (19)	8-32	5/8	2	2-21000-8	134	WASHER, LOCK BLADE (5) TO CRIMPER (1)	1/4 ID	~	1	21024-6
105	WASHER, FLAT DRAG ADJ. SCREWS (34)	8 ID	~	2	21055-6	136	SCREW, SOC. HD. CAP	1/4-20	7/8	2	21001-5
106	SCREW, SOC. HD. CAP DRAG HANDLE (31) TO DRAG (30)	8-32	3/8	2	2-21000-6	137	WASHER, FLAT AIR FEED ASSY. (64) TO BASE CASTING (39)	1/4 I.D.	~	2	21055-8
107	WASHER, FLAT R. DRAG STUDS (32)	8 I.D.	~	2	21055-6	138	SCREW SOC. HD. CAP	5-40	.25	1	6-21000-2
108	NUT, HEX ANVIL (3) ANVIL (4) SPACER (7 & 8) R. SLUG PL. (6) TO APPL. (19)	10-32	~	2	21018-7	139	WASHER, FLAT TERMINAL STOP (48) TO ANVIL, INS (9)	6 I.D.	~	1	21055-5
109	SCREW, FLAT HD. APPLICATOR ONLY TO INCLUDE	6-32	1/4	2	1-21003-8						
110	NUT, HEX. S/L CRIMPER MT. (17) SPACER (12) W. CRIMP (1) BLADE (5) TO RAM (15)	1/4-20	~	1	21022-4						
112	SCREW, SOC. HD. CAP TENSION ADJ. PLATE (65) TO FEED FINGER (36)	3/8-16	1 1/4	2	3-21001-6						
115	SCREW, SOC. HD. CAP CRIMPER INSERT (2) TO CRIMPER MT. (17)	1/4-20	1 1/2	2	21001-7						
116	SCREW, SOC. HD. CAP MT. ON-OFF VALVE OF AIR BLAST (68)	8-32	5/16	1	7-21000-4						
117	WASHER, FLAT RET. PL. (27) STRIPPER MT. (26) TO APPL. MT. (19)	8 ID	~	1	21055-6						
122	SCREW, SOC. HD. CAP STRIPPER (25) SPACER (28) LOCATOR (61) TO MOUNT (26)	8-32	5/16	1	7-21000-4						
123	WASHER, FLAT LOCATOR (61) TO MOUNT (26)	8 ID	~	1	21055-6						
125	SCREW, SOC. HD. CAP	10-32	1/2	2	3-21000-5						
126	WASHER, FLAT	10 ID	~	2	21055-7						
118	SCREW, SOC. HD. CAP	10-32	7/8	2	3-21000-8						
119	SCREW, SOC. HD. CAP	10-32	3/4	2	3-21000-7						

NOTES: 61148

THIS DRAWING IS A CONTROLLED DOCUMENT.

DIMENSIONS: INCHES	TOLERANCES UNLESS OTHERWISE SPECIFIED: 0 PLC ± - 1 PLC ± - 2 PLC ± - 3 PLC ± - 4 PLC ± - ANGLES ± - FINISH	DWN M. YOUNGER 27 JAN 05 CHK C. ERISMAN 27 JAN 2005 APVD T. ELBIN 28 JAN 2005	tyco Electronics Tyco Electronics Corporation Harrisburg, Pa 17105-3608
MATERIAL		NAME PRODUCT SPEC APPLICATION SPEC	END FEED STANDARD APPLICATOR
		SIZE A2 CAGE CODE 00779 DRAWING NO. C-565816-3 RESTRICTED TO	SCALE 1:1 SHEET 2 OF 4 REV D1

CUSTOMER DRAWING

565816-3

THIS DRAWING IS UNPUBLISHED. RELEASED FOR PUBLICATION
 © COPYRIGHT BY TYCO ELECTRONICS CORPORATION. ALL RIGHTS RESERVED.

LOC	DIST	REVISIONS			
P	LTR	DESCRIPTION	DATE	DWN	APVD
A	66	SEE SHEET 1	-	-	-

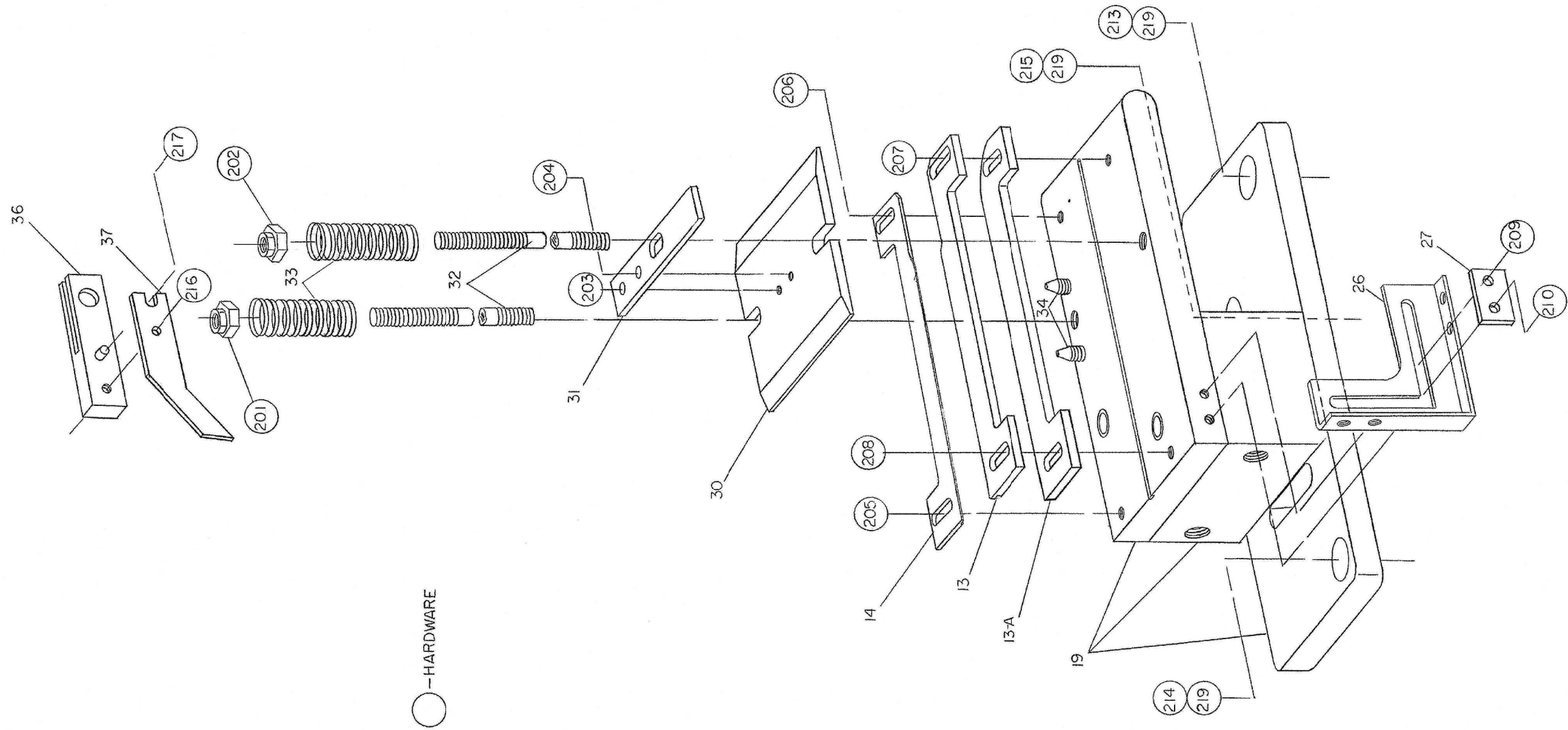

○—HARDWARE

THIS DRAWING IS A CONTROLLED DOCUMENT.		DWN M. YOUNGER 27JAN05	Tyco Electronics Corporation Harrisburg, Pa 17105-3608	
DIMENSIONS: INCHES		CHK C. ERISMAN 27BAM2005	NAME	
TOLERANCES UNLESS OTHERWISE SPECIFIED:		APVD T. ELBIN 28JAN2005	END FEED STANDARD APPLICATOR	
0 PLC	± .005	PRODUCT SPEC	SIZE	CAGE CODE
1 PLC	± .005	APPLICATION SPEC	A2	00779
2 PLC	± .005	WEIGHT	DRAWING NO C-565816-3	
3 PLC	± .005	FINISH	RESTRICTED TO	
4 PLC	± .005		-	
ANGLES	± .005		SCALE 1:1 SHEET 3 OF 4 REV D1	
MATERIAL	-	CUSTOMER DRAWING		

565816-3

THIS DRAWING IS UNPUBLISHED. RELEASED FOR PUBLICATION
 © COPYRIGHT BY TYCO ELECTRONICS CORPORATION. ALL RIGHTS RESERVED.

LOC	DIST	REVISIONS			
P	LTR	DESCRIPTION	DATE	DWN	APVD
A	66	SEE SHEET 1	-	-	-

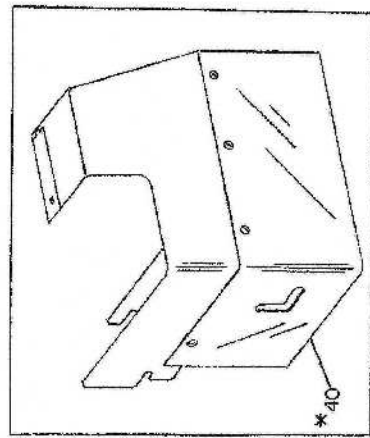
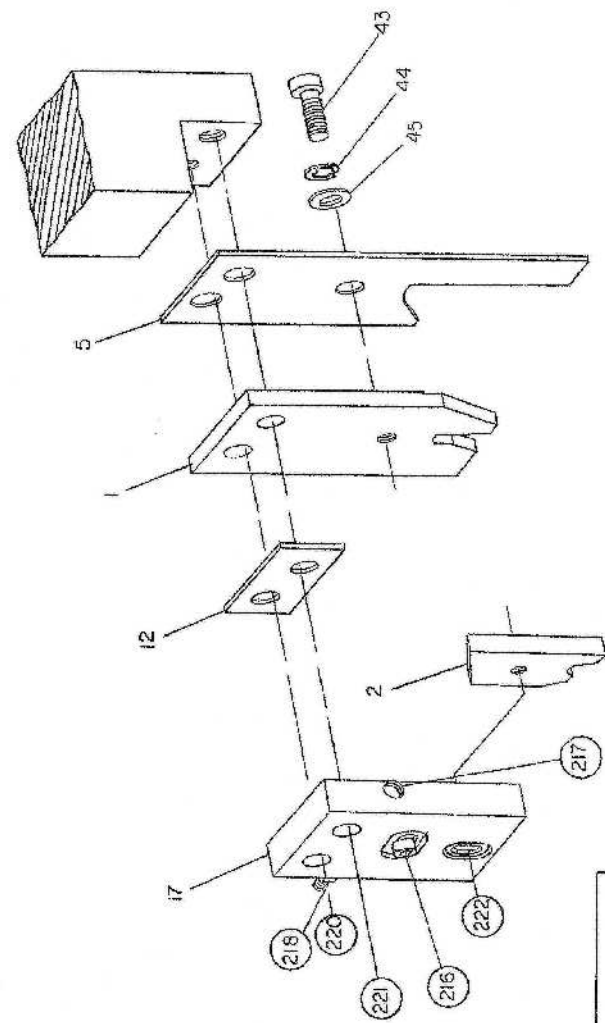

○ HARDWARE

△ OIL SPRINGLY USING VERY LIGHT OIL.

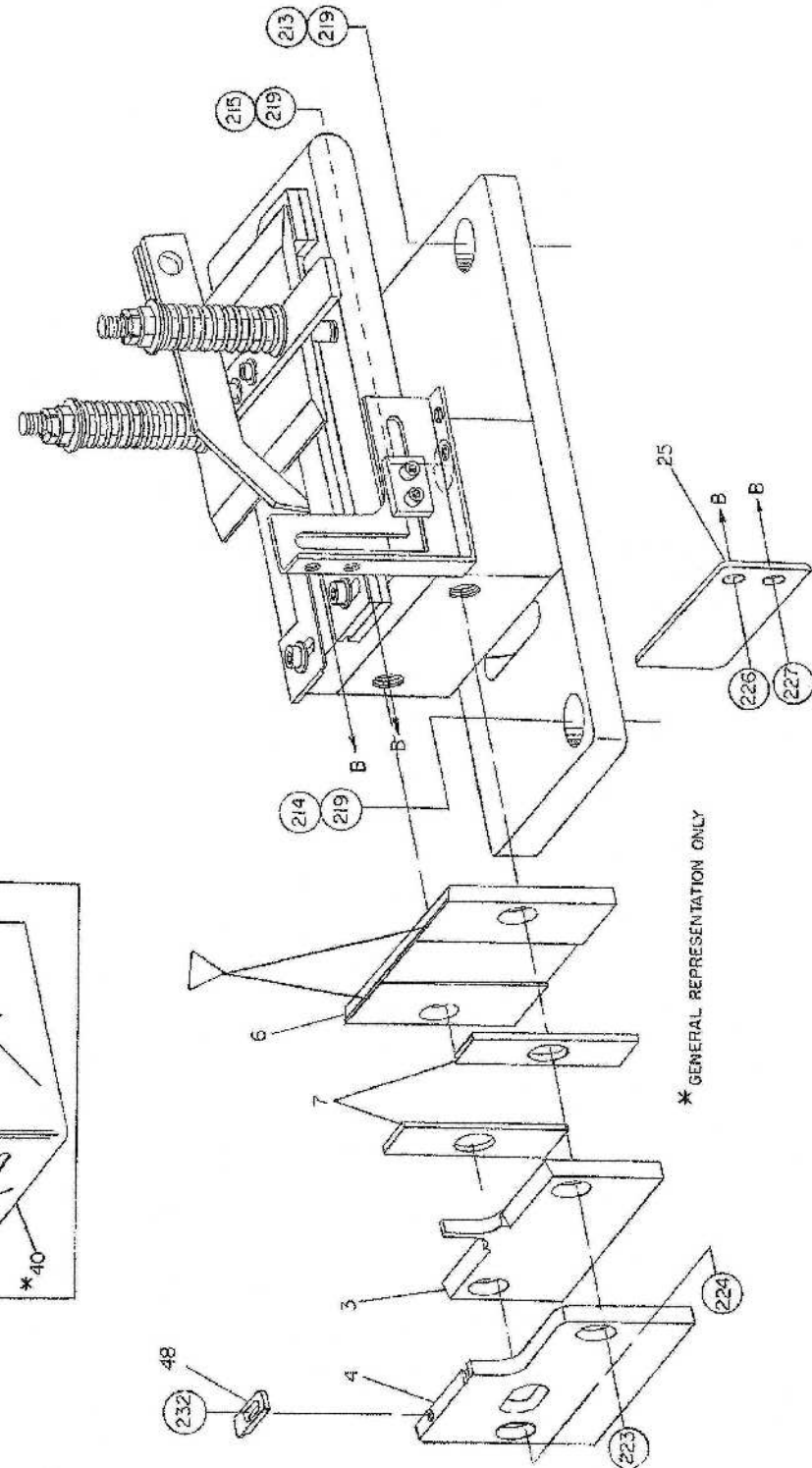

* GENERAL REPRESENTATION ONLY

THIS DRAWING IS A CONTROLLED DOCUMENT.		DWN M. YOUNGER 27JAN05	Tyco Electronics Corporation Harrisburg, Pa 17105-3608	
DIMENSIONS: INCHES		CHK C. ERISMAN 278AN2005	END FEED STANDARD APPLICATOR	
TOLERANCES UNLESS OTHERWISE SPECIFIED:		APVD T. ELBIN 28JAN2005	NAME	RESTRICTED TO
0 PLC ± -	1 PLC ± -	PRODUCT SPEC	SIZE	CAGE CODE
2 PLC ± -	3 PLC ± -	APPLICATION SPEC	A2	00779
4 PLC ± -	ANGLES ± -	WEIGHT	DRAWING NO C-565816-3	
FINISH		CUSTOMER DRAWING	SCALE	SHEET
			1:1	4 OF 4
				REV D1

565816-3