

## Mounting material - SISM 45 H - 2940139

Please be informed that the data shown in this PDF Document is generated from our Online Catalog. Please find the complete data in the user's documentation. Our General Terms of Use for Downloads are valid (<http://download.phoenixcontact.com>)

Mounting plate for screwing on switchgear, high-profile version



The illustration shows the SISM 45 product



### Key commercial data

Packing unit	1 PCE
GTIN	 4 017918 131159
Weight per Piece (excluding packing)	24.05 GRM
Custom tariff number	39269097
Country of origin	Germany

### Technical data

#### General

Housing type	DIN rail adapter
Housing material	Polyamide fiber reinforced
Color	green

#### Ambient conditions

Ambient temperature (operation)	-40 °C ... 105 °C
---------------------------------	-------------------

#### Dimensions

Length	60 mm
Width	45 mm

#### Technical data

Inflammability class according to UL 94	V2
---	----

## Mounting material - SISM 45 H - 2940139

### Classifications

#### eCl@ss

eCl@ss 4.0	27180401
eCl@ss 4.1	27180401
eCl@ss 5.0	27180506
eCl@ss 5.1	27180506
eCl@ss 6.0	27180802
eCl@ss 7.0	27182702
eCl@ss 8.0	27182702

#### ETIM

ETIM 2.0	EC001031
ETIM 3.0	EC001031
ETIM 4.0	EC001031
ETIM 5.0	EC001031

#### UNSPSC

UNSPSC 6.01	31261501
UNSPSC 7.0901	31261501
UNSPSC 11	31261501
UNSPSC 12.01	31261501
UNSPSC 13.2	31261501

### Drawings

## Mounting material - SISM 45 H - 2940139

Dimensioned drawing

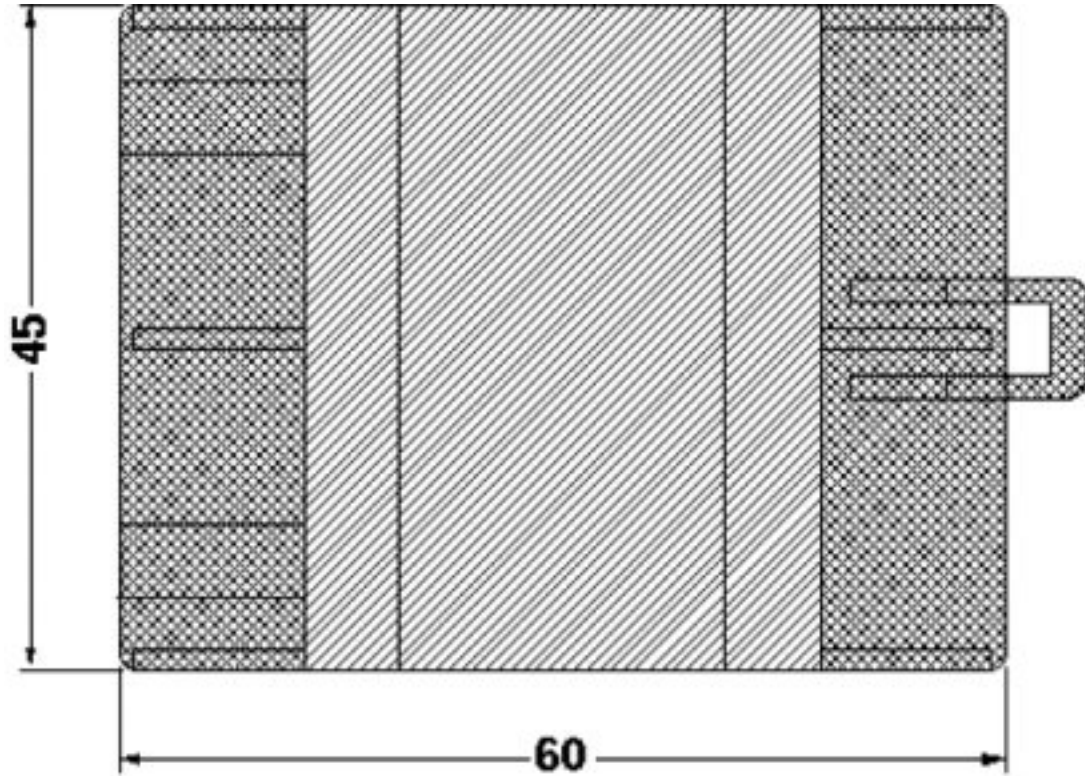

Dimensioned drawing

