

MODEL APSCM - DC CURRENT SHUNT

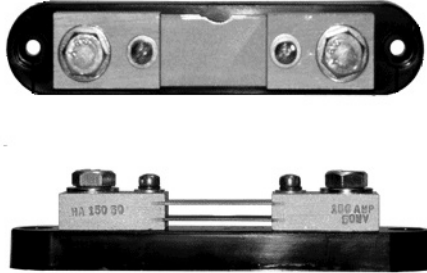

- 10 AND 100 AMP DC CURRENT SHUNTS
- CONVERTS DC CURRENT to DC MILLIVOLTS
- PROVIDES A 0 to 100 MILLIVOLT OUTPUT

DESCRIPTION

The APSCM current shunts accept signals over 2 Amp VDC and convert the output to a millivolt signal compatible with most standard DC meters. Two models are available; a 0 to 10 Amp and a 0 to 100 Amp version. Both models provide a 100 mVDC output proportional to the DC current input.

SAFETY SUMMARY

All safety regulations, local codes and instructions that appear in this and corresponding literature, or on equipment, must be observed to ensure personal safety and to prevent damage to either the instrument or equipment connected to it. If equipment is used in a manner not specified by the manufacturer, the protection provided by the equipment may be impaired.



CAUTION: Risk of Danger.
 Read complete instructions prior to installation and operation of the unit.



CAUTION: Risk of electric shock.

DIMENSIONS In inches (mm)

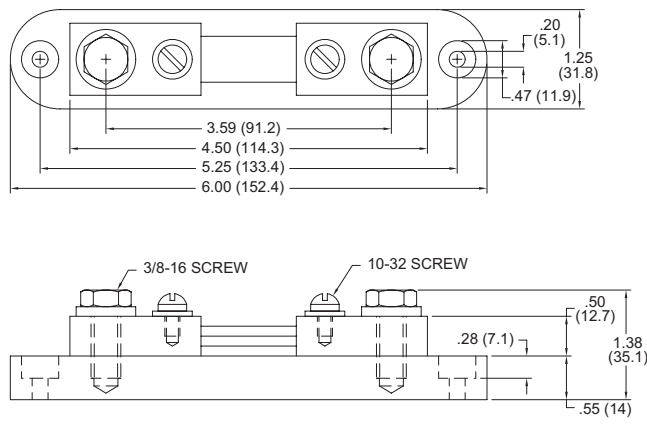

SPECIFICATIONS

- INPUT:** 10 or 100 Amps
- MAX CURRENT:** 110% of rating, not recommended for continuous use at Maximum Amp rating.
- TERMINALS:**
 Bolt Connections for Current Input
 Screw Connections for Millivolt Output
- WEIGHT:** 1 lbs. (0.45 Kg)

ORDERING INFORMATION

DC RATIO	DESCRIPTION	PART NUMBER
10 A : 100 mV	10 Amp Current Shunt	APSCM010
100 A : 100 mV	100 Amp Current Shunt	APSCM100