

PART NO..	ENG. NUMBER	TERMINAL LOCATION (SEE CHART)	MAT'L	PEG TYPE	PLATING (SEE CHART)	DIA. "A"
10-18-1031	A-3099-P3	A	V-0	POLARIZING	B	$.100 \pm .005$ (2.54 ± 0.13)
10-18-1032	A-3099-P3I	B		POLARIZING		
10-18-1033	A-3099-P3A	C		POLARIZING		
10-18-1034	A-3099-P3B	D		POLARIZING		
10-18-1035	A-3099-P3C	E		POLARIZING		
10-18-1036	A-3099-P3D	F		POLARIZING		
10-18-1037	A-3099-P3H	G		POLARIZING		
10-18-1038	A-3099-P3E	H		POLARIZING		
38-00-0204	A-3099-P3I3	B		NONE		$.103 \pm .003 / - .002$ (2.62 ± 0.08 / - 0.05)
22-19-1031	A-3099-030I	A	↓	LOCKING	↓	

TERMINAL LOCATION CHART (M=MALE, F=FEMALE, B=BLANK)			
TERMINAL LOCATION CODE	CIRCUIT NO.		
	1	2	3
A	M	B	M
B	M	M	M
C	F	M	M
D	M	F	M
E	M	M	F
F	M	F	B
G	M	F	F
H	F	F	F

PLATING CODE	PLATING
	A
B	PINS ONLY: OVERALL TIN: .000200/(0.00508) MIN. OVER COPPER .000100/(0.00254) MIN.
	SOCKETS ONLY: OVERALL TIN: .000050/(0.00127) MIN. OVER NICKEL .000050/(0.00127) MIN.

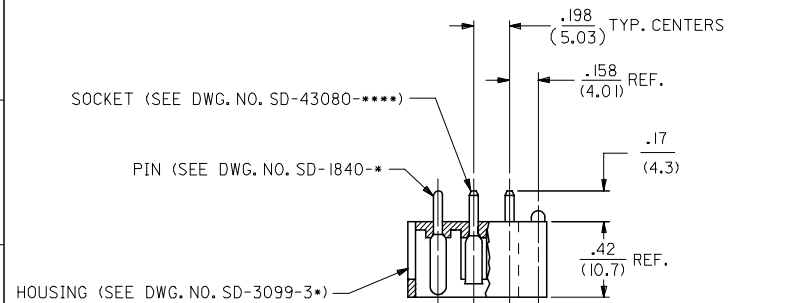

HOUSING WITH POLARIZING PEG SHOWN

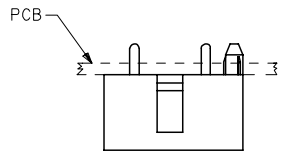

HOUSING WITH LOCKING PEG SHOWN

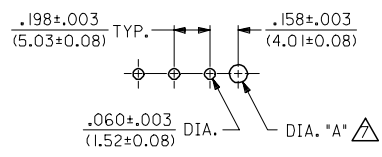
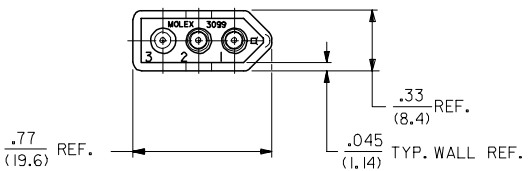

RECOMMENDED P.C. BOARD HOLE LAYOUT

- NOTES:
- MATERIAL:
HOUSING: UNFILLED POLYESTER, 94V-0, COLOR: BLACK
PIN TERMINAL: CARTRIDGE BRASS
SOCKET TERMINAL: PHOSPHOR BRONZE
 - FINISH: SEE TABLE
 - PRODUCT SPECIFICATION: N/A
 - PACKAGING SPECIFICATION: N/A
 - MATES WITH MOLEX 1396 RECEPTACLES AND .093/(2.36) SERIES TERMINALS.
 - ASSEMBLIES TO BE MOUNTED ON SUPPORTED EDGE OF P.C. BOARD.
- ▲ ONLY REQUIRED WHEN USING PARTS WITH OPTIONAL POLARIZING OR LOCKING PEGS.

UPDATE PLATING FC NO: UCP2006-2825 DRAWN/PRD: DER 2006/06/08 CHKD: AEL/HAG 2006/06/09 APPR: FSM/TH 2006/06/12	QUALITY SYMBOLS ▽=0 ▽=0	GENERAL TOLERANCES (UNLESS SPECIFIED)		DIMENSION STYLE IN/MM		SCALE 2:1	DESIGN UNITS INCH	THIRD ANGLE PROJECTION
		4 PLACES ± --- ± --- 3 PLACES ± --- ± .010 2 PLACES ± 0.25 ± .014 1 PLACE ± 0.36 ± --- ANGULAR ± 1/2°	DRAWN BY GEP DATE 5/25/89	CHECKED BY RW DATE 5/25/89	APPROVED BY RAS DATE 5/25/89	CONNECTOR ASSEMBLY ENCLOSED WAFER 3 CIRCUIT		
DRAFT WHERE APPLICABLE MUST REMAIN WITHIN DIMENSIONS		SEE CHART		MATERIAL NO. SDA-3099-*3**		DOCUMENT NO.		SHEET NO. 1 OF 1

THIS DRAWING CONTAINS INFORMATION THAT IS PROPRIETARY TO MOLEX INCORPORATED AND SHOULD NOT BE USED WITHOUT WRITTEN PERMISSION