

Core **ER35W/21/11**

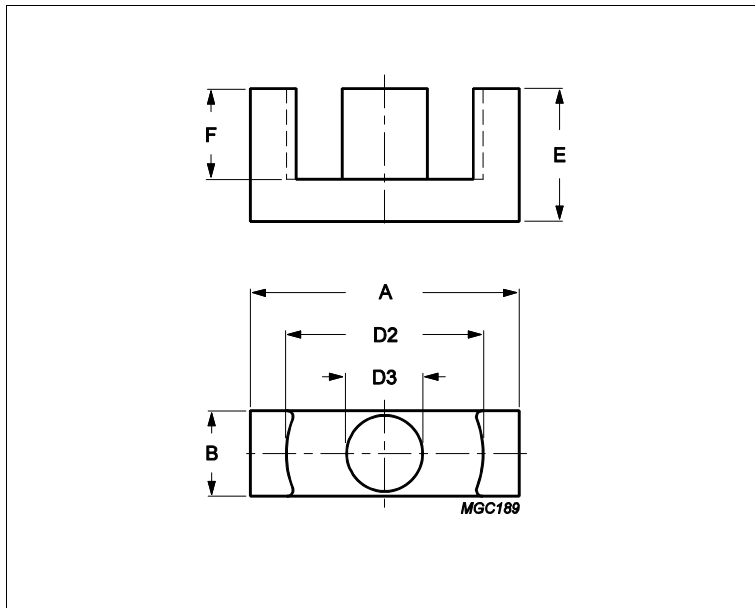

Effective parameters			
	Parameter	Value	Unit
$\Sigma(I/A)$	core factor (C1)	0.9	mm ⁻¹
Ve	effective volume	9548	mm ³
Le	effective length	92.7	mm
Ae	effective area	103	mm ²
Amin	minimum area	100	mm ²
m	ER35W/21/11	≈ 27	g/pcs

Dimensions for product: ERW/21/11						
	Nom	Tol +	Tol -	Max	Min	Unit
A	35.00	0.65	0.65	35.65	34.35	mm
B	11.30	0.35	0.35	11.65	10.95	mm
D2	27.10	0.70	0.70	27.80	26.40	mm
D3	11.30	0.25	0.25	11.55	11.05	mm
E	20.90	0.20	0.20	21.10	20.70	mm
F	15.00	0.20	0.20	15.20	14.80	mm

Inductance factor				
Material	Value	Tol +	Tol -	Unit
3C94	3000	25%	25%	nH/turns ²

Power loss: 3C94				
Measuring conditions			Max	Unit
100 kHz	200 mT	100 °C	4.800	W/set

Bsat					
Measuring conditions			Material	Min	Unit
25 kHz	250 A/m	100 °C	3C94	320	mT