

PRODUCT NUMBER	PITCH
THxx01x100J0G	5.00 mm

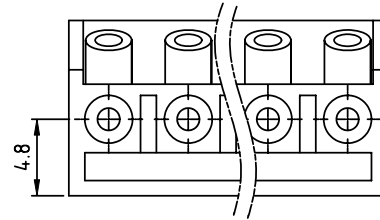
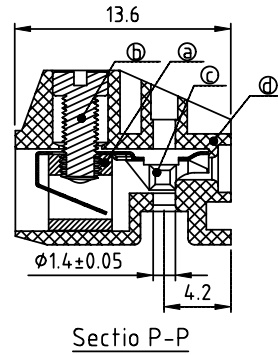
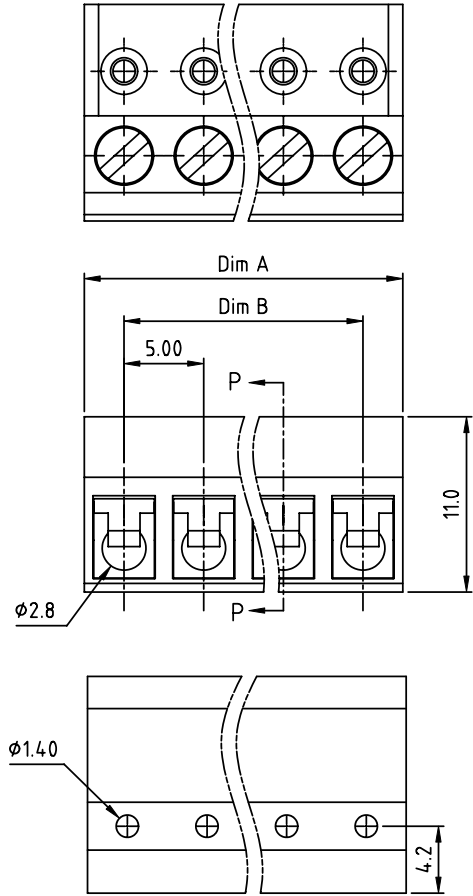

Material

- Item ① Clamp: Brass(CuZn) Tin plated
- Item ② Terminal screw: Steel Zinc plating "-" slot type
- Item ③ Female contact :PhBz (CuSn)
- Item ④ Terminal(housing): Thermoplastic (UL94V-0)

Electrical cULus / TUV / VDE

- Voltage rating: 300V/300V/300V
- Current rating: 15A/15A/12A
- Wire range: 0.34-1.5mm² / 0.34-1.5mm²
- Solid wire(AWG): 14-22 / 14-22
- Stranded wire(AWG): 14-22 / 14-22
- Torque: 3.5Lb-In / 0.4N.m / 0.4N.m
- Screw: M2.6
- Wire strip length: 5-6mm
- Withstanding Voltage: 1.6KV/2.5KV/2.5KV
- Operating temperature: -40°C to +115°C
- Safety Approval:

PART NO.: TH xx 01 x 1 00J0 G

N = Number of poles
Dim A=Nx5.0
Dim B=(N-1)x5.0

poles	Tolerance
2-6p	±0.15
7-12p	±0.20
13-18p	±0.30
19-24p	±0.40

Solid block	Body Color	RoHS compliant
No. of poles	0 Black (RAL9005)	(lead<4%)
02 2 poles	2 Red (RAL3001/D)	In copper Alloy
03 3 poles	3 Orange(RAL2011/P)	
...	4 Yellow(RAL1018/A)	
...	5 Green(RAL6018/T)	
24 24 poles	6 Blue (RAL5015/A)	
	8 Grey(RAL7035/D)	
	9 White(RAL1102)	
	C Green(RAL6018/U)	

mat'l. code				surface ASME Y14.5	tolerance ASME Y14.5	projection 	product family TERMINAL BLOCK
ltr	ecn no	dr	date	tolerances unless otherwise specified		MM	title TERMINAL BLOCK
				angles	X.±0.5		WIRE PROTECTOR,PLUGGABLE PLUG,SOLID BLOCK
				X*±1"	X.X±0.3	scale	dwg no THxx01x100J0G
					X.XX±0.1		sheet 1 of 1 size A4
				dr	EVIN ZHONG 041614		type CUSTOMER Drawing
				enrg	EVIN ZHONG 041614		
				chr	HANKE FENG 041614		
				appd	SHI JUN 041614		
sheet index	revision sheet	A	1				