

# AIRPAX®

## IAR/IUR/IER/CUR/CER Series "1RU" Magnetic Circuit Protectors

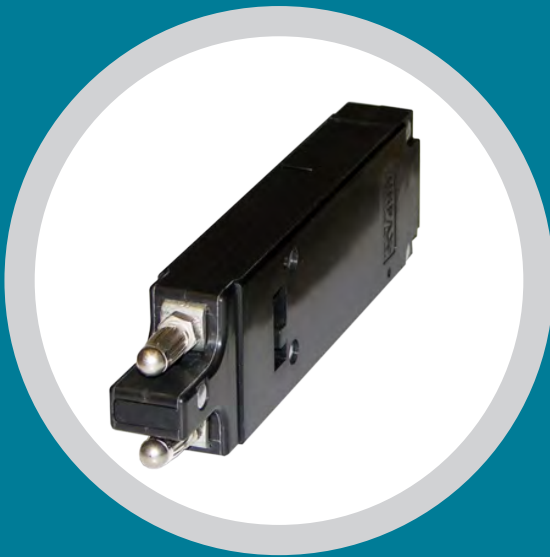

Introduction		49
Poles & Terminals		50
Configurations		53
Delay Curves & Specs		54
Operating Characteristics		55
Hardware		56
Decision Tables		57





# AIRPAX® | IAR/IUR/IER/CUR/CER Series

## “1RU” Hydraulic Magnetic Circuit Protectors

### FEATURES

- UL1077, TÜV, UL489A approved
- Designed to fit in a “1RU” application
- 5,000 AIC interrupt capacity (65/80VDC, 120/240VAC)
- Series or mid-trip with auxiliary switch alarm options
- Various delays including motor start
- 1 to 2 poles, multiple termination options

### INTRODUCTION

The Airpax™ IAR/IUR/IER/CUR/CER series is a snap-acting hydraulic-magnetic circuit breaker / protector that combines power switching and accurate, reliable circuit protection in one aesthetically pleasing, “1U” or “1RU” sized package.

Designed for rack mount applications, the IAR/IUR/IER/CUR/CER series allows efficient use of rack space without sacrificing performance via proven hydraulic-magnetic technology that provides consistent operation from -40°C to 85°C, with a circuit interrupt capacity up to 5,000 AIC at 65/80 VDC and 120/240 VAC. Available in series trip and mid-trip configurations, with auxiliary alarm switch options to provide monitoring of critical circuits.

The CER series circuit breaker provides the necessary ratings for wireless and wired applications while meeting UL489A and TÜV requirements for approval.

### APPROVALS

Ratings	Voltage	A.I.C.	Agency Approvals	Poles
2 to 50 amps	65 VDC	5,000	UL489A & C-UL	1
2 to 50 amps	80 VDC	5,000	TÜV to EN60934	1
2 to 50 amps	250 VAC	2,000	UL1077 & TÜV to EN60934	1
2 to 50 amps	80 VDC	5,000	UL489A & TÜV to EN60934	2
2 to 30 amps	120 / 240 VAC	5,000	UL1077, C-UL, TÜV to EN60934	2

## POLES & TERMINALS

The Airpax™ IAR/IUR/IER/CUR/CER series is available with one or two poles with various bullet, stud and screw terminals. Engineered for safe, sure operation, the toggle handles may be specified in blue, white, red, orange, green, yellow or black.

**Single Pole**

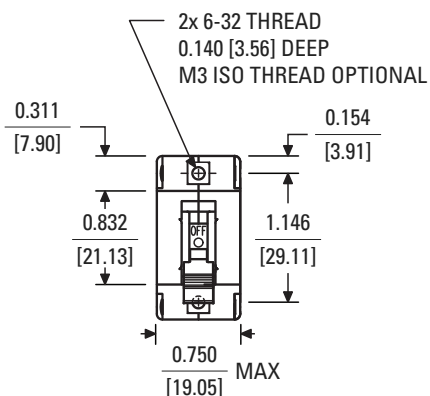

**Two Pole  
(with or without two handles)**

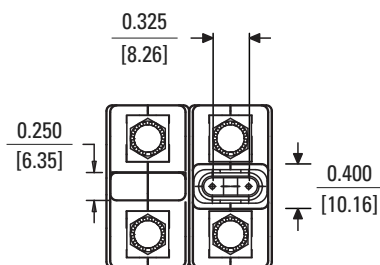
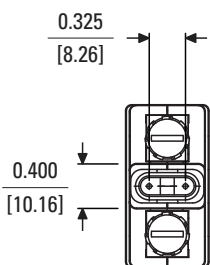
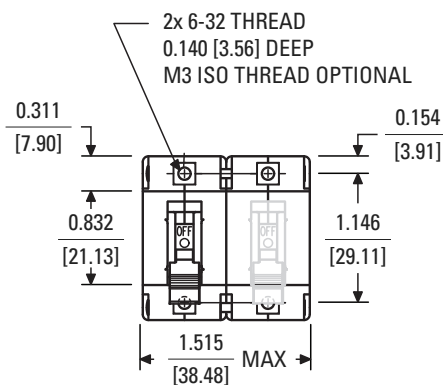

Auxiliary switch wires not shown for clarity

**Panel Mounting Detail, Single Pole**

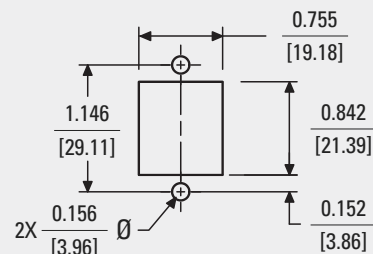

**Panel Mounting Detail, Two Pole, One Handle**

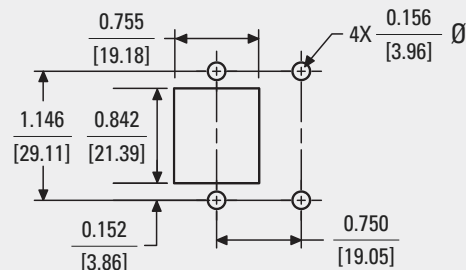

**Panel Mounting Detail, Two Pole, Two Handles**

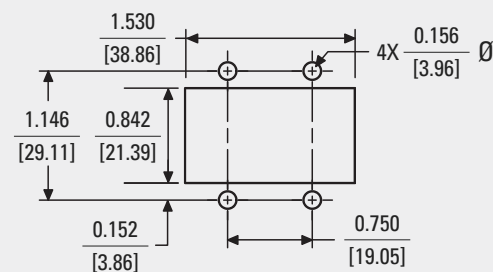

## Single Pole

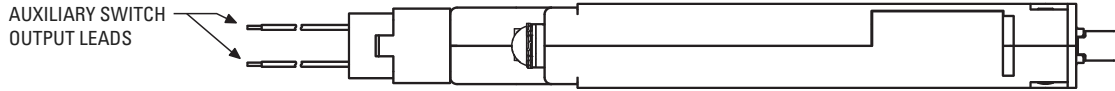

## Two Pole (with or without 2nd handle)

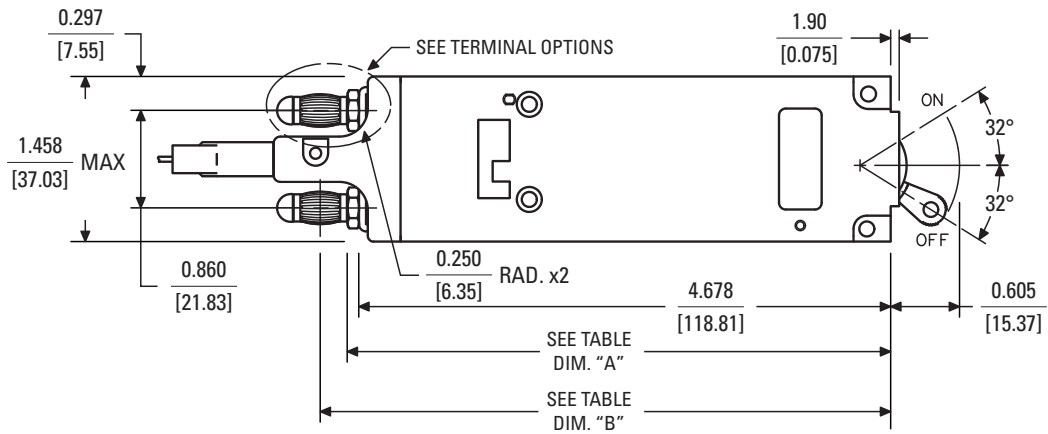
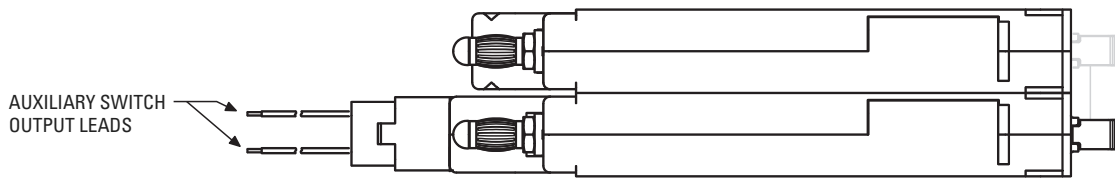

## DIMENSIONS

Bullet Type	Dim. "A"	Dim. "B"	Dim. "C"
1/4" Bullet	4.778 [121.35]	5.019 [127.48]	Ø 0.251 ± 0.001 Ø [6.38 ± 0.03]
5/16" Bullet	4.851 [123.22]	5.092 [129.35]	Ø 0.312 ± 0.001 Ø [7.92 ± 0.03]

Stud Type	Dim. "E"	Dim. "F"
10-32	0.545 [13.84]	0.622 [15.81]
M5	0.510 [12.95]	0.588 [14.92]

**Single Pole Bullet Terminal Mounting Detail**

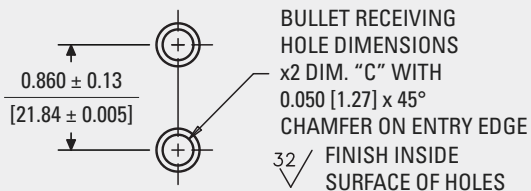

**Two Pole Bullet Terminal Mounting Detail**

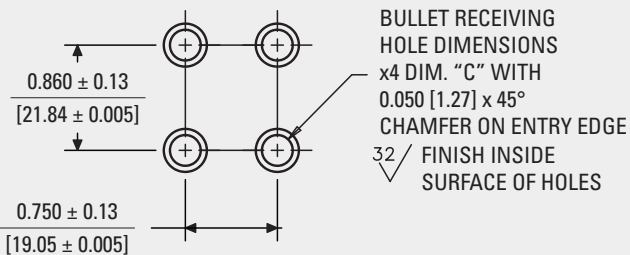

**1/4" Bullet Terminals**

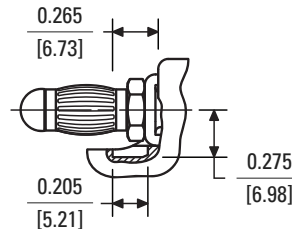

**5/16" Bullet Terminals**

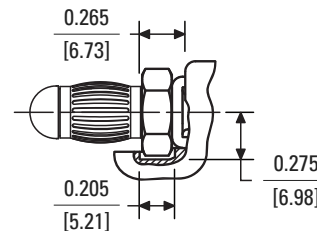

**10-32 or M5 Screw Terminals**

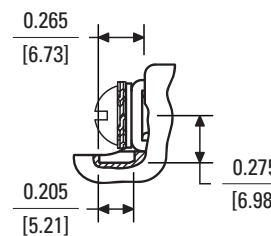

**10-32 or M5 Stud Terminals**

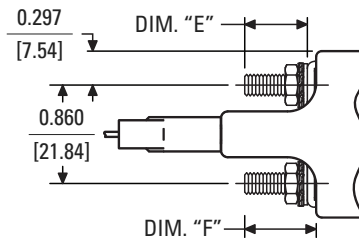

## CONFIGURATIONS

### Series Trip

The most popular configuration for magnetic protectors is the series trip where the sensing coil and the contacts are in series with the load being protected. In addition to providing conventional overcurrent protection, it is simultaneously used as an on-off switch.

Single Pole, Series Trip



Two Pole, Series Trip

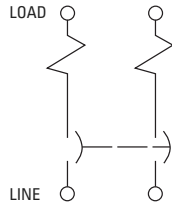

### Mid-Trip

This is furnished as an integral part of a series pole in single or, multi-pole assemblies. Isolated electrically from the protector's circuit, the switch works in unison with the power contacts and provides indication at a remote location of the protector's ON-OFF status.

Mid-Trip

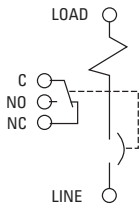

Breaker shown in ON position or manually turned OFF position

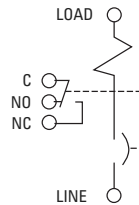

Breaker shown in mid-trip position (electrically tripped)

### Auxiliary Switch

This is furnished as an integral part of a series pole in single or, multi-pole assemblies. Isolated electrically from the protector's circuit, the switch works in unison with the power contacts and provides indication at a remote location of the protector's ON-OFF status.

Auxiliary Switch

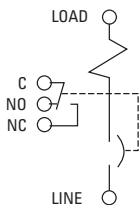

Breaker shown in OFF position

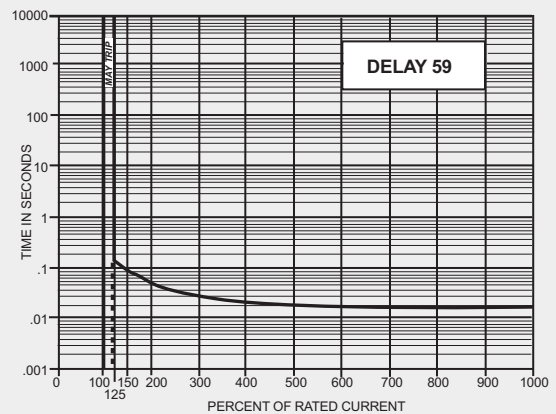
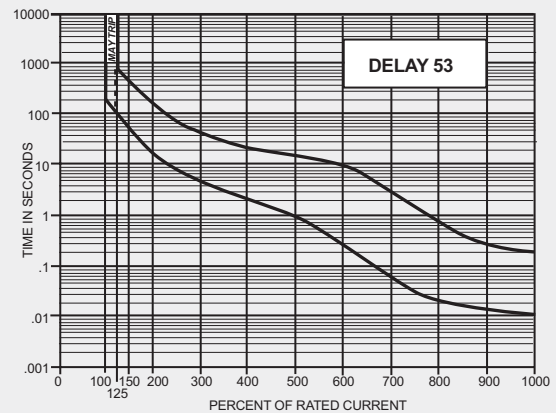
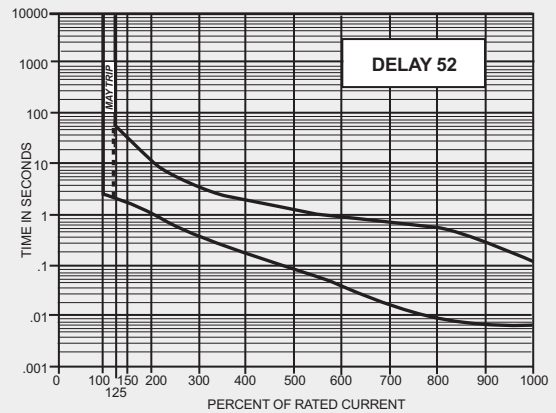
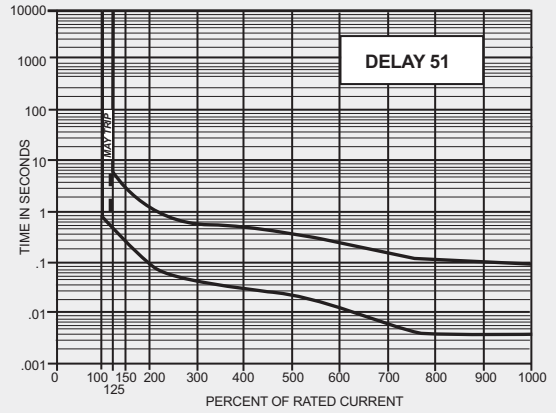

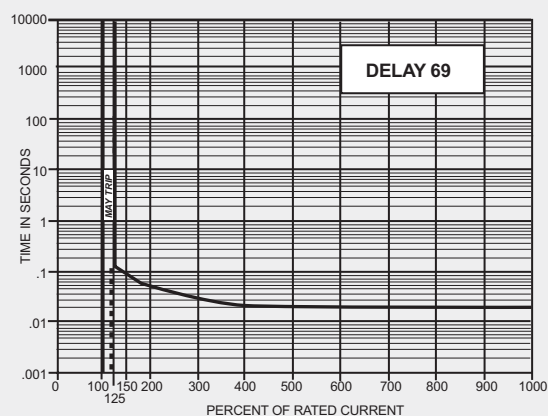
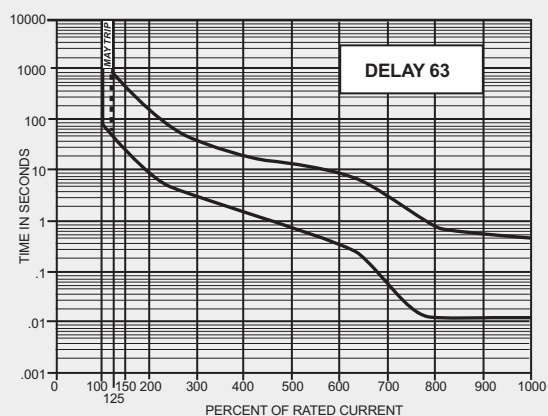
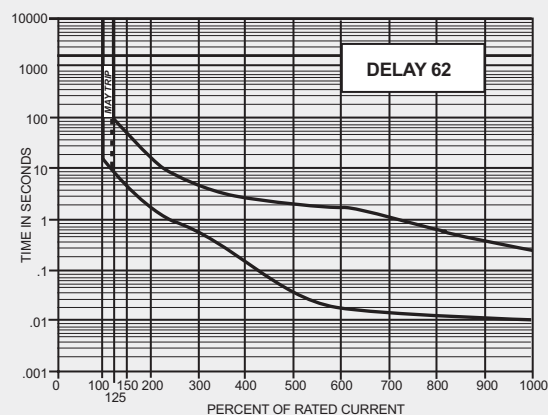
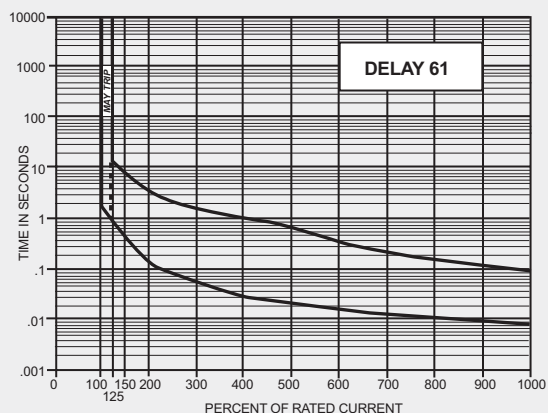

## DELAY CURVES & SPECIFICATIONS

### DC, 50/60Hz Delay Curves (typ)

A choice of delays is offered for DC and 50/60Hz applications. Delays 59 and 69 provide fast-acting, instantaneous trip and are often used to protect sensitive electronic equipment (not recommended where known inrush exists). Delays 51 and 61 have a short delay for general purpose applications. Delays 52 and 62 are long enough to start certain types of motors and most transformer and capacitor loads.

### Trip Free

Will trip open on overload, even when forcibly held on. This prevents operator from damaging the circuit by holding handle in the ON position.

### Trip Indication

The operating handle moves forcibly and positively to the OFF position on overload.

### Ambient Operation

Operates normally in temperatures between  $-40^{\circ}\text{C}$  and  $+85^{\circ}\text{C}$ .

### Insulation Resistance

Not less than 100 megohms at 500Vdc.

### Dielectric Strength

Shall withstand AC voltage 60 Hz, for 60 seconds between all electrically isolated terminals as described below.

Series, switch only	: 3,750 VAC
Auxiliary switches	: 600 VAC
Series w/ auxiliary switch	: 3,750 between main circuit breaker terminal and auxiliary switch terminal

### Shock

Shall not trip when tested per MIL-STD-202, method 213, test condition 1 with 100% rated current applied to delayed units, except 90% current in plane 4, (i.e. handle down). Instantaneous units shall have 80% rated current applied in all planes.

### Vibration

Shall not trip when vibrated per MIL-STD-202, method 204, test condition A with 100% rated current applied to delayed units and 80% rated current to instantaneous units.

### Endurance

In many applications contact wear due to the electrical load determines unit life. At maximum electrical ratings, the IAR/IUR/IER/CUR/CER can perform 10,000 operations at rated current and voltage at a maximum rate of 6 operations per minute.

## OPERATING CHARACTERISTICS

### Inrush Pulse Tolerance

Many circuit protector applications involve a transformer turn-on, an incandescent lamp load, or a capacitor charge from a DC source. Each of these applications has one common factor: a steep transient of very high current amplitude and short duration. This takes the form of a spike or a single pulse and is the cause of most nuisance tripping associated with magnetic circuit breakers.

The IAR/IUR/IER/CUR/CER series will withstand, without tripping, a single pulse of 8 milliseconds duration (half sine wave configuration) and peak amplitude of 10 times its rating.

### MAXIMUM DCR AND IMPEDANCE (APPROXIMATE VALUES)

Current Ratings (Amps)	DC Resistance (Ohms) 51, 52, 53, 59	50/60Hz Impedance (Ohms) 61, 62, 63, 69
2.0	0.027	0.038
3.0	0.074	0.098
6.0	0.037	0.048
7.5	0.025	0.029
15.0	0.010	0.011
32.0	0.003	0.003
40.0	0.003	0.003
50.0	0.0024	0.0025

*Tolerance: 2 to 2.5 amps ±20%; 2.6 to 20 amps ± 25%; 21 to 50 amps ±50%  
\*Consult factory for special values and for coil impedance of delays not shown*

### AUXILIARY SWITCH RATING

10.0 amps	@	250 VAC, 60 Hz
3.0 amps	@	50 VDC
1.0 amps	@	80 VDC

### APPROXIMATE WEIGHT PER POLE

1 pole	134 grams
2 pole	263 grams

### PULSE TOLERANCE

Delay	Pulse Tolerance
61, 62, 63	10 Times Rated Current

### PERCENTAGE OF RATED CURRENT VS TRIP TIME IN SECONDS AT +25°C (APPROXIMATE VALUES)

Delay	100%	125%	150%	200%	400%	600%	800%	1000%
51	No Trip	0.5 to 6.5	0.3 to 3	0.1 to 1.2	0.031 to 0.5	0.011 to 0.25	0.004 to 0.1	0.004 to 0.08
52	No Trip	2 to 60	1.8 to 30	1 to 10	0.15 to 2	0.015 to 1	0.008 to 0.5	0.006 to 0.1
53	No Trip	80 to 700	40 to 400	15 to 150	2 to 20	0.015 to 9	0.015 to 0.55	0.012 to 0.2
59	No Trip	0.120 max	0.1 max	0.05 max	0.022 max	0.017 max	0.017 max	0.017 max
61	No Trip	0.7 to 12	0.35 to 7	0.13 to 3	0.03 to 1	0.015 to 0.3	0.01 to 0.15	0.008 to 0.1
62	No Trip	10 to 120	6 to 60	2 to 20	0.2 to 3	0.015 to 2	0.015 to 0.8	0.01 to 0.25
63	No Trip	50 to 700	30 to 400	10 to 150	1.5 to 20	0.015 to 10	0.013 to 0.85	0.013 to 0.5
69	No Trip	0.12 max	0.1 max	0.05 max	0.022 max	0.017 max	0.017 max	0.017 max

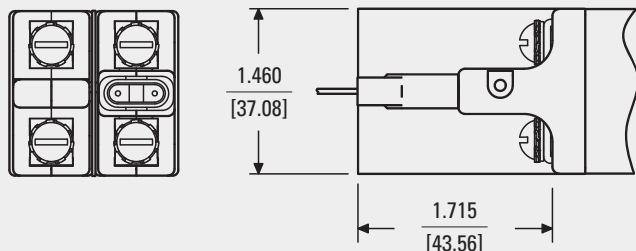

**Barrier (-B)****Bullets****Socket 1/4-20 UNC-2A**

Order # 641-480-5032  
(silver plated copper)

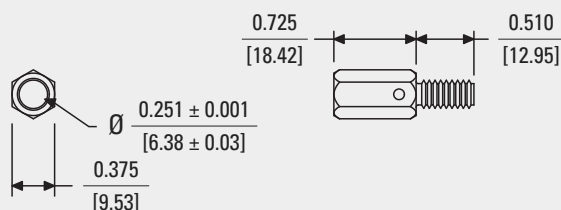
**Socket 1/4-20 UNC-2A**

Order # 641-480-5030  
(silver plated copper)

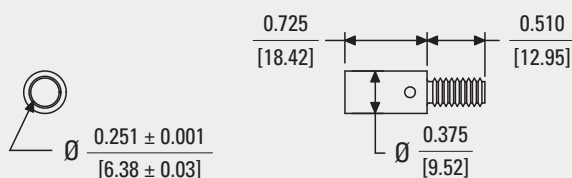
**Socket 1/4-20 UNC-2A**

Order # 641-480-5022  
(silver plated copper)

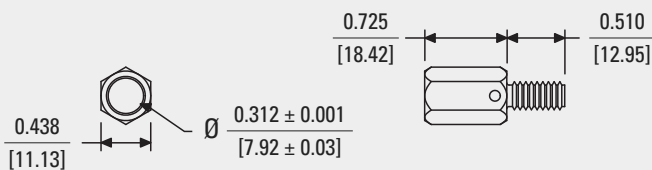
**Nut 1/4-20 UNC-2B**

Order # 388-899-5010  
(silver plated copper)

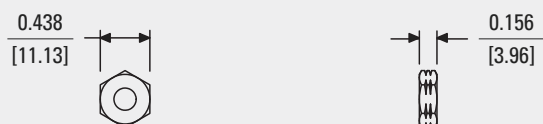
**HARDWARE****Handle Lock**

A handle lock option is available to prevent accidental actuation of the handle. The handle lock may be used in the ON or OFF position. Use of the handle lock on breakers with alarm style auxiliary switches may defeat the alarm feature on electrical trip. This option is available separately or pre-assembled (on single pole constructions only).

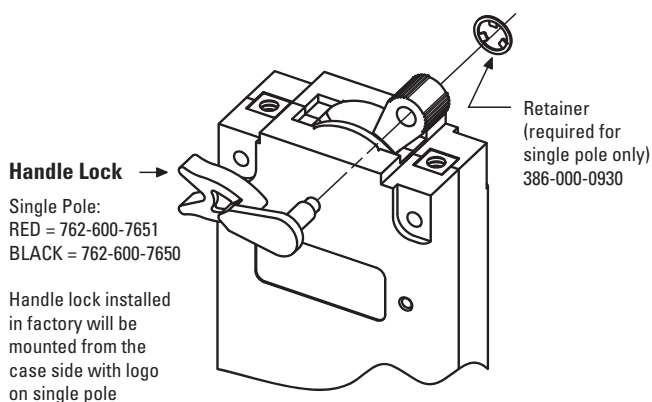
**Mid-Trip**

The handle position indicates the status of the circuit breaker. In addition to full ON and full OFF positions, there is a middle "MID-TRIP" position indicating that the breaker has electrically tripped from an overload. It is available in single pole and multi-pole (handle per pole only) series constructions. Switch only configuration is not available in mid-trip build. An auxiliary switch can be furnished as an integral part of the mid-trip breaker. The switch provides an indication at a remote location when the circuit breaker has electrically tripped and handle is in the mid-trip position.

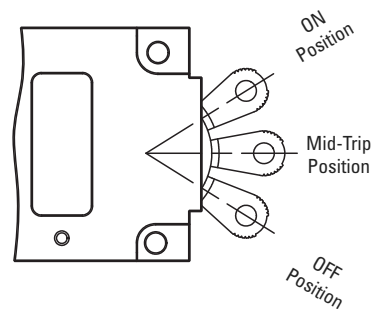

## HOW TO ORDER

The ordering code for these circuit breakers / protectors may be determined by following the steps in the decision tables shown here.

The example shown is the code for a UL1077 & TÜV approved circuit protector with series trip, one handle per unit, single pole circuit protector with 10-32 terminal screws standard and a mechanical auxiliary switch. This unit is designed with a slow DC time delay and a rating of 20 amperes with optional metric threads and optional 80VDC capability. Handle color is black with white markings, and is has been met all the selection criteria to obtain the TÜV approval.

To determine the ordering code for your particular unit, simply follow the steps shown, then fill in the letters and/or numbers in the boxes. Space is available on the circuit breaker label for your part number (up to 12 digits). You may then use your own part number to place an order or as a reference for further questions you may have. This option does require a factory assigned part number for traceability to your drawing or internal part number.

1		First Choice: Type	Second Choice: Terminal
IAR	Magnetic circuit protector, one handle per unit		10-32 screw terminal, standard (no entry)
IARH	Magnetic circuit protector, one handle per pole		K 10-32 stud terminal
IER	UL1077 & TÜV, series trip, one handle per unit		B 0.250" bullet terminal
IERH	UL1077 & TÜV, series trip, one handle per pole		<p><i>The shaded areas denote TÜV approval options. This approval requires the addition of a "T" at the end of the part number (8th decision).</i></p> <p><i>The "T" will automatically be added to any part number formed entirely from these shaded decisions. If non-shaded areas are selected, the unit will not be TÜV approved, but other approvals (if applicable) will still apply.</i></p>
IUR	UL1077, series trip, one handle per unit		
IURH	UL1077, series trip, one handle per pole		
IMR	UL1077 & TÜV, mid trip, one handle per unit		
IMRH	UL1077 & TÜV, mid trip, one handle per pole		
CER	UL489A & TÜV, series trip, one handle per unit		
CERH	UL489A & TÜV, series trip, one handle per pole		
CUR	UL489A, series trip, one handle per unit		
CURH	UL489A, series trip, one handle per pole		
CMR	UL489A & TÜV, mid trip, one handle per unit		
CMRH	UL489A & TÜV, mid trip, one handle per pole		

IER 1 - 1REC4C - 52 - 20.0 - AD - 01 - T

1 2 3 4 5 6 7 8

8
TÜV Approval
Per first decision's description: The shaded areas denote TÜV approval options. This approval requires the addition of a "T" at the end of the part number (8th decision).

2	
Number of Poles	
1	Single pole
11	Two pole

3	
Internal Configuration	
-1	Series trip
-1REC4C	Mechanical trip auxiliary switch*
-1RS4C	Electrical trip auxiliary switch*
-1RLS4C	Electrical trip auxiliary switch* (mid-trip only)
-1REG4C	Series trip with auxiliary switch* 0.110 quick-connects (gold contacts)
-1REC40	Mechanical trip auxiliary switch**
-1RS40	Electrical trip auxiliary switch*
-1RLS40	Electrical trip auxiliary switch* (mid-trip only)
-1REG40	Series trip with auxiliary switch* 0.110 quick-connects (gold contacts)
* Alarms when circuit breaker closes	
** Alarms when circuit breaker opens	
Only one auxiliary switch is normally supplied on two pole units. Switch is located in the right hand pole (viewed from terminal end) unless otherwise specified.	

7			
Handle Color & Markings			
-00	Black	-01	Black w/ white markings (standard)
-10	Yellow	-11	Yellow w/ black markings
-20	Red	-21	Red w/ white markings
-30	Blue	-31	Blue w/ white markings
-40	Green	-41	Green w / white markings
-60	Orange	-61	Orange w/ black markings
-90	White	-91	White w/ black markings

6	
Optional	
-A	Metric thread mounting (M3) & terminals (M5)
-B	Barrier (AC only)
-C	65 VDC
-D	80VDC
-E	0.312" diameter bullet (standard is 0.250" when prefix with "B" is chosen in first decision)
-F	250VAC
-L	Handle Lock
Notes:	
1. One or more descriptions may be used as required (for example, to get a barrier, 250VAC and handle lock, put -BFL)	
2. When the sixth decision is not required, the seventh decision may be substituted and U.S. thread will be supplied	

4	
Frequency & Delay	
-51	DC short delay
-52	DC long delay
-53	DC motor start / extra long delay
-59	DC 125% instant trip
-61	50 - 60 Hz short delay
-62	50 - 60 Hz Long Delay
-63	50 - 60 Hz motor start / extra long delay (30A max)
-69	50 - 60 Hz 125% instant trip

5
Rated Current
Use three numbers to print required current value between 2.00 amps minimum and 50.0 amps maximum.

